



AECOM  
303 E. Wacker Drive, Suite 1400  
Chicago, Illinois 60606

312-939-1000 tel  
312-939-4198 fax

June 25, 2019

Mr. Naren Prasad  
Peoples Gas Light & Coke Co.  
Environmental Services Department  
200 E. Randolph Street, 24<sup>th</sup> Floor  
Chicago, IL 60601

RE: Streeterville Thorium Screening for Corrosion Repair Excavation  
Permit No.: DOT1106165  
Permit Address: 159-165 E. Ohio Street, Chicago, Illinois  
AECOM Project No. 60157647

Dear Mr. Prasad:

Pursuant to conditions specified in a permit (see attached) issued by the City of Chicago, radiation monitoring was required to be performed at the above referenced site. AECOM Technical Services, Inc. (AECOM) provided the required radiation surveillance on June 25, 2019 during an excavation to install an anode.

Surveying was performed on the fill soil removed at 159-165 E. Ohio St. to install an anode on the existing service line. The excavation was approximately 80-feet west of N. St. Clair Street curb and 4-feet south of the north curb on E Ohio Street (refer to annotated drawing). The final excavation depth was approximately 60-inches below ground surface (bgs).

The monitoring did not indicate that the fill soils were above the removal action level established by the U.S. Environmental Protection Agency (USEPA) for the Streeterville area of Chicago. The USEPA removal action level for Chicago's Streeterville area is 7.1 picocuries per gram (pCi/g) total radium (Ra-226 + Ra-228). Gamma radiation count measurements for the project were recorded using Ludlum Models 2221 survey meter and a shielded 2 x 2 inch NaI probe (Model 44-10). For the instrument used, the gamma count threshold indicative of the 7.1 pCi/g removal action level is 6,669 (S/N: 172039) counts per minute (cpm) shielded. The field instrument background gamma count for nearby fill soil ranged from 2,200 to 2,900 cpm shielded.

The field gamma measurements within the excavation during the excavation process did not exceed the stated instrument threshold and ranged from a minimum of 1,700 cpm to a maximum of 4,400 cpm shielded. The general subsurface stratigraphy was composed fill sand and gravel. Based on field measurements there was no indication of the presence of radiologically-contaminated fill and/or an exceedance of the USEPA removal action level of 7.1 pCi/g total radium. A copy of the Chicago Department of Public Health (CDPH) permit form and an annotated drawing and summary table documenting the results have been included as attachments.

As part of the permit conditions, a PDF copy of this letter is being forwarded to Terry Sheahan (CDPH) and Verneta Simon (USEPA).

Permit No.: DOT1106165  
Permit Address: 159-65 E. Ohio St.  
Page 2

Please contact us with any questions you have regarding this letter.  
Regards,

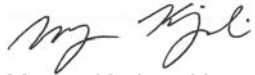

Megan Krajewski  
Geologist



Steven C. Kornder, Ph.D.  
Senior Project Geochemist

cc: Terry Sheahan, CDPH  
Verneta Simon, USEPA

Attachments: Permit  
Annotated Drawing and Tabulated Results

**PERMIT**



DEPARTMENT OF PUBLIC HEALTH  
CITY OF CHICAGO

FORM NO. CDPH.ROW.03 (STREETERVILLE Right-of-Way)

Notice is hereby given that the site you have requested a permit for is recorded with the City of Chicago Department of Public Health (CDPH) as potentially having environmental contamination on the site and adjacent right-of way. This environmental contamination could present a threat to human health and safety in connection with work performed at the site, or in the adjacent right-of-way, if proper safeguards are not employed.

A file containing detailed information regarding the aforementioned environmental contamination is available for review at CDPH at 333 S. State St., Room 200, Chicago, Illinois 60604 during normal business hours (8:30AM-4:30PM, Monday through Friday). Contact (312) 745-3152 for an appointment. This file must be reviewed and the remainder of this form completed before the permit can be issued if the ground is exposed or excavated. **Please note that for some locations, additional health and safety procedures may be required by law.**

Please complete the following:

I have reviewed and understand the documents, maintained by CDPH, regarding environmental contamination of the site and adjacent right-of-way. Further, I will ensure that all work at the subject site and adjacent right-of-way, and any monitoring required including but not limited to radiation monitoring, will be performed in a manner that is protective of human health and the environment and in compliance with all applicable local, state, and federal laws, rules, and regulations, especially those pertaining to worker safety and waste management. I will ensure that the results of any radiation monitoring and/or surveying conducted shall be provided to the CDPH and the United States Environmental Protection Agency **within two (2) weeks of their completion**. If any elevated levels of radioactive material are detected, I will immediately contact the United States Environmental Protection Agency at (800) 424-8802.

Applicant Name (print): Maria G Oliver Signature: Maria G Oliver

Site Address and Work Location (Describe exact site location and attach map): 159-165 E Ohio St

Nature of Work: Corrosion installing test lead and anode on main

Company Name, Address, Phone No.: Peoples Gas, 200 E Randolph, (312) 240-4692

General / Prime Contractor Name, Address, Phone No.: Scott Zanoni (773) 395-4247

*Include subcontractor information if applicable*

Safety Officer / Phone No. Danielle Clopton (312) 240-6674

Radiation Contractor / Phone No. (if applicable) Steve Kornder, AECOM, INC (262) 515-7700

Check if City Department Work  Department Name: \_\_\_\_\_

CDOT Permit No.: DOT1106165

Today's Date: 5/31/19 Expected Start Date: 6/4/19 CDPH Approval / Date J Sheehan 5/31/19

Please return this completed form to the Chicago Department of Transportation, Division of Infrastructure Management, Public Way Permit Office, City Hall – Room 905, 121 N. LaSalle St., Chicago, Illinois 60602 during normal business hours (8:30 AM - 4:30 PM, Monday through Friday)

For CDPH Use Only

159-65 E Ohio St DOT1106165

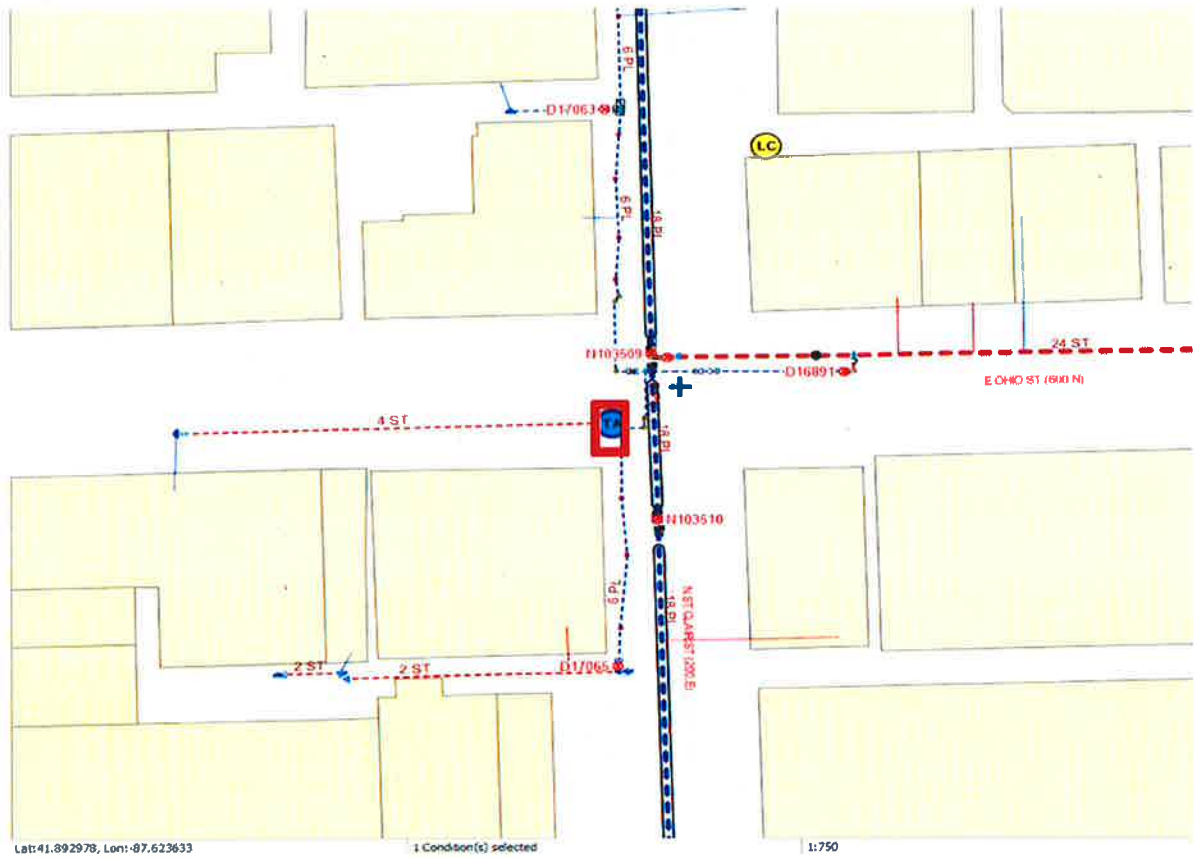

Lat:41.892978, Lon:-87.623633

1 Condition(s) selected

1:750

## ANNOTATED DRAWING AND RESULTS

# Peoples Gas Anode Installation June 25, 2019

159-65 E Ohio St DOT1106165

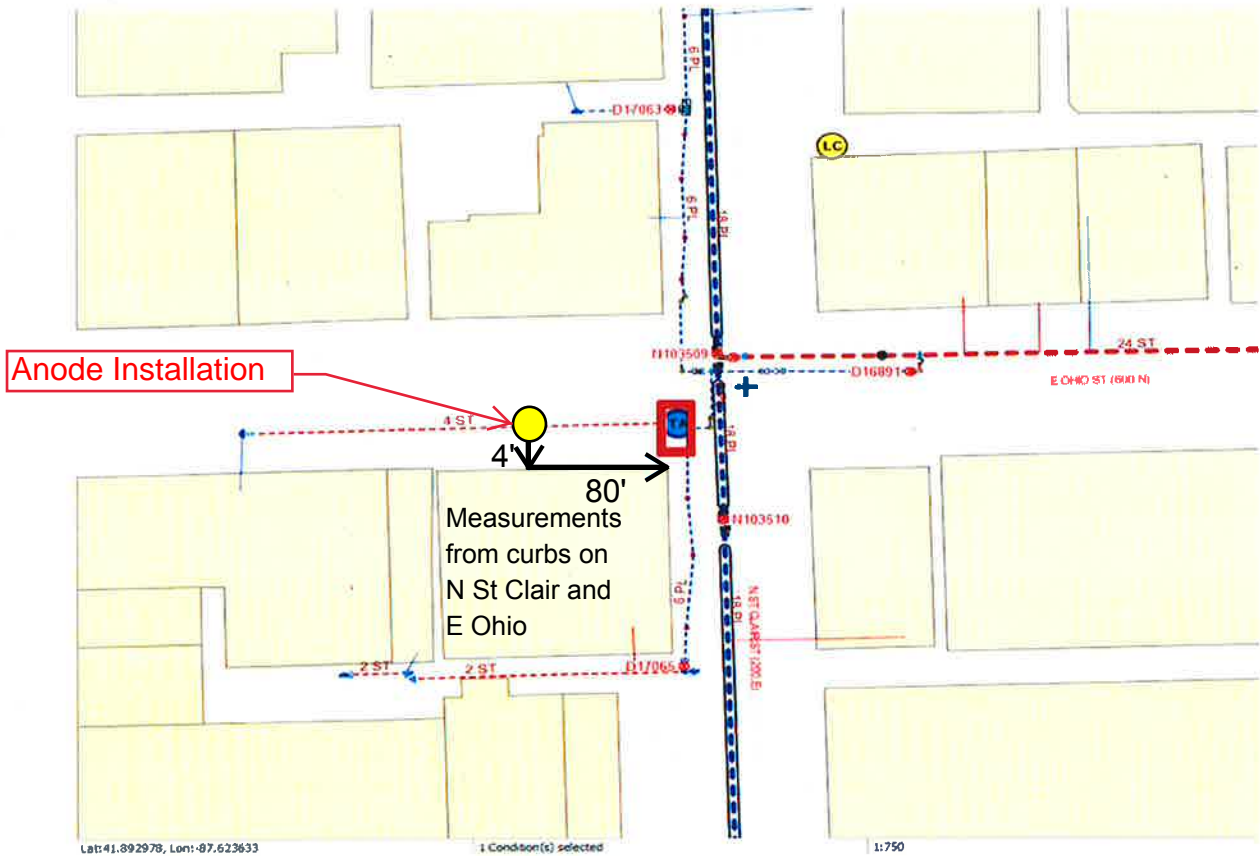

\*Not to scale

**Survey Results**  
**159-165 E. Ohio St.**  
**People's Gas**

**Survey Equipment**

Ludlum 2221 S/N:	172039
Probe 2x2 NaI S/N:	PR174406
Shielded Cutoff:	6,669 cpm
Background:	2,200 - 2,900 cpm
Personnel:	M. Krajewski
Date of Screening:	6/25/2019

**Survey Results**

Section	Date	Depth (inches)	Maximum Gamma Readings (CPM)
1	6/5/2019	0-12	concrete
		12	1,700
		24	2,300
		36	2,600
		48	3,700
		60	4,400