



AECOM
303 E. Wacker Drive, Suite 1400
Chicago, Illinois 60606

312-939-1000 tel
312-939-4198 fax

May 21, 2019

Mr. Naren Prasad
Peoples Gas Light & Coke Co.
Environmental Services Department
200 E. Randolph Street, 24th Floor
Chicago, IL 60601

RE: Streeterville Thorium Screening for Corrosion Repair Excavation
Permit No.: DOT1083525
Permit Address: 446-450 E. Ohio Street, Chicago, Illinois
AECOM Project No. 60157647

Dear Mr. Prasad:

Pursuant to conditions specified in a permit (see attached) issued by the City of Chicago, radiation monitoring was required to be performed at the above referenced site. AECOM Technical Services, Inc. (AECOM) provided the required radiation surveillance initially on April 30, 2019 and again on May 6, 2019 when it was necessary to expand the excavation horizontally to the west to complete the repair work on the service line.

Surveying was performed on the fill soil removed at 446-450 E. Ohio St. to complete repairs on the existing service line. The two adjacent excavations were each approximately 8 x 8 ft (total 8 x 16 ft). The excavation was along the northern curb approximately 20-feet east of the western property line for the 450 E. Ohio Street building (refer to sketch). The final excavation depth was approximately 48-inches below ground surface (bgs).

The monitoring did not indicate that the fill soils were above the removal action level established by the U.S. Environmental Protection Agency (USEPA) for the Streeterville area of Chicago. The USEPA removal action level for Chicago's Streeterville area is 7.1 picocuries per gram (pCi/g) total radium (Ra-226 + Ra-228). Gamma radiation count measurements for the project were recorded using Ludlum Models 2221 survey meter and a shielded 2 x 2 inch NaI probe (Model 44-10). For the instrument used, the gamma count threshold indicative of the 7.1 pCi/g removal action level is 6,669 (S/N: 172039) counts per minute (cpm) shielded. The field instrument background gamma count for nearby fill soil was 1,600 cpm shielded.

The field gamma measurements within the excavation during the excavation process did not exceed the stated instrument threshold and ranged from a minimum of 1,300 cpm to a maximum of 2,400 cpm shielded. The general subsurface stratigraphy was composed of limestone gravel, fill sand and urban fill. Based on field measurements there was no indication of the presence of radiologically-contaminated fill and/or an exceedance of the USEPA removal action level of 7.1 pCi/g total radium. A copy of the Chicago Department of Public Health (CDPH) permit form and a field sketch documenting the results and area where work was performed have been included as attachments.

As part of the permit conditions, a PDF copy of this letter is being forwarded to Terry Sheahan at the CDPH and Verneta Simon (USEPA).

Permit No.: DOT1083525
Permit Address: 446-50 E. Ohio St.
Page 2

Please contact us with any questions you have regarding this letter.
Regards,



Andrew Kozak
Geologist



Steven C. Kornder, Ph.D.
Senior Project Geochemist

cc: Terry Sheahan, Chicago Department of Public Health
Verneta Simon, USEPA

Attachments: Permit
Sketch

PERMIT



DEPARTMENT OF PUBLIC HEALTH
CITY OF CHICAGO

FORM NO. CDPH.ROW.03 (STREETERVILLE Right-of-Way)

Notice is hereby given that the site you have requested a permit for is recorded with the City of Chicago Department of Public Health (CDPH) as potentially having environmental contamination on the site and adjacent right-of way. This environmental contamination could present a threat to human health and safety in connection with work performed at the site, or in the adjacent right-of-way, if proper safeguards are not employed.

A file containing detailed information regarding the aforementioned environmental contamination is available for review at CDPH at 333 S. State St., Room 200, Chicago, Illinois 60604 during normal business hours (8:30AM-4:30PM, Monday through Friday). Contact (312) 745-3152 for an appointment. This file must be reviewed and the remainder of this form completed before the permit can be issued if the ground is exposed or excavated. **Please note that for some locations, additional health and safety procedures may be required by law.**

Please complete the following:

I have reviewed and understand the documents, maintained by CDPH, regarding environmental contamination of the site and adjacent right-of-way. Further, I will ensure that all work at the subject site and adjacent right-of-way, and any monitoring required including but not limited to radiation monitoring, will be performed in a manner that is protective of human health and the environment and in compliance with all applicable local, state, and federal laws, rules, and regulations, especially those pertaining to worker safety and waste management. I will ensure that the results of any radiation monitoring and/or surveying conducted shall be provided to the CDPH and the United States Environmental Protection Agency **within two (2) weeks of their completion**. If any elevated levels of radioactive material are detected, I will immediately contact the United States Environmental Protection Agency at (800) 424-8802.

Applicant Name (print): Maria G Oliver Signature: Maria G Oliver

Site Address and Work Location (Describe exact site location and attach map): 446-450 E Ohio St

Nature of Work: Corrosion repair on main

Company Name, Address, Phone No.: Peoples Gas, 200 E Randolph, (312) 240-4692

General / Prime Contractor Name, Address, Phone No.: Brad Nagel (312) 863-0732

Include subcontractor information if applicable

Safety Officer / Phone No. Danielle Clopton, (312) 240-6674

Radiation Contractor / Phone No. (if applicable) Steve Kornder, AECOM, Inc (262) 515-7700

Check if City Department Work Department Name: _____

CDOT Permit No.: DOT1083525

Today's Date: 4/10/2019 Expected Start Date: 4/12/2019 CDPH Approval / Date: J Sheahan 4-10-19

Please return this completed form to the Chicago Department of Transportation, Division of Infrastructure Management, Public Way Permit Office, City Hall – Room 905, 121 N. LaSalle St., Chicago, Illinois 60602 during normal business hours (8:30 AM - 4:30 PM, Monday through Friday)

For CDPH Use Only

446-50 E Ohio St Corrosion repair on main

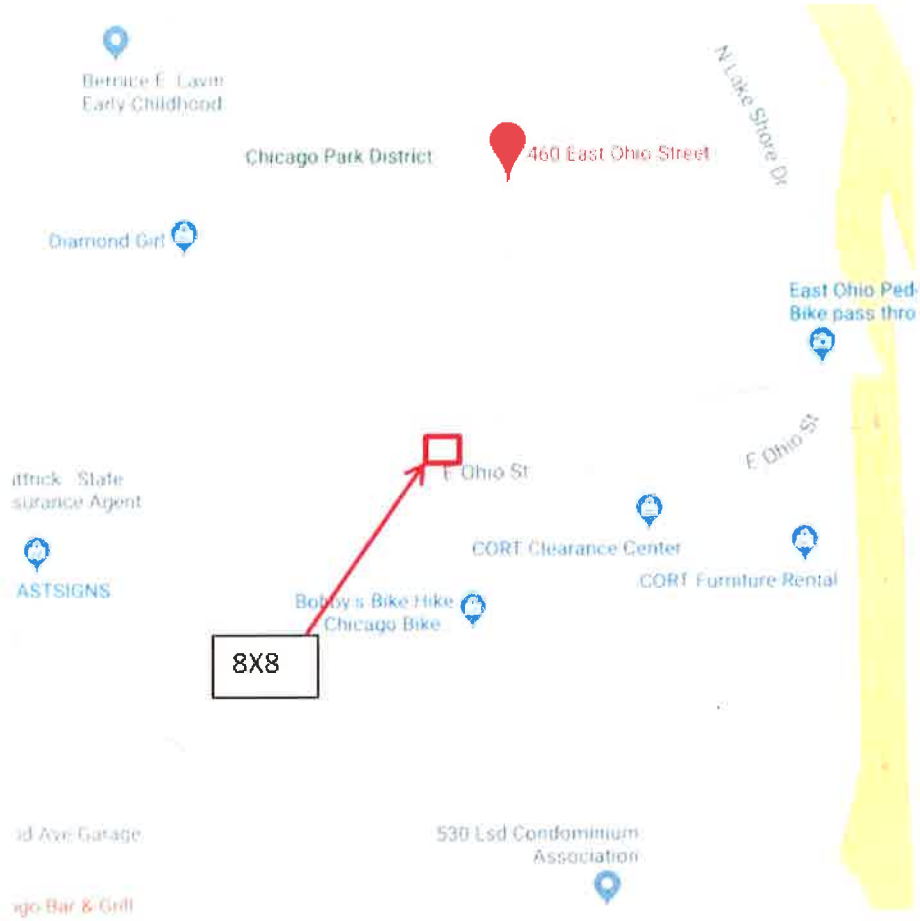

SKETCH

JOB TITLE Peoples Gas 446-450 E Ohio St
JOB NO. 60157647.121 CALCULATION NO. —
ORIGINATOR E Sulita DATE 4/30 & 5/6/19
REVIEWER SCK DATE 5/21/19
SCALE N1"=10' SHEET NO. 1 OF 1

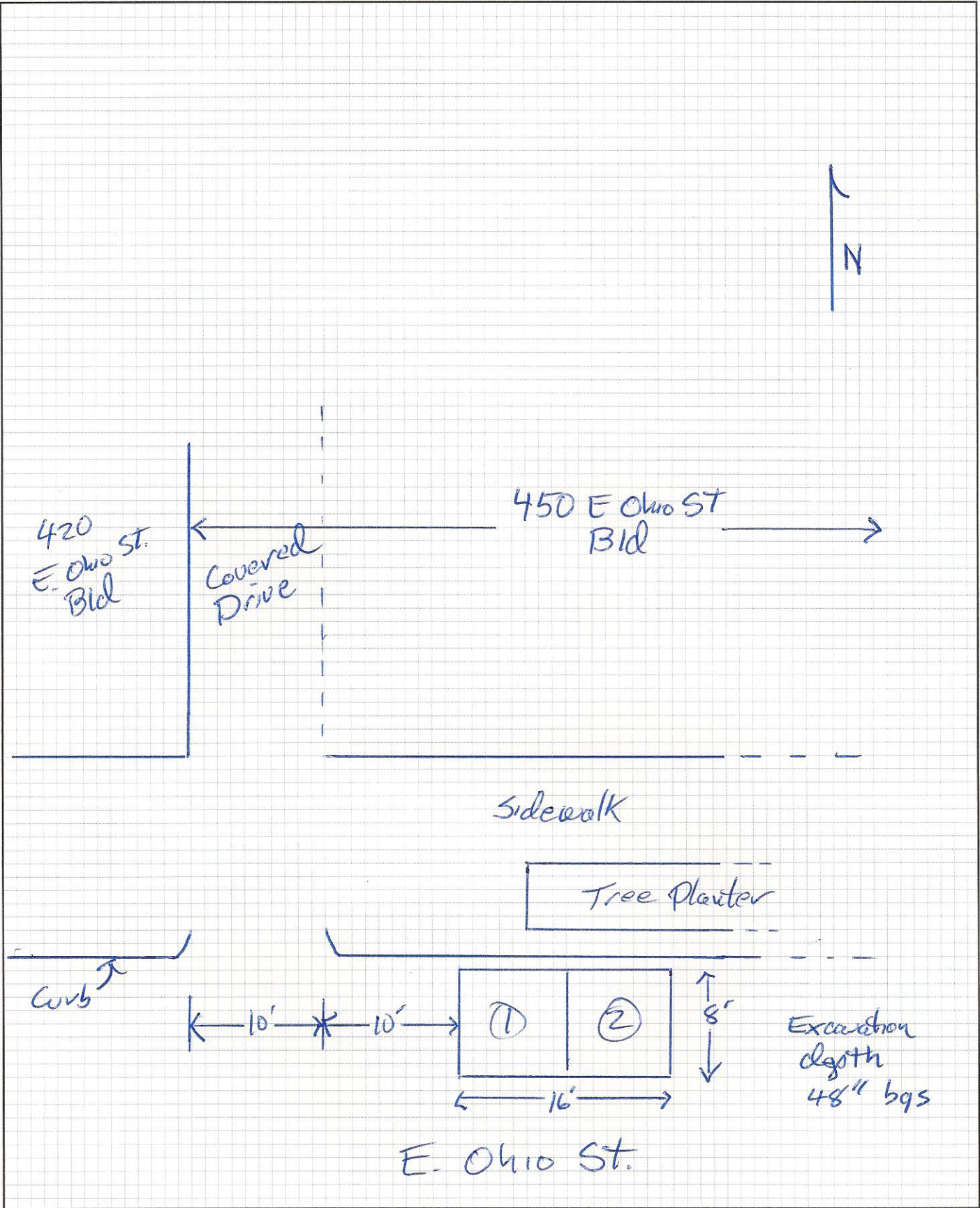

Survey Results
446-450 E. Ohio St.
People's Gas

Survey Equipment

Ludlum 2221 S/N:	172039
Probe 2x2 NaI S/N:	PR174406
Shielded Cutoff:	6,669 cpm
Background:	1600 cpm
Personnel:	E. Sulita
Dates of Screening:	4/30/19 and 5/6/19

Survey Results

Section	Date	Depth (inches)	Gamma Readings (CPM)
1	5/6/2019	0-12	concrete
		12-24	1,400 - 1,800
		24-36	1,600 - 1,900
		36-48	2,200 - 2,400
		48	1,600 - 2,000
2	4/30/2019	0-12	concrete
		12-20	1,800
		20-24	1,500-2,400
		24-36	1,300
		36-44	1,400
		44-48	1,700
		48	2,200