



October 5, 2017

Buddy Hix  
Western Utility Contractors, Inc.  
2565 Palmer Ave.  
University Park, IL 60466

RE: 61-81 E. Wacker Place Thorium Monitoring 9/25/17-9/27/17  
CDOT Permit # 831600

Dear Mr. Hix:

Stan A. Huber Consultants, Inc (SAHCI) was hired by your firm to provide radiation monitoring during excavation to repair a utility conduit at 61-81 E. Wacker Place in Chicago, Illinois. The monitoring was performed by Brian Schmidt, SAHCI Health Physics Technician, on September 25, 2017 – September 27, 2017.

#### Instrumentation

Surface gamma scans were performed using a Ludlum Model 2221 Scaled / Ratemeter (serial no. 126496) with attached Ludlum Model 44-10 2"x2" NaI probe (w/ 6" collimated lead shield). The instrument was calibrated on October 14, 2016. The US Environmental Protection Agency (USEPA) action level of 7.1 picocuries per gram (pCi/g) total thorium for this instrument is 7,029 counts per minute (cpm).

The average background count rate for this location was determined to be 1,879 cpm.

#### Soil Gamma Scans

Gamma surface scans were performed using the Ludlum Model 2221 Scaler / Ratemeter described above. Survey data was collected by entering the excavation after each 18-inch lift and recording the highest count rate for the floors and walls to an excavation depth of 3 feet below ground surface. All soil was loaded directly into a truck for disposal.

The maximum gamma count rate for each lift was recorded on the attached Radiation Survey Form. The count rates in the excavation ranged from 1,600 cpm to 2,900 cpm. No count rates were found at any time that exceeded the threshold limit of 7,029 cpm.

#### Additional Monitoring

Since no count rates were identified above the 7.1 pCi/gram threshold limit, no additional soil sampling, air monitoring, or personnel monitoring were performed.

Regulatory Notification of Survey Completion

I will be providing a copy of this report to both the City of Chicago Department of Public Health and USEPA, as required.

Thank you for your assistance with this project. If you have any questions or need additional information, please call me at (815) 485-6161.

Sincerely,  
Stan A. Huber Consultants, Inc.

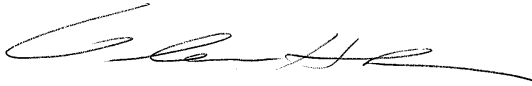
A handwritten signature in black ink, appearing to read 'Glenn Huber', with a long horizontal flourish extending to the right.

Glenn Huber, CHP  
President

### Radiation Survey Form

Location/ Project ID: WESTERN UTILITY - WACKER PLACE & GARLAND COURT - ROW RADIOLOGICAL SURVEY

Date: 9/25-27-2017

Technician: BRIAN SCHUBERT

Inst Model: LUOVLM-2221

Serial No.: 126496

Probe Type: 1"x1" NaI / 2"x2" NaI  
Shielded / Not Shielded

Lift Elevation: 0-36"

Background 1879 cpm

Action Level: 7029 cpm

Write grid designations in circles. Record highest counts for grid in cpm. Record 30 second counts at grid intersections (if required). Shade areas of elevated counts and record max cpm.

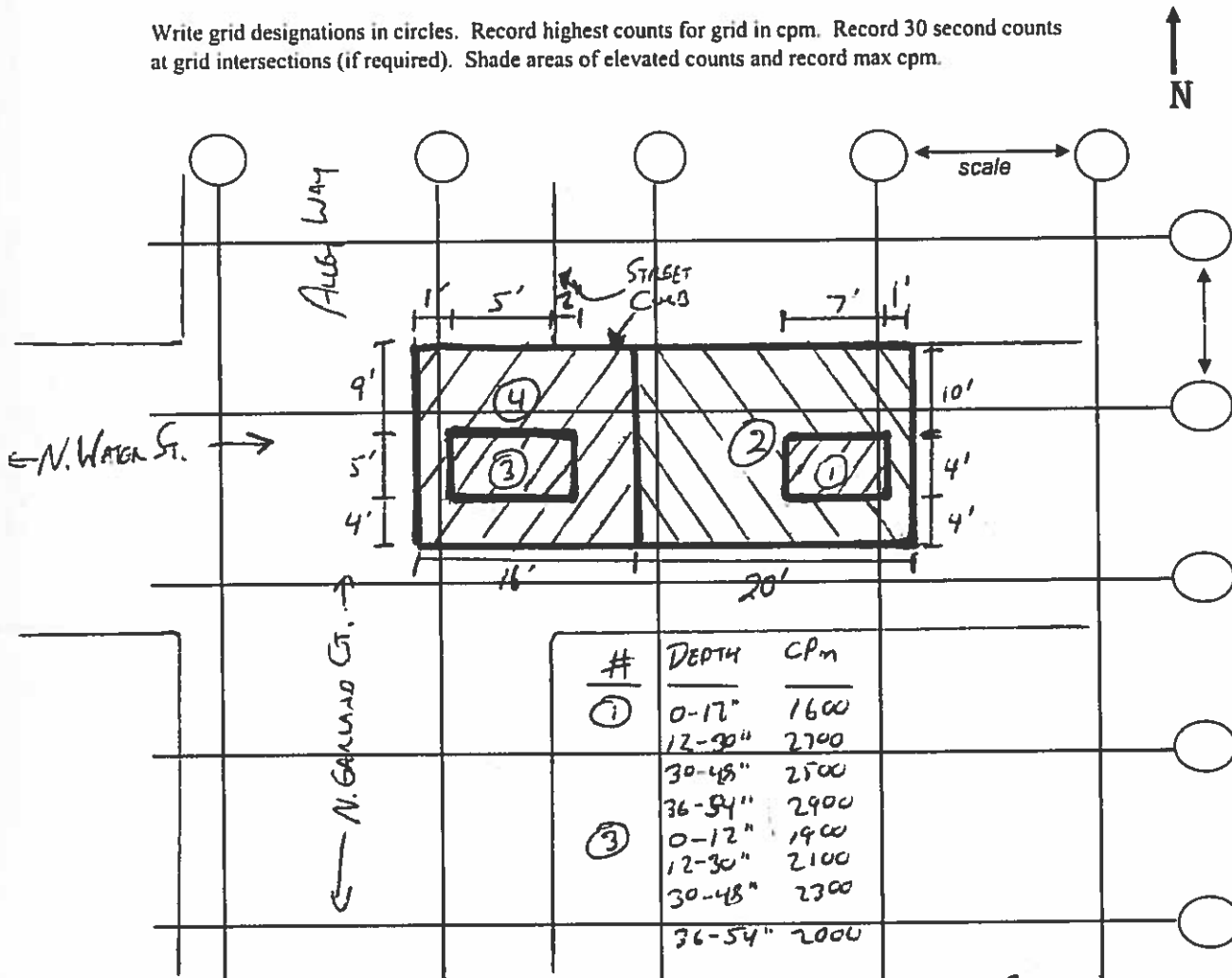

#'s ②+④ STREET SURFACE REPLACEMENT (12-12x48 CONCRETE REMOVAL)

② - MAX: 2100 cpm

④ - MAX: 1900 cpm