



AECOM  
100 S. Wacker Drive, Suite 500  
Chicago, Illinois 60606

312-939-1000 tel  
312-939-4198 fax

September 8, 2017

Mr. Kevin O'Keefe  
Premium Concrete Inc.  
655 Lunt Ave.  
Schaumburg, IL 60193

RE: Replacement of Sidewalk and Fence Posts – 626 N. Michigan Ave.  
Permit No.: DOT844846  
Permit Address: 626 N. Michigan Ave., Chicago, Illinois  
AECOM Project No. 60552905

Dear Mr. O'Keefe:

Pursuant to conditions specified in a permit (see attached) issued by the City of Chicago, radiation monitoring was required to be performed at the above referenced site. AECOM Technical Services, Inc. (AECOM) provided the required radiation surveillance on August 29, 2017 for excavations.

Surveying was performed on the fill soil removed at 626 N. Michigan Avenue (see sketch) required to address the replacement of sidewalk and four fence posts. The work consisted of four, approximately 1 foot diameter, round excavations. Three of the four excavations were excavated to approximately 30 inches below ground surface (bgs). The fourth excavation was only excavated down to a depth of 16 inches bgs due to a large piece of concrete that could not be removed. See the attached sketch for the location of each excavation.

The U.S. Environmental Protection Agency (USEPA) removal action level for Chicago's Streeterville area is 7.1 picocuries per gram (pCi/g) total radium (Ra-226 + Ra-228). Gamma radiation count measurements for the project were recorded using Ludlum Models 2221 survey meter and a shielded 2 x 2 inch NaI probe (Model 44-10). For the instrument used, the gamma count threshold indicative of the 7.1 pCi/g removal action level is 7,374 (S/N: 172039) counts per minute (cpm) shielded. The field instrument background gamma reading collected for fill in the vicinity of the excavation area was 1,840 cpm shielded.

The monitoring did not indicate that the fill soils were above the removal action level established by the USEPA for the Streeterville area of Chicago. However, gamma measurements at the base within the fourth excavation indicated a reading (7,200 cpm), which was only slightly less than the field instrument threshold. This measurement was recorded on top of what appeared to be a concrete obstruction at the base of the excavation. Spoil removed from the fourth excavation remained well below the instrument threshold and no further excavation was required.

The field gamma measurements of the spoil and within the excavations did not exceed the instrument threshold previously stated, and ranged from a minimum of 1,900 cpm to a maximum of 7,200 cpm shielded. The general subsurface stratigraphy was composed of topsoil and fine gravel. Based on field observations there was no indication of the presence of radiologically-contaminated fill excavated and/or an exceedance of the USEPA removal action level of 7.1 pCi/g total radium. A copy of the permit and a field sketch documenting the area where work was performed, have been included as attachments.

As part of the permit conditions, this letter has been forwarded to:

Chicago Department of Public Health  
Attention: Mr. Terry Sheahan  
333 South State Street, Room 200  
Chicago, Illinois 60604

Permit No.: DOT844846  
Permit Address: 626 N Michigan Ave.  
Page 2

Please contact us with any questions you have regarding this letter or the reported results.

Regards,



Andrew Kozak  
Geologist



Steven C. Kornder, Ph.D.  
Senior Project Geochemist

cc: Terry Sheahan, Chicago Department of Public Health  
Verneta Simon, USEPA

Attachments: Permit  
Sketch

**PERMIT**



DEPARTMENT OF PUBLIC HEALTH  
CITY OF CHICAGO

(STREETERVILLE Right-of-Way)

Notice is hereby given that the site you have requested a permit for is recorded with the City of Chicago Department of Public Health (CDPH) as potentially having environmental contamination on the site and adjacent right-of-way. This environmental contamination could present a threat to human health and safety in connection with work performed at the site, or in the adjacent right-of-way, if proper safeguards are not employed.

A file containing detailed information regarding the aforementioned environmental contamination is available for review at CDPH at 333 S. State St., Room 200, Chicago, Illinois 60604 during normal business hours (8:30AM-4:30PM, Monday through Friday). Contact (312) 745-3152 for an appointment. This file must be reviewed and the remainder of this form completed before the permit can be issued if the ground is exposed or excavated. Please note that for some locations, additional health and safety procedures may be required by law.

Please complete the following:

I have reviewed and understand the documents, maintained by CDPH, regarding environmental contamination of the site and adjacent right-of-way. Further, I will ensure that all work at the subject site and adjacent right-of-way, and any monitoring required including but not limited to radiation monitoring, will be performed in a manner that is protective of human health and the environment and in compliance with all applicable local, state, and federal laws, rules, and regulations, especially those pertaining to worker safety and waste management. I will ensure that the results of any radiation monitoring and/or surveying conducted shall be provided to the CDPH and the United States Environmental Protection Agency within two (2) weeks of their completion. If any elevated levels of radioactive material are detected, I will immediately contact the United States Environmental Protection Agency at (800) 424-8802.

Applicant Name (print): Kevin O'Keefe Signature: [Signature]

Site Address and Work Location (Describe exact site location and attach map): 626 N. Michigan Ave. Chicago, IL

Nature of Work: Remove & Replace sidewalk and Remove & Replace 4 fence posts at planter with concrete piers

Company Name, Address, Phone No.: Premium Concrete Inc. 655 Lunt Ave. Schaumburg IL

General / Prime Contractor Name, Address, Phone No.: Premium Concrete Inc. 847-524-0500  
*Include subcontractor information if applicable*

Safety Officer / Phone No. Mike Massillo 847-524-0500

Radiation Contractor / Phone No. and email address (if applicable) AECOM/STS Consultants Steve Kornder 262-515-9700

Check if City Department Work  Department Name: \_\_\_\_\_

CDOT Permit No.: DOT 844846

Today's Date: 8/14/17 Expected Start Date: 8-16-17 CDPH Approval / Date: [Signature] 8-15-17

Please return this completed form to the Chicago Department of Transportation, Division of Infrastructure Management, Public Way Permit Office, City Hall - Room 905, 121 N. LaSalle St., Chicago, Illinois 60602 during normal business hours (8:30 AM - 4:30 PM, Monday through Friday)

For CDPH Use Only

ONTARIO STREET

WOMAN'S ATHLETIC CLUB  
628 N MICHIGAN AVE

MICHIGAN AVENUE

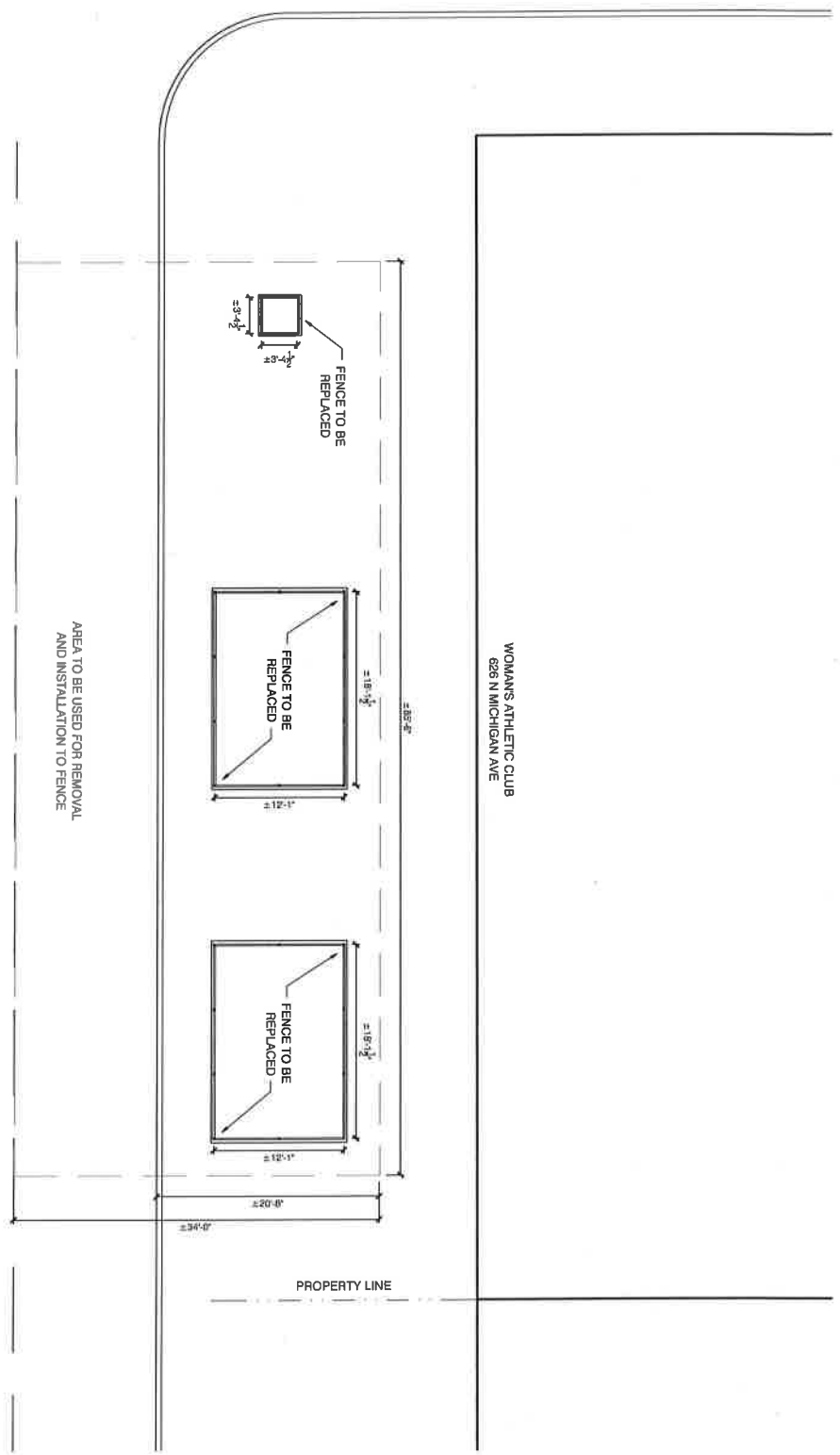

**WAC SIDEWALK FENCE**  
**SITE PLAN**  
SCALE: 3/32" = 1' - 0"  
28 APRIL 2017

# Woman's Athletic Club

LICHTEN CRAIG ARCHITECTURE + INTERIORS

**SKETCH**

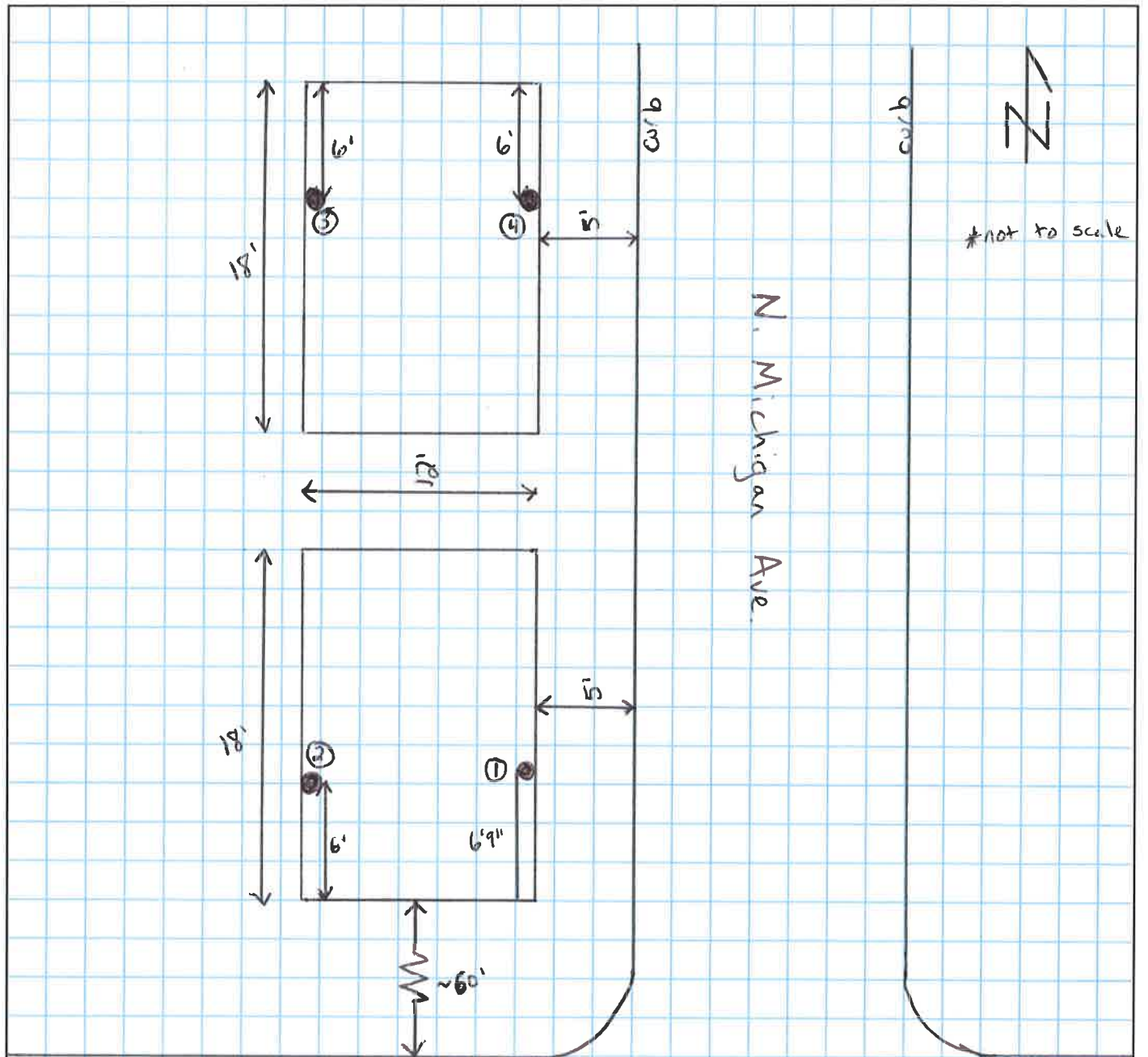

Ontario St.

Ludlum 2221 (SN 172039)  
 Threshold: 7,374 cpm shielded  
 Fld Background: 1,840 cpm shielded

Location	Depth	CPM (shielded)
①	0-30" (spoil)	1,900-3,200
②	0-30" (spoil)	1,900-2,900
③	0-30" (spoil)	2,900-4,100
④	0-16" (spoil)	2,800-7,200