



AECOM
100 S. Wacker Drive, Suite 500
Chicago, Illinois 60606

312-939-1000 tel
312-939-4198 fax

July 29, 2016

John Candelaria
City Lights, Ltd.
9993 Virginia Avenue
Chicago Ridge, IL 60415

RE: Radiological Survey of a Manhole Installation
Permit No.: DOT615440
Permit Address: 356 E. Grand Ave., Chicago, Illinois
AECOM Project No. 60513867

Dear Mr. Candelaria:

Pursuant to conditions specified in a permit (see attached) issued by the City of Chicago, radiation monitoring was required to be performed at the above referenced site. AECOM Technical Services, Inc. (AECOM) provided the required radiation surveillance on July 21, 2016 for an installation of an electrical conduit.

Surveying was performed within the excavation and on the spoil removed at 356 E. Grand Ave. (refer to sketch). The excavation involved removal of concrete and an additional trench excavation. City Lights removed a section of concrete 16-feet long by 12-feet wide. The additional trench excavation was within the removed concrete area and was approximately 16-feet long by 2-feet wide and to a depth of 38-inches below ground surface (bgs).

The monitoring did not indicate that the fill soils were above the removal action level established by the U.S. Environmental Protection Agency (USEPA) for the Streeterville area of Chicago. The USEPA removal action level for Chicago's Streeterville area is 7.1 picocuries per gram (pCi/g) total radium (Ra-226 + Ra-228). Gamma radiation count measurements for the project were recorded using Ludlum Models 2221 survey meter and an unshielded 2 x 2 inch NaI probe (Model 44-10). For the instrument used, the gamma count threshold indicative of the 7.1 pCi/g removal action level is 18,278 (S/N: 176944) counts per minute (cpm) unshielded. The field instrument background gamma reading collected for soil in the vicinity of the excavation area was 8,700 cpm.

The field gamma measurements within the excavations and of the spoil during the excavation process did not exceed the instrument threshold previously stated and ranged from a minimum of 5,000 cpm to a maximum of 9,600 cpm unshielded. Based on field observations there was no indication of the presence of radiologically-contaminated fill and/or an exceedance of the USEPA removal action level of 7.1 pCi/g total radium. A copy of the permit and a field sketch documenting the area where work was performed, have been included as attachments.

As part of the permit conditions, this letter has been forwarded to:

Chicago Department of Public Health
Attention: Ms. Rahmat Begum
333 South State Street, Room 200
Chicago, Illinois 60604

Permit No.: DOT615440
Permit Address: 356 E. Grand Ave.
Page 2

Please contact us with any questions you have regarding this letter or the reported results.

Regards,



Andrew Kozak
Geologist



Steven C. Kornder, Ph.D.
Senior Project Geoscientist

cc: Rahmat Begum, Chicago Department of Public Health
Verneta Simon, USEPA

Attachments: Permit
Sketch

PERMIT



DEPARTMENT OF PUBLIC HEALTH
CITY OF CHICAGO

(STREETERVILLE Right-of-Way)

Notice is hereby given that the site you have requested a permit for is recorded with the City of Chicago Department of Public Health (CDPH) as potentially having environmental contamination on the site and adjacent right-of way. This environmental contamination could present a threat to human health and safety in connection with work performed at the site, or in the adjacent right-of-way, if proper safeguards are not employed.

A file containing detailed information regarding the aforementioned environmental contamination is available for review at CDPH at 333 S. State St., Room 200, Chicago, Illinois 60604 during normal business hours (8:30AM-4:30PM, Monday through Friday). Contact (312) 745-3152 for an appointment. This file must be reviewed and the remainder of this form completed before the permit can be issued if the ground is exposed or excavated. Please note that for some locations, additional health and safety procedures may be required by law.

Please complete the following:

I have reviewed and understand the documents, maintained by CDPH, regarding environmental contamination of the site and adjacent right-of-way. Further, I will ensure that all work at the subject site and adjacent right-of-way, and any monitoring required including but not limited to radiation monitoring, will be performed in a manner that is protective of human health and the environment and in compliance with all applicable local, state, and federal laws, rules, and regulations, especially those pertaining to worker safety and waste management. I will ensure that the results of any radiation monitoring and/or surveying conducted shall be provided to the CDPH and the United States Environmental Protection Agency within two (2) weeks of their completion. If any elevated levels of radioactive material are detected, I will immediately contact the United States Environmental Protection Agency at (800) 424-8802.

Applicant Name (print): STEVEN HOFFMAN Signature: Steven J. Hoffman

Site Address and Work Location (Describe exact site location and attach map): 356 E. GRAND

Nature of Work: INSTALL CONDUIT AND SHELTER PAD

Company Name, Address, Phone No.: CITY LIGHTS LTD. 999 S. VIRGINIA AVE. CHICAGO RIDGE

General / Prime Contractor Name, Address, Phone No.: _____

Include subcontractor information if applicable

Safety Officer / Phone No. _____

Radiation Contractor / Phone No. and email address (if applicable) AE COM STEVO KORNER (262) 515-7700

Check if City Department Work Department Name: _____

CDOT Permit No.: DOT 615440

Today's Date: 7-8-16 Expected Start Date: 7-11-16 CDPH Approval / Date: J Sheehan 7/8/16

Please return this completed form to the Chicago Department of Transportation, Division of Infrastructure Management, Public Way Permit Office, City Hall - Room 905, 121 N. LaSalle St., Chicago, Illinois 60602 during normal business hours (8:30 AM - 4:30 PM, Monday through Friday)

For CDPH Use Only

Location: _____

Date: 2-11-2016

Bus Route No: 2, 29, 65, 66, 124

FS, WB
NWX

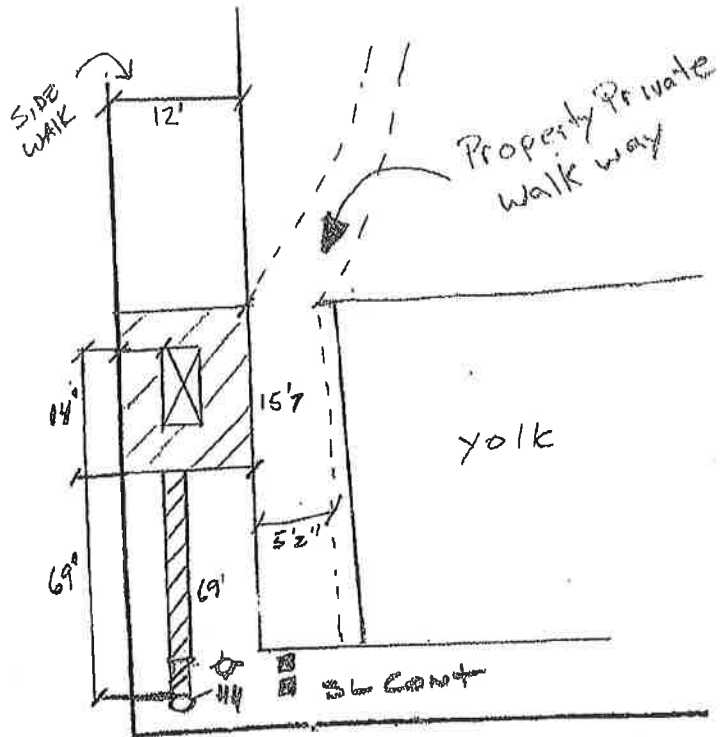
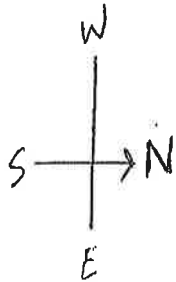

McClurg

Address 356 E Grand

Power Source _____

Sidewalk: (12'x15') (69'x3')

Concrete _____

Asphalt _____

Pad X

Street: Concrete _____

Asphalt _____

Alley: _____

Concrete _____

Asphalt _____

Curb _____

Options (Circle One)

1 2 3 AD UNIT

_____ Setback

| | | | |
|-----|---------|---------|----|
| | Actual | | |
| 420 | 70 x 6' | 69 x 5' | 24 |
| 192 | 12 x 16 | 12 x 16 | 19 |
| 612 | | | 43 |

Grand

Reviewed By:

CTA _____

CDOT Boz Miller

CDOT _____

SKETCH

JOB TITLE City Lights - 356 E. Grand Ave.
 JOB NO. 60513867 CALCULATION NO. _____
 ORIGINATOR A. Kozak DATE 7/21/16
 REVIEWER S. Koruder DATE 7/22/16
 SCALE not to scale SHEET NO. 1 OF 1

Survey Equipment

Lucilon 2221 S/N: 176944
 Probe 2x2 NaI S/N: RN21187
 unshielded : 18,278 cpm
 shielded : 6,123 cpm
 background : 8,700 cpm
 personnel: A. Kozak

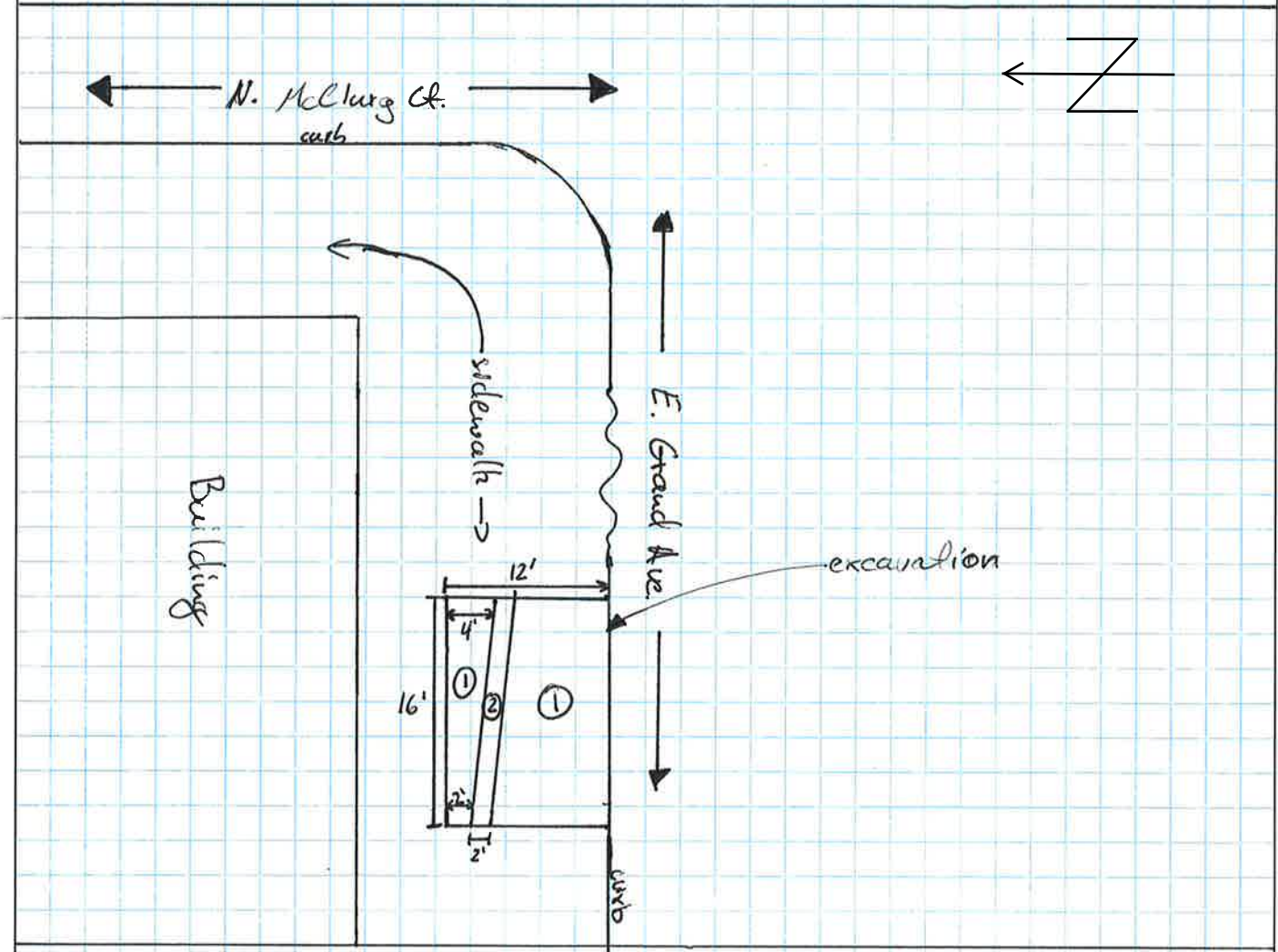

Readings

| <u>Depth</u> | <u>CPM</u> |
|-------------------------|---------------|
| ① 8" (beneath concrete) | 5,000 - 6,400 |
| ② 8"-38" (soil) | 6,400 - 7,800 |
| 38" (floor) | 8,200 - 9,600 |