



AECOM
100 S. Wacker Drive, Suite 500
Chicago, Illinois 60606

312-939-1000 tel
312-939-4198 fax

January 4, 2016

Mr. Mike Jouras
Peoples Gas Light & Coke Co.
Environmental Services Department
200 E. Randolph Street, 24th Floor
Chicago, IL 60601

RE: Radiological Survey of Right-of-Way Utility Excavation
Permit No.: DOT573514
Permit Address: 215 E. Grand Ave
AECOM Project No. 60157647

Dear Mr. Jouras:

Pursuant to conditions specified in a permit (see attached) issued by the City of Chicago, radiation monitoring was required to be performed at the above referenced site. AECOM Technical Services, Inc. (AECOM) provided the required radiation surveillance on December 16, 2015 for an emergency excavation on the street to address a service line gas leak.

Surveying was performed on the soil removed at 215 E Grand Ave. (see drawing and sketch) to a depth of 3-feet below ground surface (bgs) required to address an identified leak on an existing gas service line. The excavation activities included two adjacent excavations, approximately 5-foot long by 3.5-foot wide to a depth of 3-feet below ground surface (bgs).

The monitoring did not indicate that the fill and/or soil were above the removal action level established by the U.S. Environmental Protection Agency (USEPA) for the Streeterville area of Chicago. The USEPA removal action level for Chicago's Streeterville area is 7.1 picocuries per gram (pCi/g) total radium (Ra-226 + Ra-228). Gamma radiation count measurements for the project were made using Ludlum Model 2221 survey meter and an unshielded 2 x 2 inch NaI probe (Model 44-10). For the instrument used, the gamma count threshold indicative of the 7.1 pCi/g removal action level is 17,015 counts per minute (cpm) unshielded.

The field gamma measurements within the excavation during the excavation process did not exceed the instrument threshold previously stated and ranged from a minimum of 6,800 cpm to a maximum of 7,200 cpm unshielded. Thus, there was no indication of the presence of radiologically-contaminated material and/or an exceedance of the USEPA removal action level of 7.1 pCi/g total radium. A copy of the permit and a field sketch documenting the area where work was performed have been included as attachments.

As part of the permit conditions, this letter has been forwarded to:

Chicago Department of Public Health
Attention: Ms. Rahmat Begum
333 South State Street, Room 200
Chicago, Illinois 60604

Permit No.: DOT573514
Permit Address: 215 East Grand Avenue
Page 2

Please contact us with any questions you have regarding this letter or the reported results.

Regards,



Andrew Kozak
Environmental Engineer



Steven C. Kornder, Ph.D.
Senior Project Geoscientist

cc: Rahmat Begum, Chicago Department of Public Health
Verneta Simon, USEPA

Attachments: Permit

PERMIT



DEPARTMENT OF PUBLIC HEALTH
CITY OF CHICAGO

FORM NO. CDPH.ROW.03 (STREETERVILLE Right-of-Way)

Notice is hereby given that the site you have requested a permit for is recorded with the City of Chicago Department of Public Health (CDPH) as potentially having environmental contamination on the site and adjacent right-of way. This environmental contamination could present a threat to human health and safety in connection with work performed at the site, or in the adjacent right-of-way, if proper safeguards are not employed.

A file containing detailed information regarding the aforementioned environmental contamination is available for review at CDPH at 333 S. State St., Room 200, Chicago, Illinois 60604 during normal business hours (8:30AM-4:30PM, Monday through Friday). Contact (312) 745-3152 for an appointment. This file must be reviewed and the remainder of this form completed before the permit can be issued if the ground is exposed or excavated. **Please note that for some locations, additional health and safety procedures may be required by law.**

Please complete the following:

I have reviewed and understand the documents, maintained by CDPH, regarding environmental contamination of the site and adjacent right-of-way. Further, I will ensure that all work at the subject site and adjacent right-of-way, and any monitoring required including but not limited to radiation monitoring, will be performed in a manner that is protective of human health and the environment and in compliance with all applicable local, state, and federal laws, rules, and regulations, especially those pertaining to worker safety and waste management. I will ensure that the results of any radiation monitoring and/or surveying conducted shall be provided to the CDPH and the United States Environmental Protection Agency within two (2) weeks of their completion. If any elevated levels of radioactive material are detected, I will immediately contact the United States Environmental Protection Agency at (800) 424-8802.

Applicant Name (print): Maria G. Oliver Signature: Maria G. Oliver

Site Address and Work Location (Describe exact site location and attach map): 201-15 E. Grand Av.

Nature of Work: Emergency Leak

Company Name, Address, Phone No.: Peoples Gas, 200 E. Randolph (312) 240-4692

General / Prime Contractor Name, Address, Phone No.: Earl Michs (773) 542-7860

Include subcontractor information if applicable
Safety Officer / Phone No. Jerry Gross (773) 542-7927

Radiation Contractor / Phone No. (if applicable) Steve Kornder-AECOM Inc (262) 515-7700

Check if City Department Work Department Name: _____

CDOT Permit No.: DOT 573514

Today's Date: 12/16/15 Expected Start Date: 12/16/15 CDPH Approval / Date Rahmatunisa Bego
12/16/2015

Please return this completed form to the Chicago Department of Transportation, Division of Infrastructure Management, Public Way Permit Office, City Hall - Room 905, 121 N. LaSalle St., Chicago, Illinois 60602 during normal business hours (8:30 AM - 4:30 PM, Monday through Friday)

For CDPH Use Only

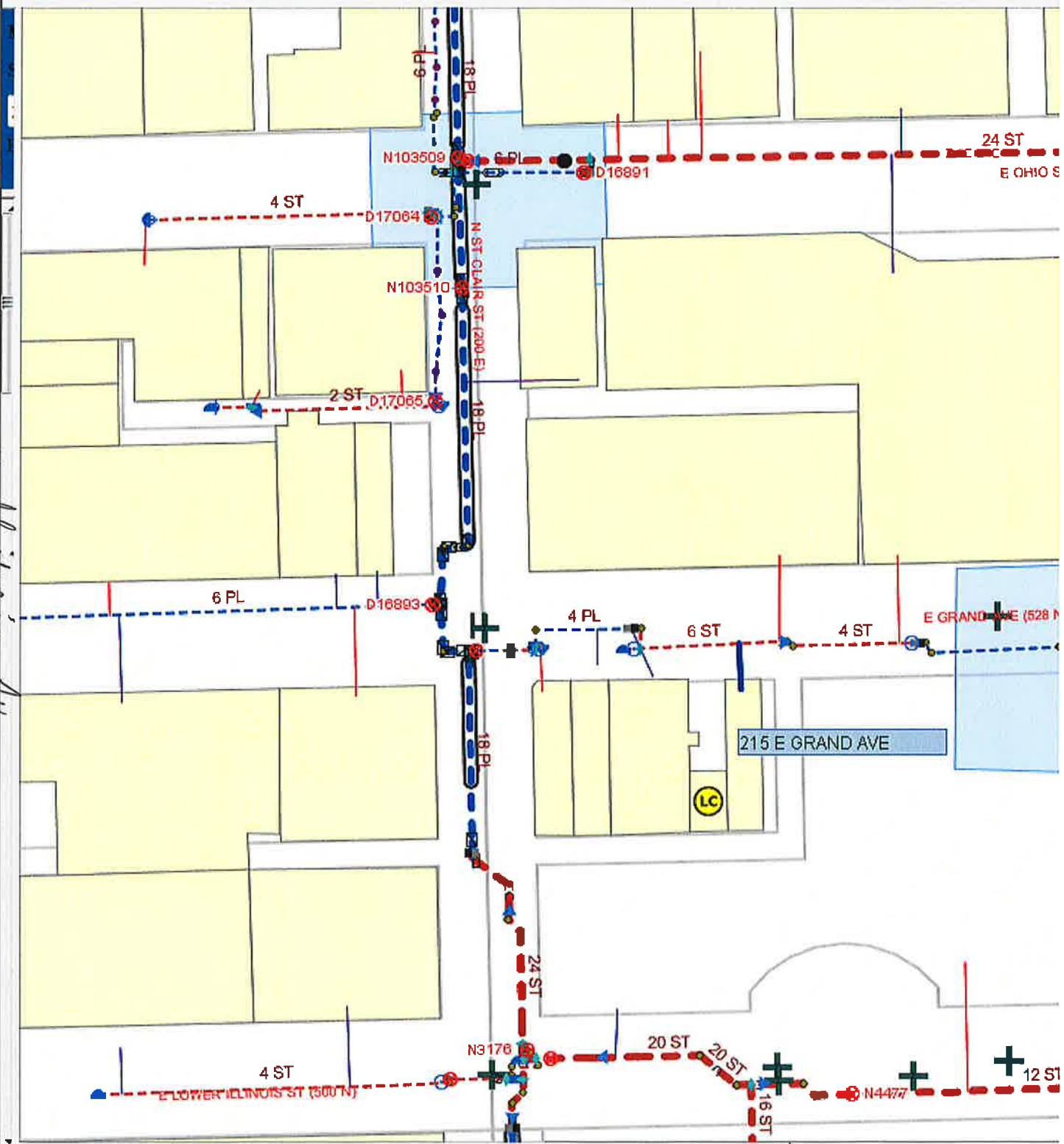

N. of Chicago Av.



SKETCH

JOB TITLE People's Gas - 215 East Grand Ave.
 JOB NO. 60157647 CALCULATION NO. _____
 ORIGINATOR Andrew Kozak DATE 10/16/15
 REVIEWER Steve Korndor DATE 12/30/15
 SCALE Not to Scale SHEET NO. 1 OF 1

Survey Equipment

Ludlum 2221 S/N: 172039
 Probe 2x3 NaI S/N: 174496
 unshielded: 17,015 cpm
 shielded: 6,684 cpm
 background (stone): 4,700 cpm

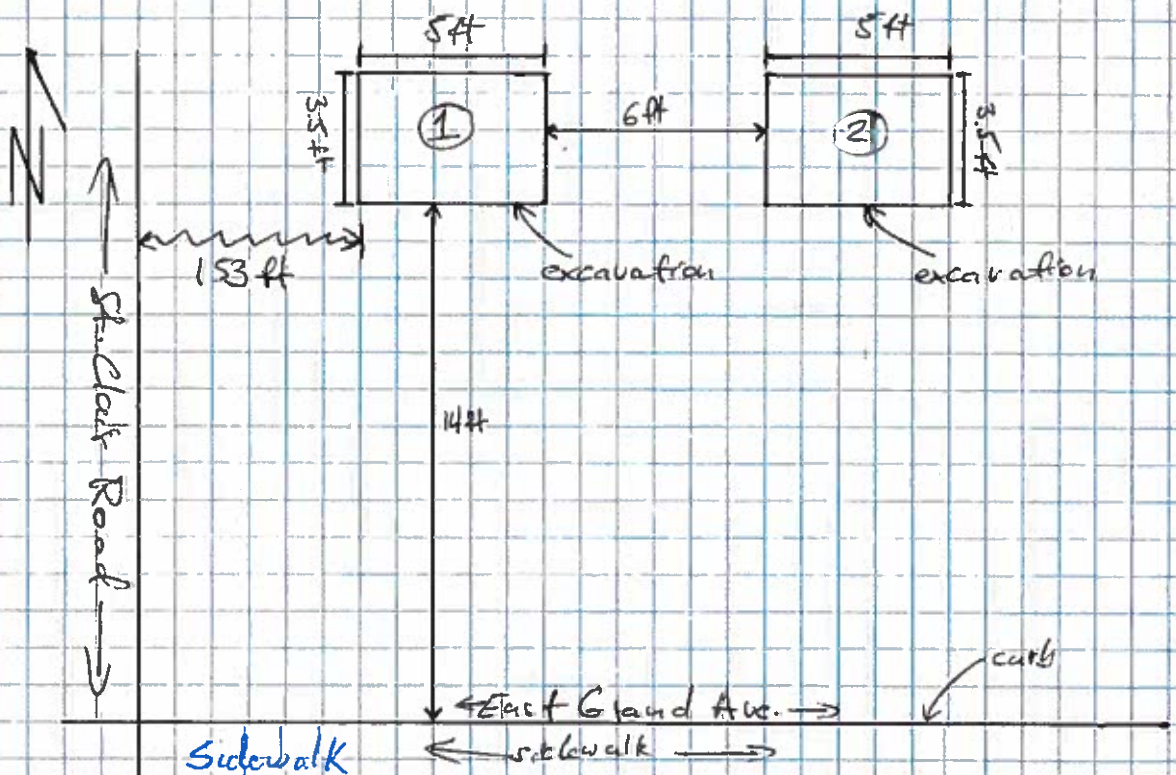

Survey Readings

Depth	CPM
① 0-3ft (spoils)	< 7,200 cpm
② 0-3ft (spoils)	< 6,800 cpm