

CHEMETCO

*Chemetco was a secondary copper smelter.
They refined brass and other metal-bearing
scrap MAINLY LEAD!*

*Anode Copper, crude Pb/Tn solder, ZnO and
Slag*

*They refined brass and other metal-bearing
scrap MAINLY LEAD!*

*Anode Copper, crude Pb/Tn solder, ZnO and
Slag*



CHEMETCO

LQG

Interim Status for ZnO Bunker (S03), ZnO pits, floor wash impoundments and cooling water canal (D83)

Newly discovered units (post 1996) Discharge Area (D83), refractory brick disposal (S03), Black Acid Tank (S02)

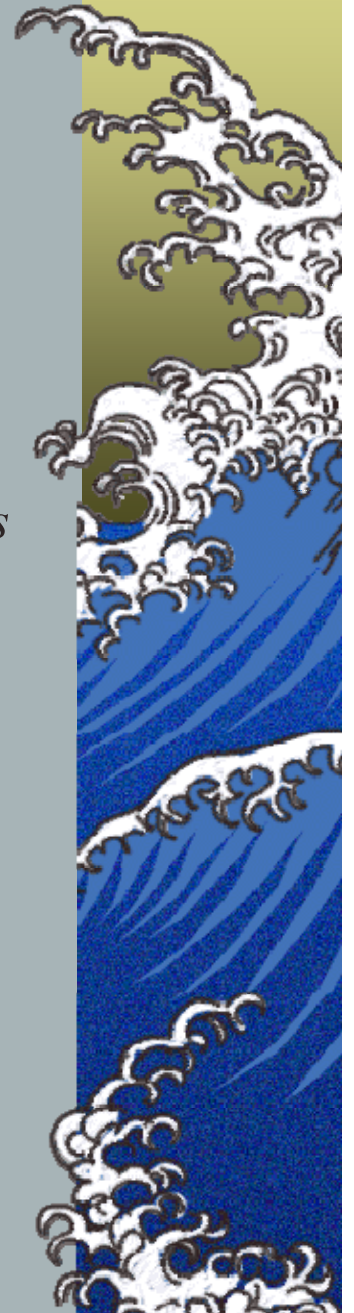

CHEMETCO

Waste Generated by Chemetco include

- 1. Baghouse Bags, Filter Press Cloths (D008 and D006)*
- 2. Absorbent and Oil (D008 and D006)*
- 3. Black pipe and Fire hose (D008)*
- 4. Refractory Brick (D006 and D008)*
- 5. Zinc Oxide in Bunker (D006 and D008)*
- 6. Used oil and oily water*



Process By-Products

1. *Secondary Copper Slag (D008)*
2. *Zinc Oxide from Baghouses (D008 and D006)*
3. *Zinc Oxide from wet scrubbers (D008 and D006)*
4. *Under sized slag fines (D008)*





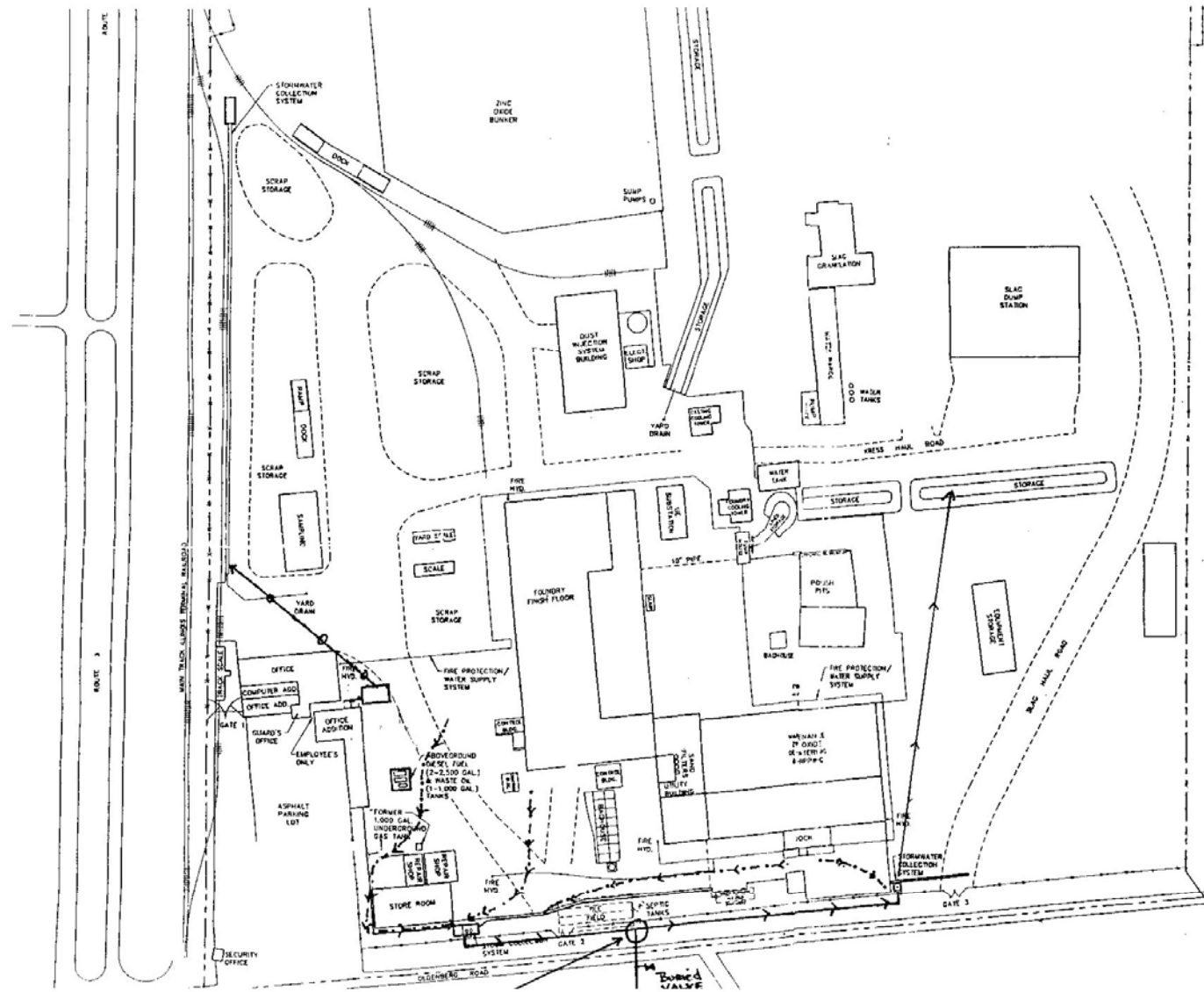

NOTE:
 THE FENCELINE
 MORE PROPER
 IS AGRICULTURE
 SOUTH IS A
 MORE FARM.
 TOTAL OWNER





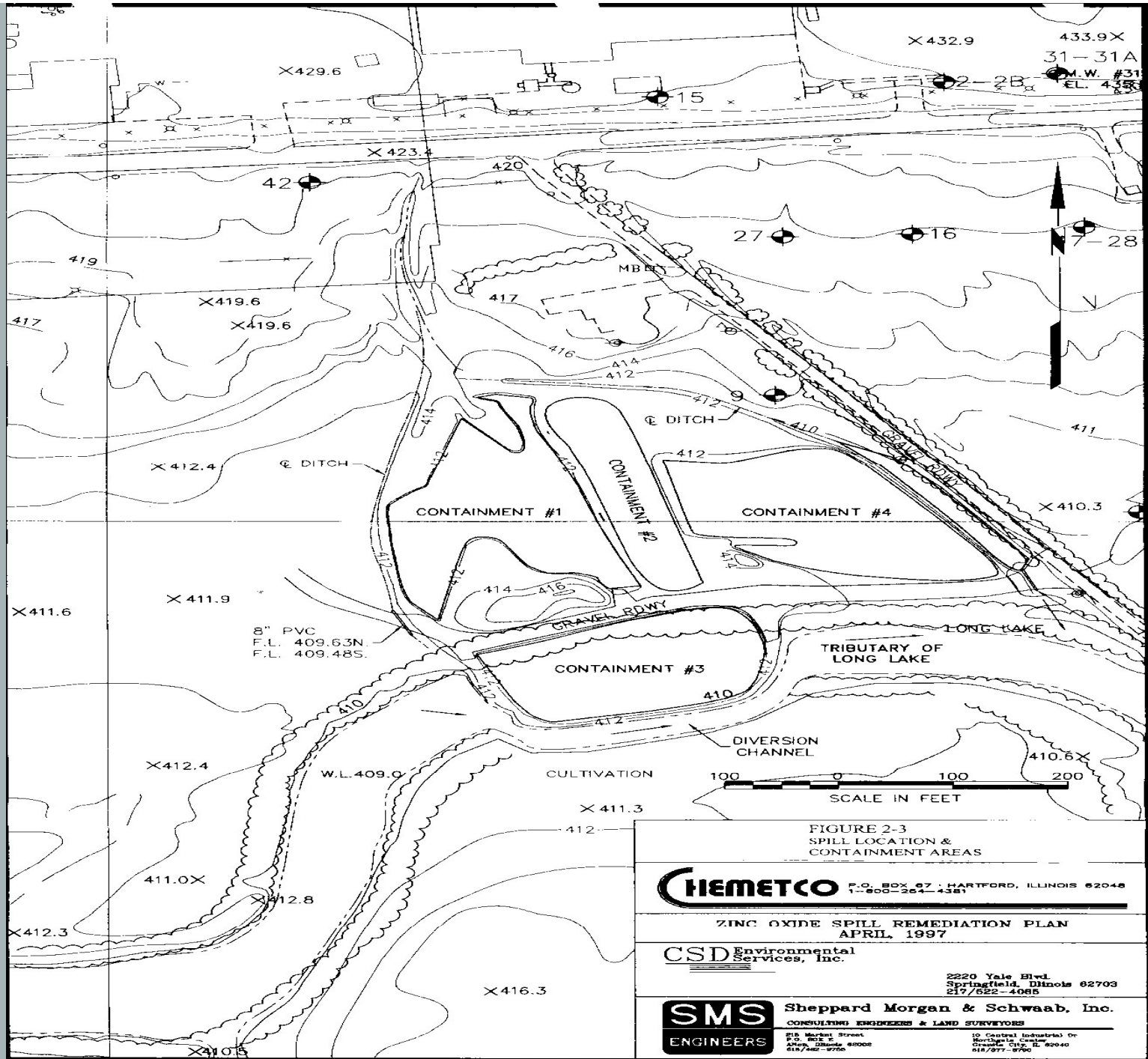

FIGURE 2-3
 SPILL LOCATION &
 CONTAINMENT AREAS

CHEMETCO P.O. BOX 67, HARTFORD, ILLINOIS 62048
 1-800-264-4381

ZINC OXIDE SPILL REMEDIATION PLAN
 APRIL, 1997

CSD Environmental
 Services, Inc.

2220 Yale Blvd.
 Springfield, Illinois 62703
 217/522-4085

SMS Sheppard Morgan & Schwaab, Inc.
 CONSULTING ENGINEERS & LAND SURVEYORS

P.O. Box 101
 215 North Street
 Ames, Iowa 50010
 515/242-9750

10 Central Expressway Dr.
 Greenville, S.C. 29604
 815/877-8700



