



AECOM  
303 E. Wacker Drive, Suite 900  
Chicago, Illinois 60601

312-938-0300 tel  
312-938-1109 fax

May 7, 2013

Mr. Mike Jouras  
People's Gas Light & Coke Co.  
Environmental Services Department  
130 East Randolph, 22nd Floor  
Chicago, IL 60601

RE: Radiological Survey of Right-of-Way Utility Excavation  
Permit No.: 360163706  
Permit Address: 350 East Ohio Street  
AECOM Project No. 60157647

Dear Mr. Jouras:

Pursuant to conditions specified in a permit (see attached) issued by the City of Chicago, radiation monitoring was required to be performed at the above referenced site. AECOM Technical Services, Inc. (AECOM) provided the required radiation surveillance on the day of May 3, 2013 for an excavation to install an anode to a gas service line for the address located at 350 E. Ohio St.

Surveying was performed for the soil removed from a 2-foot by 4-foot trench excavation within the sidewalk on the north side of Ohio Street (see sketch) to a depth of approximately 4-feet below ground surface, required for an anode installation on an existing gas service line. The monitoring revealed no indication of soils above the specified clean-up threshold established by the U. S. Environmental Protection Agency (USEPA) for the Streeterville area of Chicago. The USEPA threshold for Chicago's Streeterville area is 7.1 picocuries per gram (pCi/g total radium (Ra-226 + Ra-228)).

Gamma radiation count measurements for the project were made using Ludlum Model 2221 survey meter and an unshielded 2 x 2 NaI probe (Model 44-10). For the instrument used, the gamma count indicative of the 7.1 pCi/g threshold was 17,920 counts per minute (cpm) unshielded (6,425 cpm shielded). The field gamma background for the area was measured at approximately 7,700 cpm unshielded. The field gamma measurements within the excavation and the spoil materials generated during the excavation process did not exceed the respective threshold values previously stated and ranged from a minimum of 5,700 cpm to a maximum of 12,200 cpm unshielded. Thus, there was no indication of the presence of radiologically-contaminated material and/or an exceedance of the USEPA cleanup threshold of 7.1 pCi/g total radium.

As part of the permit conditions this letter has been forwarded to:

Chicago Department of Public Health  
Attn: Ms. Rahmat Begum  
333 South State Street, Rm. 200  
Chicago, Illinois 60604

Radiological Survey of Right-of-Way Utility Excavation  
Permit No.: 360163706  
Page 2

Please contact us with any questions you have regarding this letter or the reported results.

Regards,



Brian R. Schmidt  
Project Scientist II



Steven C. Kornder, Ph.D.  
Senior Project Geoscientist

cc: Rahmat Begum, Chicago Public Health  
Verneta Simon, USEPA

Attachments: Permit  
Sketch

**Permit # 360163706**

**AMENDED**



Received Date: Apr 11, 2013 4:40:0

**PEOPLES GAS LIGHT & COKE CO**  
**130 EAST RANDOLPH**  
**DRIVE**  
**CHICAGO, IL 60601**

**City of Chicago**  
**Department of Transportation**  
**(312) 744-4652**

**BUDZINSKI 773-542-7830**

**ACTIVITY HOURS**

See **RESTRICTIONS** for permitted hours

**DATES**

**Apr 23, 2013 through May 7, 2013**

**ACTIVITIES**

**Street Opening (Curb Lane):**

**Dig #: TBD**

There will be 1 opening(s) in the public way for the purpose: CORROSION -  
 INSTALL TEST LEAD & ANODE.

3 Feet x 5 Feet x 5 Feet

Excavation may commence on - NO SOONER.

350 E OHIO ST

WORK TO BE PERFORMED BY: MEADE ELECTRIC

@ 80 EE FAIRBANKS CT & 28 SN

MONDAY - FRIDAY, 9:30 AM - 3:30 PM

SAT - SUN, 8 AM - 4 PM

MUST MAINTAIN A MINIMUM OF TWO EASTBOUND LANE AT ALL  
 TIMES

RESTORATION REQUIREMENTS - 15X24 ( 1/2 PT

**Street Opening (Curb Lane):****Dig #: TBD**

OK INSPECTOR R. VINION ON 1/31/13

OK M SIMON

OK TO RELEASE PER RAHMAT BEGUM ON 4/15/13

**Restrictions:**

1. A copy of the permit must remain on-site for inspector's review.
2. Permit fees must be paid within 24 hours of the date of issuance. Failure to pay will result in you being considered in violation of the terms and agreement of the permit and subject to any applicable fine and fees as if you never attained a permit. Additionally, you will still be responsible for the cost of the original permit. Monthly billing accounts are not applicable to the 24 hour payment criteria but failure to pay the monthly bill by the due date will result in the same penalties applying.
3. All directional boring must be pre-approved by the Office of Underground Coordination.
4. Contractor must secure plating over all openings in the roadway and secure all sidewalk/parkway openings during non-working hours until such time when the road surface is restored.
5. All traffic control will be the responsibility of the contractor and must comply with all MUTCD standards.
6. Restore all lanes to normal operation during non-working hours.
7. Must use flagmen and/or arrow boards to maintain traffic operations through the work zone.
8. Contractor must notify DIGGER at 312-744-7000 no less then 48 hours (exclusive of Saturdays, Sundays and Holidays) but no more then 14 calendar days in advance of the start of the excavation or demolition, unless the excavation date was provided with the application and remains unchanged. Prior to 26 calendar days the Contractor must notify DIGGER to renewal the dig date!
9. It is the Excavator's responsibility to request refreshing of marks when needed, but no longer than 28 calendar days after the last requested date.
10. When applicable, all excavation areas are to be clearly marked in safety white paint prior to calling DIGGER. White paint is not required for joint meets or emergency work.
11. Excavators requesting dig tickets are responsible for the protection of utility markings at the job site. Any markings of underground utilities utilizing utility colors, must be done by facility owners or authorized agents only.
12. Use of pneumatic equipment must not begin before 8:00 A.M. or continue after 8:00 P.M.
13. Permittee must provide a sign which identifies the telephone number and company or person performing the work. Signage may be affixed to barricades.
14. Work to be performed as per plans and specifications.
15. All pavements and pavement markings are to be restored in accordance with CDOT

**Restrictions:**

Construction Standards.

16. All street openings must be restored with concrete base to grade.
17. Permanent base pavement restoration to follow within 5 days after the completion of underground work.
18. WARNING: THIS WORKSITE(S) CONTAINS RADIOACTIVE MATERIAL. ANY QUESTIONS PERTAINING TO HANDLING OF MATERIALS, CONTACT THE DEPT. OF ENVIRONMENT AT 312-744-3152.
19. Contractors to post signs to indicate: BIKE LANE CLOSED - SHARED LANE YIELD TO BIKES.

It is also the permit holder's responsibility to restore to original condition any damage to any bikeway, including replacement pavement markings and signage. You must contact Ben Gomberg (312) 744-8093 48 hours in advance of any activity.

20. No work in or use of the public right of way is to be done when a special event is taking place. It is up to the applicant to determine if an event is scheduled. To obtain a listing of programs or events within the City of Chicago please dial 311 when you are within the City boundaries.
21. It is the responsibility of the applicant to fund Traffic Control Aides if the City deems it necessary due to heavy congestion situations.
22. Pursuit to City Ordinances 10-20-150 and 10-28-281.3 a re-inspection fee of \$100 may be assessed for each inspection conducted after the initial inspection.
23. All metal plates used for public way construction or placed within the right-of-way must indicate Ownership!

**Street Opening (Curb Lane)**

04-23-2013 - Fee Pavement Opening

CBD:	Y	Cost Per EA:	\$ 411.00	CAPS:	300-84-2135-256
Tiered:	N	# Of EA:	1.00	Late charge:	\$ .00
Mora:	N			Amount:	\$ 411.00

**Total Fees: \$ 411.00**

PEOPLES GAS LIGHT & COKE CO

Permit # 360163706

Counter

Page #: 3

5211927387

**Grand Total Fees: \$ 411.00**

**Affected CUAN Sites: 7, 15, 18, 21, 22, 24, 28, 29, 31, 34, 36, 38, 53, 61, 68, 70, 141, 147**

**EFFECTIVE DATES OF PERMIT**

Current: Apr 23, 2013 through May 07, 2013 ( Input date: Apr 11, 2013 1:09:43 p.m. )

Previous: Apr 11, 2013 through May 07, 2013 ( Input date: Apr 23, 2013 1:09:32 p.m. )

Previous: Apr 11, 2013 through Apr 25, 2013 ( Input date: Apr 11, 2013 4:40:00 p.m. )

**END OF PERMIT**

JOB TITLE Integrals - 350 E. Ohio St.

JOB NO. 60157647 T.42 CALCULATION NO. \_\_\_\_\_

ORIGINATOR Brian Schmitt DATE 5/3/13

SHEET 1 OF 1

REVIEWER Brian Schmitt DATE 5/3/13

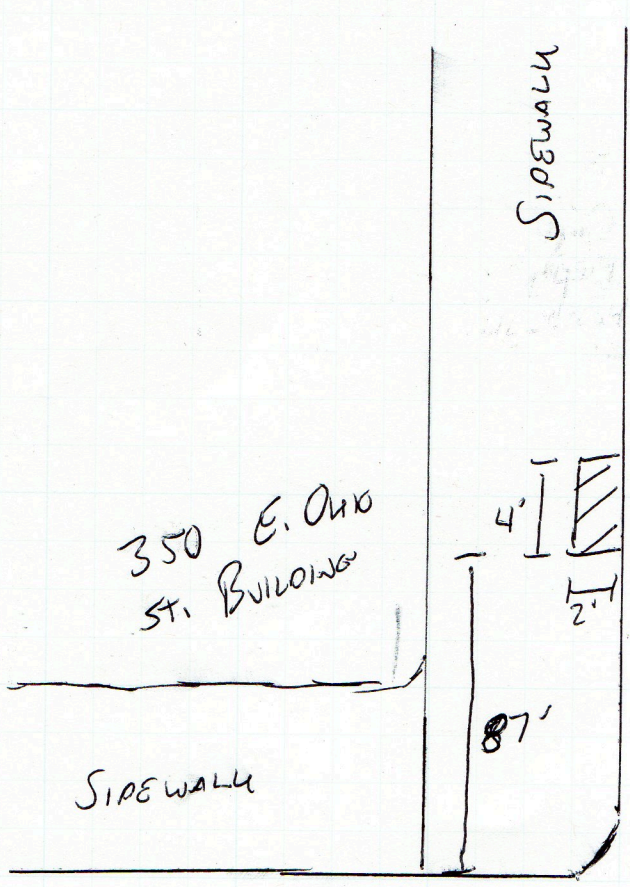
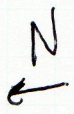

EXCAVATION VALUES (CPM)

DEPTH	COUNTS PER MINUTE
0-6"	CONCRETE
6-24"	5700
24-42"	7700
36-54"	9900
46-64"	12200

OHIO St.

BACKGROUND = 7700 cpm  
 LUOLVM - 2221 w/ 2x2  
 NAL PROBE  
 SERIAL # 176944  
 CUT-OFF VALUE = 17920  
 UNSHIELDED

FAIRBANKS St.