



AECOM
303 E. Wacker Drive, Suite 900
Chicago, Illinois 60601

312-938-0300 tel
312-938-1109 fax

April 23, 2013

Ms. Michele Pisterzi
AT&T Illinois
2427 Union Street
Blue Island, Illinois 60406

RE: Radiological Survey of Right-of-Way Utility Excavation
Permit No.: 354586920
Permit Address: 205-207 E. Grand Ave.
AECOM Project No. 60163572

Dear Ms. Pisterzi:

Pursuant to conditions specified in a permit (see attached) issued by the City of Chicago, radiation monitoring was required to be performed at the above referenced site. AECOM Technical Services, Inc. (AECOM) provided the required radiation monitoring on the day of February 26, 2013 for a trench excavation to install a telephone communications service package.

Surveying was conducted in 18-inch lifts for soils removed from an approximately 3-foot wide by 7-foot long trench excavation to a depth of 33-inches in the Right of Way (See Sketch), required for the installation of a telephone communications service package. The monitoring revealed no indication of soils above the specified clean-up threshold established by the U.S. Environmental Protection Agency (USEPA) for the Streeterville area of Chicago. The USEPA threshold for Chicago's Streeterville area is 7.1 picocuries per gram (pCi/g total radium (Ra-226 + Ra-228)).

Gamma radiation count measurements for the project were made using a Ludlum Model 2221 survey meter and an unshielded 2 x 2 NaI probe (Model 44-10). For the instrument used, the gamma count indicative of the 7.1 pCi/g threshold was 17,920 counts per minute (cpm) unshielded. The field gamma background for the area was measured at approximately 6,100 cpm unshielded. The field gamma measurements within the excavation and the spoil materials generated during the excavation process did not exceed the respective threshold values previously stated and ranged from a minimum of 6,200 cpm to a maximum of 8,200 cpm unshielded. Thus, there was no indication of the presence of radiologically-contaminated material and/or an exceedance of the USEPA cleanup threshold of 7.1 pCi/g total radium.

As part of the permit conditions this letter has been forwarded to:

Chicago Department of Public Health
Attn: Ms. Rahmat Begum
333 South State Street, Rm. 200
Chicago, Illinois 60604

Please contact us with any questions you have regarding this letter or the reported results.

Regards,

Brian R. Schmidt
Project Scientist II

Steven C. Kornder, Ph.D.
Senior Project Geoscientist

cc: Rahmat Begum, Chicago Department of Public Health
Verneta Simon, USEPA

Attachments: Permit
Sketch

Alley Opening - Improved:

Dig #: TBD

205 - 207 E GRAND AV

Restrictions:

1. A copy of the permit must remain on-site for inspector's review.
2. Permit fees must be paid within 24 hours of the date of issuance. Failure to pay will result in you being considered in violation of the terms and agreement of the permit and subject to any applicable fine and fees as if you never attained a permit. Additionally, you will still be responsible for the cost of the original permit. Monthly billing accounts are not applicable to the 24 hour payment criteria but failure to pay the monthly bill by the due date will result in the same penalties applying.
3. All directional boring must be pre-approved by the Office of Underground Coordination.
4. Contractor must secure plating over all openings in the roadway and secure all sidewalk/parkway openings during non-working hours until such time when the road surface is restored.
5. Contractor must notify DIGGER at 312-744-7000 no less than 48 hours (exclusive of Saturdays, Sundays and Holidays) but no more than 14 calendar days in advance of the start of the excavation or demolition, unless the excavation date was provided with the application and remains unchanged. Prior to 26 calendar days the Contractor must notify DIGGER to renew the dig date!
6. It is the Excavator's responsibility to request refreshing of marks when needed, but no longer than 28 calendar days after the last requested date.
7. Excavators requesting dig tickets are responsible for the protection of utility markings at the job site. Any markings of underground utilities utilizing utility colors, must be done by facility owners or authorized agents only.
8. When applicable, all excavation areas are to be clearly marked in safety white paint prior to calling DIGGER. White paint is not required for joint meets or emergency work.
9. Must maintain minimum of a 10 foot clearance at all times, otherwise a Full Closure permit is required.
10. Permittee must provide a sign which identifies the telephone number and company or person performing the work. Signage may be affixed to barricades.
11. Use of pneumatic equipment must not begin before 8:00 A.M. or continue after 8:00 P.M.
12. Alley pavement restoration is to follow within five days after the completion of underground work, weather permitting.
13. All street openings must be restored with concrete base to grade.
14. All pavements and pavement markings are to be restored in accordance with CDOT Construction Standards.
15. Work area to be backfilled to grade or plated when site is unattended.

Restrictions:

16. No work in or use of the public right of way is to be done when a special event is taking place. It is up to the applicant to determine if an event is scheduled. To obtain a listing of programs or events within the City of Chicago please dial 311 when you are within the City boundaries.
17. It is the responsibility of the applicant to fund Traffic Control Aides if the City deems it necessary due to heavy congestion situations.
18. Pursuit to City Ordinances 10-20-150 and 10-28-281.3 a re-inspection fee of \$100 may be assessed for each inspection conducted after the initial inspection.

Affected CUAN Sites: 7, 15, 18, 21, 22, 24, 28, 29, 31, 34, 36, 38, 53, 61, 68, 70, 141, 147

EFFECTIVE DATES OF PERMIT

Current: Feb 14, 2013 through Feb 28, 2013 (Input date: Feb 14, 2013 5:11:07 p.m.)
Previous: Feb 14, 2013 through Mar 14, 2013 (Input date: Feb 14, 2013 5:10:59 p.m.)

END OF PERMIT

JOB TITLE 200 E. GRAND AVE. - ALLEY SERVICE INSTALL
 JOB NO. 8344093 T. 9090 CALCULATION NO. _____
 ORIGINATOR BRIAN SCHMIDT DATE 2/26/13
 REVIEWER STEVE KOLSDEN DATE 2/26/13
 SCALE N/A SHEET NO. 1 OF 1

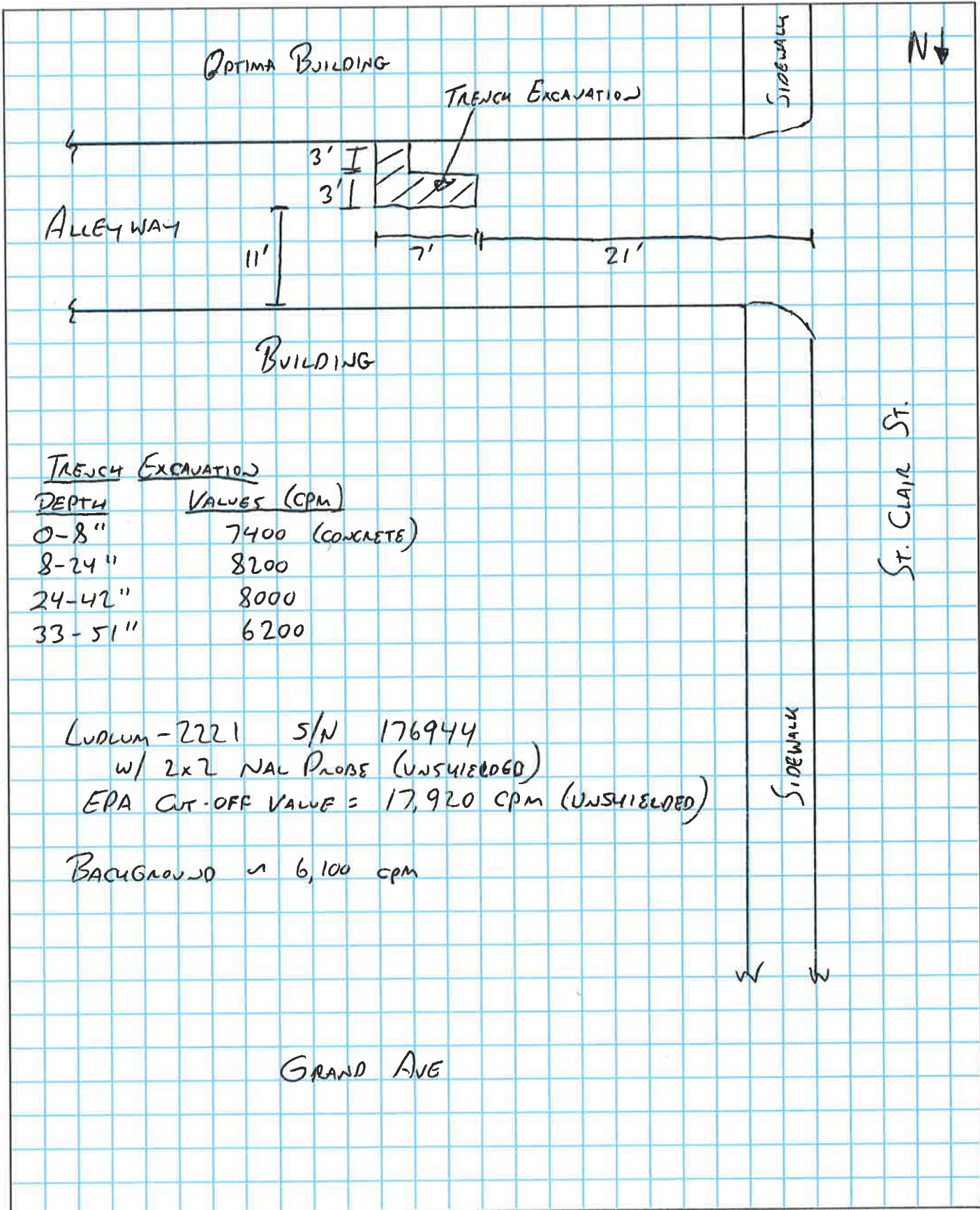

TRENCH EXCAVATION

<u>DEPTH</u>	<u>VALUES (CPM)</u>
0-8"	7400 (CONCRETE)
8-24"	8200
24-42"	8000
33-51"	6200

LUDLUM-2221 S/N 176944
 w/ 2x2 NAL PROBE (UNSHIELDED)
 EPA CUT-OFF VALUE = 17,920 CPM (UNSHIELDED)
 BACKGROUND ~ 6,100 CPM

GRAND AVE