



August 11, 2025

705369

Joe Carroll
CMMR, LLC
9847 S. Oakley Ave.
Chicago, IL 60643

RE: Thorium Monitoring – 455-457 E. Ontario St.
CDOT Permit: 2139844

Dear Mr. Carroll:

Stan A. Huber Consultants, Inc (SAHCI) was hired by your firm to provide radiation monitoring during excavation for an installation of a sidewalk electrical conduit at 455-457 E. Ontario St. in Chicago, Illinois. The monitoring was performed by Glenn Huber and Bethany Tennyson, SAHCI Health Physicists, on August 9, 2025.

Instrumentation

Surface gamma scans were performed using a Ludlum Model 2221 Scaler / Ratemeter (serial no. 134542) with attached Ludlum Model 44-10 2"x2" NaI Detector (w/ 6" collimated lead shield). The instrument was calibrated on May 6, 2025. The US Environmental Protection Agency (USEPA) action level of 7.1 picocuries per gram (pCi/g) total thorium for this instrument is 6,898 counts per minute (cpm).

The average background count rate for this location was 1,855 cpm.

Soil Gamma Scans

Gamma surface scans were performed using the Ludlum Model 2221 Scaler / Ratemeter described above. Survey data was collected by scanning the surface of the sidewalk of the planned excavation trench prior to removal and again after the concrete was removed to a maximum depth of 12" below ground surface. The trench was 20 feet long by 1 foot wide and connected two existing tree planters.

The maximum gamma count rate for the single lift was recorded on the attached Radiation Survey Form. The count rates ranged from 2,100 cpm to 2,700 cpm. No count rates were found at any time that exceeded the threshold limit of 6,898 cpm.

Additional Monitoring

Since no count rates were identified above the 7.1 pCi/gram threshold limit, no additional soil sampling, air monitoring, or personnel monitoring were performed.

I will be providing a copy of this report to both the City of Chicago Department of Public Health and US Environmental Protection Agency, as required.

Thank you for your assistance with this project. If you have any questions or need additional information, please call me at (815) 485-6161.

Sincerely,
Stan A. Huber Consultants, Inc.

A handwritten signature in black ink, appearing to read 'Glenn Huber', with a stylized flourish at the end.

Glenn Huber, CHP
President

Radiation Survey Form

Location/ Project ID: 455- 457 E. Ontario St. EMMR Sidewalk Conduit Install

Date: 8/9/25

Technician: Bethany Tennyson

Inst Model: Ludlum 2221

Serial No. : 134542

Probe Type: 1"x1" NaI / 2"x2" NaI
Shielded / Not Shielded

Lift Elevation: Surface to -1'

Background 1,855 cpm

Action Level: 6,898 cpm

Write grid designations in circles. Record highest counts for grid in cpm. Record 30 second counts at grid intersections (if required). Shade areas of elevated counts and record max cpm.

N

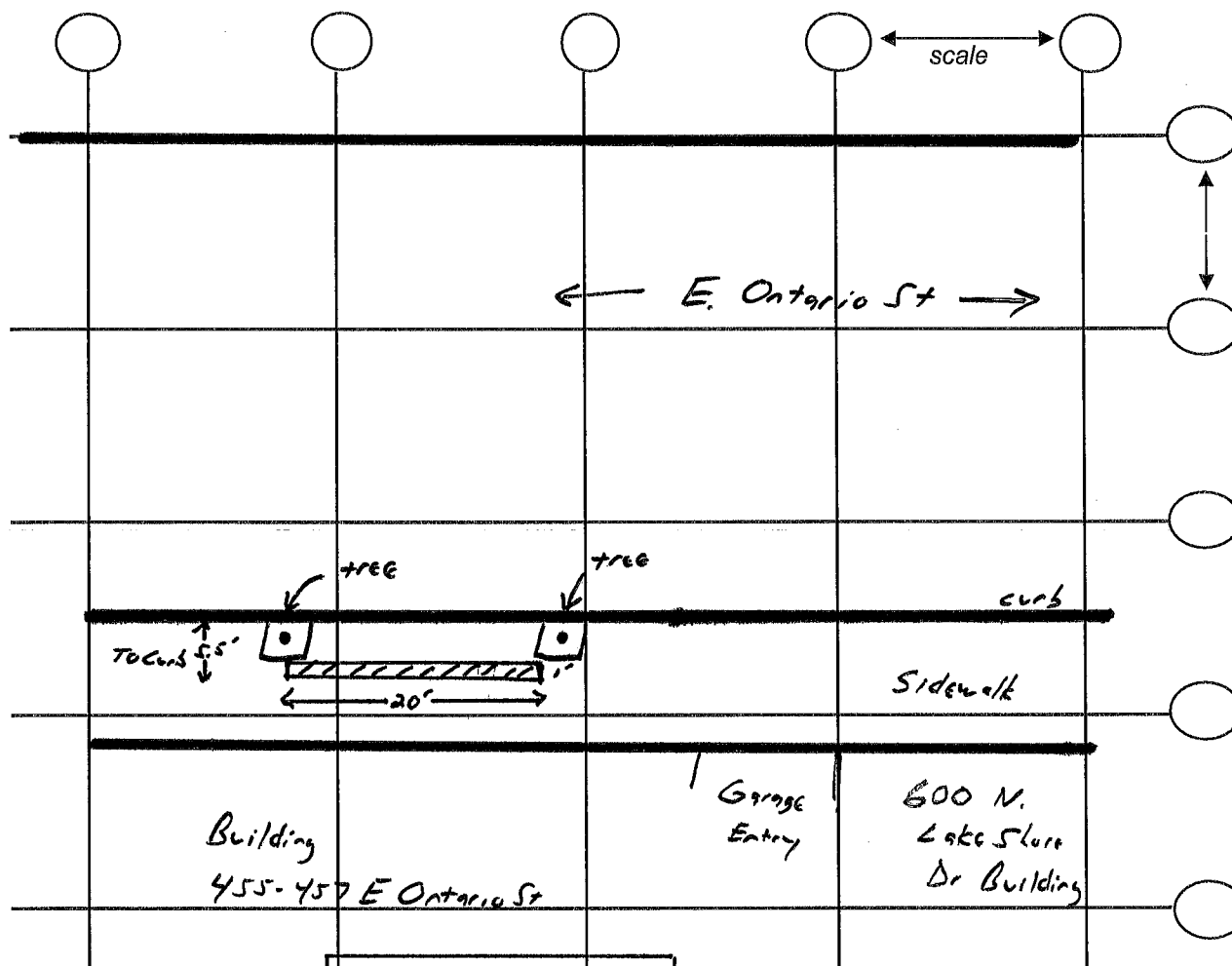

Depth	cpm
Surface	2100
-1'	2700

= Excavated area
9/6/9