



August 3, 2025

705364

Angel Camacho
SET Environmental
450 Sumac Road
Wheeling, Illinois 60090

RE: Thorium Monitoring – City of Chicago Department of Fleet and Facilities
Management (2FM)
CDOT Permit No. 2077194 – 233 E. Riverwalk (Northman)

Dear Mr. Camacho:

Stan A. Huber Consultants, Inc (SAHCI) was hired by your firm to provide radiation monitoring during the excavation for an non-structural concrete slab at 330 E. Riverwalk (Northman) in Chicago, Illinois. The monitoring was performed by Bethany Tennyson, SAHCI Health Physicist, on July 25, 2025. All activities were conducted under the guidance of document *SET General Procedure for Thorium Monitoring*.

Instrumentation

Surface gamma scans were performed using a Ludlum Model 2221 Scaler / Ratemeter (serial no. 134542) with attached 2"x2" NaI probe (w/ 6" collimated lead shield). The instrument was calibrated on May 6, 2025. The US Environmental Protection Agency (USEPA) action level of 7.1 picocuries per gram (pCi/g) total thorium for this instrument is 6,898 counts per minute (cpm).

The average background count rate for this location was determined to be 1,730 cpm.

Soil Gamma Scans

Gamma surface scans were performed using the Ludlum Model 2221 Scaler / Ratemeter described above. Survey data was collected by scanning the surface of the planned concrete pad area before and after soil removal at 8 inches maximum below ground surface.

The maximum gamma count rate for each lift was recorded on the attached Radiation Survey Form. The count rates ranged from 2,100 cpm to 3,400 cpm. No count rates were found at any time that exceeded the threshold limit of 6,898 cpm.

Additional Monitoring

Since no count rates were identified above the 7.1 pCi/gram threshold limit, no additional soil sampling, air monitoring, or personnel monitoring were performed.

I will be providing a copy of this report to both the City of Chicago Department of Public Health and US Environmental Protection Agency, as required.

Thank you for your assistance with this project. If you have any questions or need additional information, please call me at (815) 485-6161.

Sincerely,
Stan A. Huber Consultants, Inc.

A handwritten signature in black ink, appearing to read 'Glenn Huber', with a long horizontal flourish extending to the right.

Glenn Huber, CHP
President

Radiation Survey Form

Location/ Project ID: 233 E. Riverwalk (2FM - Northman)

Date: 7/25/25

Technician: Bethany Tennyson

Inst Model: Ludlum 2221

Serial No. : 134542

Probe Type: 1"x1" NaI / (2"x2" NaI)
Shielded / Not Shielded

Lift Elevation: Surface to -8"

Background 1,730 cpm

Action Level: 6,898 cpm

Write grid designations in circles. Record highest counts for grid in cpm. Record 30 second counts at grid intersections (if required). Shade areas of elevated counts and record max cpm.

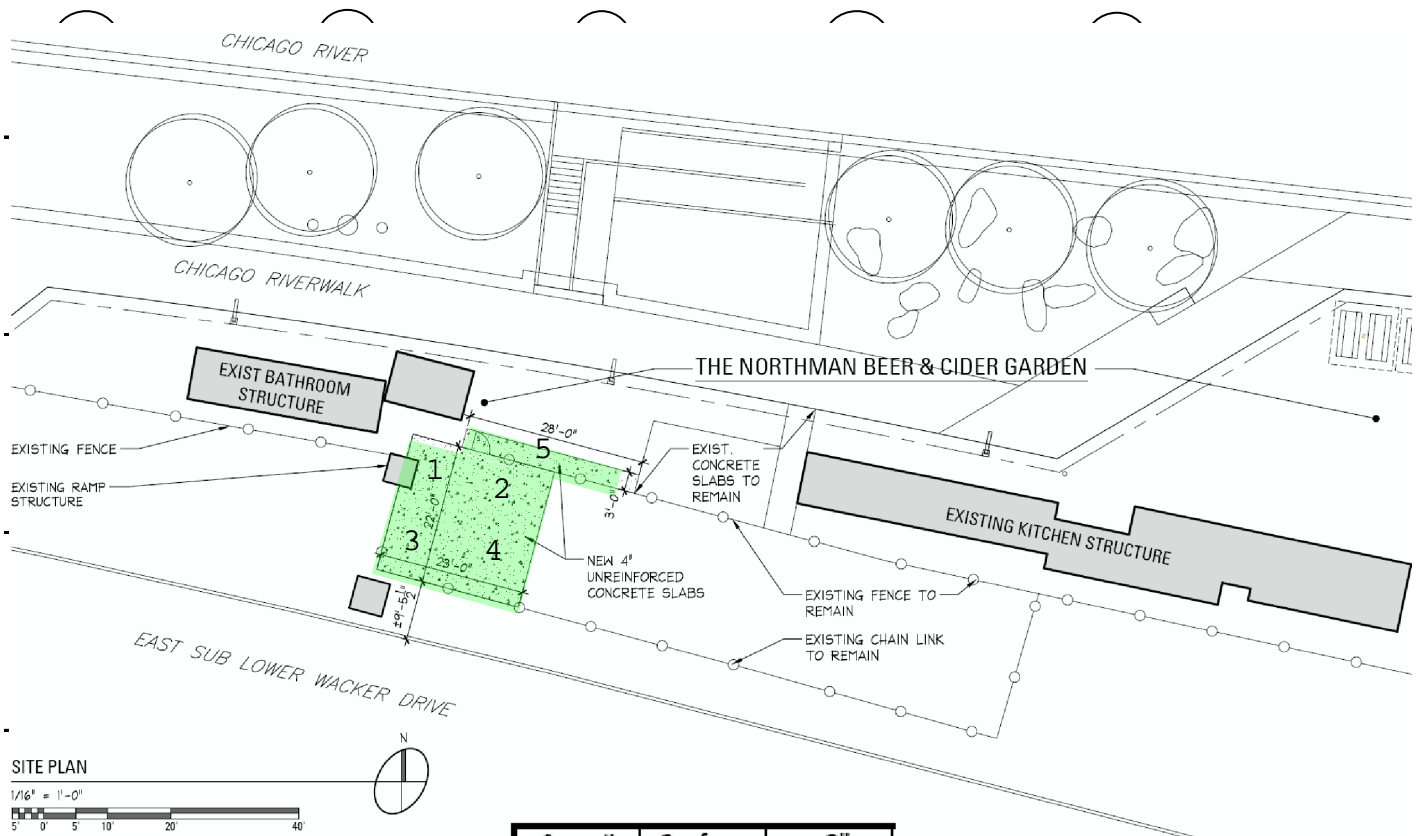

Area #	Surface	-8"
1	2400	2400
2	2500	2500
3	2200	2400
4	2100	3400
5	2500	2600

All results in cpm