



AECOM  
303 E Wacker Drive, Suite 900  
Chicago, Illinois 60601

312-938-0300 tel  
312-938-1109 fax

February 29, 2012

Mr. Narendra Prasad  
People's Gas Light & Coke Co.  
Environmental Services Department  
130 East Randolph, 22nd Floor  
Chicago, IL 60601



RE: Radiological Survey of Right-of-Way Utility Excavation  
Permit No.: 254079126  
Permit Address: 150-152 East Ontario Street  
AECOM Project No. 60157647

Dear Mr. Prasad:

Pursuant to conditions specified in a permit (see attached) issued by the City of Chicago, radiation monitoring was required to be performed at the above referenced site. AECOM Technical Services, Inc. (AECOM) provided the required radiation surveillance on February 29, 2012 for an excavation to install an anode along a section of gas main.

Surveying was performed for the soil removed from a 2-foot by 4-foot excavation to a depth of 3-feet below ground surface required for installation of an anode along a section of gas main. The monitoring revealed no indication of soils above the specified clean-up threshold established by the U. S. Environmental Protection Agency (USEPA) for the Streeterville area of Chicago. The USEPA cleanup threshold for Chicago's Streeterville area is 7.1 picocuries per gram (pCi/g total radium (Ra-226 + Ra-228)).

Gamma radiation count measurements for the project were made using Ludlum Model 2221 survey meter and an unshielded 2 x 2 NaI probe (Model 44-10). For the instrument used, the gamma count indicative of the 7.1 pCi/g threshold was 19,969 counts per minute (cpm) unshielded (7,127 cpm shielded). The field gamma background for the area was measured at approximately 6,700 cpm unshielded. The field gamma measurements within the excavation and the spoil materials generated during the excavation process did not exceed the respective threshold value previously stated and ranged from a minimum of 7,400 cpm to a maximum of 9,600 cpm unshielded. Thus, there was no indication of the presence of radiologically-contaminated material and/or an exceedance of the USEPA cleanup threshold of 7.1 pCi/g total radium.

As part of the permit conditions this letter has been forwarded to:

Chicago Department of Environment  
Attention: Ms. Rahmat Begum  
30 North LaSalle Street, 2<sup>nd</sup> Floor  
Chicago, Illinois 60602

Radiological Survey of Right-of-Way Utility Excavation  
Permit No.: 254079126  
Page 2

Please contact us with any questions you have regarding this letter or the reported results.

Regards,



Brian R. Schmidt  
Project Scientist II



Steven C. Kornder, Ph.D.  
Senior Project Geoscientist

cc: Rahmat Begum, Chicago Department of Environment  
Verneta Simon, USEPA

Attachments: Permit  
Sketch

CITY OF CHICAGO DEPARTMENT OF ENVIRONMENT  
FORM NO. DOE.ROW.03

Notice is hereby given that the site you have requested a permit for is recorded with the City of Chicago Department of Environment as potentially having environmental contamination on the site and adjacent right-of-way. This environmental contamination could present a threat to human health and safety in connection with work performed at the site, or in the adjacent right-of-way, if proper safeguards are not employed.

A file containing detailed information regarding the aforementioned environmental contamination is available for review at the Department of Environment at 33 N. LaSalle St., Suite LL-120, Chicago, Illinois 60602 during normal business hours (8:30AM-4:30PM, Monday through Friday). Contact (312) 744-7606 for an appointment. This file must be reviewed and the remainder of this form completed before the permit can be issued if the ground is exposed or excavated. Please note that for some locations, additional health and safety procedures may be required by law.

Please complete the following:

I have reviewed and understand the documents, maintained by the Department of Environment, regarding environmental contamination of the site and adjacent right-of-way. Further, I will ensure that all work at the subject site and adjacent right-of-way, and any monitoring required including but not limited to radiation monitoring, will be performed in a manner that is protective of human health and the environment and in compliance with all applicable local, state, and federal laws, rules, and regulations, especially those pertaining to worker safety and waste management. I will ensure that the results of any radiation monitoring and/or surveying conducted shall be provided to the Department of Environment and the United States Environmental Protection Agency within two (2) weeks of their completion. If any elevated levels of radioactive material are detected, I will immediately contact the United States Environmental Protection Agency at (800) 424-8802.

Permit No: 254079126

Date: 2/15/12

Site Address

150-52 E. Ontario

Work Location (Describe exact site location and attach map)

Traffic Lane

Applicant Name (print) Maria G Oliver

Signature Maria G. Oliver Date 2/15/12

Company  Peoples Gas

Company Address / Phone No: (312) 240-4692

Check if City-Department Work  Department Name \_\_\_\_\_

General / Prime Contractor Rachel Nielsen  
Include subcontractor information if applicable

Address 130 E. Randolph

Phone No. (773) 395-4254

Nature of Work

Construction

Expected Start Date

ASAP

Safety Officer / Phone No. Jake Wilken (773) 542-7838

Radiation Contractor / Phone No. (if applicable) AECOM Steve Kornder (847) 279-2448

Department of Environment Approval / Date Fahmatunisa Begum 2/15/12

Please return this completed form to the City of Chicago Department of Transportation at 30 N. LaSalle St., Room 1101, Chicago, Illinois 60602 during normal business hours (8:30 AM - 4:30 PM, Monday through Friday).

For DOE Use Only

# Calculation Sheet

Project <b>INTEGRYS - 150 - 152 E. ONTARIO ST.</b>		Subject <b>RADIOLOGICAL SOIL SURVEY - RIGHT OF WAY</b>				
Originated By <b>LD</b>	Date <b>2/29/12</b>	Checked By <b>BN</b>	Date <b>2/29/12</b>	Job No. <b>60157647</b>	Scale <b>N/A</b>	Sheet No. <b>1 of 1</b>

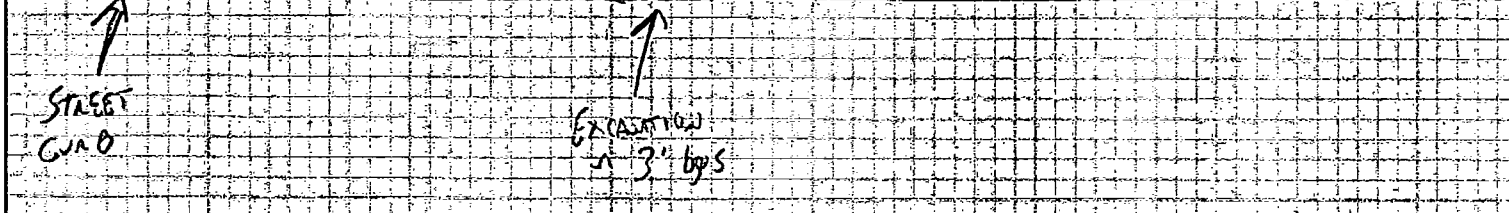
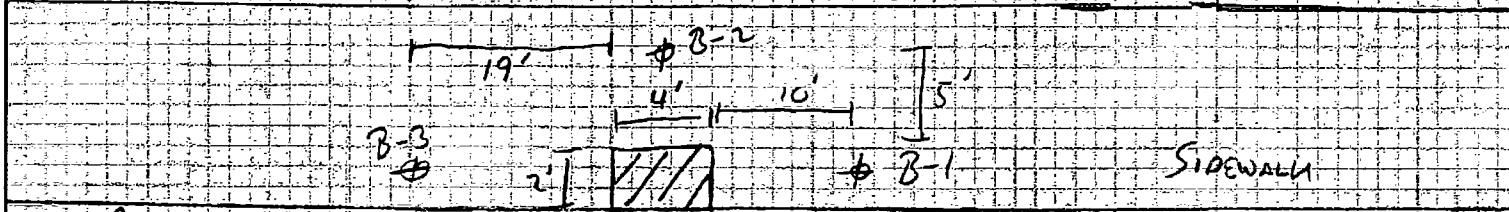
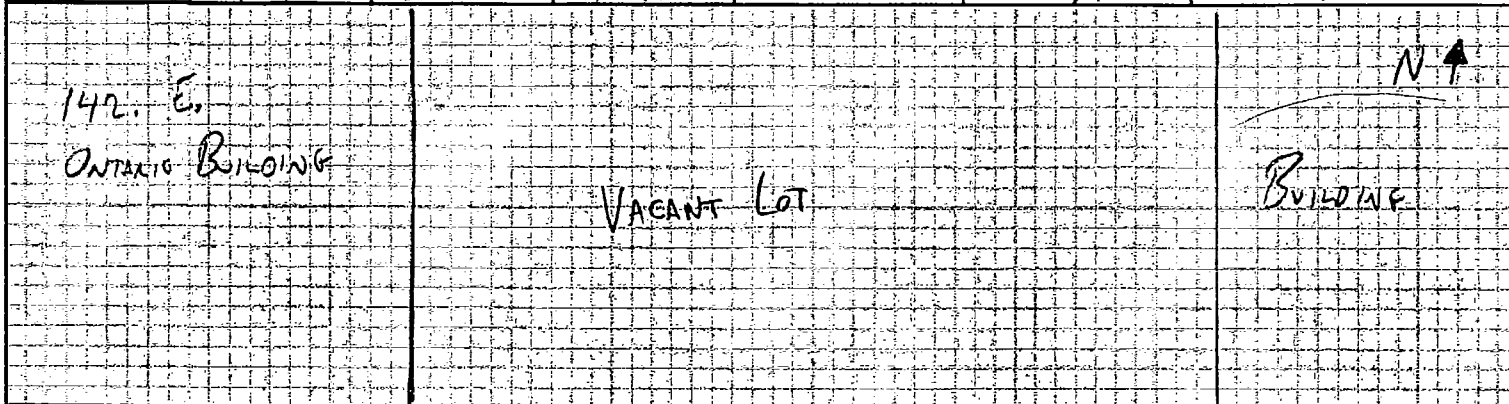

ONTARIO ST.

BACKGROUND SURVEY VALUES  
1-MINUTE COUNTS

B-1	6,832 cpm
B-2	6,600 cpm
B-3	6,708 cpm

EXCAVATION RADIOLOGICAL SOIL SURVEY VALUES (CPM)

<u>DEPTH</u>	<u>CPM</u>
0-6"	CONCRETE SIDEWALK
6-24"	7,400
18-36"	8,900
36-54"	9,600