

AECOM Environment
750 Corporate Woods Parkway, Vernon Hills, IL 60061
T 847.279.2500 F 847.279.2510 www.aecom.com

AECOM

August 21, 2009

Mr. Narendra Prasad
People's Gas
Environmental Services Department
130 East Randolph, 22nd Floor
Chicago, IL 60601



RE: Radiological Survey of Right-of-Way Utility Excavation
Permit No.: 962677739
Permit Address: 630 North McClurg Court
AECOM Project No. 10535-004

Dear Mr. Prasad:

Pursuant to conditions specified in a permit (see attached) issued by the City of Chicago, radiation monitoring was required to be performed at the above referenced site. AECOM, Inc. (AECOM) provided the required radiation surveillance from May 14, 2009 for the excavation of various test pits and trenches for the replacement of gas mains and connections.

Surveying was performed for the asphalt, concrete, and soil removal for the excavations required for the replacement of the gas mains and connections. The monitoring revealed no indication of soils above the specified clean-up threshold established by the U. S. Environmental Protection Agency (USEPA) for the Streeterville area of Chicago. The USEPA threshold for Chicago's Streeterville area is 7.1 picocuries per gram (pCi/g total radium (Ra-226 + Ra-228). Gamma radiation count measurements for the project were made using Ludlum Model 2221 survey meter and an unshielded 2 x 2 NaI probe (Model 44-10). Several AECOM personnel were responsible for oversight during excavation activities, which required the use of two instruments. For the two instruments used, the gamma count indicative of the 7.1 pCi/g threshold was 19,482 counts per minute (cpm) unshielded (7,402 cpm shielded) and 17,805 cpm unshielded (6,860 cpm shielded). The field gamma measurements within the excavation and the spoil materials generated during the excavation process did not exceed the respective threshold values previously stated, and ranged from a minimum of 6,400 cpm to a maximum of 11,500 cpm. Thus, there was no indication of the presence of radiologically-impacted material and/or an exceedance of the USEPA cleanup threshold of 7.1 pCi/g total radium.

Finally, as part of the permit conditions, this letter has been forwarded to:

Chicago Department of Environment
Attention: Ms. Rahmat Begum
30 North LaSalle Street, 25th Floor
Chicago, Illinois 60602

Please contact us with any questions you have regarding this letter or the reported results.

Regards,

Jaclyn C. Webb
Assistant Project Engineer

Steven C. Kornder, Ph.D.
Senior Project Geoscientist

cc: Rahmat Begum, Chicago Department of Environment
Verneta Simon, USEPA

Attachments: Permit
Sketch



**CITY OF CHICAGO DEPARTMENT OF ENVIRONMENT
FORM NO. DOE.ROW.02**

City of Chicago
Richard M. Daley, Mayor

Department of Environment

Sadhu A. Johnston
Commissioner

Twenty-fifth Floor
30 North LaSalle Street
Chicago, Illinois 60602-2575
(312) 744-7606 (Voice)
(312) 744-6451 (FAX)
(312) 744-3586 (TTY)

http://www.cityofchicago.org

Notice is hereby given that the site you have requested a permit for is recorded with the City of Chicago Department of Environment as potentially having environmental contamination on the site and adjacent right-of-way. This environmental contamination could present a threat to human health and safety in connection with work performed at the site, or in the adjacent right-of-way, if proper safeguards are not employed.

A file containing detailed information regarding the aforementioned environmental contamination is available for review at the Department of Environment at 30 N. LaSalle St., 25th Floor, Chicago, Illinois 60602 during normal business hours (8:30AM -4:30PM, Monday through Friday). Contact (312) 744-7606 for an appointment. This file must be reviewed and the remainder of this form completed before the permit can be issued if the ground is exposed or excavated. Please note that for some locations, additional health and safety procedures may be required by law.

Please complete the following:

I have reviewed and understand the documents, maintained by the Department of Environment, regarding environmental contamination of the site and adjacent right-of-way. Further, I will ensure that all work at the subject site and adjacent right-of-way, and any monitoring required including but not limited to radiation monitoring, will be performed in a manner that is protective of human health and the environment and in compliance with all applicable local, state, and federal laws, rules, and regulations, especially those pertaining to worker safety and waste management. I will ensure that the results of any radiation monitoring and/or surveying conducted shall be provided to the Department of Environment and the United States Environmental Protection Agency within two (2) weeks of their completion. If any elevated levels of radioactive material are detected, I will immediately contact the United States Environmental Protection Agency at (800) 424-8802.

Permit No. 10-2077739

Date 5/17/09

Site Address 630 N. McHenry Ct.

Work Location (Describe exact site location and attach map)

Curb lane, sidewalk & driveway

Nature of Work Cut-off Drains

Expected Start Date ASAP

Applicant Name (print) Maria G. Oliver

Signature Maria G. Oliver Date _____

Company Peoples Gas

Company Address / Phone No. 130 E. Randolph (312) 240-4692

Check if City Department Work Department Name _____

General / Prime Contractor Robert Herman
Include subcontractor information if applicable

Address 130 E. Randolph

Phone No. (773) 542-7842

Safety Officer / Phone No. Ed Beauneard (773) 542-7838

Radiation Contractor / Phone No. (if applicable) AECOM-Steve Kandler (847) 279-2448

Department of Environment Approval / Date Rahima Tumsa Bejjani 4/17/09

Please return this completed form to the City of Chicago Department of Transportation at 30 N. LaSalle St., Room 1101, Chicago, Illinois 60602 during normal business hours (8:30 AM - 4:30 PM, Monday through Friday).

For DOE Use Only



Permit # 962677739



Received Date: May 6, 2009 9:1:35

**PEOPLES GAS LIGHT & COKE CO
130 EAST RANDOLPH
DRIVE
CHICAGO, IL 60601**

**City of Chicago
Department of Transportation
(312) 744-4652**

R HERMAN 773-542-7830

ACTIVITY HOURS

Permitted activity hours begin at 9 AM. Permitted activity hours will end at 4 PM. ANY WORK ON ARTERIAL STREETS MUST ADHERE TO ALL RUSH HOUR RESTRICTIONS. 630 - 630 N MCCLURG CT Street Opening (Curb Lane)

DATES

May 6, 2009 through Jun 6, 2009

ACTIVITIES

Street Opening (Curb Lane): **Dig #: TBD**

There will be 1 opening(s) in the public way for the purpose: MAINTENANCE-GENERAL.

4 Feet x 4 Feet

Excavation may commence on - NO SOONER.

630 N MCCLURG CT

OK TO RELEASE, PER RAHMAT BEGUM ON 4/11/09 (SEE RESTRICTIONS)

OK M SIMON

Restrictions:

1. A copy of the permit must remain on-site for inspector's review.

Street Opening (Sidewalk, Parkway, Curb Lane & Traffic Lane)

04-15-2009 - Fee Pavement Opening

CBD:	N	Cost Per EA:	\$ 337.00	CAPS:	300-84-2135-256
Tiered:	N	# OF EA:	1.00	Late charge:	\$.00
Mora:	N			Amount:	\$ 337.00

Total Fees: \$ 337.00

Grand Total Fees: \$ 337.00

Affected CUAN Sites: 5, 15, 21, 22, 29, 65, 90, 144, 152

EFFECTIVE DATES OF PERMIT

Current: Apr 15, 2009 through Jun 15, 2009 (Input date: Apr 15, 2009 9:23:47 a.m.)

END OF PERMIT

Restrictions:

2. Permit fees must be paid within 24 hours of the date of issuance. Failure to pay will result in the immediate cancellation of the permit. Monthly billing accounts are not applicable.
3. All directional boring must be pre-approved by the Office of Underground Coordination.
4. Contractor must secure plating over all openings in the roadway during non-working hours until such time when the road surface is restored.
5. All traffic control will be the responsibility of the contractor and must comply with all MUTCD standards.
6. Permitted Hours: 9 AM to 4 PM (days)
7. Restore all lanes to normal operation during non-working hours.
8. Must use flagmen and/or arrow boards to maintain traffic operations through the work zone.
9. Contractor must notify DIGGER at 312-744-7000 no less than 48 hours (exclusive of Saturdays, Sundays and Holidays) but no more than 14 calendar days in advance of the start of the excavation or demolition, unless the excavation date was provided with the application and remains unchanged. Prior to 26 calendar days the Contractor must notify DIGGER to renew the dig date!
10. It is the Excavator's responsibility to request refreshing of marks when needed, but no longer than 28 calendar days after the last requested date.
11. When applicable, all excavation areas are to be clearly marked in safety white paint prior to calling DIGGER. White paint is not required for joint meets or emergency work.
12. Excavators requesting dig tickets are responsible for the protection of utility markings at the job site. Any markings of underground utilities utilizing utility colors, must be done by facility owners or authorized agents only.
13. Use of pneumatic equipment must not begin before 8:00 A.M. or continue after 8:00 P.M.
14. Permittee must provide a sign which identifies the telephone number and company or person performing the work. Signage may be affixed to barricades.
15. Work to be performed as per plans and specifications.
16. All pavements are to be restored in accordance with CDOT Construction Standards.
17. All street openings must be restored with concrete base to grade.
18. Permanent base pavement restoration to follow within 5 days after the completion of underground work.
19. WARNING: THIS WORKSITE(S) CONTAINS RADIOACTIVE MATERIAL. ANY QUESTIONS PERTAINING TO HANDLING OF MATERIALS, CONTACT THE DEPT. OF ENVIRONMENT AT 312-744-3152.
20. No work in or use of the public right of way is to be done when a special event is taking place. It is up to the applicant to determine if an event is scheduled. To obtain a listing of programs or events within the City of Chicago please dial 311 when you are within the City boundaries.
21. It is the responsibility of the applicant to fund Traffic Control Aides if the City deems it necessary due to heavy congestion situations.
22. Pursuit to City Ordinances 10-20-150 and 10-28-281.3 a re-inspection fee of \$100 may be assessed for each inspection conducted after the initial inspection.

Street Opening (Curb Lane)

05-11-2009 - Fee Pavement Opening

CBD:	Y	Cost Per EA:	\$ 337.00	CAPS:	300-84-2135-256
Tiered:	N	# OE EA:	1.00	Late charge:	\$.00
Mora:	N			Amount:	\$ 337.00

Total Fees: \$ 337.00

Grand Total Fees: \$ 337.00

Affected CUAN Sites: 7, 15, 21, 22, 24, 29, 34, 36, 38, 53, 65, 68, 141, 147

EFFECTIVE DATES OF PERMIT

Current: May 06, 2009 through Jun 06, 2009 (Input date: May 06, 2009 9:01:35 a.m.)

END OF PERMIT

JOB TITLE Integrays Radiological Surveying

JOB NO. 10535-004

CALCULATION NO. -

ORIGINATOR Jaclyn Webb

DATE _____

SHEET 1

OF 1

REVIEWER Steve Korndor

DATE _____

Permit No. 962677739
Permit Dates: 5/6/09 (Excavations on 5/14/09)
Site Address: 630 N. McClurg Ct.



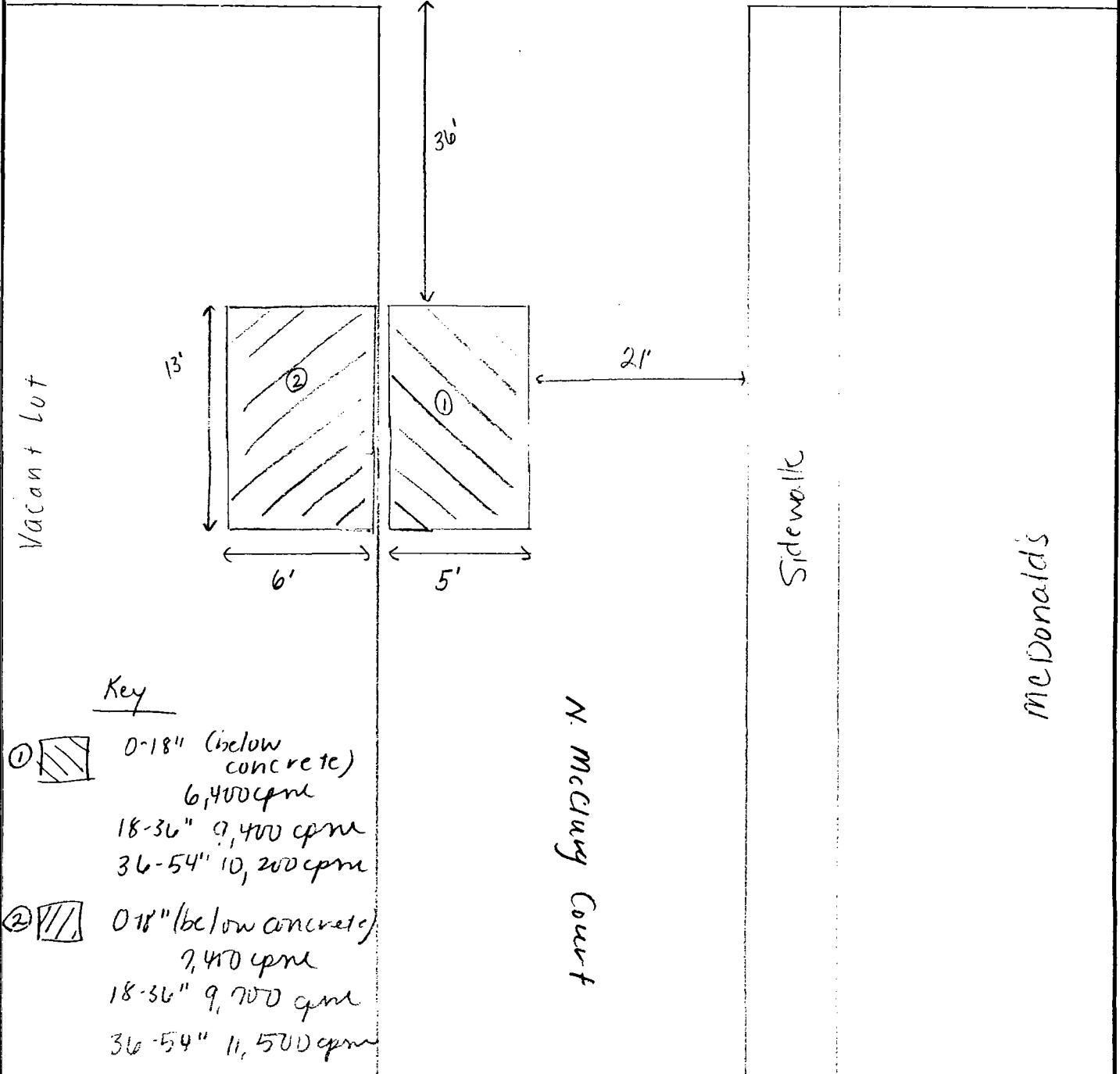

E. Eric Street

Jersey
barrier



Key

- ①  0-18" (below concrete)
6,400 cpm
18-36" 9,400 cpm
36-54" 10,200 cpm
- ②  0-18" (below concrete)
7,400 cpm
18-36" 9,700 cpm
36-54" 11,500 cpm