

Weekly Field Report
Week: 03-09-14 through 03-15-14
New Bedford Harbor Lower Harbor CAD Cell (LHCC)

This Weekly Field Report was prepared to serve as a summary of field activities conducted throughout the week for Phase I dredging of the New Bedford Harbor Lower Harbor CAD Cell (LHCC) in New Bedford, Massachusetts.

1. Introduction:

The weekly field report describes the activities carried out by the Contractor (Cashman/Tripp Marine), the Owner's Representative (Apex Companies, LLC), and any subcontractors completing work within the scope of the project requirements.

This Weekly Field Report represents the nineteenth Report associated with Phase I dredging of the LHCC in New Bedford Harbor, and the associated handling and disposal of dredged materials at CAD cells within the Harbor, and at designated open-water disposal sites approved for this Project.

This 19th Report for the LHCC dredging activities includes:

- Daily Inspection Reports from the dredging oversight performed during the week of March 9th through March 15th, 2014. These reports include notes on the equipment used on site, and a summary of contractor activities. (See Attachment 1);
- Water Quality Monitoring Forms completed for the week of March 9th through March 15th, 2014, (Attachment 2) summarizing monitoring survey data recorded during active dredging. Included with the attached forms is Figure 1 Lower Harbor CAD Cell Phase I Water Quality Monitoring Plan, which shows the locations of the water quality monitoring events conducted during this reporting period. Per the approved Water Quality Monitoring Plan and associated performance standards for the dredging efforts being conducted during this reporting period, Apex has:
 - Conducted water quality monitoring a minimum of one day per week
 - Performed visual inspections of dredged materials before the disposal of a scow for any visible debris or other items that could potentially become a hazard to navigation prior to the scow's departure for the offshore disposal site.

Summary:

The Contractor, Cashman Dredging and Marine Contracting, Co. LLC (Cashman) conducted dredging at the LHCC on March 10th, 11th, 12th, 13th, 14th, and 15th. Dredging operations focused on the removal of Phase I Bottom of CAD Cell sediments. During this reporting period, dredging operations were conducted using a conventional digging bucket, with dredged materials being disposed offshore at the Rhode Island Sound Disposal Site (RISDS). Cashman was observed conducting these activities during the authorized operational window of 7AM until sunset, utilizing a single dredge plant – the Bobby D; two tugs – Ellsea and Lucinda Smith; a 2800 cubic yard split scow – Eddie Carroll; and two small utility boats. A 1500 cubic yard pocket scow, SEI 2000, was used in a trial period from March 14th to March 15th as part of its Dredging Quality Management (DQM) certification process. The pocket scow was cleared on March 14th for dredging of Bottom of CAD material at the LHCC following its Disposal

Quality inspection for offshore disposal at the RISDS. Apex is still waiting on the DQM Certification of the SEI 2000. With time of year restrictions now in place (January 15th through June 15th) all dredging activities were conducted within a silt curtained perimeter surrounding the LHCC.

2. Operational Notes:

Dredging:

Dredging of LHCC Phase I Bottom of CAD sediments continued during the week. Apex conducted one day of water quality monitoring on March 11th while dredging was being performed to ensure that this activity did not result in an exceedance of any project-specific water quality standards.

Offshore Disposal:

Offshore disposal for LHCC Phase I Bottom of CAD sediments is scheduled and permitted for the Rhode Island Sound Disposal Site. Three offshore disposal events, using the split scow Eddie Carroll, were recorded during the week and occurred on March 11th, 12th, and 14th.

Table 1 – Cumulative Dredging Progress

Period of Activity	Volume (cy)
Approximate Top of CAD Volume Dredged to Date*	24,890
Approximate Bottom of CAD Volume Dredged this Reporting Period	4,800
Approximate Bottom of CAD Volume Dredged to Date*	19,900

* Dredge volume quantities are estimated based on observed scow draft marks and an assumed density of the materials dredged. Given the uncertainty in the density of a composite mix of sediments being dredged, all volumes are confirmed and adjusted as necessary using bathymetric survey data.

3. Monitoring Summary

There were no water quality exceedances observed during this reporting period related to dredging operations. No water quality samples were collected.

Prepared by:
Apex Companies, LLC



John B. McAllister, P.E.
Senior Project Engineer

Attachment 1
Daily Inspection Reports



City of New Bedford Harbor Development Commission
New Bedford Harbor USEPA Lower Harbor CAD Cell
CFDA No.: 66.802
Inspection Report

Inspector: Kaios Ryan, Adam Hart

Date: 03/09/2014

Contractor: Cashman **Foreman/Supt:** No Captain

Weather	AM:	<u>Cloudy</u>	Temperature	AM:	<u>39</u>
	PM:	<u>Clear</u>		PM:	<u>25</u>

Tides	High	<u>0158</u>	AM	<u>1526</u>	PM
	Low	<u>0954</u>	AM	<u>2029</u>	PM

Manpower Onsite

Engineer 0 @ Hrs
Operators 0 @ Hrs
Mate 0 @ Hrs
Deckhand 0 @ Hrs
Captains 0 @ Hrs

Other: @ Hrs

Equipment Onsite

Description: Bobby D. Hrs. 0
Eddie Carroll Hrs. 1
Lucinda Smith Hrs. 1
 Hrs.
 Hrs.
 Hrs.

Contractor Activities: (Attach Additional Sheets as Necessary)

0540 no activity on site. 0712 no activity on site; Bobby D. is in dredge area and the Eddie Carroll is located at the south staging area. 0900 no activity on site. 1130 Lucinda Smith and the Eddie Carroll makes the 1115 bridge opening north bound and tie to staging area at Cad Cell # 3. 1418 no activity on site.

Problems/Issues or Action Items:

Visitors:

Signature: 

Title: Environmental Technician

Copy to: File

Date: 03/09/2014

Page: 1 of 1

File: DIR_LHCC_030914



City of New Bedford Harbor Development Commission
New Bedford Harbor USEPA Lower Harbor CAD Cell
CFDA No.: 66.802

Inspection Report

Inspector: Kaios Ryan, Adam Hart **Date:** 03/10/2014

Contractor: Cashman Dredging and Marine Contracting **Foreman/Supt:** Micah Bowes

Weather	AM:	<u>Snow</u>	Temperature	AM:	<u>43</u>
	PM:	<u>Cloudy</u>		PM:	<u>33</u>
Tides	High	<u>0359</u>	AM	<u>1627</u>	PM
	Low	<u>1047</u>	AM	<u>2141</u>	PM

Manpower Onsite

Equipment Onsite

Engineer	<u>1</u>	@	<u>10</u>	Hrs	Description:	<u>Bobby D.</u>	Hrs.	<u>10</u>
Operators	<u>1</u>	@	<u>10</u>	Hrs		<u>Eddie Carroll</u>	Hrs.	<u>10</u>
Mate	<u>1</u>	@	<u>10</u>	Hrs		<u>Elsea</u>	Hrs.	<u>3</u>
Deckhand	<u>1</u>	@	<u>10</u>	Hrs		<u>Lucinda Smith</u>	Hrs.	<u>2</u>
Captains	<u>1</u>	@	<u>10</u>	Hrs		<u>Red Skiff</u>	Hrs.	<u>10</u>
Other:	<u> </u>	@	<u> </u>	Hrs		<u> </u>	Hrs.	<u> </u>

Contractor Activities: (Attach Additional Sheets as Necessary)

0707 Bobby D. begins to dredge into the Eddie Carroll, drafting at 3.5'. They are dredging in cuts 1&2 station 3+85. 0812 mechanic on board the Bobby D. to look at port spud, it is operating fine at the moment. 0817 Elsea is tied to the Bobby D. 0946 Bobby D. stops dredging due to a pin had started to come out of bucket. 0956 crew members are driving pin back into bucket. 1028 the pin is driven back into the bucket of the Bobby D. and resume dredging into the Eddie Carroll. 1153 Bobby D. stops dredging so the crew can move the Eddie Carroll to the west. 1204 Bobby D. resumes dredging into the Eddie Carroll in the middle of the scow. They are now dredging in cut 1, station 4+03. 1428 Tug boat Elsea moves the Dredge Plant Bobby D. and scow Eddie Carroll to the west. 1454 Dredge Plant Bobby D. resumes dredging. 1525 Bobby D.'s crew are greasing the spuds. 1620 Tug boat Lucinda Smith passes through the bridge north bound. 1626 Tug boat Lucinda Smith ties to the Richie Barber. 1650 Dredge plant Bobby D. stops dredging, scow Eddie Carroll is full drafting 9.5 and 10.5. 1653 Eddie Carroll is inspected and cleared for disposal off of Rhode Island. 1655 Tug boat Elsea pushes the Bobby D. and Eddie Carroll south so the Lucinda Smith has room to maneuver. 1700 The red skiff opens the silt curtain. 1703 Tug Boat Lucinda Smith ties to the Eddie Carroll. 1707 Lucinda Smith and Elsea move the Eddie Carroll from the silt curtain. 1708 Bobby D. lifts spuds to reposition for tomorrow. 1715 Tug boat Lucinda Smith and scow Eddie Carroll head south toward the bridge. 1720- Tug boat Lucinda Smith and scow Eddie Carroll head south through the bridge heading toward Rhode Island offshore disposal site.

Visitors: _____

Signature: 
 Title: Environmental Technician
 Copy to: File

Date: 03/10/2014
 Page: 1 of 1
 File: DIR_LHCC_031014_KR



City of New Bedford Harbor Development Commission
New Bedford Harbor USEPA Lower Harbor CAD Cell
CFDA No.: 66.802

Inspection Report

Inspector: Kaios Ryan, Brett Young **Date:** 03/11/2014

Contractor: Cashman **Foreman/Supt:** Michah Bowers

Weather	AM:	<u>Cloudy</u>	Temperature	AM:	<u>57</u>
	PM:	<u>Clear</u>		PM:	<u>36</u>
Tides	High	<u>0503</u>	AM	<u>1726</u>	PM
	Low	<u>1127</u>	AM	<u>2245</u>	PM

Manpower Onsite

Equipment Onsite

Engineer	<u>1</u>	@	<u>10</u>	Hrs	Description:	<u>Bobby D.</u>	Hrs.	<u>10</u>
Operators	<u>1</u>	@	<u>10</u>	Hrs		<u>Eddie Carroll</u>	Hrs.	<u>10</u>
Mate	<u>1</u>	@	<u>10</u>	Hrs		<u>Ellsea</u>	Hrs.	<u>12</u>
Deckhand	<u>1</u>	@	<u>10</u>	Hrs		<u>Lucinda Smith</u>	Hrs.	<u>6</u>
Captains	<u>1</u>	@	<u>10</u>	Hrs		<u>Red Skiff</u>	Hrs.	<u>10</u>
Other:		@		Hrs			Hrs.	

Contractor Activities: (Attach Additional Sheets as Necessary)

0638- Lucinda Smith brings the Eddie Carroll into the dredge area and ties the Eddie Carroll to the Bobby D. 0654- Lucinda Smith ties up by Cad Cell # 3. 0718- The Bobby D. begins dredging into the Eddie Carroll drafting at 4'. 0836- The Bobby D. still dredging into the Eddie Carroll at cut 6 station 6 + 09. 1018- The Bobby D. stops dredging and moves a little to the west at cut 6 station 5 + 82. 1024- The Bobby D. resumes dredging into the Eddie Carroll. 1250- The Bobby D. stops dredging; Ellsea helps with moving the Bobby D. and the Eddie Carroll to the west. 1330- Bobby D. resumes dredging into the Eddie Carroll at cut 6 station 4 + 82. 1400- The Eddie Carroll is drafting; bow 9', stern 8.5'. 1439- The Bobby D. moves and begins dredging into the Eddie Carroll at cut 6 station 5+12. 1523- The Bobby D. moves and begins dredging into the Eddie Carroll at cuts 6&7 station 4+95. 1619- The Bobby D. moves and begins dredging into the Eddie Carroll at cut 6 station 5+36. 1645- The Bobby D. stops dredging to move and snaps the bow line. 1650- The Ellsea assists in pushing the Eddie Carroll back up against the Bobby D. 1705- The Bobby D. resumes dredging. 1722- The Bobby D. stops dredging. 1725- The Eddie Carroll is inspected and cleared for offshore disposal. Eddie Carroll drafting; bow-9.5' stern- 11'. 1730- Silt curtain is opened and the Lucinda Smith enters. 1740- The Lucinda Smith takes the Eddie Carroll outside of the silt curtain and waits for the 1815 bridge opening.

Problems/Issues or Action Items:

1708- There is a miscommunication between the dredge captain and tug captain about the opening of the silt curtain gate. The red skiff opens the silt curtain gate while the Bobby D. is dredging and it remained open for about 2 minutes before the mistake was realized and they immediately close the gate.

Visitors:

Signature:  **Date:** 3/11/2014
Title: Environmental Scientist **Page:** 1 of 1
Copy to: File **File:** DIR_LHCC_031114



City of New Bedford Harbor Development Commission

New Bedford Harbor USEPA Lower Harbor CAD Cell

CFDA No.: 66.802

Inspection Report

Inspector: Kaios Ryan, Adam Hart

Date: 03/12/2014

Contractor: Cashman/Weeks

Foreman/Supt: Micah Bowers

Weather AM: Cloudy Temperature AM: 52
PM: Cloudy PM: 22

Tides High 558 AM 1816 PM
Low 1201 AM 2338 PM

Manpower Onsite

Equipment Onsite

Engineer	1 @ 8.5 Hrs	Description: Bobby D.	Hrs. 9.5
Operators	1 @ 8.5 Hrs	Eddie Carroll	Hrs. 9.5
Mate	1 @ 8.5 Hrs	Ellsea	Hrs. 1
Deckhand	1 @ 8.5 Hrs	Lucinda Smith	Hrs. 2
Captains	1 @ 8.5 Hrs	Survey 4	Hrs. 3.5
Other:	@ Hrs		Hrs.

Contractor Activities: (Attach Additional Sheets as Necessary)

0620 Lucinda Smith brings the Eddie Carroll into dredge area and ties up to the Bobby D. 0714 Bobby D. begins dredging into the Eddie Carroll drafting at 3.5'. 0815 Bobby D. stops dredging to allow fuel barge into dredge area. 0822 survey 4 boat on site to perform survey. 0853 silt fence is closed. 0855 Bobby D. resumes dredging into the Eddie Carroll. 0937 Bobby D. stops dredging and moves to the east. 0948 Bobby D. resumes dredging into the Eddie Carroll at station 5 + 68 cut 10. 1118 Bobby D. stops dredging and moves 30' northwest, Ellsea assists in the move. 1124 Bobby D. resumes dredging into the Eddie Carroll at station 4 + 49 cut 6. 1258 Bobby D still dredging into the Eddie Carroll. 1400 Bobby D. stops dredging and engineer checks on swing motor of excavator, the whole crew are working on the problem. 1450 Captain Bowers decides to run the excavator with the problem. 1452 Ellsea moves the Bobby D. and Eddie Carroll to the east. 1456 the Bobby D. resumes dredging into the Eddie Carroll at station 5 + 20 cut 6. 1520 Tug boat Lucinda Smith passes through the bridge north bound. 1627 Dredge Plant Bobby D. finishes dredging, scow Eddie Carroll is filled with a draft of 9.5' - 8'. 1636 Scow Eddie Carroll is inspected and cleared for offshore disposal. Silt curtain is open and tug boat Lucinda Smith ties to the scow Eddie Carroll. 1720 Tug boat Lucinda Smith and scow Eddie Carroll pass through the bridge south bound. 1729 Tug boat Lucinda Smith and scow Eddie Carroll head through the hurricane barrier south bound for offshore disposal. 1800 Dredge plant Bobby D. crew offsite, no site activity.

Visitors:

Signature: 

Date: 03/12/2014

Title: Environmental Technician

Page: 1 of 1

Copy to: File

File: DIR_LHCC_031214



City of New Bedford Harbor Development Commission
New Bedford Harbor USEPA Lower Harbor CAD Cell
CFDA No.: 66.802
Inspection Report

Inspector: Mark Martinho, Brett Young **Date:** 03/13/2014

Contractor: Cashman **Foreman/Supt:** Steve Baynes, Micah Bowers

Weather	AM:	<u>Snow</u>	Temperature	AM:	<u>21</u>
	PM:	<u>Snow</u>		PM:	<u>23</u>
Tides	High	<u>0626</u>	AM	<u>1846</u>	PM
	Low	<u>x</u>	AM	<u>1256</u>	PM

Manpower Onsite

Engineer 1 @ 12 Hrs
Operators 1 @ 12 Hrs
Mate 1 @ 12 Hrs
Deckhand 1 @ 12 Hrs
Captains 2 @ 12 Hrs

Other: _____ @ _____ Hrs

Equipment Onsite

Description: Bobby D Hrs. 12
Eddie Carroll Hrs. 12
Ellsea Hrs. 12
Lucinda Smith Hrs. 6
Red Skiff Hrs. 12
_____ Hrs. _____

Contractor Activities: (Attach Additional Sheets as Necessary)

0714- Bobby D begins dredging into the Eddie Carroll. 0830- Bobby D continues to dredge into the Eddie Carroll drafting; bow-6.5' stern-6.5'. Silt curtain fully closed. 0840-Bobby D dredging 1/2 to 3/4 full buckets. 0850- Bobby D stops dredging. 0908- Bobby D resumes dredging. Location 815231, 2696867. 1005- Eddie Carroll is drafting; bow-7.5' stern 7.5'. 1015- Spuds up, Bobby D moves 60' west. 1032- Bobby D is dredging in a new location: 815231, 2696928. 1040- Eddie Carroll is hard aground, tide ebbing. 1535- Bobby D and Eddie Carroll completely freed with assistance from Lucinda Smith and Ellsea. 1547- Eddie Carroll is drafting; bow-6.5' stern- 8'. 1602- Silt curtain gate is closed. 1605-Bobby D resumes into the Eddie Carroll at cut 6 station 6+26. 1615- Lucinda Smith tied up to the Richie Barber. 1625- Bobby D dredging in a new location, cut 6 station 6+04. 1652- Bobby D stops dredging. 1700- Bobby D resumes dredging at cut 6 station 5+92. 1740-Bobby D stops dredging. 1800- The silt curtain gate is opened. 1815- The Lucinda Smith enters and takes the Eddie Carroll and ties it to the Richie Barber. 1820- The Ellsea repositions the Bobby D 20' west of the eastern side of the silt curtain.

Problems/Issues or Action Items:

Visitors: _____

Signature: Brett Young
Title: Environmental Scientist
Copy to: File

Date: 03/13/2014
Page: 1 of 1
File: DIR_LHCC_031314



City of New Bedford Harbor Development Commission
New Bedford Harbor USEPA Lower Harbor CAD Cell
CFDA No.: 66.802

Inspection Report

Inspector: Chris Stillman, Brett Young **Date:** 3/14/2014

Contractor: Cashman **Foreman/Supt:** Micah Bowers, Junior Mitchel, Dave Norton

Weather AM: Clear **Temperature** AM: 35
 PM: Clear PM: 34

Tides High 0722 AM 1938 PM
 Low 1232 AM 1307 PM

Manpower Onsite

Foreman	Micah	@	<u>12</u>	Hrs
	Dave	@	<u>12</u>	Hrs
	Junior	@	<u>6</u>	Hrs
Operators	Tommy	@	<u>12</u>	Hrs
Deck Hands	Davey	@	<u>12</u>	Hrs
	Josh	@	<u>12</u>	Hrs
Engineer	Dwight	@	<u>12</u>	Hrs

Equipment Onsite

Description:	<u>Bobby D</u>	Hrs.	<u>10</u>
	<u>Eddie Carroll</u>	Hrs.	<u>3</u>
	<u>Ellsea</u>	Hrs.	<u>10</u>
	<u>Lucinda Smith</u>	Hrs.	<u>3</u>
	<u>SEI 2000</u>	Hrs.	<u>8</u>
		Hrs.	

Contractor Activities: (Attach Additional Sheets as Necessary)

0630- Crew arrive at the Bobby D- no dredging, the Eddie Carroll will head out for disposal early to avoid late night predicted high seas. 0848- Split scow Eddie Carroll cleared for inspection for Rhode Island offshore Disposal Area. 0938- Tug Lucinda Smith takes the Eddie Carroll from the dewatering area and out of the harbor in transit for Rhode Island disposal. 0949- Tug Ellsea brings the pocket scow SEI 2000 to the Bobby D. 1000- Scow SEI 2000 failed pre-inspection for Lower Harbor Cad Cell, Bottom of Dredge activity due to the presence of surficial New Bedford Harbor sediment from the Northern Mooring Mitigation Area. 1020- Ellsea brings the SEI 2000 to the dewatering plant, silt curtains encapsulated the cleaning operation. 1140- Dewatering operation commenced. 1330- Apex performed a second pre-inspection and documented the complete removal of previous material- scow was cleared for dredging of bottom of CAD on project following it's requisite Disposal Quality inspection for offshore disposal at Rhode Island Sound Disposal Area. 1453- Ellsea spins around and ties its stern to the SEI 2000. 1458- The Ellsea begins to take the SEI 2000 around the north section of the harbor for unloaded Disposal Quality inspection. 1503- Ellsea unties from the bow of the SEI 2000 and ties up to the stern. 1518- The SEI 2000 completes and passes unloaded Disposal Quality inspection. Ellsea begins to take the SEI 2000 to the Bobby D. 1538- The SEI 2000 ties up to the Bobby D. 1545- The Bobby D begins dredging into the SEI 2000. 1625- The SEI 2000 is drafting; bow-4.5' stern-4.5'. 1627- Bobby D stops dredging to move crew and tools onto the SEI 2000. 1632- Bobby D resumes dredging. 1655- Bobby D dredging cut 7 station 7+00. 1718- Bobby D stops dredging to adjust the lines. 1721- Bobby D resumes dredging into the SEI 2000. 1747- Bobby D repositions and begins dredging cut 7 station 6+89. 1820- Bobby D repositions and begins dredging cut 7 station 6+60. 1835- The SEI 2000 is drafting; bow-5' stern-9'. 1841- Bobby D stops dredging, the bucket is on deck. Scow is not full and will be used for dredging activities on 3/15/14.

Problems/Issues or Action Items:

1555- Apex contacted Micah Bowers and informed him the silt curtain was still open. Dredging activities were immediately stopped until the curtain was closed. Curtain was open for 10 minutes while dredging occurred. No visible turbidity was seen exiting the silt curtain.

Visitors: _____

Signature: Brett Young

Title: Environmental Scientist

Copy to: File

Date: 03/14/2014

Page: 1 of 1

File: DIR_LHCC_031414



City of New Bedford Harbor Development Commission

New Bedford Harbor USEPA Lower Harbor CAD Cell

CFDA No.: 66.802

Inspection Report

Inspector: Mike Tumolo, Adam Hart

Date: 03/15/2014

Contractor: Cashman/Weeks

Foreman/Supt: Dave Norton

Weather AM: Partly Cloudy **Temperature** AM: 32
PM: Clear PM: 57

Tides High 756 AM 2013 PM
Low 113 AM 1339 PM

Manpower Onsite

Engineer 1 @ 10 Hrs
Operators 1 @ 10 Hrs
Mate 1 @ 10 Hrs
Deckhand 1 @ 10 Hrs
Captains 1 @ 10 Hrs
Other: Welder 1 @ 9 Hrs

Equipment Onsite

Description: Bobby D. Hrs. 10
Eddie Carroll Hrs. 6
Ellsea Hrs. 1
Lucinda Smith Hrs. 2
SEI 2000 Hrs. 4
Red Skiff Hrs. 10

Contractor Activities: (Attach Additional Sheets as Necessary)

Dredging Start Time: 0745. Dredging End Time: 1835. 745 Dredge Plant Bobby D. begins dredging into scow SEI 2000, with a draft of 4' - 8'. 815 Dredging stops to clean up a minor oil leak on deck of the dredge plant Bobby D. 820 Dredging resumes into the scow SEI 2000. 1100 Scow SEI 2000 is filled, draft of 9' -11'. Compartments 3, 4, and 5 are empty. 1125- Tug boat Lucinda Smith brings the scow SEI 2000 to the Richie Barber. 1155 Tug boat Lucinda Smith brings the scow Eddie Carroll to the dredge plant Bobby D. 1233 Dredge plant Bobby D. repositions and begins dredging into the scow Eddie Carroll, draft of 3.5'-4'. 1251 Scow SEI 2000 was cleared for offshore disposal. 1325 Dredge Plant Bobby D. tries raising spuds, but port spud is having mechanical issues. 1330 Port spud begins lifting. 1337 Dredge Plant Bobby D. resumes dredging. 1345 Excavator on the Bobby D. places bucket on deck, crew beings repairing pin. 1350 Tug boat Ellsea pulls along side the Bobby D. so the crew can use the torch. 1435 Dredge Plant Bobby D. resumes dredging into the scow Eddie Carroll. 1512 Dredge plant Bobby D.'s spud motor is over heating, cannot lift spud. 1546 Dredge plant Bobby D. attempts at lifting port spud, tug boat Ellsea pushes the dredge plant Bobby D. south. 1604 Dredging resumes. 1605 Red skiff brings Captain Norton and a deckhand to the SEI 2000 to make repairs. 1640 Oil leak from the Bobby D. spud motor, crew is working on repairing it. 1650 Red skiff returns with Captain Norton and deckhand. 1712 Dredge plant Bobby D. resumes dredging. 1727 The red skiff brings Captain Norton and deckhand to the SEI 2000 to finish repairs. 1755 Tug boat Ellsea ties to the dredge plant Bobby D. to bring into deeper water. 1815 Scow SEI 2000 is inspected and cleared for offshore disposal. 1830 Bobby D. fills the scow Eddie Carroll, draft of 7.5' -6'. (Cashman is not sure if the Eddie Carroll will go for a disposal today, decision will be made on 3/16/14). 1837 The red skiff opens the silt curtain. 1640 Tug boat Lucinda Smith ties to the scow Eddie Carroll. 1842 Scow Eddie Carroll is untied from the dredge plant Bobby D. Tug boat Ellsea pushed the scow Eddie Carroll out of the silt curtain, tug boat Lucinda Smith pulls the scow Eddie Carroll from the silt curtain. 1900 Tug boat Lucinda Smith ties the scow Eddie Carroll to the scow Winslow at CAD cell 3. Tug boat Ellsea ties to the Bobby D. and the red skiff closes the silt curtain. 1920 All activity stopped, all crews offsite.

Visitors: _____

Signature: 

Date: 03/15/2014

Title: Environmental Technician

Page: 1 of 1

Copy to: File

File: DIR_LHCC_031214

Attachment 2
Water Quality Monitoring Forms

PROJECT: New Bedford Harbor Lower Harbor CAD Cell

JOB NUMBER: 6724

DATE: 3/11/2014

MONITORS: Kyle Miller, Mark Martinho

WEATHER CONDITIONS: High: 57 Low: 36

WIND:

PRIOR STORM EVENTS:

DREDGE UPDATE:

TYPE OF WATER QUALITY MONITORING EVENT: TOP CAD Dredging / BTM CAD Dredging / Disposal

TIDE High:0503/1726

Low: 1127/2245



UP-CURRENT

Monitoring ID #	NORTHING/ EASTING	TIME	TOTAL WATER DEPTH (ft)	SAMPLE DEPTH (ft)	TURBIDITY (NTUs)	GPS FILE NAME	TIDAL STAGE	TYPE OF WQM & DISTANCE FROM LOCATION	NUMBER OF HOURS DREDGING	
031114-00-1-1	814979, 2696570	752	9.6	1	1.76	apex wqm 031114	Ebbing	200' S of Dredge	00	
031114-00-1-4.5		754		4.5	1.97					
031114-00-1-9		756		9	2.76					
AVERAGE TURBIDITY:					2.16					
031114-02-1-1	815057, 2697225	930	7.3	1	1.31	apex wqm 031114	Ebbing	200' N of Dredge	02	
031114-02-1-3		932		3	1.71					
031114-02-1-6		934		6	2.92					
AVERAGE TURBIDITY:					1.98					
031114-04-1-1	814915, 2697142	1100	9.3	1	1.68	apex wqm 031114	Ebbing	200' N of Dredge	04	
031114-04-1-4		1102		4	1.89					
031114-04-1-8		1104		8	1.97					
AVERAGE TURBIDITY:					1.85					
031114-06-1-1	815070, 2696153	1310	11.8	1	3.49	apex wqm 031114	Flooding	200' S of Dredge	06	
031114-06-1-5		1312		5	2.91					
031114-06-1-10		1314		10	3.59					
AVERAGE TURBIDITY:					3.33					
031114-08-1-1		1520	11	1	3.52	apex wqm 031114	Flooding	200' S of Dredge	08	
031114-08-1-5		1522		5	2.88					
031114-08-1-10		1524		10	6.02					
AVERAGE TURBIDITY:					4.14					

Down-Current

Monitoring ID #	NORTHING/ EASTING	TIME	TOTAL WATER DEPTH (ft)	SAMPLE DEPTH (ft)	TURBIDITY (NTUs)	GPS FILE NAME	TIDAL STAGE	DISTANCE FROM DREDGE/SILT CURTAIN	NUMBER OF HOURS DREDGING	
031114-00-9-1	815269, 2697185	745	7.2	1	1.55	apex wqm 031114	Ebbing	200' N of Dredge	00	
031114-00-9-3.5		747		3.5	2.24					
031114-00-9-7		749		7	5.27					
AVERAGE TURBIDITY:					3.02					
TURBIDITY INCREASE:					0.86					
031114-02-9-1	815177, 2696554	940	6.5	1	7.97	apex wqm 031114	Ebbing	200' S of Dredge	02	
031114-02-9-3		942		3	6.28					
031114-02-9-66		944		66	4.61					
AVERAGE TURBIDITY:					6.29					
TURBIDITY INCREASE:					4.31					
031114-04-9-1	815026, 2696555	1110	7.7	1	4	apex wqm 031114	Ebbing	200' S of Dredge	04	
031114-04-9-3		1112		3	4.3					
031114-04-9-6		1114		6	3.68					
AVERAGE TURBIDITY:					3.99					
TURBIDITY INCREASE:					2.15					
031114-06-9-1	815164, 2697025	1320	5.1	1	2.97	apex wqm 031114	Flooding	200' N of Dredge	06	
031114-06-9-2		1322		2	3.82					
031114-06-9-4		1324		4	4.7					
AVERAGE TURBIDITY:					3.83					
TURBIDITY INCREASE:					0.5					
031114-08-9-1	814995, 2696339	1500	10	1	5.03	apex wqm 031114	Flooding	200' N of Dredge	08	
031114-08-9-5		1502		5	5					
031114-08-9-9		1504		9	4.29					
AVERAGE TURBIDITY:					4.77					
TURBIDITY INCREASE:					0.63					

* Turbidity Increase = Down-Current Average Turbidity - Up-Current Average Turbidity

Figure 1
Lower Harbor CAD Cell Phase I – Water Quality Monitoring

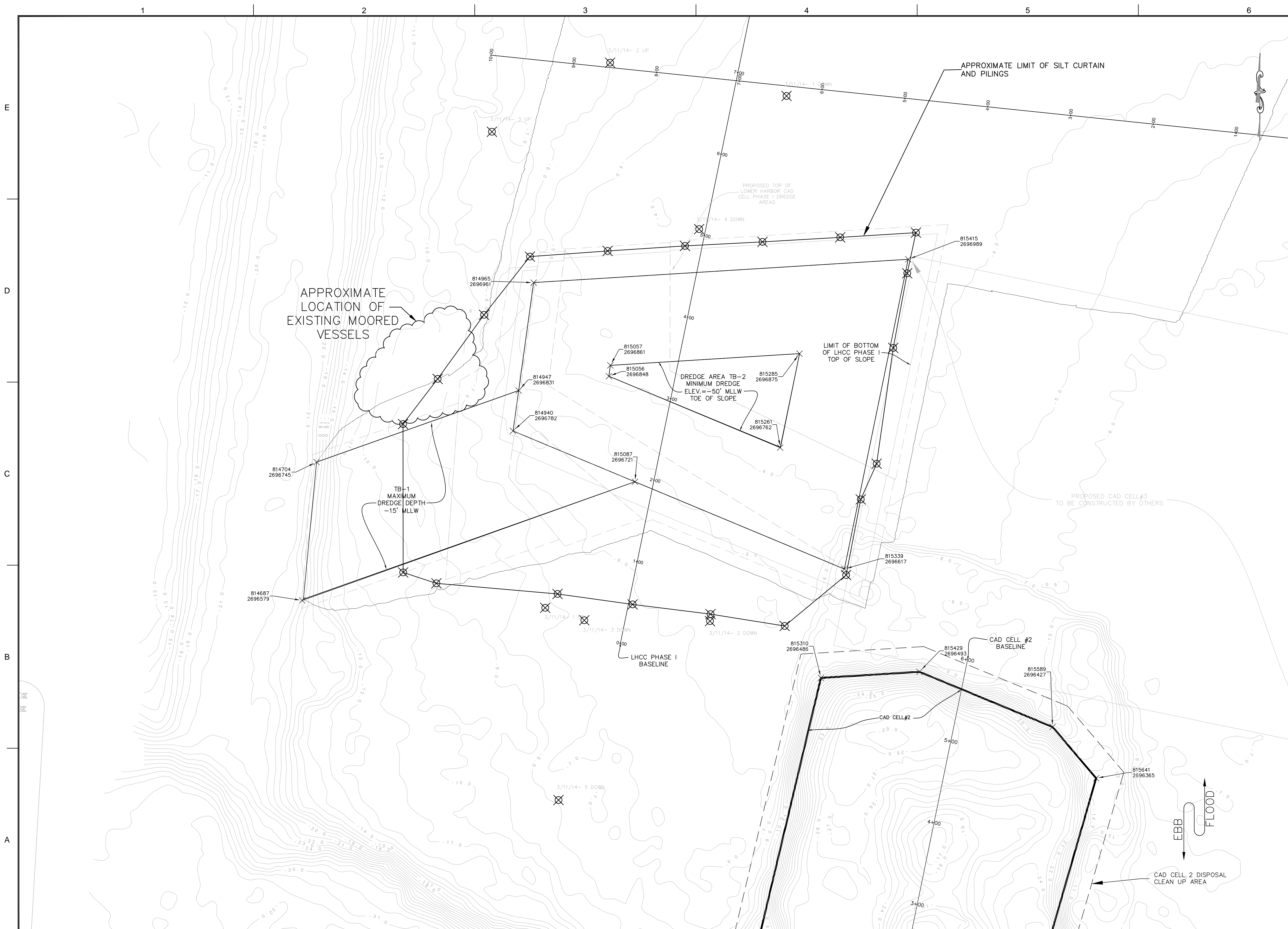

ROCKVILLE, MD
SOUTH WINDSOR, CT - BOSTON, MA -
NEW BEDFORD, MA - HOLYOKE, MA
125 BROAD STREET, 5TH FLOOR
BOSTON, MA 02210
58H CONNECTICUT AVENUE
SOUTH WINDSOR, CT

The drawings prepared by Apex for this project are instruments of Apex's services for use solely with respect to the project and general and do not constitute a contract. The drawings and all related documents, including but not limited to, specifications, contracts, and other documents, shall remain the property of Apex. The drawings shall not be used for any other project, for addition to this project or for completion of this project by others, except by agreement in writing and with appropriate compensation to Apex.

PROJECT	NEW BEDFORD HARBOR DEVELOPMENT COMMISSION LOWER HARBOR CAD CELL	
	OWNER	NEW BEDFORD HARBOR DEVELOPMENT COMMISSION 52 FISHERMAN'S WHARF, NEW BEDFORD, MA 02740

1	9/25/2012	EPA COMMENTS	GCD
2	2/21/2013	DRAFT SUITABILITY	MCK

DATE	DESCRIPTION	BY
9/25/2012	EPA COMMENTS	GCD
2/21/2013	DRAFT SUITABILITY	MCK

PROJECT NO.	6724
CADD FILE	
DESIGNED BY	CHM
DRAWN BY	GCD
CHECKED BY	GCD
DATE	MAY 2013
DRAWING SCALE	AS NOTED

GRAPHIC SCALE
SCALE: 1"=50'
0 25 50 100

SHEET TITLE

BOTTOM OF LOWER HARBOR CAD CELL PHASE 1 WATER QUALITY
3/09/14-3/15/14

DRAWING NO.

WQM-1

6 OF 15