

Weekly Field Report  
Week: 02-02-14 through 02-08-14  
New Bedford Harbor Lower Harbor CAD Cell (LHCC)

This Weekly Field Report was prepared to serve as a summary of field activities conducted throughout the week for Phase I dredging of the New Bedford Harbor Lower Harbor CAD Cell (LHCC) in New Bedford, Massachusetts.

**1. Introduction:**

The weekly field report describes the activities carried out by the Contractor (Cashman/Tripp Marine), the Owner's Representative (Apex Companies, LLC), and any subcontractors completing work within the scope of the project requirements.

This Weekly Field Report represents the fourteenth Report associated with Phase I dredging of the LHCC in New Bedford Harbor, and the associated handling and disposal of dredged materials at CAD cells within the Harbor, and at designated open-water disposal sites approved for this Project.

This 14<sup>th</sup> Report for the LHCC dredging activities includes:

- Daily Inspection Reports from the dredging oversight performed during the week of February 2<sup>nd</sup> through February 8<sup>th</sup>, 2014. Daily contractor activities are included in the form of Daily Inspection Reports noting equipment observed on site and a summary of contractor activities. (See Attachment 1);
- Water Quality Monitoring Forms completed for the week of February 2<sup>nd</sup> through February 8<sup>th</sup>, 2014 are attached (See Attachment 2). Included with the attached forms is Figure 1 Lower Harbor CAD Cell Phase I Water Quality Monitoring Plan, which shows the locations of the water quality monitoring events conducted during this reporting period. Per the approved Water Quality Monitoring Plan and associated performance standards for the dredging efforts being conducted during this reporting period, Apex has:
  - Conducted water quality monitoring a minimum of one day per week.
  - Performed visual inspections of dredged materials in the disposal scow for any visible debris or other items that could potential become a hazard to navigation prior to scow's departure for the offshore disposal site.

**Summary:**

The Contractor through its subcontractor, Tripp Marine conducted dredging at the LHCC on February 3<sup>rd</sup>, 4<sup>th</sup>, and 7<sup>th</sup>. Dredging operations focused on the strategic removal of Phase I Bottom of CAD Cell sediments to open up a 125-foot wide deep water channel entering in from the southwest corner of the LHCC to facilitate the access of larger barge mounted dredge equipment expected on site. During this reporting period dredging operations were conducted using a conventional digging bucket, with dredged materials being disposed offshore at the Rhode Island Sound Disposal Site (RISDS). Tripp Marine was observed conducting these activities during the authorized operational window of 7AM until sunset, utilizing a single dredge plant; the tug *Sand Pebble*; a 900 cubic yard dump scow – *TMC 140*; and two small utility boats. With time of year restrictions now in place (January 15<sup>th</sup> through June 15<sup>th</sup>) all dredging activities were conducted within a silt curtained perimeter surrounding the LHCC.

## 2. Operational Notes:

### Dredging:

Dredging of LHCC Phase I Bottom of CAD sediments continued during the week. Dredging operations focused on the strategic removal of sediments to open up a 125-foot wide deep water access channel. Apex conducted one day of water quality monitoring on February 7<sup>th</sup>, while dredging was being performed to ensure that this activity did not result in an exceedance of any project-specific water quality standards.

### Offshore Disposal:

Offshore disposal for LHCC Phase I Bottom of CAD sediments is scheduled and permitted for the Rhode Island Sound Disposal Site. Three offshore disposal events, using the dump scow TMC-140, were recorded during the week and occurred on February 2<sup>nd</sup>, 6<sup>th</sup> and 7<sup>th</sup>. Adverse weather and sea conditions offshore limited dredging and disposal activities during the week.

Table 1 – Cumulative Dredging Progress

Period of Activity	Volume (cy)
Approximate Top of CAD Volume Dredged to Date*	24,890
Approximate Bottom of CAD Volume Dredged this Reporting Period	2,400
Approximate Bottom of CAD Volume Dredged to Date*	4,600

\* Dredge volume quantities are estimated based on observed scow draft marks and an assumed density of the materials dredged. Given the uncertainty in the density of a composite mix of sediments being dredged, all volumes are confirmed and adjusted as necessary using bathymetric survey data.

## 3. Monitoring Summary

There were no water quality exceedances observed during this reporting period related to dredging operations. No water quality samples were collected.

Prepared by:  
Apex Companies, LLC



John B. McAllister, P.E.  
Senior Project Engineer



Don Boyé  
Senior Project Manager

Attachment 1  
Daily Inspection Reports



**City of New Bedford Harbor Development Commission**  
**New Bedford Harbor USEPA Lower Harbor CAD Cell**  
**CFDA No.: 66.802**

**Inspection Report**

**Inspector:** C. Stillman **Date:** 03 February 2014

**Contractor:** Tripp Marine **Foreman/Supt:** Pyne Tripp

**Weather** AM: Fog / Snow **Temperature** AM: 28  
PM: Fog/Snow Winds 5-10k N PM: 42

**Tides** High 1025 AM 2254 PM  
Low 0339 AM 1553 PM

**Manpower Onsite**

Foreman 1 @ 8 Hrs  
Operators 1 @ 8 Hrs  
Laborers 1 @ 8 Hrs  
Drivers \_\_\_\_\_ @ \_\_\_\_\_ Hrs  
Other: \_\_\_\_\_ @ \_\_\_\_\_ Hrs

**Equipment Onsite**

Description: Dredge Tripp 47 Hrs. 8  
Scow TMC 140 Hrs. 8  
Push boat Sand Pebble Hrs. 8  
Support boat Hrs. 8  
Scow SEI 2000 Hrs. 0

**Contractor Activities: (Attach Additional Sheets as Necessary)**

Apex on-site at 0545 and is informed by Tripp Marine that dredging will begin at 0815. Dredging begins on schedule with materials being placed into scow TMC-140. Dredging continued until 1527 with end-of-day draft marks on the partially filled scow at 5' FWD and 7' AFT. Apex informed that dredging would resume at 0715 on 04FEB. Apex departs site at 1545.

No water quality issues were observed.

**Problems/Issues or Action Items:**

None / n/a

**Visitors:**

**Signature:** D. Boye

**Title:** \_\_\_\_\_

**Copy to:** file

**Date:** 03 February 2014

**Page:** 1 of 1

**File:** DIR\_LHCC\_020314



**City of New Bedford Harbor Development Commission**  
**New Bedford Harbor USEPA Lower Harbor CAD Cell**  
**CFDA No.: 66.802**

**Inspection Report**

**Inspector:** J. Ray and B. Young

**Date:** 04 February 2014

**Contractor:** Tripp Marine Foreman/Supt: Pyne Tripp

<b>Weather</b>	AM:	<u>Clear</u>	<b>Temperature</b>	AM:	<u>34</u>
	PM:	<u>Clear. Winds 5k NW</u>		PM:	<u>21</u>
<b>Tides</b>	High	<u>1118</u>	AM	<u>2349</u>	PM
	Low	<u>0427</u>	AM	<u>1633</u>	PM

**Manpower Onsite**

**Equipment Onsite**

Foreman	<u>1</u>	@	<u>8</u>	Hrs	Description:	<u>Dredge Tripp 47</u>	Hrs.	<u>8</u>
Operators	<u>1</u>	@	<u>8</u>	Hrs		<u>Scow TMC 140</u>	Hrs.	<u>8</u>
Laborers	<u>1</u>	@	<u>8</u>	Hrs		<u>Push boat Sand Pebble</u>	Hrs.	<u>8</u>
Drivers		@		Hrs		<u>Support boat</u>	Hrs.	<u>8</u>
Other:		@		Hrs		<u>Scow SEI 2000</u>	Hrs.	<u>0</u>

**Contractor Activities: (Attach Additional Sheets as Necessary)**

Apex on-site at 0758 to oversee dredging activities. 0843- Dredge Tripp 47 is moved into position to begin dredging. 0845- Dredge Tripp 47 begins dredging into Scow TMC 140. Dredge is facing west and dredging in between piles #2 and #3 approximately 100 feet north of the southern boundary of the silt curtain. 0855- TMC 140 draft- stern: 7.5', bow: 5'. 1055- Tripp 47 is not dredging. 1445- Tripp 47 resumes dredging near piles #2 and #3 in the southwest corner of the silt curtain area. 1630- Tripp 47 stops dredging for the day. TMC 140 draft- stern: 11' , bow: 9'

No water quality issues were observed during the day.

**Problems/Issues or Action Items:**

None / N/A

**Visitors:**

**Signature:** J. McAllister

**Date:** 04 February 2014

**Title:** \_\_\_\_\_

**Page:** 1 of 1

**Copy to:** file

**File:** DIR\_LHCC\_020414



**City of New Bedford Harbor Development Commission**  
**New Bedford Harbor USEPA Lower Harbor CAD Cell**  
**CFDA No.: 66.802**

**Inspection Report**

**Inspector:** C. Stillman **Date:** 05 February 2014

**Contractor:** Tripp Marine **Foreman/Supt:** Pyne Tripp

**Weather** AM: Overcast / Fog **Temperature** AM: 25  
PM: Rain/Snow. Winds 10-15k NNE PM: 34

**Tides** High - AM 1212 PM  
Low 0521 AM 1717 PM

**Manpower Onsite**

**Equipment Onsite**

Foreman	<u>      </u>	@	<u>      </u>	Hrs	Description:	<u>Dredge Tripp 47</u>	Hrs.	<u>      </u>
Operators	<u>      </u>	@	<u>      </u>	Hrs		<u>Scow TMC 140</u>	Hrs.	<u>      </u>
Laborers	<u>      </u>	@	<u>      </u>	Hrs		<u>Push boat Sand Pebble</u>	Hrs.	<u>      </u>
Drivers	<u>      </u>	@	<u>      </u>	Hrs		<u>Support boat</u>	Hrs.	<u>      </u>
Other:	<u>      </u>	@	<u>      </u>	Hrs		<u>Scow SEI 2000</u>	Hrs.	<u>      </u>

**Contractor Activities: (Attach Additional Sheets as Necessary)**

Apex on-site at 0500 to observe scow TMC-140 fully loaded from the prior days dredging. Informed by Tripp Marine that dredging will not occur today due to the full loaded scow, and that the current weather and offshore sea conditions will delay a disposal run to the Rhode Island Sound Disposal Site until the evening of 06FEB. Apex departs site.

No water quality issues were observed.

**Problems/Issues or Action Items:**

None / n/a

Visitors: \_\_\_\_\_

Signature: D. Boye

Date: 05 February 2014

Title: \_\_\_\_\_

Page: 1 of 1

Copy to: file

File: DIR\_LHCC\_020514



**City of New Bedford Harbor Development Commission**  
**New Bedford Harbor USEPA Lower Harbor CAD Cell**  
**CFDA No.: 66.802**

**Inspection Report**

**Inspector:** C. Stillman **Date:** 06 February 2014

**Contractor:** Tripp Marine **Foreman/Supt:** Pyne Tripp

**Weather** AM: Overcast. **Temperature** AM: 16  
PM: Snow. Winds 5-10k NW PM: 30

**Tides** High 0044 AM 1306 PM  
Low 0645 AM 1809 PM

**Manpower Onsite**

**Equipment Onsite**

Foreman	<u>      </u>	@	<u>      </u>	Hrs	Description:	<u>Dredge Tripp 47</u>	Hrs.	<u>      </u>
Operators	<u>      </u>	@	<u>      </u>	Hrs		<u>Scow TMC 140</u>	Hrs.	<u>12</u>
Laborers	<u>      </u>	@	<u>      </u>	Hrs		<u>Push boat Sand Pebble</u>	Hrs.	<u>4</u>
Drivers	<u>      </u>	@	<u>      </u>	Hrs		<u>Support boat</u>	Hrs.	<u>      </u>
Other:	<u>      </u>	@	<u>      </u>	Hrs		<u>Tug Guilford Courthouse</u>	Hrs.	<u>12</u>

**Contractor Activities: (Attach Additional Sheets as Necessary)**

Apex on-site at 0830; no activity observed on-site. Informed by Tripp Marine at 1045 that scow TMC-140 is scheduled to depart for offshore disposal at the Rhode Island Sound Disposal site at 1430 today. Observed tug Guilford Courthouse and push boat Sand Pebble at 1530 maneuvering scow into position for readying scow for transit offshore.

No water quality issues were observed.

**Problems/Issues or Action Items:**

None / n/a

Visitors: \_\_\_\_\_

Signature: D. Boye

Date: 06 February 2014

Title: \_\_\_\_\_

Page: 1 of 1

Copy to: file

File: DIR\_LHCC\_020614



**City of New Bedford Harbor Development Commission**  
**New Bedford Harbor USEPA Lower Harbor CAD Cell**  
**CFDA No.: 66.802**

**Inspection Report**

**Inspector:** M. Martinho **Date:** 07 February 2014

**Contractor:** Tripp Marine **Foreman/Supt:** Pyne Tripp

**Weather** AM: Clear. **Temperature** AM: 10  
PM: Sunny. Winds 10k or less. WSW PM: 30

**Tides** High 0141 AM 1403 PM  
Low 0839 AM 1912 PM

**Manpower Onsite**

Foreman 1 @ 8 Hrs  
Operators 1 @ 8 Hrs  
Laborers 1 @ 8 Hrs  
Drivers \_\_\_\_\_ @ \_\_\_\_\_ Hrs  
Other: \_\_\_\_\_ @ \_\_\_\_\_ Hrs

**Equipment Onsite**

Description: Dredge Tripp 47 Hrs. 8  
Scow TMC 140 Hrs. 8  
Push boat Sand Pebble Hrs. 8  
Support boat Hrs. 8  
Scow SEI 2000 Hrs. 0

**Contractor Activities: (Attach Additional Sheets as Necessary)**

Apex on-site at 0645; no activity observed on-site. Tripp Marine personnel arrive at 0730, and after mobilization, dredging begins at 0825. Dredge operations conducted within the confines of a silt curtain perimeter. Apex conducts water quality monitoring survey. Dredging continues until 1413 with all dredged materials loaded into scow TMC-140. End-of-day draft marks on the scow were 9' FWD and 11' AFT.

At 1520 Tripp Marine informs Apex that the schedule for transiting scow TMC-140 offshore for disposal has yet to be decided, but an update will be provided once the trip has been scheduled.

Apex departs site at 1630. No water quality issues were observed.

**Problems/Issues or Action Items:**

None / n/a

**Visitors:**

**Signature:** D. Boye

**Title:** \_\_\_\_\_

**Copy to:** file

**Date:** 07 February 2014

**Page:** 1 of 1

**File:** DIR\_LHCC\_020714





**City of New Bedford Harbor Development Commission**  
**New Bedford Harbor USEPA Lower Harbor CAD Cell**  
**CFDA No.: 66.802**  
**Inspection Report**

**Inspector:** M. Tumolo **Date:** 08 February 2014

**Contractor:** Tripp Marine **Foreman/Supt:** Pyne Tripp

**Weather** AM: Clear **Temperature** AM: 17  
PM: Sunny. Winds 5-10k W PM: 28

**Tides** High 0241 AM 1503 PM  
Low 0944 AM 2023 PM

**Manpower Onsite**

Foreman \_\_\_\_\_ @ \_\_\_\_\_ Hrs  
Operators \_\_\_\_\_ @ \_\_\_\_\_ Hrs  
Laborers \_\_\_\_\_ @ \_\_\_\_\_ Hrs  
Drivers \_\_\_\_\_ @ \_\_\_\_\_ Hrs

Other: \_\_\_\_\_ @ \_\_\_\_\_ Hrs

**Equipment Onsite**

Description: Dredge Tripp 47 Hrs. \_\_\_\_\_  
Scow TMC 140 Hrs. 12  
Push boat Sand Pebble Hrs. 4  
Support boat Hrs. \_\_\_\_\_  
Tug Guilford Courthouse Hrs. 12

**Contractor Activities: (Attach Additional Sheets as Necessary)**

0700 No activity occurring on-site. Apex observes scow TMC-140 returning northbound through the Rte. 6 bridge at 0815. Apex at LHCC site at 0850; no Tripp Marine staff observed. Apex contacts Tripp Marine at 0930 via cellular and is informed that dredging will not be performed today. Apex departs site at 0945.

No water quality issues were observed.

**Problems/Issues or Action Items:**

None / n/a

**Visitors:** \_\_\_\_\_

**Signature:** D. Boye

**Title:** \_\_\_\_\_

**Copy to:** file

**Date:** 08 February 2014

**Page:** 1 of 1

**File:** DIR\_LHCC\_020814

Attachment 2  
Water Quality Monitoring Forms

PROJECT:	New Bedford Harbor Lower Harbor CAD Cell		
JOB NUMBER:	6724		
SURVEY DATE:	07 February 2014		
MONITORS:	M. Martinho		
WEATHER CONDITIONS:	Mostly cloudy	Low: 10	High: 30
WIND CONDITIONS:	Speed: 10k or less	Direction: WSW	
PRIOR STORM EVENTS:	N/A		
DREDGE / SCOW Position:	Northing/Easting: SW corner of curtained area.		
TYPE OF WATER QUALITY MONITORING EVENT:	TOP CAD Dredging / BTM CAD Dredging / Disposal		
TIDE INFORMATION:	High: 0141/1403	Low: 0839/1912	
WAS WATER QUALITY SAMPLING PERFORMED? (YES/NO):	N	IF YES, ATTACH COC FORMS	
GENERAL NOTES:	Dredging begins at 0825, loading Bottom of CAD sediments into scow TMC-140. Dredging ends for the day at 1413.		



**UP-CURRENT**

Monitoring ID #	NORTHING / EASTING	TIME	TOTAL WATER DEPTH (ft)	SAMPLE DEPTH (ft)	TURBIDITY (NTUs)	GPS FILE NAME	TIDAL STAGE	RELATIVE POSITION OF MEASUREMENT	NUMBER OF HOURS DREDGING
020714-00-1-1	2697030 / 815297	0830	4.2	1	3.4		Ebbing / Slack	200' N of Dredge	0
020714-00-1-2		0832		2	4.3				
020714-00-1-4		0834		4	4.7				
					AVERAGE TURBIDITY:			4.13	
020714-02-1-1	2696565 / 815002	1030	8.1	1	2.9		Flooding tide	200' S of Dredge	2
020714-02-1-4		1032		4	3.5				
020714-02-1-8		1034		8	3.9				
					AVERAGE TURBIDITY:			3.43	
020714-04-1-1	2696594 / 814850	1230	11.6	1	3.4		Flooding tide	200' S of Dredge	4
020714-04-1-5		1232		5	3.9				
020714-04-1-10		1234		10	4.2				
					AVERAGE TURBIDITY:			3.83	
020714-06-1-1	2696565 / 815002	1430	10.1	1	3.7		Ebbing	200' N of Dredge	6
020714-06-1-5		1432		5	3.6				
020714-06-1-9		1434		9	3.8				
					AVERAGE TURBIDITY:			3.70	
					AVERAGE TURBIDITY:				

**Down-Current**

Monitoring ID #	NORTHING / EASTING	TIME	TOTAL WATER DEPTH (ft)	SAMPLE DEPTH (ft)	TURBIDITY (NTUs)	GPS FILE NAME	TIDAL STAGE	DISTANCE FROM LOCATION	NUMBER OF HOURS DREDGING
020714-00-9-1	2696546 / 815115	0840	6.8	1	3.9		Ebbing / Slack	200' S of Dredge	0
020714-00-9-3		0842		3	4.2				
020714-00-9-6		0844		6	4.4				
					AVERAGE TURBIDITY:			4.17	
					TURBIDITY INCREASE:			0.03	
020714-02-9-1	2697014 / 815204	1040	4.6	1	3.3		Flooding tide	200' N of Dredge	2
020714-02-9-2		1042		2	6.8				
020714-02-9-4		1044		4	9.1				
					AVERAGE TURBIDITY:			6.40	
					TURBIDITY INCREASE:			2.97	
020714-04-9-1	2697026 / 815419	1240	10.6	1	4.7		Flooding tide	200' N of Dredge	4
020714-04-9-5		1242		5	6.9				
020714-04-9-10		1244		10	9.4				
					AVERAGE TURBIDITY:			7.00	
					TURBIDITY INCREASE:			3.17	
020714-06-9-1	2696909 / 814865	1435	12.2	1	2.7		Ebbing	200' S of Dredge	6
020714-06-9-5		1437		5	3.9				
020714-06-9-11		1439		11	4.6				
					AVERAGE TURBIDITY:			3.73	
					TURBIDITY INCREASE:			0.03	
					AVERAGE TURBIDITY:				
					TURBIDITY INCREASE:				

\* Turbidity Increase = Down-Current Average Turbidity - Up-Current Average Turbidity

Figure 1  
Lower Harbor CAD Cell Phase I – Water Quality Monitoring

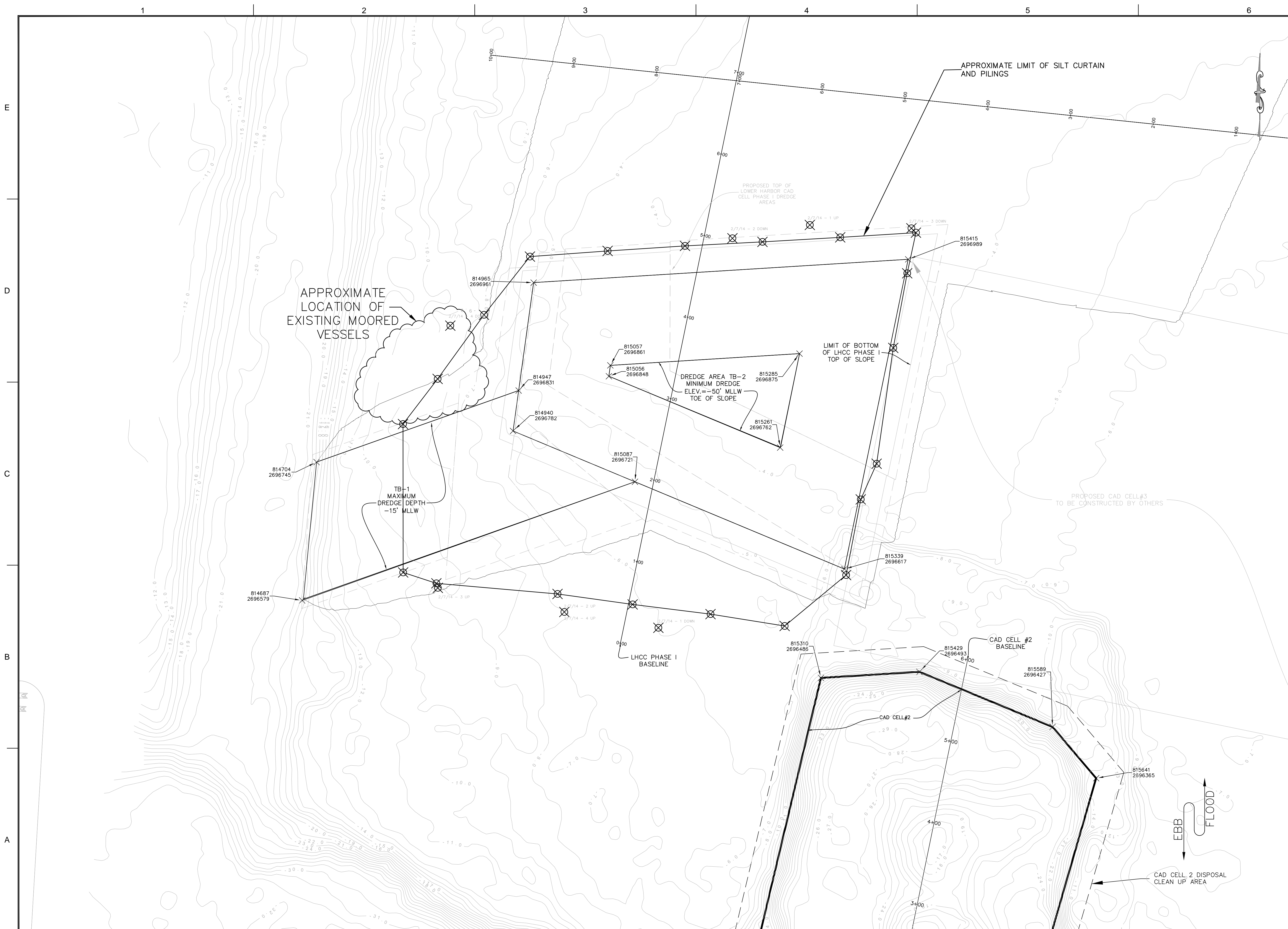

ROCKVILLE, MD  
SOUTH WINDSOR, CT - BOSTON, MA -  
NEW BEDFORD, MA - HOLYOKE, MA  
125 BROAD STREET, 5TH FLOOR  
BOSTON, MA 02210  
58H CONNECTICUT AVENUE  
SOUTH WINDSOR, CT

The drawings prepared by Apex for this project are instruments of Apex's service for use solely with respect to the project and general site conditions shown on the drawings and do not constitute a warranty, liability and other reserved rights with respect thereto, including the copyright. The Documents shall not be used on other projects, for addition to this project or for completion of this project by others, except by agreement in writing and with appropriate compensation to Apex.

PROJECT	NEW BEDFORD HARBOR DEVELOPMENT COMMISSION LOWER HARBOR CAD CELL	
	OWNER	NEW BEDFORD HARBOR DEVELOPMENT COMMISSION 52 FISHERMAN'S WHARF, NEW BEDFORD, MA 02740

1	9/25/2012	EPA COMMENTS	GCD
2	2/21/2013	DRAFT SUITABILITY	MCK

DATE	DESCRIPTION	BY
9/25/2012	EPA COMMENTS	GCD
2/21/2013	DRAFT SUITABILITY	MCK

PROJECT NO.	6724
CADD FILE	
DESIGNED BY	CHM
DRAWN BY	GCD
CHECKED BY	GCD
DATE	MAY 2013
DRAWING SCALE	AS NOTED

GRAPHIC SCALE  
SCALE: 1"=50'  
0 25 50 100

SHEET TITLE

**BOTTOM OF LOWER HARBOR CAD CELL PHASE 1 WATER QUALITY**  
2/2/14-2/8/14

DRAWING NO.

**WQM-1**

6 OF 15