

Weekly Field Report  
Week: 01-26-14 through 02-01-14  
New Bedford Harbor Lower Harbor CAD Cell (LHCC)

This Weekly Field Report was prepared to serve as a summary of field activities conducted throughout the week for Phase I dredging of the New Bedford Harbor Lower Harbor CAD Cell (LHCC) in New Bedford, Massachusetts.

**1. Introduction:**

The weekly field report describes the activities carried out by the Contractor (Cashman/Tripp Marine), the Owner's Representative (Apex Companies, LLC), and any subcontractors completing work within the scope of the project requirements.

This Weekly Field Report represents the thirteenth Report associated with Phase I dredging of the LHCC in New Bedford Harbor, and the associated handling and disposal of dredged materials at CAD cells within the Harbor, and at designated open-water disposal sites approved for this Project.

This 13<sup>th</sup> Report for the LHCC dredging activities includes:

- Daily Inspection Reports from the dredging oversight performed during the week of January 26<sup>th</sup> through February 1<sup>st</sup>, 2014. Daily contractor activities are included in the form of Daily Inspection Reports noting equipment observed on site and a summary of contractor activities. (See Attachment 1);
- Water Quality Monitoring Forms completed for the week of January 26<sup>th</sup> through February 1<sup>st</sup>, 2014 are attached (See Attachment 2). Included with the attached forms is Figure 1 Lower Harbor CAD Cell Phase I Water Quality Monitoring Plan, which shows the locations of the water quality monitoring events conducted during this reporting period. Per the approved Water Quality Monitoring Plan and associated performance standards for the dredging efforts being conducted during this reporting period, Apex has:
  - Conducted water quality monitoring a minimum of one day per week, with the intent of monitoring the first three days of construction activities.
  - Performed visual inspections of dredged materials in the disposal scow for any visible debris or other items that could potential become a hazard to navigation prior to scow's departure for the offshore disposal site.

**Summary:**

The Contractor through its subcontractor, Tripp Marine conducted dredging at the LHCC on January 27<sup>th</sup> and 31<sup>st</sup>, and February 1<sup>st</sup>. Dredging operations continued to focus on the strategic removal of Phase I Bottom of CAD Cell sediments to open up a 125-foot wide deep water channel entering in from the southwest corner of the LHCC to facilitate the access of larger barge mounted dredge equipment expected on site. During this reporting period dredging operations were conducted using a conventional digging bucket, with dredged materials being disposed offshore at the Rhode Island Sound Disposal Site (RISDS). Tripp Marine was observed conducting these activities during the authorized operational window of 7AM until sunset, utilizing a single dredge plant; the tug *Sand Pebble*; a 900 cubic yard dump scow – *TMC 140*; and two small utility boats. With time of year restrictions now in place (January 15<sup>th</sup> through June 15<sup>th</sup>) all dredging activities were conducted within a silt curtained perimeter surrounding the LHCC.

## 2. Operational Notes:

### Dredging:

Dredging of LHCC Phase I Bottom of CAD sediments continued during the week. Dredging operations focused on the strategic removal of sediments to open up a 125-foot wide deep water access channel. Apex conducted two days of water quality monitoring, on January 27<sup>th</sup> and 31<sup>st</sup>, while dredging was being performed to ensure that these activities did not result in an exceedance of any project-specific water quality standards.

### Offshore Disposal:

Offshore disposal for LHCC Phase I Bottom of CAD sediments is scheduled and permitted for the Rhode Island Sound Disposal Site. Two offshore disposal events, using the dump scow TMC-140, were recorded during the week and occurred on January 30<sup>th</sup> and January 31<sup>st</sup>. Adverse weather and sea conditions offshore limited dredging and disposal activities during the week.

Table 1 – Cumulative Dredging Progress

Period of Activity	Volume (cy)
Approximate Top of CAD Volume Dredged to Date*	24,890
Approximate Bottom of CAD Volume Dredged this Reporting Period	1,600
Approximate Bottom of CAD Volume Dredged to Date*	2,200

\* Dredge volume quantities are estimated based on observed scow draft marks and an assumed density of the materials dredged. Given the uncertainty in the density of a composite mix of sediments being dredged, all volumes are confirmed and adjusted as necessary using bathymetric survey data.

## 3. Monitoring Summary

There were no water quality exceedances observed during this reporting period related to dredging operations. No water quality samples were collected.

Prepared by:  
Apex Companies, LLC



John B. McAllister, P.E.  
Senior Project Engineer



Don Boyé  
Senior Project Manager

Attachment 1  
Daily Inspection Reports



**City of New Bedford Harbor Development Commission**  
**New Bedford Harbor USEPA Lower Harbor CAD Cell**  
**CFDA No.: 66.802**  
**Inspection Report**

**Inspector:** Chris Stillman

**Date:** 20 January 2014

**Contractor:** Tripp Marine

**Foreman/Supt:** Tripp Pyne

<b>Weather</b>	AM:	<u>Clear</u>	<b>Temperature</b>	AM:	<u>30</u>
	PM:	<u>Cloudy</u>		PM:	<u>45</u>

<b>Tides</b>	High	<u>1012</u>	AM	<u>2245</u>	PM
	Low	<u>321</u>	AM	<u>1542</u>	PM

**Manpower Onsite**

Foreman 0 @ 0 Hrs  
Operators 0 @ 0 Hrs  
Laborers 0 @ 0 Hrs  
Drivers \_\_\_\_\_ @ \_\_\_\_\_ Hrs

Other: \_\_\_\_\_ @ \_\_\_\_\_ Hrs

**Equipment Onsite**

Description: Dredge Tripp 47 Hrs. 0  
Scow TMC 140 Hrs. 0  
Push boat Sand Pebble Hrs. 0  
Support boat Hrs. 0  
Scow SEI 2000 Hrs. \_\_\_\_\_

**Contractor Activities: (Attach Additional Sheets as Necessary)**

0530 Apex on site - no activity at this time. 1317 Apex on site, still no activity at this time.

**Problems/Issues or Action Items:**

**Visitors:** \_\_\_\_\_

**Signature:** K Ryan

**Date:** 20 January 2014

**Title:** \_\_\_\_\_

**Page:** 1 of 1

**Copy to:** file

**File:** DIR\_LHCC\_011814



**City of New Bedford Harbor Development Commission**  
**New Bedford Harbor USEPA Lower Harbor CAD Cell**  
**CFDA No.: 66.802**  
**Inspection Report**

**Inspector:** C Stillman

**Date:** 21 January 2014

**Contractor:** Tripp Marine

**Foreman/Supt:** Pyne Tripp

<b>Weather</b>	AM:	<u>Clear</u>	<b>Temperature</b>	AM:	<u>14</u>
	PM:	<u>Cloudy</u>		PM:	<u>29</u>

<b>Tides</b>	High	<u>1054</u>	AM	<u>2329</u>	PM
	Low	<u>0400</u>	AM	<u>1616</u>	PM

**Manpower Onsite**

Foreman 0 @ 0 Hrs  
Operators 0 @ 0 Hrs  
Laborers 0 @ 0 Hrs  
Drivers \_\_\_\_\_ @ \_\_\_\_\_ Hrs

Other: \_\_\_\_\_ @ \_\_\_\_\_ Hrs

**Equipment Onsite**

Description: Dredge Tripp 47 Hrs. 0  
Scow TMC 140 Hrs. 0  
Push boat Sand Pebble Hrs. 0  
Support boat Hrs. 0  
Scow SEI 2000 Hrs. 0

**Contractor Activities: (Attach Additional Sheets as Necessary)**

0624 Apex on site, no activity at this time. 1421 Still no activity on site, after periodic checks throughout the day and confirmation from the Dredge Captain.

**Problems/Issues or Action Items:**

Visitors: \_\_\_\_\_

Signature: K Ryan

Title: \_\_\_\_\_

Copy to: file

Date: 21 January 2014

Page: 1 of 1

File: DIR\_LHCC\_012114



**City of New Bedford Harbor Development Commission**  
**New Bedford Harbor USEPA Lower Harbor CAD Cell**  
**CFDA No.: 66.802**  
**Inspection Report**

**Inspector:** K Ryan

**Date:** 22 January 2014

**Contractor:** Tripp Marine

**Foreman/Supt:** Pyne Tripp

<b>Weather</b>	AM:	<u>Overcast</u>	<b>Temperature</b>	AM:	<u>7</u>
	PM:	<u>Clear</u>		PM:	<u>17</u>

<b>Tides</b>	High	<u>1143</u>	AM	<u>          </u>	PM
	Low	<u>0442</u>	AM	<u>1656</u>	PM

**Manpower Onsite**

Foreman 0 @ 0 Hrs  
Operators 0 @ 0 Hrs  
Laborers 0 @ 0 Hrs  
Drivers 0 @ 0 Hrs

Other:                      @            Hrs

**Equipment Onsite**

Description: Dredge Tripp 47 Hrs. 0  
Scow TMC 140 Hrs. 0  
Push boat Sand Pebble Hrs. 0  
Support boat Hrs. 0  
Scow SEI 2000 Hrs. 0

**Contractor Activities: (Attach Additional Sheets as Necessary)**

0548 Apex on site not activity at this time. 0847 No activity at this time. 1526 Still no activity at this time, including periodic checks throughout the day. No activity for the day confirmed by the Dredge Captain.

**Problems/Issues or Action Items:**

Visitors:                     

Signature: K Ryan

Title:                     

Copy to: file

Date: 22 January 2014

Page: 1 of 1

File: DIR\_LHCC\_012214



**City of New Bedford Harbor Development Commission**  
**New Bedford Harbor USEPA Lower Harbor CAD Cell**  
**CFDA No.: 66.802**  
**Inspection Report**

**Inspector:** C Stillman

**Date:** 23 January 2014

**Contractor:** Tripp Marine

**Foreman/Supt:** Pyne Tripp

<b>Weather</b>	AM:	<u>Clear</u>	<b>Temperature</b>	AM:	<u>4</u>
	PM:	<u>Clear</u>		PM:	<u>20</u>

<b>Tides</b>	High	<u>1217</u>	AM	<u>0031</u>	PM
	Low	<u>0533</u>	AM	<u>1746</u>	PM

**Manpower Onsite**

Foreman 0 @ 0 Hrs  
Operators 0 @ 0 Hrs  
Laborers 0 @ 0 Hrs  
Drivers 0 @ 0 Hrs

Other: \_\_\_\_\_ @ \_\_\_\_\_ Hrs

**Equipment Onsite**

Description: Dredge Tripp 47 Hrs. 0  
Scow TMC 140 Hrs. 0  
Push boat Sand Pebble Hrs. 0  
Support boat Hrs. 0  
Scow SEI 2000 Hrs. 0

**Contractor Activities: (Attach Additional Sheets as Necessary)**

0530 Apex on site not activity at this time. 1217 No activity at this time. 1530 Still no activity at this time, including periodic checks throughout the day. No activity for the day confirmed by the Dredge Captain.

**Problems/Issues or Action Items:**

**Visitors:** \_\_\_\_\_

**Signature:** K Ryan

**Title:** \_\_\_\_\_

**Copy to:** file

**Date:** 23 January 2014

**Page:** 1 of 1

**File:** DIR\_LHCC\_012314



**City of New Bedford Harbor Development Commission**  
**New Bedford Harbor USEPA Lower Harbor CAD Cell**  
**CFDA No.: 66.802**  
**Inspection Report**

**Inspector:** C Stillman **Date:** 24 January 2014

**Contractor:** Tripp Marine **Foreman/Supt:** Pyne Tripp

**Weather** AM: Clear **Temperature** AM: 7  
PM: Clear PM: 17

**Tides** High 0109 AM 1327 PM  
Low 0637 AM 1848 PM

**Manpower Onsite**

Foreman 1 @ 8 Hrs  
Operators 1 @ 8 Hrs  
Laborers 1 @ 8 Hrs  
Drivers \_\_\_\_\_ @ \_\_\_\_\_ Hrs

Other: \_\_\_\_\_ @ \_\_\_\_\_ Hrs

**Equipment Onsite**

Description: Dredge Tripp 47 Hrs. 8  
Scow TMC 140 Hrs. 8  
Push boat Sand Pebble Hrs. 8  
Support boat Hrs. 8  
Scow SEI 2000 Hrs. 0

**Contractor Activities: (Attach Additional Sheets as Necessary)**

0505 Apex on site, no activity at this time. 0951 Pyne on site with Dredge Tripp 47, Sand Pebble, and skiff, they are dropping curtain, no dredging at this time. 1202 Pyne begins dredging into the TMC-140 inside the silt curtain. 1230 dredging is occurring in the middle of silt curtained area. 1320 the TMC - 140 is drafting at: bow 3' and stern 3.5'. 1438 Tripp continues to dredge into the TMC - 140 drafting at: bow 3.5' and the stern 7'. 1550 Tripp Marine is finished for the day.

**Problems/Issues or Action Items:**

Visitors: \_\_\_\_\_

Signature: K Ryan

Title: \_\_\_\_\_

Copy to: file

Date: 24 January 2014

Page: 1 of 1

File: DIR\_LHCC\_2014





**City of New Bedford Harbor Development Commission**  
**New Bedford Harbor USEPA Lower Harbor CAD Cell**  
**CFDA No.: 66.802**  
**Inspection Report**

**Inspector:** K Ryan, J Thomson **Date:** 25 January 2014

**Contractor:** Tripp Marine **Foreman/Supt:** Pyne Tripp

**Weather** AM: Cloudy **Temperature** AM: 13  
PM: Showers PM: 40

**Tides** High 0206 AM 1428 PM  
Low 0753 AM 1956 PM

**Manpower Onsite**

Foreman 1 @ 1 Hrs  
Operators 1 @ 1 Hrs  
Laborers 1 @ 1 Hrs  
Drivers \_\_\_\_\_ @ \_\_\_\_\_ Hrs

Other: \_\_\_\_\_ @ \_\_\_\_\_ Hrs

**Equipment Onsite**

Description: Dredge Tripp 47 Hrs. 1  
Scow TMC 140 Hrs. 1  
Push boat Sand Pebble Hrs. 1  
Support boat Hrs. 1  
Scow SEI 2000 Hrs. 0

**Contractor Activities: (Attach Additional Sheets as Necessary)**

0755 Tripp Marine is not on site at the moment, they did notify Apex they would be on site at 1100. 1205 Tripp Marine is on site, no dredging at this time. 1215 Tripp begins dredging into the TMC - 140. 1252 Tripp stops dredging for the day; TMC - 140 drafting at: bow 5.5 and the stern 9'.

**Problems/Issues or Action Items:**

1328 talked with Pyne Tripp he said they decided to stop dredging activities due to heavy winds. He also added that they will not be able to perform their disposal until 01/28/2014 due to inclement weather. They are permitted to dispose of their material at the Rhode Island off shore disposal site.

Visitors: \_\_\_\_\_

Signature: K Ryan

Title: \_\_\_\_\_

Copy to: file

Date: 25 January 2014

Page: 1 of 1

File: DIR\_LHCC\_012514

Attachment 2  
Water Quality Monitoring Forms

PROJECT:	New Bedford Harbor Lower Harbor CAD Cell		
JOB NUMBER:	6724		
SURVEY DATE:	24 January 2014		
MONITORS:	M. Martinho		
WEATHER CONDITIONS:	Sunny / Clear	Low: 11	High: 15
WIND CONDITIONS:	Speed: 5-10k	Direction: NW	
PRIOR STORM EVENTS:	N/A		
DREDGE / SCOW Position:	Northing/Easting:		
TYPE OF WATER QUALITY MONITORING EVENT:	TOP CAD Dredging / BTM CAD Dredging / Disposal		
TIDE INFORMATION:	High: 0104/1325	Low: 0639/1847	
WAS WATER QUALITY SAMPLING PERFORMED? (YES/NO):	N IF YES, ATTACH COC FORMS		
GENERAL NOTES:	Dredging begins at 1202 for Bottom of CAD dredging which continued until 1550		



**UP-CURRENT**

Monitoring ID #	NORTHING / EASTING	TIME	TOTAL WATER DEPTH (ft)	SAMPLE DEPTH (ft)	TURBIDITY (NTUs)	GPS FILE NAME	TIDAL STAGE	RELATIVE POSITION OF MEASUREMENT	NUMBER OF HOURS DREDGING
012414-00-1-1	2696535 / 815046	1200	8.6	1	2.6		Flooding tide	200' S of Dredge	0
012414-00-1-4		1202		4	4				
012414-00-1-8		1204		8	4.5				
					AVERAGE TURBIDITY:	3.70			
012414-02-1-1	2697050 / 815113	1400	6.3	1	3.3		Ebbing	200' N of Dredge	2
012414-02-1-3		1402		3	3.9				
012414-02-1-6		1404		6	3.8				
					AVERAGE TURBIDITY:	3.67			
012414-04-1-1	2697025 / 814980	1600	5.8	1	3.4		Ebbing	200' N of Dredge	4
012414-04-1-2.5		1602		2.5	3.3				
012414-04-1-5		1604		5	3.2				
					AVERAGE TURBIDITY:	3.30			
					AVERAGE TURBIDITY:				
					AVERAGE TURBIDITY:				

**Down-Current**

Monitoring ID #	NORTHING / EASTING	TIME	TOTAL WATER DEPTH (ft)	SAMPLE DEPTH (ft)	TURBIDITY (NTUs)	GPS FILE NAME	TIDAL STAGE	DISTANCE FROM LOCATION	NUMBER OF HOURS DREDGING
012414-00-9-1	2697051 / 815065	1210	6	1	3.5		Flooding tide	200' N of Dredge	0
012414-00-9-2.5		1212		2.5	4.2				
012414-00-9-5		1214		5	4.6				
					AVERAGE TURBIDITY:	4.10			
					TURBIDITY INCREASE:	0.40			
012414-02-9-1	2696487 / 815217	1410	6.1	1	4.2		Ebbing	200' S of Dredge	2
012414-02-9-3		1412		3	4.4				
012414-02-9-5.5		1414		5.5	4.4				
					AVERAGE TURBIDITY:	4.33			
					TURBIDITY INCREASE:	0.67			
012414-04-9-1	2696604 / 814807	1610	13.2	1	5.4		Ebbing	200' S of Dredge	4
012414-04-9-6		1612		6	5.5				
012414-04-9-12		1614		12	5.3				
					AVERAGE TURBIDITY:	5.40			
					TURBIDITY INCREASE:	2.10			
					AVERAGE TURBIDITY:				
					TURBIDITY INCREASE:				
					AVERAGE TURBIDITY:				
					TURBIDITY INCREASE:				

\* Turbidity Increase = Down-Current Average Turbidity - Up-Current Average Turbidity

PROJECT: New Bedford Harbor Lower Harbor CAD Cell  
 JOB NUMBER: 6724  
 SURVEY DATE: 25 January 2014  
 MONITORS: K. Ryan, J. Thompson  
 WEATHER CONDITIONS: Rain/Snow Mix Low: 12 High: 39  
 WIND CONDITIONS: Speed: 15-20k Direction: SSW  
 PRIOR STORM EVENTS: N/A  
 DREDGE / SCOW Position: Northing/Easting:  
 TYPE OF WATER QUALITY MONITORING EVENT: TOP CAD Dredging / BTM CAD Dredging / Disposal  
 TIDE INFORMATION: High: 0200/1425 Low: 0758/1956  
 WAS WATER QUALITY SAMPLING PERFORMED? (YES/NO): N IF YES, ATTACH COC FORMS  
 GENERAL NOTES: Dredging begins at 1215 for Bottom of CAD dredging, which continued until 1252, after which activities stopped due to high wind conditions.



**UP-CURRENT**

Monitoring ID #	NORTHING / EASTING	TIME	TOTAL WATER DEPTH (ft)	SAMPLE DEPTH (ft)	TURBIDITY (NTUs)	GPS FILE NAME	TIDAL STAGE	RELATIVE POSITION OF MEASUREMENT	NUMBER OF HOURS DREDGING
012514-00-1-1	2696511 / 815138	1235	8.4	1	4.5		Flooding tide	200' S of Dredge	0
012514-00-1-4		1237		4	4.2				
012514-00-1-8		1239		8	7				
					AVERAGE TURBIDITY:				
					AVERAGE TURBIDITY:				
					AVERAGE TURBIDITY:				
					AVERAGE TURBIDITY:				
					AVERAGE TURBIDITY:				

**Down-Current**

Monitoring ID #	NORTHING / EASTING	TIME	TOTAL WATER DEPTH (ft)	SAMPLE DEPTH (ft)	TURBIDITY (NTUs)	GPS FILE NAME	TIDAL STAGE	DISTANCE FROM LOCATION	NUMBER OF HOURS DREDGING
012514-00-9-1	2697133 / 815207	1245	6.4	1	4.9		Flooding tide	200' N of Dredge	0
012514-00-9-3		1247		3	7.8				
012514-00-9-6		1249		6	6.6				
					AVERAGE TURBIDITY:	6.43			
					TURBIDITY INCREASE:	1.20			
					AVERAGE TURBIDITY:				
					TURBIDITY INCREASE:				
					AVERAGE TURBIDITY:				
					TURBIDITY INCREASE:				
					AVERAGE TURBIDITY:				
					TURBIDITY INCREASE:				
					AVERAGE TURBIDITY:				
					TURBIDITY INCREASE:				

\* Turbidity Increase = Down-Current Average Turbidity - Up-Current Average Turbidity

Figure 1  
Lower Harbor CAD Cell Phase I – Water Quality Monitoring

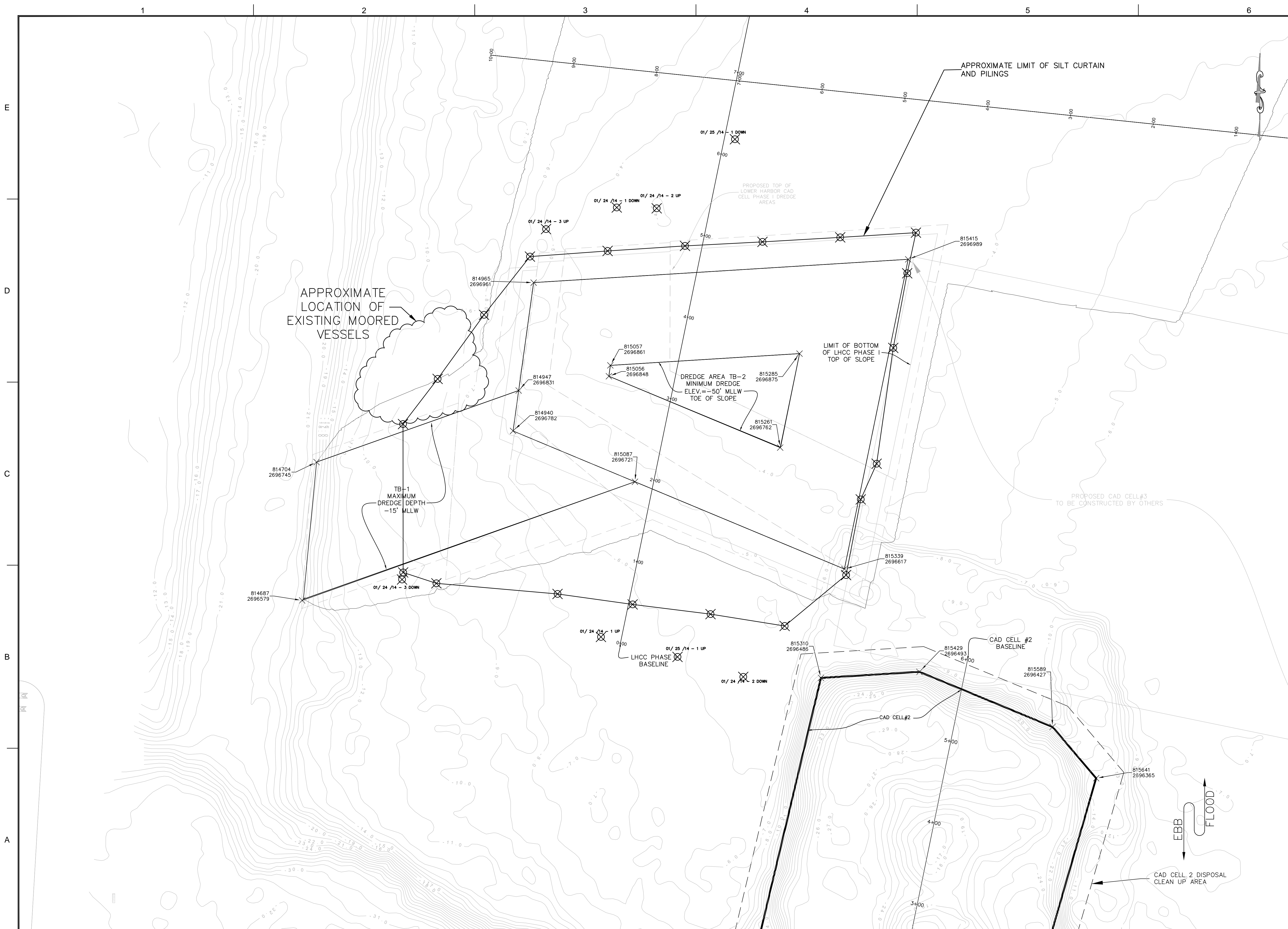

ROCKVILLE, MD  
SOUTH WINDSOR, CT - BOSTON, MA -  
NEW BEDFORD, MA - HOLYOKE, MA

125 BROAD STREET, 5TH FLOOR  
BOSTON, MA 02210  
58H CONNECTICUT AVENUE  
SOUTH WINDSOR, CT

The drawings prepared by Apex for this project are the property of Apex and are to be used only for the project and general use as shown on the drawings and shall not be used for any other project, in whole or in part, without the written consent of Apex. The drawings shall not be used for any other project, in whole or in part, without the written consent of Apex.

PROJECT	NEW BEDFORD HARBOR DEVELOPMENT COMMISSION LOWER HARBOR CAD CELL	
	OWNER	
OWNER	NEW BEDFORD HARBOR DEVELOPMENT COMMISSION 52 FISHERMAN'S WHARF, NEW BEDFORD, MA 02740	

1	9/25/2012	EPA COMMENTS	GCD
2	2/21/2013	DRAFT SUITABILITY	MCK

DATE	DESCRIPTION	BY
PROJECT NO.	6724	
CADD FILE		
DESIGNED BY	CHM	
DRAWN BY	GCD	
CHECKED BY	GCD	
DATE	MAY 2013	
DRAWING SCALE	AS NOTED	

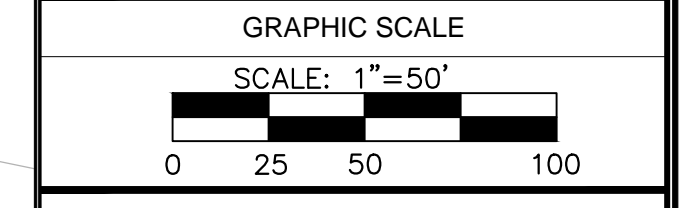

SHEET TITLE

**BOTTOM OF LOWER HARBOR CAD CELL PHASE 1 WATER QUALITY 1/19/14- 1/25/14**

DRAWING NO.

**WQM-1**

6 OF 15