

**ADMINISTRATIVE ORDER ON CONSENT
SECTION 122(g)(4) DE MINIMIS CONTRIBUTORS**

Superfund Record Center
SITE: Beede
BREAK: 10:7
OTHER: 41618

APPENDIX A

**RESPONDENTS AND RESPONDENT FEDERAL AGENCIES
TO ADMINISTRATIVE
ORDER ON CONSENT
(Beede Second De Minimis Settlement)**

**(TO BE PREPARED AFTER RECEIPT
OF SIGNATURE PAGES)**

Appendix A - List of Settling Parties

Appendix A - Section I - Respondents

AEP Industries, Inc.	0743	\$22,812.50
Agawam Service Center, Inc.	0118	\$8,750.00
Al & Paul's Auto Sales, Inc.	0134	\$8,750.00
All-Rite Auto, Inc.	0149	\$3,876.00
Altieri Service, Inc.	0179	\$7,187.50
A.M.A. Transportation Company, Inc.	0182	\$6,875.00
Anchor Motor Freight, Inc. (Penske Truck Leasing Company, LP)	0236	\$25,956.25
Andover Auto & Truck Service, Inc.	0246	\$9,375.00
Andover Street Motor Sports LP (d/b/a Acura of Peabody)	0092	\$28,750.00
Andy's Auto Service	0267	\$10,625.00
Anton's Cleaners, Inc.	0280	\$7,500.00
ARAMARK Uniform & Career Apparel, Inc.	0291	\$6,875.00
Arlax Oil Corporation	0306	\$15,500.00
Arrington Services, Inc.	3779	\$5,814.00
Arsenal Auto Service	1179	\$1,938.00
Atlantic Broom Service	0346	\$5,297.20
Auburndale Service Center LLC	0372	\$12,812.50
Auto Body & Tire Center, Inc. (d/b/a Cape Auto Body)	1552	\$8,937.50
Auto Craft Enterprises	0415	\$2,388.00
Auto Hospital	0390	\$2,261.00
Bailey Motor Sales, Inc.	0489	\$13,437.50
Baker-Wright Auto Electric Service	0496	\$10,468.75
Bancroft Motors, Inc.	0507	\$31,187.50
Barbas Trucking Company, Inc.	0513	\$2,907.00
Beacon Hill Sunoco	0554	\$2,584.00
Beaulieu Trucking	0560	\$4,179.00
Belmont Springs Water Company, Inc.	0587	\$11,875.00
Berardi Automotive, Inc.	6096	\$2,985.00
Berardi Bros Auto Body, Inc.	0617	\$5,671.50
Berman Repair & Sales, Inc.	0609	\$22,500.00
Betley Chevrolet Buick, Inc.	0603	\$15,437.50
Bettencourt Machine Company, Inc.	0626	\$13,437.50
Bill's Auto Repair	0643	\$6,312.50
BJ's Wholesale Club, Inc.	0658	\$7,437.50
Blakeslee Sales	0667	\$4,776.00
Blount Marine Corporation	0676	\$27,243.75
BME Engineering, Inc.	0681	\$18,918.75
Bob & Jim's Service Station, Inc.	0685	\$10,937.50
Bob Pion Pontiac-Buick-GMC, Inc.	4028	\$17,343.74
Borden Foods Corporation	GRP450	\$25,312.50
Boro Sand & Stone Corporation	0745	\$4,522.00
Bouchard & Son, Inc.	0770	\$11,875.00
Bresnahan Ice Company	0804	\$22,562.50
Brian Egan and Gregory Egan	1400	\$6,137.00
Brian's Auto Service, Inc.	0810	\$12,687.50
Broadway Foreign Auto Repairs	0837	\$1,938.00
Broadway Rental, Inc. (d/b/a Taylor Rental Center)	4937	\$10,937.50
Broadway Tire & Auto Company, Inc.	3929	\$31,093.75
Brockton Rental Service, Inc.	0850	\$14,375.00
Brodie, Inc.	0851	\$13,125.00
Brooks School	6073	\$11,250.00
Brownie's Texaco Service, Inc.	0865	\$25,781.25
Brown's Service Station	0871	\$8,437.50
Bruce's Tremont Street Garage	0877	\$6,875.00

Bubbles, Inc.	1545	\$6,875.00
Burke Distributing Corporation	0901	\$22,812.50
Cabot Cabot & Forbes	0201	\$9,531.25
Callan Automotive Service	0914	\$7,500.00
CambridgeSide Galleria, Inc.	3659	\$10,468.75
Campello Coal Company, Inc.	1148	\$10,393.75
Carlson's Motor Sales, Inc.	1793	\$16,937.50
Casoli Sand & Gravel, Inc.	1814	\$2,584.00
Cedarview Filling Station, Inc.	1829	\$3,766.18
Central Motors, Inc.	1848	\$17,500.00
Centre Trucking Service, Inc.	1855	\$5,522.55
Century Trailer Sales, Inc.	1857	\$2,907.00
Charles Doucette (d/b/a Charlie's Garage)	1880	\$3,068.50
Charles M. Rollins Company, Inc.	4367	\$8,750.00
Charlie's Auto Service	1877	\$5,491.00
Chicos Sunoco	1919	\$1,938.00
Chute Fuel	1931	\$4,845.00
City of Attleboro, MA	GRP304	\$8,437.50
City of Beverly, MA	GRP308	\$3,553.00
City of Brockton, MA	GRP313	\$4,263.60
City of Cambridge, MA	GRP318	\$7,812.50
City of Manchester, NH	GRP364	\$16,062.50
City of New Bedford, MA	GRP382	\$28,125.00
City of Pawtucket, RI	GRP393	\$10,837.50
City of Portsmouth, NH	GRP401	\$10,500.00
City of Somerville, MA	GRP414	\$2,985.00
City of Taunton, MA	GRP418	\$6,375.00
City of Waltham, MA	GRP 422	\$6,562.50
Clarence H. Knight, Inc.	2958	\$6,406.25
Clark Motor Company, Inc.	1956	\$24,687.50
Clay Chevrolet, Inc.	1962	\$8,200.00
Cleghorn Oil, Inc.	1967	\$11,250.00
Coan, Inc.	1970	\$10,000.00
Compaq Computer Corporation (wholly-owned by Hewlett-Packard Company)	1074	\$8,125.00
Conley Group, Inc.	2052	\$25,531.25
Contemporary Chrysler Plymouth Dodge, Inc.	2046	\$11,375.00
CPC Division US Filter Wastewater Group, Inc.	2103	\$22,500.00
Crystal Motor Express, Inc.	2137	\$7,187.50
Crystal Transport, Inc.	2139	\$8,437.50
D. Dimartino Construction Corporation	1116	\$2,805.90
D J Basile Jr., Inc.	1218	\$8,125.00
Damon Pontiac, Inc.	1008	\$15,937.50
Dana Hall School	2454	\$23,437.50
Dan's Auto Service, Inc.	1015	\$3,876.00
Dan's Service Center	1014	\$20,968.75
Dave Gove Auto Repair, Inc.	2343	\$3,230.00
David J. Coomber (d/b/a Dave's Garage)	1042	\$22,937.50
Davis & Tripp, Inc.	1063	\$14,218.75
Davis Exxon	1066	\$17,937.50
Davis Motor Service Corporation	1169	\$6,875.00
Davis Towing, Inc.	1067	\$3,402.90
DCM Liquidation Corporation (f/k/a DiaCom Corporation)	1156	\$8,406.25
Dead River Company	1073	\$6,695.76
DeLongchamp Auto Company, Inc.	1101	\$17,812.50
Demoulas Supermarket, Inc. (Retail Management & Development, Inc. (RMD))	1118	\$13,593.75
Denaults Auto Repair	1120	\$14,956.25
Diamond Crystal Specialty Foods, Inc. (a subsidiary of Imperial Sugar Company)	1158	\$12,500.00
D.L. Maher Company	3215	\$6,562.50
Domenick Zanni Sons, Inc.	1217	\$8,437.50
Dom's Motor Service (d/b/a Riverside Kawasaki-Yamaha)	4329	\$6,562.50
Don's Garage, Inc.	1248	\$5,671.50

Douglas D Andersen	0977	\$24,062.50
Down East Drilling	1262	\$8,312.50
Dracut Tire Shop, Inc.	1274	\$28,906.25
Drew's Service Station	1283	\$8,125.00
Drum Hill Construction Corporation	1293	\$7,031.25
Duston Oil Company, Inc.	1326	\$3,283.50
E & S Mobile Service, Inc.	1335	\$1,938.00
Eagle Flight Center, Inc.	1339	\$9,531.25
Early and Sons, Inc.	1345	\$15,000.00
East Coast Petroleum Corporation	1351	\$14,306.25
Eastham Auto Sales, Inc.	2521	\$14,437.50
Edgcomb Metals Company (and current successor, Edgcomb Metals Company, LLC)	1385	\$9,375.00
Edgemont Oil Company	1387	\$7,968.75
Energy Machinery, Inc.	1436	\$7,687.50
Essex Gas Company	1460	\$13,187.50
Exit 4 Service Corporation (d/b/a Super Shell Foodmart)	5109	\$6,875.00
Falmouth Toyota, Inc.	1525	\$10,000.00
Fenway Mutual / George Pagounis	0341	\$7,062.50
Fernandes & Sons Construction Company, Inc.	1559	\$3,876.04
Fiori's Depot Motors, Inc.	1133	\$19,375.00
Fireside Nissan, Inc.	1582	\$7,812.50
First Realty Trust	4210	\$3,527.16
Fishery Products International	1587	\$10,625.00
Foss Motors, Inc.	1645	\$6,562.50
Foundry Street Garage	1649	\$8,125.00
Fowler's Express, Inc.	1655	\$8,750.00
Frank C. Dunlap, Inc.	1310	\$7,812.50
Frank's Auto Repair, Inc.	1670	\$7,187.50
Frank's Garage	1693	\$5,373.00
Fred W. Smith, Inc.	4718	\$2,907.00
Frederick M. Shaw, Inc. (d/b/a Shaw Saab)	4586	\$8,281.25
Fred's Repair Service	1690	\$3,164.10
G & G Cycle Sales of Salisbury, Inc.	1697	\$8,531.25
G & G Enterprises, Inc.	2630	\$15,312.50
G & S Management Corporation (successor of Tolpin Marketing, d/b/a Franklin Ford/Tilton Chrysler)	1668	\$8,437.50
G. Conway, Inc.	2060	\$8,250.00
George Cullen's Garage	0441	\$5,373.00
Gerardi's Amoco	2271	\$3,230.00
Godin Bros, Inc.	2320	\$5,684.80
Gonthier's Service Station	2326	\$15,000.00
GoodNews Garage	2328	\$7,500.00
Grant Plastics, Inc.	2364	\$14,281.25
Great Neck Saw Manufacturers, Inc./Buck Brothers	0880	\$7,500.00
Greater Lawrence Sanitary District	GRP55	\$4,776.00
Groton-Dunstable Regional School District	GRP67	\$6,406.25
GTE Sylvania Corporation (GTE Operations Support Incorporated, Successor)	2421	\$10,000.00
Guill Tool & Engineering Company, Inc.	2426	\$16,250.00
Hamel Brothers Service, Inc.	1666	\$23,531.25
Hammond Park Trust	2462	\$7,312.50
Handy & Harman Electronics Materials	2472	\$17,500.00
Hans' Foreign Auto Repair	2481	\$7,625.00
Harbro Auto Service	2495	\$6,562.50
Harold P. Hansen (d/b/a Miller Auto Service)	3487	\$6,875.00
Harrington Paving	2507	\$3,876.00
Hathaway Transmission Service, Inc.	2528	\$9,062.50
Heating Oil Partners LP	0601	\$12,187.50
Heidimarie Service Corporation	3502	\$7,968.75
HEJ Corporation	2885	\$30,000.00
Hendrix Wire & Cable (Thomas & Betts Corporation)	2552	\$30,375.00
Heritage Operating LP (f/k/a Kingston Propane, Inc.)	2948	\$7,468.75
Hogan Tire Centers, Inc.	2604	\$6,562.50

Holden Heating Company (n/k/a Agway Energy Products LLC)	2609	\$17,575.60
Hollingsworth & Vose Company	2616	\$9,687.50
Holmes Products Corporation (n/k/a The Holmes Group, Inc.)	2622	\$7,687.50
Honda Cars of Boston (Atala Corporation)	2631	\$12,500.00
Honeywell, Inc. (Honeywell International Inc., Bull HN Information Systems Inc.)	2636	\$27,586.87
Hub Starters & Alternators, Inc.	2658	\$10,000.00
Huggard & Ewing, Inc.	2666	\$8,468.75
Hyannis Nissan, Inc.	2672	\$18,437.50
Imported Cars of Worcester, Inc.	2624	\$7,812.50
Interstate Brands Corporation (f/k/a Nissen Bakeries)	3728	\$5,970.00
Interstate Brands Corporation	2050	\$7,031.25
Interstate Brands Corporation (f/k/a Sunbeam Bakers)	4875	\$27,500.00
Interstate Gas & Oil Corporation	2696	\$13,312.50
Irving Oil Corporation	0633	\$9,375.00
Irving's Service Center, Inc.	2706	\$8,125.00
J. J. O'Brien & Sons, Inc.	3796	\$26,250.00
J. L. Hammett Company	6010	\$12,500.00
J. M. Cashman, Inc.	1812	\$9,187.50
James A. Mahoney & Sons, Inc.	3218	\$12,750.00
Jefferson Smurfit Corporation (U.S.)	2044	\$20,000.00
Jefferson Smurfit Corporation (U.S.) (f/k/a Container Corp of America)	6043	\$3,582.00
Joan Fabrics Corporation	2816	\$3,880.50
John H. Fuccione (d/b/a Burlington Auto Service)	0905	\$2,686.50
John C. Sarette (on behalf of Johnny's Tire & Battery d/b/a JT&B Texaco)	2843	\$20,000.00
John J. Benson, Inc.	0600	\$10,000.00
John Mento, Inc.	5226	\$6,406.25
John W. Cutter, Inc. (d/b/a AAMCO Transmissions)	0037	\$11,562.50
John's Citgo	2853	\$6,562.50
Johnson Controls, Inc. (Hoover Universal, Inc.)	2871	\$23,906.25
Jones Lang LaSalle Management Services, Inc. (Jones Lang LaSalle Americas, Inc., Successor)	3028	\$13,437.50
Joseph J. Miliano	2998	\$7,812.50
Joseph R. Morin, Inc.	3559	\$1,791.00
Keller Company, Inc.	2812	\$7,125.00
Kevin King Enterprises Company, Inc.	2937	\$18,437.50
Knight Oil, Inc.	2959	\$16,562.50
Lake Avenue Gulf	2989	\$16,875.00
Law Motor Freight, Inc. (d/b/a Heavy Duty Truck & Diesel Service)	2541	\$25,000.00
Lawrence-Lynch Corporation	3041	\$2,261.00
Lewis Builders, Inc. (successor to Lewis Equipment Company, Inc.)	3086	\$12,500.00
Leon G. Caron (d/b/a C&D Auto Glass & Repair Service)	0945	\$9,375.00
Lucchetti's Service Center, Inc.	3166	\$9,781.25
Lynn Sign, Inc.	3185	\$3,230.00
Lyons Enterprises, Inc.	3188	\$8,750.00
M/A-Com, Inc.	2819	\$11,562.50
Mackenzie Trust	3202	\$6,700.00
Madico, Inc.	3212	\$12,187.50
Maffee's Garage, Inc.	3214	\$6,460.00
Magic Discount Muffler, Inc.	2612	\$7,312.50
Maher Bros Auto Sales & Service, Inc.	2492	\$3,230.00
Main Street Auto Sales	3226	\$10,000.00
Mandeville Chevrolet, Inc.	3255	\$7,187.50
Marblehead Trading Company	3274	\$6,562.50
Marken Properties, Inc.	3290	\$15,375.00
Markings, Inc.	3292	\$5,168.00
Mar-Lee Mold Company, Inc. (n/k/a Mar-Lee Companies, Inc.)	3270	\$4,263.60
Marois Brothers, Inc.	3288	\$2,584.00
Marty's, Inc.	3318	\$13,768.75
Massachusetts Turnpike Authority	GRP109	\$11,531.25
Massachusetts Port Authority	GRP103	\$17,281.25
Mass-Vac, Inc.	3328	\$28,968.75
Matty's Sevice	2548	\$18,437.50

Max Levine and Company, Inc.	0047	\$10,625.00
McFarland Ford Sales, Inc.	3194	\$18,750.00
McGreevy Buick-Cadillac, Inc.	3342	\$6,875.00
Mears Tractors, Inc.	5924	\$12,343.75
Medford Automatic Transmission, Inc.	3366	\$20,312.50
Metech International, Inc. (f/k/a Boliden Metech, Inc.)	0724	\$10,312.50
Methuen Motor Mart, Inc.	3417	\$10,937.50
Mike's Service Station	3475	\$14,062.50
Mine Safety Appliances Company	3503	\$7,500.00
Minuteman Regional Vocational Technical School District	GRP92	\$2,985.00
Minuteman Volkswagen, Inc.	3507	\$9,906.25
Mitch and Rogers Auto Service	3512	\$22,812.50
Molloy's Garage, Inc.	3537	\$20,000.00
Monro/Speedy Muffler Group (Monro Muffler Brake, Inc., Successor)	GRP437	\$12,950.00
Montanto Company (n/k/a Pharmacia Corporation By Solutia, Inc.)	6036	\$29,375.00
Montachusett Regional Vocational Technical School District	GRP255	\$12,500.00
Monument Square Sunoco Service Center	3549	\$7,500.00
Mount Auburn Hospital	3578	\$13,368.75
Multi-State Roofing, Inc.	3597	\$9,218.75
NAI Enterprises, Inc. (d/b/a Wellesley Toyota)	5056	\$6,775.00
Nashua Corporation	3620	\$7,812.50
Ned's H/D Towing & Service	3640	\$4,199.00
New Penn Motor Express, Inc.	3688	\$23,125.00
Newman Ford Sales, Inc.	3694	\$7,500.00
North River Motors, Inc.	5330	\$6,875.00
North Shore Regional Vocational School District	GRP270	\$10,625.00
Northeast Builders Transport, Inc.	3750	\$1,938.00
Northeast Refrigeration & Heating Company, Inc. (d/b/a Northeast Equipment)	3753	\$8,125.00
Olin Corporation (f/k/a Olin Hunt Specialty Products, Inc.)	3820	\$19,750.00
P & M Service Center, Inc.	3846	\$9,375.00
P. A. Landers, Inc.	2377	\$25,468.75
Paragios Enterprise, Inc.	3873	\$6,562.50
Patalano Chrysler Plymouth, Inc.	3906	\$9,156.25
Paul J. Tocchio (d/b/a Paul's Transmission Repair)	3926	\$7,750.00
Paul's Auto	3917	\$8,437.50
Paul's Auto Service, Inc.	3919	\$2,686.50
PCI Group, Inc. (Scovill Fasteners, Inc., Successor)	3931	\$8,218.75
Penta Auto Body Company, Inc.	3965	\$3,553.00
Peterborough Oil Company, Inc.	3989	\$11,875.00
Phil Jr's Mobil	4009	\$8,437.50
Phillips Exeter Academy	4004	\$22,187.50
Plaistow Precast Corporation	3672	\$12,500.00
Plaistow Service Center	4040	\$2,149.20
Plant Action, Inc.	4043	\$7,500.00
Polyclad Laminates, Inc.	4068	\$21,562.50
Poulin Corporation	4084	\$30,312.50
Power's Service Station, Inc.	4093	\$9,687.50
Prompt Construction Company, Inc.	4125	\$12,500.00
Quinn Bros Corporation	4161	\$19,437.50
R. S. Audley, Inc.	0376	\$10,625.00
Ralph J. Scovotti (d/b/a Bradford Towing Company)	0791	\$30,312.50
Raymond's Hilltop, Inc.	4220	\$6,562.50
Ray's Auto Service, Inc.	4224	\$15,156.25
Raytheon Company	4232	\$14,687.50
Rent-A-Tool, Inc.	4263	\$9,062.50
Rhode Island Convention Center Authority	2055	\$29,218.75
Richard Tanning Company, Inc.	4921	\$9,375.00
Richie's Mobil, Inc.	4291	\$13,125.00
Riverside Transmission Company	4330	\$8,750.00
Robert A. Chiacchio	3703	\$9,062.50
Robert Fawcett & Son Company, Inc.	1542	\$8,750.00

Robert K. Sweet Jr. (d/b/a Buddy's Garage)	0883	\$7,812.50
Rochester Lincoln Mercury	4352	\$6,718.75
Rose's Oil Service, Inc.	4390	\$20,312.50
Roy's Place	4404	\$7,500.00
RPP Corporation	4412	\$26,843.75
S & E Auto Service & Sales, Inc.	4445	\$9,562.50
S & L Automotive Repair, Inc. (d/b/a Dow's Gulf)	1259	\$17,187.50
Saef Lincoln Mercury, Inc.	2340	\$13,125.00
Salem State College	GRP191	\$13,125.00
Salisbury Auto Salvage	4475	\$19,875.00
San-Vel Concrete Corporation (Lone Star Industries, Inc.)	4513	\$7,500.00
Sawtelle Brothers, Inc.	4521	\$6,875.00
Sawyer Enterprises, Inc.	0788	\$4,477.50
Saxonville Realty Trust	4523	\$2,584.00
Saybolt, Inc. (Saybolt LP)	4524	\$7,187.50
S.B.E., Inc.	1068	\$7,500.00
Schlott Company, Inc.	4531	\$11,875.00
School Administrative Unit Fifty-Six	GRP282	\$13,750.00
Scott's Auto Clinic	4539	\$3,940.20
Scotty's Service, Inc.	4541	\$30,625.00
Scott-Williams, Inc.	5405	\$7,531.25
Seacoast Auto Parts, Inc.	4547	\$7,500.00
Seacoast Volkswagen, Inc.	4551	\$6,718.75
SGS Control Services, Inc.	4577	\$8,125.00
Shaughnessy Crane Service, Inc. (Shaughnessy & Ahern Company)	4585	\$9,687.50
Showcase Isuzu, Inc.	4606	\$2,854.00
Silva Tire Depot, Inc.	4617	\$16,562.50
Skilling & Sons, Inc.	4630	\$6,406.25
Sons of Mary, Health of the Sick, Inc.	4671	\$11,437.50
Southcoast Hospitals Group, Inc. (d/b/a Saint Luke's Hospital)	4465	\$16,875.00
Spalding Construction, Inc.	4714	\$11,406.25
St. Margaret Parish	4767	\$8,750.00
St. Mary's Rectory (The Roman Catholic Bishop of Fall River, a corporation)	6065	\$23,125.00
St. Peters Realty Trust	4768	\$20,000.00
Standard-Thomson Corporation	4775	\$18,875.00
Stephen Antinarelli, Inc.	0279	\$7,587.50
Stephen E. Shamban (Chapter 7 Trustee of NAIC Of New Bedford, Inc.)	4581	\$3,553.00
Stephen H. Craig (d/b/a Plympton Service Center)	4061	\$7,562.50
Stephen J. Pettepit	0558	\$9,687.50
Stroock & Stroock & Lavan LLP/Kaye, Failkow, Richmond & Rothstein	2183	\$10,718.75
Sullivan Bros Nissan Lincoln-Mercury, Inc.	3798	\$10,781.25
Sullivan Tire Company, Inc.	4870	\$7,343.75
Sun Auto Rental Company, Inc.	4874	\$6,875.00
Tatnuck Mobil	4927	\$7,750.00
Teknor Apex Company	4948	\$10,728.63
The Charles Stark Draper Laboratory, Inc.	1281	\$9,968.75
The Dodge Company, Inc.	1213	\$23,750.00
The Druker Company LTD.	1292	\$24,062.50
The Hertz Corporation	2577	\$21,562.50
The Salvation Army	4491	\$5,373.00
The Stop & Shop Supermarket Company (and Purity Supreme, Inc.)	4147	\$8,437.50
The Wakefield Corporation	5236	\$12,812.50
The William Carter Company	1802	\$7,500.00
Tom Porter's Auto Service, Inc.	4074	\$6,406.25
Tommy's Auto Service	4750	\$13,281.25
Topsfield Fire Department (Town of Topsfield)	5859	\$2,584.00
Tosti's Service Station, Inc.	5028	\$14,043.75
Tower Automotive, Inc.	5032	\$11,250.00
Towers of Chestnut Hill	6075	\$30,625.00
Town of Billerica, MA	GRP309	\$16,562.50
Town of Boxford, MA	GRP311	\$10,625.00

Town of Brookline, MA	GRP316	\$21,250.00
Town of Burlington, MA	GRP317	\$7,900.00
Town of Carver, MA	GRP320	\$9,125.00
Town of Chatham, MA	GRP321	\$28,343.75
Town of Duxbury, MA	GRP329	\$9,593.75
Town of Eastham, MA	GRP332	\$24,687.50
Town of Epping, NH	GRP334	\$6,875.00
Town of Hanover, MA	GRP344	\$6,562.50
Town of Hanson, MA	GRP345	\$11,093.75
Town of Harwich, MA	GRP347	\$24,343.75
Town of Littleton, MA (Littleton Electric Light Department)	GRP359	\$3,695.43
Town of Mashpee, MA	GRP368	\$2,261.00
Town of Milford, MA	GRP376	\$9,006.25
Town of Milton, MA	GRP377	\$4,776.00
Town of Natick, MA	GRP380	\$21,500.00
Town of New Durham, NH	GRP383	\$1,938.00
Town of Norwood, MA (Municipal Light Department & Department of Public Works)	GRP389	\$23,437.50
Town of Orleans, MA	GRP392	\$21,250.00
Town of Plaistow, NH	GRP398	\$26,250.00
Town of Plymouth, MA	GRP399	\$19,375.00
Town of Reading, MA	GRP406	\$7,500.00
Town of Wakefield, MA	GRP421	\$9,093.75
Town of Wareham, MA	GRP423	\$2,842.40
Town of Wayland, MA	GRP426	\$8,118.75
Town of Wellfleet, MA	GRP428	\$9,218.75
Town of West Bridgewater, MA	GRP430	\$8,750.00
Town of Westford, MA	GRP431	\$11,718.75
Town of Winchester, MA	GRP433	\$9,687.50
Townsend Sales & Service, Inc.	5050	\$9,375.00
Tresca Brothers Sand & Gravel, Inc.	5072	\$10,312.50
Trombly Motor Coach Service, Inc.	5085	\$8,125.00
Tudor Cab, Inc.	5101	\$1,899.24
Two Twenty Two Berkeley Venture	5116	\$13,437.50
UniFirst Corporation	5133	\$9,062.50
Universal Construction, Inc.	5160	\$1,938.00
US Food Service (Monarch Foods and PYA/Monarch, LLC)	3541	\$8,125.00
Varney Bros Sand & Gravel, Inc.	5191	\$11,250.00
Verizon New England, Inc.	3676	\$17,037.50
Vin's Auto Service, Inc.	5219	\$15,312.50
Volkswagen of America, Inc.	5223	\$18,487.50
Wagner & Wagner Auto Sales, Inc. (d/b/a Wagner Motor Sales)	5234	\$18,687.50
Wakefield Materials Corporation	3365	\$22,187.50
Wakefield Tune-up, Inc.	5240	\$1,938.00
Water Street Auto Body, Inc.	5275	\$9,375.00
WEACO Realty, Inc.	0344	\$22,500.00
Weber Dodge, Inc.	5296	\$6,875.00
West Lynn Service, Inc.	5338	\$4,179.00
W. A. Kraft Corporation (n/k/a Kraft Power Corporation)	2970	\$10,312.50
W.H. Bagshaw Company, Inc.	0485	\$13,750.00
Whitney's Service	5393	\$20,625.00
William A. Miller (d/b/a Shawsheen Service)	4590	\$11,562.50
Woods Hole Oceanographic Institution	5447	\$13,750.00
		\$4,688,723.10

Appendix A - List of Settling Parties

Name	PRP #	Amount
Appendix A - Section II - Respondent Federal Agencies		
Army & Air Force Exchange Service (AAFES)	6094	\$15,937.50
Massachusetts Adjutant General (State of Massachusetts & United States on behalf of U.S. Army)	GRP129	\$23,500.00
New Hampshire Adjutant General (State of New Hampshire & United States on behalf of U.S. Army)	GRP108	\$15,000.00
United States Army Reserve	GRP172	\$8,062.50
		\$62,500.00

**ADMINISTRATIVE ORDER ON CONSENT
SECTION 122(g)(4) DE MINIMIS CONTRIBUTORS**

APPENDIX B

SITE MAP

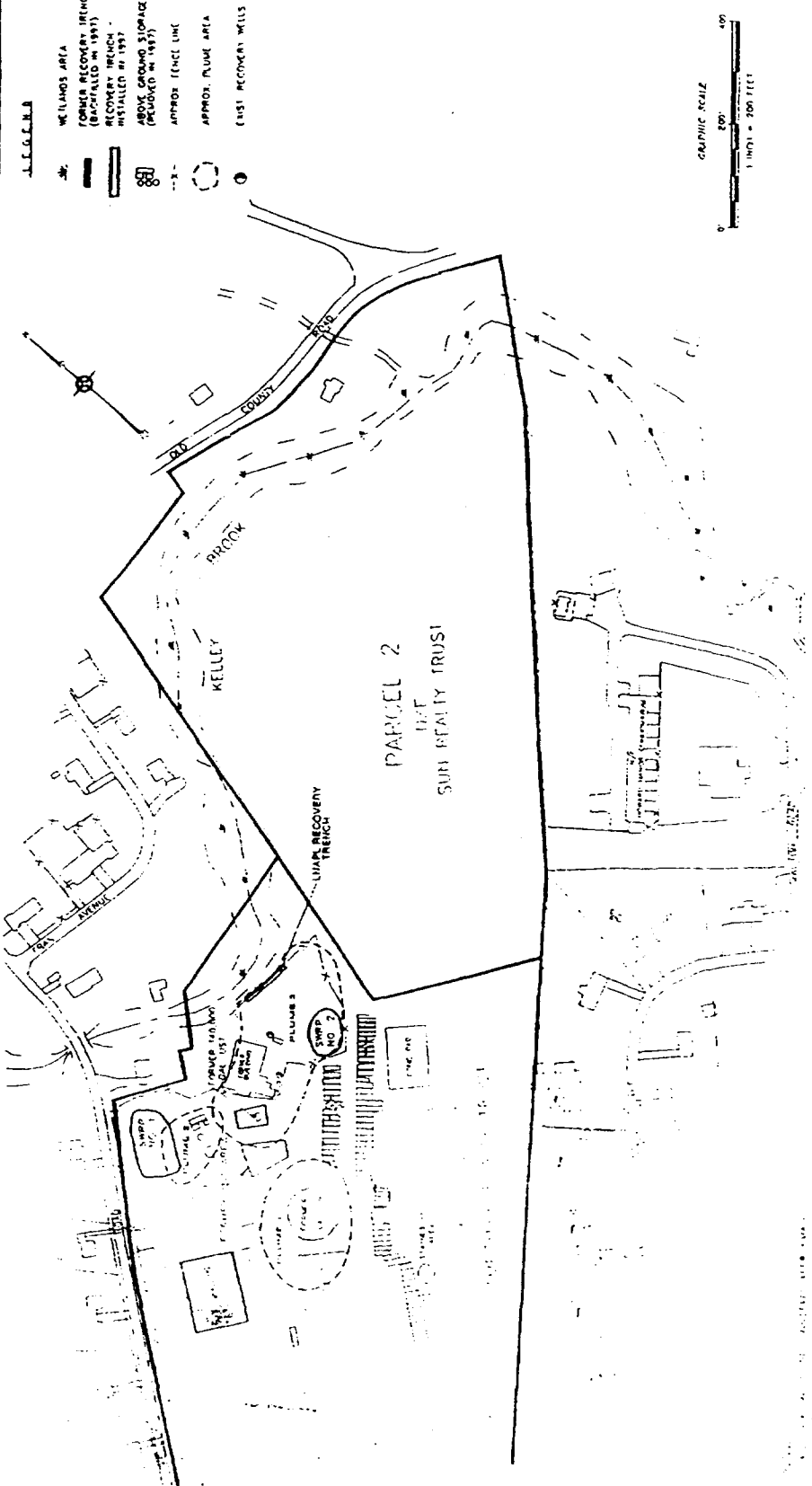

THIS MAP WAS PREPARED BY TETRA TECH NUS, INC. FOR THE USE OF THE NEW HAMPSHIRE DEPARTMENT OF ENVIRONMENTAL SERVICES (DES) IN CONNECTION WITH THE BEEBE WASTE OIL SITE. THE MAP IS A REPRESENTATION OF THE SOIL FEATURES AS OBSERVED AND MEASURED IN THE FIELD. IT IS NOT A GUARANTEE OF THE ACCURACY OF THE INFORMATION SHOWN ON THE MAP. THE INFORMATION SHOWN ON THE MAP IS BASED ON THE DATA PROVIDED BY THE CLIENT AND THE FIELD SURVEY. THE CLIENT IS RESPONSIBLE FOR THE ACCURACY OF THE DATA PROVIDED. THE INFORMATION SHOWN ON THE MAP IS NOT TO BE USED FOR ANY OTHER PURPOSES WITHOUT THE WRITTEN CONSENT OF TETRA TECH NUS, INC.

ADMINISTRATIVE ORDER ON CONSENT
SECTION 122(g)(4) DE MINIMIS CONTRIBUTORS

APPENDIX C

SECOND DE MINIMIS GENERATOR PRP
SETTLEMENT AMOUNTS

Including individual total volumetric shares, component EPA and State dollar amounts and the sum **total** due for each settling Respondent and Respondent Federal Agency.

Appendix C(1) Same Rate

PRP Name	PRP ID	PRP Volume	Total Cash Out PAY THIS AMOUNT	Consists of the (EPA Cash-Out Amount) + following components (NH Cash-Out Amount)
Allied Cold Storage Corp	1233	850	\$5,074.50	(\$4,964.00) + (\$110.50)
American Paper Recycling Corp	0203	1000	\$5,970.00	(\$5,840.00) + (\$130.00)
Anderson Marine	7000	800	\$4,776.00	(\$4,672.00) + (\$104.00)
Anthony F Curtin Jr	2098	790	\$4,716.30	(\$4,613.60) + (\$102.70)
Arrow Automotive Industries Inc	0309	300	\$1,791.00	(\$1,752.00) + (\$39.00)
Atlantic Coast Seafood Inc	0348	550	\$3,283.50	(\$3,212.00) + (\$71.50)
Auto Craft Enterprises	0415	400	\$2,388.00	(\$2,336.00) + (\$52.00)
Balboni's Garage Inc	0497	400	\$2,388.00	(\$2,336.00) + (\$52.00)
Beaulieu Trucking	0560	700	\$4,179.00	(\$4,088.00) + (\$91.00)
Berardi Automotive Inc	6096	500	\$2,985.00	(\$2,920.00) + (\$65.00)
Berardi Bros Auto Body Inc	0617	950	\$5,671.50	(\$5,548.00) + (\$123.50)
Blakeslee Sales	0667	800	\$4,776.00	(\$4,672.00) + (\$104.00)
Bob's Auto Repair Inc	0691	950	\$5,671.50	(\$5,548.00) + (\$123.50)
Boston Harbor Cruises	0757	400	\$2,388.00	(\$2,336.00) + (\$52.00)
Burlington Auto Service	0905	450	\$2,686.50	(\$2,628.00) + (\$58.50)
Centre Trucking Service Inc	1855	925	\$5,522.25	(\$5,402.00) + (\$120.25)
City of Somerville	GRP414	500	\$2,985.00	(\$2,920.00) + (\$65.00)
Container Corp of America-Folding Carton Div	6043	600	\$3,582.00	(\$3,504.00) + (\$78.00)
D DiMartino Construction Corp	1116	470	\$2,805.90	(\$2,744.80) + (\$61.10)
Dave's Auto Service	1043	800	\$4,776.00	(\$4,672.00) + (\$104.00)
Davis Towing Inc	1067	570	\$3,402.90	(\$3,328.80) + (\$74.10)
Don's Garage	1248	950	\$5,671.50	(\$5,548.00) + (\$123.50)
Dustin Oil Inc	1326	550	\$3,283.50	(\$3,212.00) + (\$71.50)
Eastern Transmission Service	1373	700	\$4,179.00	(\$4,088.00) + (\$91.00)
Foreign Affairs of Orleans	1624	300	\$1,791.00	(\$1,752.00) + (\$39.00)
Fran's Expert Repair	0618	700	\$4,179.00	(\$4,088.00) + (\$91.00)
Frank's Garage	1693	900	\$5,373.00	(\$5,256.00) + (\$117.00)

Appendix C(1) Same Rate

PRP Name	PRP ID	PRP Volume	PAY THIS AMOUNT	Total Cash Out	Consists of the (EPA Cash-Out Amount + NH Cash-Out Amount)	following components (NH Cash-Out Amount)
Fred's Repair Service	1690	530	\$3,164.10		(\$3,095.20) + (\$68.90)	
George Cullen's Garage	0441	900	\$5,373.00		(\$5,256.00) + (\$117.00)	
George Nassif	0830	880	\$5,253.60		(\$5,139.20) + (\$114.40)	
Gould Auto Sales	5994	500	\$2,985.00		(\$2,920.00) + (\$65.00)	
Greater Lawrence Sanitary District	GRP55	800	\$4,776.00		(\$4,672.00) + (\$104.00)	
Hampton Concrete Inc	2465	500	\$2,985.00		(\$2,920.00) + (\$65.00)	
Hilton & Strout Inc	2595	700	\$4,179.00		(\$4,088.00) + (\$91.00)	
J & R Autobody Inc	2727	800	\$4,776.00		(\$4,672.00) + (\$104.00)	
Joan Fabrics Corporation	2816	650	\$3,880.50		(\$3,796.00) + (\$84.50)	
John's Service Station	2860	300	\$1,791.00		(\$1,752.00) + (\$39.00)	
John M White	5473	800	\$4,776.00		(\$4,672.00) + (\$104.00)	
Joseph R Morin Inc	3559	300	\$1,791.00		(\$1,752.00) + (\$39.00)	
Kingston BP	6099	664	\$3,964.08		(\$3,877.76) + (\$86.32)	
Kriswood Inc	2972	750	\$4,477.50		(\$4,380.00) + (\$97.50)	
Larry's Marina	3021	475	\$2,835.75		(\$2,774.00) + (\$61.75)	
Marilyn Motors Inc	3280	775	\$4,626.75		(\$4,526.00) + (\$100.75)	
Middleton Golf Course II Inc	3468	450	\$2,686.50		(\$2,628.00) + (\$58.50)	
Minuteman Regional Vocational Technical School District	GRP092	500	\$2,985.00		(\$2,920.00) + (\$65.00)	
N Cibotti Inc	1935	700	\$4,179.00		(\$4,088.00) + (\$91.00)	
Nissen Bakeries	3728	1000	\$5,970.00		(\$5,840.00) + (\$130.00)	
Norri's Repair	3737	624	\$3,725.28		(\$3,644.16) + (\$81.12)	
Old Colony Motors Inc	1997	900	\$5,373.00		(\$5,256.00) + (\$117.00)	
Paul's Auto Service Inc	3919	450	\$2,686.50		(\$2,628.00) + (\$58.50)	
Plaisow Service Center	4040	360	\$2,149.20		(\$2,102.40) + (\$46.80)	
Power's Auto Service	4092	750	\$4,477.50		(\$4,380.00) + (\$97.50)	
Professional Center for Handicapped Children, Inc.	4120	650	\$3,880.50		(\$3,796.00) + (\$84.50)	
Sawyer Enterprises Inc	0788	750	\$4,477.50		(\$4,380.00) + (\$97.50)	

Appendix C(1) Same Rate

PRP Name	PRP ID	PRP Volume	PAY THIS AMOUNT	Total Cash Out	Consists of the following components
					(EPA Cash-Out Amount) + (NH Cash-Out Amount)
Scott's Auto Clinic	4539	660	\$3,940.20		(\$3,854.40) + (\$85.80)
Sports Imports of Cape Cod Inc	4754	690	\$4,119.30		(\$4,029.60) + (\$89.70)
Steve King Tire Center Inc	4821	800	\$4,776.00		(\$4,672.00) + (\$104.00)
Tedeschi Food Shops Inc	3518	650	\$3,880.50		(\$3,796.00) + (\$84.50)
The Salvation Army	4491	900	\$5,373.00		(\$5,256.00) + (\$117.00)
Thomas P Morabito Jr	0229	900	\$5,373.00		(\$5,256.00) + (\$117.00)
TNT Automotive Inc.	1337	720	\$4,298.40		(\$4,204.80) + (\$93.60)
Towers Front End and Service	5034	450	\$2,686.50		(\$2,628.00) + (\$58.50)
Town of Dennisport	GRP327	500	\$2,985.00		(\$2,920.00) + (\$65.00)
Town of Littleton	GRP359	619	\$3,695.43		(\$3,614.96) + (\$80.47)
Town of Milton	GRP377	800	\$4,776.00		(\$4,672.00) + (\$104.00)
Vinny's Sunoco of Hanover	6095	400	\$2,388.00		(\$2,336.00) + (\$52.00)
Wakefield Auto Service, Inc.	5235	900	\$5,373.00		(\$5,256.00) + (\$117.00)
West Lynn Service Inc	5338	700	\$4,179.00		(\$4,088.00) + (\$91.00)
Wood's Exxon Service	5445	500	\$2,985.00		(\$2,920.00) + (\$65.00)

Appendix C(2) New Rate

PRP Name	PRP ID	PRP Volume	Total Cash Out PAY THIS AMOUNT	Consists of the (EPA Cash-Out Amount) + following components (NH Cash-Out Amount)
128 Tire Inc	0898	1300	\$8,125.00	(\$7,956.00) + (\$169.00)
A Neal Perley (DBA: Perley's Marina)	3942	1050	\$6,562.50	(\$6,426.00) + (\$136.50)
A & B Automotive Inc	0006	4150	\$25,937.50	(\$25,398.00) + (\$539.50)
A & C Tire Co Inc	0008	1250	\$7,812.50	(\$7,650.00) + (\$162.50)
A & O Service Center Inc	0020	1915	\$11,968.75	(\$11,719.80) + (\$248.95)
Action Tire Inc	0091	1014	\$6,337.50	(\$6,205.68) + (\$131.82)
Admiral Folding Box Inc	0097	1350	\$8,437.50	(\$8,262.00) + (\$175.50)
Advance Muffler & Brake Co Inc	0102	1250	\$7,812.50	(\$7,650.00) + (\$162.50)
AEP Industries Inc	0743	3650	\$22,812.50	(\$22,338.00) + (\$474.50)
Agawam Service Center Inc	0118	1400	\$8,750.00	(\$8,568.00) + (\$182.00)
AJ Gagnon & Sons Inc	2195	2300	\$14,375.00	(\$14,076.00) + (\$299.00)
AKL Inc (DBA: Elm Street Mobil)	1421	2200	\$13,750.00	(\$13,464.00) + (\$286.00)
Al Murphy's Mobil	3607	1500	\$9,375.00	(\$9,180.00) + (\$195.00)
Al & Paul's Auto Sales Inc	0134	1400	\$8,750.00	(\$8,568.00) + (\$182.00)
Alteri Service Inc	0179	1150	\$7,187.50	(\$7,038.00) + (\$149.50)
AMA Transportation Co Inc	0182	1100	\$6,875.00	(\$6,732.00) + (\$143.00)
American Auto Sales Inc	0188	1450	\$9,062.50	(\$8,874.00) + (\$188.50)
American Fleet Service Inc	0194	1175	\$7,343.75	(\$7,191.00) + (\$152.75)
Amesbury Group Inc	0218	4425	\$27,656.25	(\$27,081.00) + (\$575.25)
Amherst Service Center	0223	1650	\$10,312.50	(\$10,098.00) + (\$214.50)
Anchor Motor Freight Inc	0236	4153	\$25,956.25	(\$25,416.36) + (\$539.89)
Andover Auto & Truck Services Inc	0246	1500	\$9,375.00	(\$9,180.00) + (\$195.00)
Andover Street Motor Sports LP (DBA: Acura of Peabody)	0092	4600	\$28,750.00	(\$28,152.00) + (\$598.00)
Andy's Auto Service	0267	1700	\$10,625.00	(\$10,404.00) + (\$221.00)
Anjo Services Inc (DBA: Spark's Computerized Car Care)	4710	1900	\$11,875.00	(\$11,628.00) + (\$247.00)
Antoine's Sunoco	5205	1500	\$9,375.00	(\$9,180.00) + (\$195.00)
Antoni's Cleaners Inc	0280	1200	\$7,500.00	(\$7,344.00) + (\$156.00)

Appendix C(2) New Rate

PRP Name	PRP ID	PRP Volume	PAY THIS AMOUNT	Total Cash Out	Consists of the following components
					(EPA Cash-Out Amount) + (NH Cash-Out Amount)
ARAMARK Uniform and Career Apparel Inc	0291	1100	\$6,875.00		(\$6,732.00) + (\$143.00)
Artis Auto Inc	0305	2150	\$13,437.50		(\$13,158.00) + (\$279.50)
Artex Oil Corporation	0306	2480	\$15,500.00		(\$15,177.60) + (\$322.40)
Army Air Force Exchange Service	6094	2550	\$15,937.50		(\$15,606.00) + (\$331.50)
Atlantic Wasie Systems North	3937	3850	\$24,062.50		(\$23,562.00) + (\$500.50)
Auburndale Service Center LLC	0372	2050	\$12,812.50		(\$12,546.00) + (\$266.50)
Auto Body & Tire Center Inc (DBA: Cape Auto Body)	1552	1430	\$8,937.50		(\$8,751.60) + (\$185.90)
Auto Radiator Service Inc	0401	2780	\$17,375.00		(\$17,013.60) + (\$361.40)
Automotive Consultants Inc	0422	2750	\$17,187.50		(\$16,830.00) + (\$357.50)
Bacon & Son Auto Repair Inc	0480	2910	\$18,187.50		(\$17,809.20) + (\$378.30)
Bailey Motor Sales Inc	0489	2150	\$13,437.50		(\$13,158.00) + (\$279.50)
Baker-Wright Auto Electric Service	0496	1675	\$10,468.75		(\$10,251.00) + (\$217.75)
Bancroft Motors Inc	0507	4990	\$31,187.50		(\$30,538.80) + (\$648.70)
Bancroft Tire Center	0508	1050	\$6,562.50		(\$6,426.00) + (\$136.50)
Bay State Taxi Inc	0549	1350	\$8,437.50		(\$8,262.00) + (\$175.50)
Beckett Getty Service Station	0561	1400	\$8,750.00		(\$8,568.00) + (\$182.00)
Beeley's Auto Repair & Body Shop Inc	0566	3400	\$21,250.00		(\$20,808.00) + (\$442.00)
Belgrade Auto Inc	0570	3750	\$23,437.50		(\$22,950.00) + (\$487.50)
Belmont Springs Water Company Inc	0587	1900	\$11,875.00		(\$11,628.00) + (\$247.00)
Ber-Giam Inc (DBA: Dedham Service Center)	1092	1600	\$10,000.00		(\$9,792.00) + (\$208.00)
Berman Repair and Sales Inc	0609	3600	\$22,500.00		(\$22,032.00) + (\$468.00)
Betty Chevrolet Buick Inc	0603	2470	\$15,437.50		(\$15,116.40) + (\$321.10)
Bettencourt Machine Company Inc	0626	2150	\$13,437.50		(\$13,158.00) + (\$279.50)
Bill's Auto Repair	0643	1010	\$6,312.50		(\$6,181.20) + (\$131.30)
BJ's Wholesale Club Inc	0658	1190	\$7,437.50		(\$7,282.80) + (\$154.70)
Blanchette's Automotive Center Inc	0672	1265	\$7,906.25		(\$7,741.80) + (\$164.45)
Blount Marine Corporation	0676	4359	\$27,243.75		(\$26,677.08) + (\$566.67)

Appendix C(2) New Rate

PRP Name	PRP ID	PRP Volume	Total Cash Out PAY THIS AMOUNT	Consists of the (EPA Cash-Out Amount)	following components (NH Cash-Out Amount)
BME Engineering Inc	0681	3027	\$18,918.75	(\$18,525.24)	+\$393.51
Bob's Auto Service	0695	3925	\$24,531.25	(\$24,021.00)	+\$510.25
Bob's Cligo	0699	2540	\$15,875.00	(\$15,544.80)	+\$330.20
Bob's Custom Sunoco	0700	3225	\$20,156.25	(\$19,737.00)	+\$419.25
Bob Pion Pontiac-Buick-GMC Inc	4028	2775	\$17,343.75	(\$16,983.00)	+\$360.75
Bob Stevens AMOCO	4807	2400	\$15,000.00	(\$14,688.00)	+\$312.00
Bob & Jim's Service Station Inc (DBA: Bob & Jim's Sunoco)	0685	1750	\$10,937.50	(\$10,710.00)	+\$227.50
Bolster Shell Service	0727	1300	\$8,125.00	(\$7,956.00)	+\$169.00
Bonanza Bus Lines Inc	0730	1550	\$9,687.50	(\$9,486.00)	+\$201.50
Borden Foods Corporation	GRP450	4050	\$25,312.50	(\$24,786.00)	+\$526.50
Boston Public Health Commission	GRP284	1450	\$9,062.50	(\$8,874.00)	+\$188.50
Bouchard's Getty	0771	1300	\$8,125.00	(\$7,956.00)	+\$169.00
Bouchard & Son Inc	0770	1900	\$11,875.00	(\$11,628.00)	+\$247.00
Bournival Inc	0775	1300	\$8,125.00	(\$7,956.00)	+\$169.00
Bradlees Stores Inc	0792	1495	\$9,343.75	(\$9,149.40)	+\$194.35
Braintree Foreign Car Specialists Inc	0796	1200	\$7,500.00	(\$7,344.00)	+\$156.00
Braintree Square Mobil	1174	1053	\$6,581.25	(\$6,444.36)	+\$136.89
Bresnahan Ice Company	0804	3610	\$22,562.50	(\$22,093.20)	+\$469.30
Brian's Auto Service Inc	0810	2030	\$12,687.50	(\$12,423.60)	+\$263.90
Brickyard Enterprises Trust	0814	1400	\$8,750.00	(\$8,568.00)	+\$182.00
Bridge Marina Inc	0815	3105	\$19,406.25	(\$19,002.60)	+\$403.65
Broadway Brake Supply Inc	0835	1300	\$8,125.00	(\$7,956.00)	+\$169.00
Broadway Motor Service of Revere Inc	0840	1400	\$8,750.00	(\$8,568.00)	+\$182.00
Broadway Rental Inc	4937	1750	\$10,937.50	(\$10,710.00)	+\$227.50
Broadway Tire & Auto Company Inc	3929	4975	\$31,093.75	(\$30,447.00)	+\$646.75
Brockton Excavating Contractors Inc	0849	2355	\$14,718.75	(\$14,412.60)	+\$306.15
Brockton Rental Service Inc	0850	2300	\$14,375.00	(\$14,076.00)	+\$299.00

Appendix C(2) New Rate

PRP Name	PRP ID	PRP Volume	Total Cash Out PAY THIS AMOUNT	Consists of the (EPA Cash-Out Amount)	following components (NH Cash-Out Amount)
Brodie Inc	0851	2100	\$13,125.00	(\$12,852.00)	+\$ (273.00)
Brooks School Day Camp	6073	1800	\$11,250.00	(\$11,016.00)	+\$ (234.00)
Brown's Auto	0866	1950	\$12,187.50	(\$11,934.00)	+\$ (253.50)
Brown's Service Station	0871	1350	\$8,437.50	(\$8,262.00)	+\$ (175.50)
Brownie's Texaco Service Inc	0865	4125	\$25,781.25	(\$25,245.00)	+\$ (536.25)
Bruce's Tremont Street Garage	0877	1100	\$6,875.00	(\$6,732.00)	+\$ (143.00)
Bubbles Inc (DBA: Mr Bubbles Carwash)	1545	1100	\$6,875.00	(\$6,732.00)	+\$ (143.00)
Burke's Den Rock Mobil	1119	2550	\$15,937.50	(\$15,606.00)	+\$ (331.50)
Burke Distributing Corporation	0901	3650	\$22,812.50	(\$22,338.00)	+\$ (474.50)
Buxton Brothers Inc	0931	2900	\$18,125.00	(\$17,748.00)	+\$ (377.00)
Byfield Auto Center	0936	4375	\$27,343.75	(\$26,775.00)	+\$ (568.75)
C & D Auto Glass and Repair Service	0945	1500	\$9,375.00	(\$9,180.00)	+\$ (195.00)
C & G Truck Repair	0952	1675	\$10,468.75	(\$10,251.00)	+\$ (217.75)
Cabot Cabot & Forbes	0201	1525	\$9,531.25	(\$9,333.00)	+\$ (198.25)
Callan Automotive Service	0914	1200	\$7,500.00	(\$7,344.00)	+\$ (156.00)
Cambridgeside Galleria Inc	3659	1675	\$10,468.75	(\$10,251.00)	+\$ (217.75)
Campello Coal Co Inc	1148	1663	\$10,393.75	(\$10,177.56)	+\$ (216.19)
Cape Ann Marina Corp	1318	1700	\$10,625.00	(\$10,404.00)	+\$ (221.00)
Carchedi Inc (DBA: Ipswich Getty)	2701	2500	\$15,625.00	(\$15,300.00)	+\$ (325.00)
Cargo Transport Inc	1787	2600	\$16,250.00	(\$15,912.00)	+\$ (338.00)
Carlson Motor Sales Inc	1793	2710	\$16,937.50	(\$16,585.20)	+\$ (352.30)
CDST Corporation (DBA: Quality Lube and Wash)	4156	3000	\$18,750.00	(\$18,360.00)	+\$ (390.00)
Central Motors Inc	1848	2800	\$17,500.00	(\$17,136.00)	+\$ (364.00)
Central NH Sales Inc	1838	1050	\$6,562.50	(\$6,426.00)	+\$ (136.50)
Certus Inc	1861	1045	\$6,531.25	(\$6,395.40)	+\$ (135.85)
Chappy's Auto Repair, Inc.	1868	2100	\$13,125.00	(\$12,852.00)	+\$ (273.00)
Charles Daher's Commonwealth Motors, Inc.	2013	2310	\$14,437.50	(\$14,137.20)	+\$ (300.30)

Appendix C(2) New Rate

PRP Name	PRP ID	PRP Volume	Total Cash Out	PAY THIS AMOUNT	Consists of the following components
					(EPA Cash-Out Amount) + (NH Cash-Out Amount)
Charles M Rollins Co Inc	4367	1400	\$8,750.00		(\$8,568.00) + (\$182.00)
Chelmsford Center Mobil	1897	1700	\$10,625.00		(\$10,404.00) + (\$221.00)
Chets Auto Repair	1914	1425	\$8,906.25		(\$8,721.00) + (\$185.25)
Christie Transfer Inc	1924	1250	\$7,812.50		(\$7,650.00) + (\$162.50)
Chrysler-Plymouth of Medford Inc (DBA: Grava Chrysler-Plymouth etc)	2373	1350	\$8,437.50		(\$8,262.00) + (\$175.50)
Cinderella Carriage Co Inc	1936	1350	\$8,437.50		(\$8,262.00) + (\$175.50)
City of Attleboro	GRP304	1350	\$8,437.50		(\$8,262.00) + (\$175.50)
City of Cambridge	GRP318	1250	\$7,812.50		(\$7,650.00) + (\$162.50)
City of Chicopee	GRP325	2250	\$14,062.50		(\$13,770.00) + (\$292.50)
City of Gloucester	GRP340	2275	\$14,218.75		(\$13,923.00) + (\$295.75)
City of Manchester	GRP364	2570	\$16,062.50		(\$15,728.40) + (\$334.10)
City of New Bedford	GRP382	4500	\$28,125.00		(\$27,540.00) + (\$585.00)
City of Newburyport	GRP384	4340	\$27,125.00		(\$26,560.80) + (\$564.20)
City of Pawtucket	GRP393	1734	\$10,837.50		(\$10,612.08) + (\$225.42)
City of Portsmouth	GRP401	1680	\$10,500.00		(\$10,281.60) + (\$218.40)
City of Quincy	GRP404	4000	\$25,000.00		(\$24,480.00) + (\$520.00)
City of Salem	GRP410	2250	\$14,062.50		(\$13,770.00) + (\$292.50)
City of Taunton	GRP418	1020	\$6,375.00		(\$6,242.40) + (\$132.60)
City of Waltham	GRP422	1050	\$6,562.50		(\$6,426.00) + (\$136.50)
Clarence H Knight Inc (DBA: Knight Chevrolet-Oldsobile)	2958	1025	\$6,406.25		(\$6,273.00) + (\$133.25)
Clark Motor Company Inc	1956	3950	\$24,687.50		(\$24,174.00) + (\$513.50)
Clay Chevrolet Inc	1962	1312	\$8,200.00		(\$8,029.44) + (\$170.56)
Clayton's Auto Repair	1964	1410	\$8,812.50		(\$8,629.20) + (\$183.30)
Clearview Auto Inc	1965	1100	\$6,875.00		(\$6,732.00) + (\$143.00)
Cleghorn Oil Inc	1967	1800	\$11,250.00		(\$11,016.00) + (\$234.00)
Coady Garage & Towing Service	1969	3125	\$19,531.25		(\$19,125.00) + (\$406.25)
Coan Inc	1970	1600	\$10,000.00		(\$9,792.00) + (\$208.00)

Appendix C(2) New Rate

PRP Name	PRP ID	PRP Volume	Total Cash Out PAY THIS AMOUNT	Consists of the (EPA Cash-Out Amount)	following components (NH Cash-Out Amount)
Coast Pontiac-Cadillac Inc	1971	1500	\$9,375.00	(\$9,180.00)	+\$195.00
Colman Brothers Auto Service Inc	1978	1250	\$7,812.50	(\$7,650.00)	+\$162.50
Community Auto Center Inc	2014	4600	\$28,750.00	(\$28,152.00)	+\$598.00
Compad Computer Corporation	1074	1300	\$8,125.00	(\$7,956.00)	+\$169.00
Congdon Auto Center Inc	5964	1150	\$7,187.50	(\$7,038.00)	+\$149.50
Conley Group Inc (DBA: Continental Plastics Corp)	2052	4085	\$25,531.25	(\$25,000.20)	+\$531.05
Connolly Buick Co Inc (DBA: Herb Connolly Acura of Framingham)	3037	3600	\$22,500.00	(\$22,032.00)	+\$468.00
Consumer Auto Parts Inc	2043	1470	\$9,187.50	(\$8,996.40)	+\$191.10
Contemporary Chrysler Plymouth Dodge Inc	2046	1820	\$11,375.00	(\$11,138.40)	+\$236.60
Contemporary Concepts Inc (DBA: Roger Roy Mobil)	2047	2200	\$13,750.00	(\$13,464.00)	+\$286.00
Copeland Automotive	2072	1201	\$7,506.25	(\$7,350.12)	+\$156.13
Coppola Inc	2073	4875	\$30,468.75	(\$29,835.00)	+\$633.75
Cox Fuel Company Inc	2101	1200	\$7,500.00	(\$7,344.00)	+\$156.00
CPC Div of US Filter Wastewater Group Inc	2103	3600	\$22,500.00	(\$22,032.00)	+\$468.00
Criterion Systems	2123	2750	\$17,187.50	(\$16,830.00)	+\$357.50
Crystal Motor Express Inc	2137	1150	\$7,187.50	(\$7,038.00)	+\$149.50
Crystal Transport Inc	2139	1350	\$8,437.50	(\$8,262.00)	+\$175.50
D's Arco Inc	1297	2250	\$14,062.50	(\$13,770.00)	+\$292.50
D J Basile Jr Inc (DBA: Dom's Global)	1218	1300	\$8,125.00	(\$7,956.00)	+\$169.00
D L Maher Co	3215	1050	\$6,562.50	(\$6,426.00)	+\$136.50
D S & S Service Station Inc	5707	1100	\$6,875.00	(\$6,732.00)	+\$143.00
D & M Foreign Auto Repair Inc	0985	1600	\$10,000.00	(\$9,792.00)	+\$208.00
Dalley Oil Company Inc	1003	3975	\$24,843.75	(\$24,327.00)	+\$516.75
Damon Pontiac Inc	1008	2550	\$15,937.50	(\$15,606.00)	+\$331.50
Dan's Auto Repair	1017	3155	\$19,718.75	(\$19,308.60)	+\$410.15
Dan's Service Station	1014	3355	\$20,968.75	(\$20,532.60)	+\$436.15
Dana Hall School	2454	3750	\$23,437.50	(\$22,950.00)	+\$487.50

Appendix C(2) New Rate

PRP Name	PRP ID	PRP Volume	PAY THIS AMOUNT	Total Cash Out	Consists of the (EPA Cash-Out Amount)	following components (NH Cash-Out Amount)
Daniels LeSaffre Motors Inc	3026	1450	\$9,062.50		(\$8,874.00)	+\$ (188.50)
Dave's Enterprises Inc (DBA: Dave's Mobil)	1052	2850	\$17,812.50		(\$17,442.00)	+\$ (370.50)
Dave & Jack's Service Inc	1039	3300	\$20,625.00		(\$20,196.00)	+\$ (429.00)
David J Coomer (DBA: Dave's Garage)	1042	3670	\$22,937.50		(\$22,460.40)	+\$ (477.10)
Davis Exxon	1066	2870	\$17,937.50		(\$17,564.40)	+\$ (373.10)
Davis Motor Service Corp Inc	1169	1100	\$6,875.00		(\$6,732.00)	+\$ (143.00)
Davis & Tripp Inc	1063	2275	\$14,218.75		(\$13,923.00)	+\$ (295.75)
Dead River Company	1073	1071.322	\$6,695.76		(\$6,556.49)	+\$ (139.27)
Delongchamp Automobile Company Inc	1101	2850	\$17,812.50		(\$17,442.00)	+\$ (370.50)
Delongchamp Sales	6097	3250	\$20,312.50		(\$19,890.00)	+\$ (422.50)
Demers Bros Trucking Inc	1823	1650	\$10,312.50		(\$10,098.00)	+\$ (214.50)
Demoulas Supermarkets Inc	1118	2175	\$13,593.75		(\$13,311.00)	+\$ (282.75)
Denaults Auto Repair	1120	2393	\$14,956.25		(\$14,645.16)	+\$ (311.09)
DiaCom Corporation	1156	1345	\$8,406.25		(\$8,231.40)	+\$ (174.85)
Diamond Crystal Specialty Foods Inc	1158	2000	\$12,500.00		(\$12,240.00)	+\$ (260.00)
Dick's Service Station	1167	1100	\$6,875.00		(\$6,732.00)	+\$ (143.00)
Diggins & Rose Inc	1175	1350	\$8,437.50		(\$8,262.00)	+\$ (175.50)
Dom's Motor Service (DBA: Riverside Kawasaki-Yamaha)	4329	1050	\$6,562.50		(\$6,426.00)	+\$ (136.50)
Domenick Zanni Sons Inc	1217	1350	\$8,437.50		(\$8,262.00)	+\$ (175.50)
Doug's Exxon	1255	1950	\$12,187.50		(\$11,934.00)	+\$ (253.50)
Douglas D Andersen (DBA: D & D Service)	0977	3850	\$24,062.50		(\$23,562.00)	+\$ (500.50)
Down East Drilling	1262	1330	\$8,312.50		(\$8,139.60)	+\$ (172.90)
Downtown Dispatch Inc	1263	2200	\$13,750.00		(\$13,464.00)	+\$ (286.00)
Draco Homes Inc	1270	3450	\$21,562.50		(\$21,114.00)	+\$ (448.50)
Dracut Auto Clinic	1271	1075.5	\$6,721.88		(\$6,582.06)	+\$ (139.82)
Dracut Tire Shop Inc	1274	4625	\$28,906.25		(\$28,305.00)	+\$ (601.25)
Drew's Service Station	1283	1300	\$8,125.00		(\$7,956.00)	+\$ (169.00)

Appendix C(2) New Rate		Total Cash Out	Consists of the following components	
PRP Name	PRP ID	PRP Volume	PAY THIS AMOUNT	(EPA Cash-Out Amount) + (NH Cash-Out Amount)
Drews Tire & Auto Service	1285	1800	\$11,250.00	(\$11,016.00) + (\$234.00)
Drum Hill Construction Corp	1293	1125	\$7,031.25	(\$6,885.00) + (\$146.25)
Dunk's Automotive Service	1309	2050	\$12,812.50	(\$12,546.00) + (\$266.50)
Duns General Repair	1315	1700	\$10,625.00	(\$10,404.00) + (\$221.00)
Eagle Flight Center Inc	1339	1525	\$9,531.25	(\$9,333.00) + (\$198.25)
Early & Sons Inc	1345	2400	\$15,000.00	(\$14,688.00) + (\$312.00)
East Coast Petroleum Corporation	1351	2289	\$14,306.25	(\$14,008.68) + (\$297.57)
East Side Mobil	1378	1300	\$8,125.00	(\$7,956.00) + (\$169.00)
Eastern Lumber Co Inc	1371	2530	\$15,812.50	(\$15,483.60) + (\$328.90)
Eastham Auto Sales Inc (DBA: Harvey's Auto Service)	2521	2310	\$14,437.50	(\$14,137.20) + (\$300.30)
Ed Henley & Sons Automotive Inc	2553	4700	\$29,375.00	(\$28,764.00) + (\$611.00)
Edgcomb Metals Company	1385	1500	\$9,375.00	(\$9,180.00) + (\$195.00)
Edgemont Oil Company	1387	1275	\$7,968.75	(\$7,803.00) + (\$165.75)
Ell Bern Service Corp	0612	1100	\$6,875.00	(\$6,732.00) + (\$143.00)
Energy Machinery Inc	1436	1230	\$7,687.50	(\$7,527.60) + (\$159.90)
ENSERCH E&C Inc	1379	2812.096	\$17,575.60	(\$17,210.03) + (\$365.57)
Erikson Fuel Company Inc	1454	2550	\$15,937.50	(\$15,606.00) + (\$331.50)
Ernest Service Station	1456	3355	\$20,968.75	(\$20,532.60) + (\$436.15)
Essex Gas Company	1460	2110	\$13,187.50	(\$12,913.20) + (\$274.30)
Eugene Beaudry (DBA: Gene's Truck Service)	2251	1800	\$11,250.00	(\$11,016.00) + (\$234.00)
Everett Automatic Transmission Service Inc.	1477	2925	\$18,281.25	(\$17,901.00) + (\$380.25)
Excel Auto Unlimited Inc	1481	1020	\$6,375.00	(\$6,242.40) + (\$132.60)
Exit 4 Service Corp. d/b/a Super Shell Foodmart	5109	1100	\$6,875.00	(\$6,732.00) + (\$143.00)
E/Z Auto Service Center Inc	1500	1651	\$10,318.75	(\$10,104.12) + (\$214.63)
F L Pagano Inc	1701	1450	\$9,062.50	(\$8,874.00) + (\$188.50)
Falmouth Marine & Yachting Center	1522	1875	\$11,718.75	(\$11,475.00) + (\$243.75)
Falmouth Toyota Inc	1525	1600	\$10,000.00	(\$9,792.00) + (\$208.00)

Appendix C(2) New Rate

PRP Name	PRP ID	PRP Volume	Total Cash Out	PAY THIS AMOUNT	Consists of the	following components
					(EPA Cash-Out Amount)	+(NH Cash-Out Amount)
Fazio's Specialty Auto Parts & Service	1577	1100	\$6,875.00		(\$6,732.00)	+(\$143.00)
Felix Exxon Inc	1550	2100	\$13,125.00		(\$12,852.00)	+(\$273.00)
Ferway Mutual /George Pagouris (DBA: Texaco Star)	0341	1130	\$7,062.50		(\$6,915.60)	+(\$146.90)
Fiori's Depot Motors Inc	1133	3100	\$19,375.00		(\$18,972.00)	+(\$403.00)
Fireside Nissan Inc	1582	1250	\$7,812.50		(\$7,650.00)	+(\$162.50)
Fishery Products Int'l	1587	1700	\$10,625.00		(\$10,404.00)	+(\$221.00)
Floyd & Glenn Inc	1612	1400	\$8,750.00		(\$8,568.00)	+(\$182.00)
Foreign Auto Doctor	1628	1400	\$8,750.00		(\$8,568.00)	+(\$182.00)
Foreign Auto Engineering Inc	1629	2050	\$12,812.50		(\$12,546.00)	+(\$266.50)
Foreign Cars of Belmont Inc (DBA: Belmont Volkswagen)	0588	2000	\$12,500.00		(\$12,240.00)	+(\$260.00)
Forrest Service Center Inc	1641	1500	\$9,375.00		(\$9,180.00)	+(\$195.00)
Foss Motors Inc	1645	1050	\$6,562.50		(\$6,426.00)	+(\$136.50)
Foundry Street Garage	1649	1300	\$8,125.00		(\$7,956.00)	+(\$169.00)
Fowler's Express Inc	1655	1400	\$8,750.00		(\$8,568.00)	+(\$182.00)
Frammingham Auto Sales Inc (DBA: Frammingham Ford)	1658	4000	\$25,000.00		(\$24,480.00)	+(\$520.00)
Francis H Maroney Inc	1659	3725	\$23,281.25		(\$22,797.00)	+(\$484.25)
Frank's Auto Repair Inc	1670	1150	\$7,187.50		(\$7,038.00)	+(\$149.50)
Frank's Garage	1671	2565	\$16,031.25		(\$15,697.80)	+(\$333.45)
Frank C Dunlap Inc	1310	1250	\$7,812.50		(\$7,650.00)	+(\$162.50)
Fred's Auto Service	1687	2065	\$12,906.25		(\$12,637.80)	+(\$268.45)
Frederick M. Shaw Inc (DBA: Shaw Saab)	4586	1325	\$8,281.25		(\$8,109.00)	+(\$172.25)
G Conway Inc	2060	1320	\$8,250.00		(\$8,078.40)	+(\$171.60)
G & G Cycle Sales of Salisbury Inc	1697	1365	\$8,531.25		(\$8,353.80)	+(\$177.45)
G & G Enterprises Inc (DBA: Honda Barn)	2630	2450	\$15,312.50		(\$14,994.00)	+(\$318.50)
G & S Management Corp	1668	1350	\$8,437.50		(\$8,262.00)	+(\$175.50)
G & T Automotive Inc	2190	1360	\$8,500.00		(\$8,323.20)	+(\$176.80)
Gas Bars Inc (DBA: North Street Texaco)	3785	3150	\$19,687.50		(\$19,278.00)	+(\$409.50)

Appendix C(2) New Rate		Total Cash Out	Consists of the	following components
PRP Name	PRP ID	PRP Volume	PAY THIS AMOUNT	(EPA Cash-Out Amount) + (NH Cash-Out Amount)
Gaston Andrey of Frammingham Inc	0266	2400	\$15,000.00	(\$14,688.00) + (\$312.00)
Gelo's Inc	2236	4020	\$25,125.00	(\$24,602.40) + (\$522.60)
George's Gulf	2260	2280	\$14,250.00	(\$13,953.60) + (\$296.40)
George Luddy Chevrolet Inc	3170	3150	\$19,687.50	(\$19,278.00) + (\$409.50)
Gill's Automotive Inc	2297	3870	\$24,187.50	(\$23,684.40) + (\$503.10)
Gonthier Service Station	2326	2400	\$15,000.00	(\$14,688.00) + (\$312.00)
Goodnews Garage	2328	1200	\$7,500.00	(\$7,344.00) + (\$156.00)
Grand Prix Imports Inc	2351	2350	\$14,687.50	(\$14,382.00) + (\$305.50)
Grant Plastics Inc	2364	2285	\$14,281.25	(\$13,984.20) + (\$297.05)
Great Neck Saw Manufacturers Inc	0880	1200	\$7,500.00	(\$7,344.00) + (\$156.00)
Greater Lowell Regional Vocational Technical School District	GRP63	2625	\$16,406.25	(\$16,065.00) + (\$341.25)
Grieco Brothers Inc	2403	2735	\$17,093.75	(\$16,738.20) + (\$355.55)
Groton-Dunstable Regional School District	GRP67	1025	\$6,406.25	(\$6,273.00) + (\$133.25)
Grove Products Inc	2414	2650	\$16,562.50	(\$16,218.00) + (\$344.50)
GTE Sylvania Corp (DBA: GTE Operations Support Inc)	2421	1600	\$10,000.00	(\$9,792.00) + (\$208.00)
Guilfoili's Summer Street Garage	2425	1050	\$6,562.50	(\$6,426.00) + (\$136.50)
Gull Tool & Engineering Co Inc	2426	2600	\$16,250.00	(\$15,912.00) + (\$338.00)
Gulwining Service Company Inc (DBA: Paul Russell and Co)	2433	3275	\$20,468.75	(\$20,043.00) + (\$425.75)
H Wright Service Inc	5461	2800	\$17,500.00	(\$17,136.00) + (\$364.00)
Hale Street Automotive	2099	1330	\$8,312.50	(\$8,139.60) + (\$172.90)
Hamel Brothers Service Inc	1666	3765	\$23,531.25	(\$23,041.80) + (\$489.45)
Hamilton Charily	GRP299	2243.6	\$14,022.50	(\$13,730.83) + (\$291.67)
Hammond Park Trust	2462	1170	\$7,312.50	(\$7,160.40) + (\$152.10)
Hampden Dodge	2464	3960	\$24,750.00	(\$24,235.20) + (\$514.80)
Handy & Harman Electronic Materials	2472	2800	\$17,500.00	(\$17,136.00) + (\$364.00)
Hank's Garage	2475	2200	\$13,750.00	(\$13,464.00) + (\$286.00)
Hans' Foreign Auto Repair	2481	1220	\$7,625.00	(\$7,466.40) + (\$158.60)

Appendix C(2) New Rate

PRP Name	PRP ID	PRP Volume	Total Cash Out	PAY THIS AMOUNT	Consists of the following components
					(EPA Cash-Out Amount) + (NH Cash-Out Amount)
Harbro Auto Service	2495	1050	\$6,562.50		(\$6,426.00) + (\$136.50)
Hathaway Transmission Service Inc	2528	1450	\$9,062.50		(\$8,874.00) + (\$188.50)
Heating Oil Partners LP	0601	1950	\$12,187.50		(\$11,934.00) + (\$253.50)
Heidimarie Service Corp (DBA: Milton Shell Service Center)	3502	1275	\$7,968.75		(\$7,803.00) + (\$165.75)
HEJ Corporation	2885	4800	\$30,000.00		(\$29,376.00) + (\$624.00)
Hendrix Wire & Cable	2552	4860	\$30,375.00		(\$29,743.20) + (\$631.80)
Henny's Auto Parts Inc	2557	3228	\$20,175.00		(\$19,755.36) + (\$419.64)
Henny's Sunoco Inc	2562	3650	\$22,812.50		(\$22,338.00) + (\$474.50)
Heritage Operating L P (DBA: Kingston Propane)	2948	1195	\$7,468.75		(\$7,313.40) + (\$155.35)
Hogan Tire Centers Inc	2604	1050	\$6,562.50		(\$6,426.00) + (\$136.50)
Holden Heating Co	2609	2812.096	\$17,575.60		(\$17,210.03) + (\$365.57)
Holden Oil Inc	2611	3300	\$20,625.00		(\$20,196.00) + (\$429.00)
Hollingsworth & Vose Company	2616	1550	\$9,687.50		(\$9,486.00) + (\$201.50)
Holmes Products Corp	2622	1230	\$7,687.50		(\$7,527.60) + (\$159.90)
Hometown Auto Framingham Inc (DBA: Bay State Lincoln Mercury)	0553	1850	\$11,562.50		(\$11,322.00) + (\$240.50)
Honda Cars of Boston	2631	2000	\$12,500.00		(\$12,240.00) + (\$260.00)
Honda Village Inc	2635	4175	\$26,093.75		(\$25,551.00) + (\$542.75)
Honeywell Inc	2636	4414	\$27,587.50		(\$27,013.68) + (\$573.82)
Hub Foundation Co Inc	2657	2100	\$13,125.00		(\$12,852.00) + (\$273.00)
Hub Starters & Alternators Inc	2658	1600	\$10,000.00		(\$9,792.00) + (\$208.00)
Huggard & Ewing Inc	2666	1355	\$8,468.75		(\$8,292.60) + (\$176.15)
Hyannis Nissan Inc	2672	2950	\$18,437.50		(\$18,054.00) + (\$383.50)
Hydramatic Sales & Service Corp	2678	2700	\$16,875.00		(\$16,524.00) + (\$351.00)
I-95 Sunoco Inc	4361	1259	\$7,868.75		(\$7,705.08) + (\$163.67)
Ideal Transmissions Inc	1529	1650	\$10,312.50		(\$10,098.00) + (\$214.50)
Ideal Transportation Company Inc	1704	1025	\$6,406.25		(\$6,273.00) + (\$133.25)
Imported Cars of Worcester Inc	2624	1250	\$7,812.50		(\$7,650.00) + (\$162.50)

Appendix C(2) New Rate

PRP Name	PRP ID	PRP Volume	Total Cash Out	PAY THIS AMOUNT	Consists of the (EPA Cash-Out Amount)	following components (NH Cash-Out Amount)
Internal Combustion Ltd	2691	3865	\$24,156.25		(\$23,653.80)	+\$502.45)
Interstate Brands Corp (DBA: My Bread Baking Co)	4875	4400	\$27,500.00		(\$26,928.00)	+\$572.00)
Interstate Brands Corporation	2050	1125	\$7,031.25		(\$6,885.00)	+\$146.25)
Interstate Gas & Oil Corp	2696	2130	\$13,312.50		(\$13,035.60)	+\$276.90)
Irving's Service Center Inc	2706	1300	\$8,125.00		(\$7,956.00)	+\$169.00)
Irving Oil Corporation	0633	1500	\$9,375.00		(\$9,180.00)	+\$195.00)
Iverson Ford Sales Inc	2711	4235	\$26,468.75		(\$25,918.20)	+\$550.55)
J J O'Brien & Sons Inc	3796	4200	\$26,250.00		(\$25,704.00)	+\$546.00)
J L Hammett Co	6010	2000	\$12,500.00		(\$12,240.00)	+\$260.00)
J M Cashman Inc	1812	1470	\$9,187.50		(\$8,996.40)	+\$191.10)
J P Realty Trust	2737	1150	\$7,187.50		(\$7,038.00)	+\$149.50)
J & A AutoBody & Repairing	1708	1020	\$6,375.00		(\$6,242.40)	+\$132.60)
J & C Auto Repairs Inc	2716	3850	\$24,062.50		(\$23,562.00)	+\$500.50)
James A Mahoney & Sons Inc	3218	2040	\$12,750.00		(\$12,484.80)	+\$265.20)
James R Nicholson	3716	1860	\$11,625.00		(\$11,383.20)	+\$241.80)
James V Silva (DBA: Silva's Garage)	4618	1775	\$11,093.75		(\$10,863.00)	+\$230.75)
Jannor Enterprises Inc (DBA: Midas)	2768	2300	\$14,375.00		(\$14,076.00)	+\$299.00)
Jean's Auto Service	2778	2050	\$12,812.50		(\$12,546.00)	+\$266.50)
Jefferson Smurfit Corporation (US)	2044	3200	\$20,000.00		(\$19,584.00)	+\$416.00)
Jenness W Merrick (DBA: Bud Merrick Transmission Service)	3396	4610	\$28,812.50		(\$28,213.20)	+\$599.30)
JF White Contractor	5381	1100	\$6,875.00		(\$6,732.00)	+\$143.00)
Jim's American	2795	2720	\$17,000.00		(\$16,646.40)	+\$353.60)
Jim's Auto Service	2800	1050	\$6,562.50		(\$6,426.00)	+\$136.50)
Jim How Chevrolet Inc	2649	1575	\$9,843.75		(\$9,639.00)	+\$204.75)
Joel R Labell	6013	1200	\$7,500.00		(\$7,344.00)	+\$156.00)
John's Citgo	2853	1050	\$6,562.50		(\$6,426.00)	+\$136.50)
John's Foreign Car Service Inc	2856	2400	\$15,000.00		(\$14,688.00)	+\$312.00)

Appendix C(2) New Rate

PRP Name	PRP ID	PRP Volume	Total Cash Out PAY THIS AMOUNT	Consists of the (EPA Cash-Out Amount)	following components (NH Cash-Out Amount)
John B Duda (DBA: Shell Service Station)	4597	1675	\$10,468.75	(\$10,251.00)	+\$217.75)
John C Bell Inc (DBA: New Meadows Auto Repair)	3685	1150	\$7,187.50	(\$7,038.00)	+\$149.50)
John C Sarette (DBA: JT&B Texaco)	2843	3200	\$20,000.00	(\$19,584.00)	+\$416.00)
John J Benson Inc	0600	1600	\$10,000.00	(\$9,792.00)	+\$208.00)
John Mento Inc (DBA: South Meadow Citigo)	5226	1025	\$6,406.25	(\$6,273.00)	+\$133.25)
John Sales & Service	6098	1200	\$7,500.00	(\$7,344.00)	+\$156.00)
John W Cutter Inc (DBA: AAMCO Transmissions)	0037	1850	\$11,562.50	(\$11,322.00)	+\$240.50)
Johns Gulf	2857	3500	\$21,875.00	(\$21,420.00)	+\$455.00)
Johnson Controls Inc	2871	3825	\$23,906.25	(\$23,409.00)	+\$497.25)
Johnson Transmission	2875	2300	\$14,375.00	(\$14,076.00)	+\$299.00)
Jones Lang LaSalle Management Services Inc	3028	2150	\$13,437.50	(\$13,158.00)	+\$279.50)
Joseph A Noujaim (DBA: Byblos Mercedes Clinic)	0934	1800	\$11,250.00	(\$11,016.00)	+\$234.00)
Joseph D Coloni Jr (DBA: Joey's Auto Repair)	2834	2050	\$12,812.50	(\$12,546.00)	+\$266.50)
Joseph J Miliano (DBA: Lakeside Exxon)	2998	1250	\$7,812.50	(\$7,650.00)	+\$162.50)
Joseph L Rymne (DBA: Rymne's Auto Sales)	4443	3125	\$19,531.25	(\$19,125.00)	+\$406.25)
Joseph P Cardillo & Son Inc	1779	1150	\$7,187.50	(\$7,038.00)	+\$149.50)
JR Weigel & Son Inc	5306	2730	\$17,062.50	(\$16,707.60)	+\$354.90)
J.L.J. Enterprises, Inc.	GRP440	3430	\$21,437.50	(\$20,991.60)	+\$445.90)
KCo Inc	1426	3200	\$20,000.00	(\$19,584.00)	+\$416.00)
Keller Company Inc	2812	1140	\$7,125.00	(\$6,976.80)	+\$148.20)
Kelly's Tire Mart Inc	2895	1822	\$11,387.50	(\$11,150.64)	+\$236.86)
Kelsey's Garage	2896	1100	\$6,875.00	(\$6,732.00)	+\$143.00)
Ken's Auto Repair Inc	2913	2475	\$15,468.75	(\$15,147.00)	+\$321.75)
Ken's Garage	2907	2450	\$15,312.50	(\$14,994.00)	+\$318.50)
Kendall Green Service Center	2902	1150	\$7,187.50	(\$7,038.00)	+\$149.50)
Kenwood Auto	2924	1500	\$9,375.00	(\$9,180.00)	+\$195.00)
Keoghane Brothers Inc	2925	1250	\$7,812.50	(\$7,650.00)	+\$162.50)

Appendix C(2) New Rate

PRP Name	PRP ID	PRP Volume	Total Cash Out PAY THIS AMOUNT	Consists of the (EPA Cash-Out Amount) + following components (NH Cash-Out Amount)
Kevin King Enterprises Inc	2937	2950	\$18,437.50	(\$18,054.00) + (\$383.50)
Kingslon Alignment & Tire Center Inc	2942	1560	\$9,750.00	(\$9,547.20) + (\$202.80)
Kinsman Service Station Inc	2952	2700	\$16,875.00	(\$16,524.00) + (\$351.00)
Kmart Corporation	2956	1950	\$12,187.50	(\$11,934.00) + (\$253.50)
Knight Oil Inc	2959	2650	\$16,562.50	(\$16,218.00) + (\$344.50)
K&R Industries Inc (DBA: Transmission World)	5066	2100	\$13,125.00	(\$12,852.00) + (\$273.00)
Lake Ave Gulf	2989	2700	\$16,875.00	(\$16,524.00) + (\$351.00)
Lake Street Auto	2992	1325	\$8,281.25	(\$8,109.00) + (\$172.25)
Lakeview Shell Inc	3001	1050	\$6,562.50	(\$6,426.00) + (\$136.50)
Landry's Automotive	3135	1350	\$8,437.50	(\$8,262.00) + (\$175.50)
Lavallee's Transmission Service	3032	4000	\$25,000.00	(\$24,480.00) + (\$520.00)
Law Motor Freight Inc (DBA: Heavy Duty Truck & Deisel Service)	2541	4000	\$25,000.00	(\$24,480.00) + (\$520.00)
Lewis Equipment Co Inc	3086	2000	\$12,500.00	(\$12,240.00) + (\$260.00)
Lexington Mobil	3092	1450	\$9,062.50	(\$8,874.00) + (\$188.50)
Lindberg Heat Treating Company	3111	3775	\$23,593.75	(\$23,103.00) + (\$490.75)
Linsky's Inc	3116	2200	\$13,750.00	(\$13,464.00) + (\$286.00)
Lombardi Oil Company Inc	3131	3200	\$20,000.00	(\$19,564.00) + (\$436.00)
Longwood Buick Co Inc	3138	1800	\$11,250.00	(\$11,016.00) + (\$234.00)
Lub-O-Line Industrial Oil Co Inc	3163	2600	\$16,250.00	(\$15,912.00) + (\$338.00)
Lucchetti's Service Center Inc	3166	1565	\$9,781.25	(\$9,577.80) + (\$203.45)
Lynn Fells Exxon	3181	2850	\$17,812.50	(\$17,442.00) + (\$370.50)
Lyons Enterprises Inc	3188	1400	\$8,750.00	(\$8,568.00) + (\$182.00)
M P & G Tune-Up of Malden Inc	4114	2462	\$15,387.50	(\$15,067.44) + (\$320.06)
M / A-Com Inc (DBA: AMP Inc)	2819	1850	\$11,562.50	(\$11,322.00) + (\$240.50)
Mackenzie Trust (DBA: Mackenzie Motors)	3202	1072	\$6,700.00	(\$6,560.64) + (\$139.36)
Madico Inc	3212	1950	\$12,187.50	(\$11,934.00) + (\$253.50)
Magic Discount Muffler Inc	2612	1170	\$7,312.50	(\$7,160.40) + (\$152.10)

Appendix C(2) New Rate

PRP Name	PRP ID	PRP Volume	Total Cash Out PAY THIS AMOUNT	Consists of the (EPA Cash-Out Amount)	following components (NH Cash-Out Amount)
Main Street Auto Sales	3226	1600	\$10,000.00	(\$9,792.00)	+\$208.00)
Main Street Services Inc	3228	2000	\$12,500.00	(\$12,240.00)	+\$260.00)
Main Street Sunoco	3224	2700	\$16,875.00	(\$16,524.00)	+\$351.00)
Manchester Auto Clinic	3249	1400	\$8,750.00	(\$8,568.00)	+\$182.00)
Mandeville Chevrolet Inc	3255	1150	\$7,187.50	(\$7,038.00)	+\$149.50)
Manufacturer's Rubber & Supply Co	3584	1100	\$6,875.00	(\$6,732.00)	+\$143.00)
Marblehead Trading Company (DBA: The Forepeak)	3274	1050	\$6,562.50	(\$6,426.00)	+\$136.50)
Marken Properties Inc	3290	2460	\$15,375.00	(\$15,055.20)	+\$319.80)
Martel Automotive Service	3310	4600	\$28,750.00	(\$28,152.00)	+\$598.00)
Marty's Inc	3318	2203	\$13,768.75	(\$13,482.36)	+\$286.39)
Mass-Vac Inc	3328	4635	\$28,968.75	(\$28,366.20)	+\$602.55)
Massachusetts Adjutant General	GRP129	3760	\$23,500.00	(\$23,011.20)	+\$488.80)
Massachusetts Bay Transportation Authority	GRP124	2855	\$17,843.75	(\$17,472.60)	+\$371.15)
Massachusetts Port Authority	GRP103	2765	\$17,281.25	(\$16,921.80)	+\$359.45)
Massachusetts Turnpike Authority	GRP109	1845	\$11,531.25	(\$11,291.40)	+\$239.85)
Matty's Service	2548	2950	\$18,437.50	(\$18,054.00)	+\$383.50)
Max Levine and Co Inc	0047	1700	\$10,625.00	(\$10,404.00)	+\$221.00)
McDevitt Machinery Inc	3283	5000	\$31,250.00	(\$30,600.00)	+\$650.00)
McFarland Ford Sales Inc	3194	3000	\$18,750.00	(\$18,360.00)	+\$390.00)
McGreavy Buick-Cadillac Inc	3342	1100	\$6,875.00	(\$6,732.00)	+\$143.00)
McKenna & O'Keefe Auto Repairs Inc	3345	1920	\$12,000.00	(\$11,750.40)	+\$249.60)
McKinney Bus Co Inc	3346	1350	\$8,437.50	(\$8,262.00)	+\$175.50)
McLaughlin Chevrolet Inc	3348	3300	\$20,625.00	(\$20,196.00)	+\$429.00)
Mears Tractors Inc	5924	1975	\$12,343.75	(\$12,087.00)	+\$256.75)
Medford Automatic Transmission Inc	3366	3250	\$20,312.50	(\$19,890.00)	+\$422.50)
Medway Auto Sales Inc	3368	4675	\$29,218.75	(\$28,611.00)	+\$607.75)
Merrimac Truck & Equipment Inc	3401	2050	\$12,812.50	(\$12,546.00)	+\$266.50)

Appendix C(2) New Rate

PRP Name	PRP ID	PRP Volume	Total Cash Out	PAY THIS AMOUNT	Consists of the (EPA Cash-Out Amount)	following components (NH Cash-Out Amount)
Merrimack Valley Hebrew Academy	3405	1200	\$7,500.00		(\$7,344.00)	+\$ (156.00)
Morrow's Inc	3407	2600	\$16,250.00		(\$15,912.00)	+\$ (338.00)
Metech International Inc	0724	1650	\$10,312.50		(\$10,098.00)	+\$ (214.50)
Methuen Construction	3412	4200	\$26,250.00		(\$25,704.00)	+\$ (546.00)
Methuen Motor Mart Inc	3417	1750	\$10,937.50		(\$10,710.00)	+\$ (227.50)
Michael Cartier (DBA: Dube's Garage)	1301	1200	\$7,500.00		(\$7,344.00)	+\$ (156.00)
Micromatic Products Co Inc	3432	2575	\$16,093.75		(\$15,759.00)	+\$ (334.75)
Mitfold Inc (DBA: Raynham Midas Muffler and Brake Shop)	1929	2009	\$12,556.25		(\$12,295.08)	+\$ (261.17)
Mike's Garage	3472	3750	\$23,437.50		(\$22,950.00)	+\$ (487.50)
Mike's Service Station	3475	2250	\$14,062.50		(\$13,770.00)	+\$ (292.50)
Miller's Auto Body	3493	4000	\$25,000.00		(\$24,480.00)	+\$ (520.00)
Miller Auto Service	3487	1100	\$6,875.00		(\$6,732.00)	+\$ (143.00)
Millis Shell	3498	2250	\$14,062.50		(\$13,770.00)	+\$ (292.50)
Mine Safety Appliances Company	3503	1200	\$7,500.00		(\$7,344.00)	+\$ (156.00)
Minuteman Volkswagen Inc	3507	1585	\$9,906.25		(\$9,700.20)	+\$ (206.05)
Mitch and Rogers Auto Service	3512	3650	\$22,812.50		(\$22,338.00)	+\$ (474.50)
Mitchell's Exxon	3514	3200	\$20,000.00		(\$19,584.00)	+\$ (416.00)
Mohawk Village Motors Inc	3534	1375	\$8,593.75		(\$8,415.00)	+\$ (178.75)
Molloy's Garage Inc	3537	3200	\$20,000.00		(\$19,584.00)	+\$ (416.00)
Monro/Speedy Muffler Group	GRP437	2072	\$12,950.00		(\$12,680.64)	+\$ (269.36)
Monsanto Company	6036	4700	\$29,375.00		(\$28,764.00)	+\$ (611.00)
Montachusett Regional Vocational Technical School District	GRP255	2000	\$12,500.00		(\$12,240.00)	+\$ (260.00)
Monument Square Sunoco Service Center	3549	1200	\$7,500.00		(\$7,344.00)	+\$ (156.00)
Moody St Mobil Inc	3550	1100	\$6,875.00		(\$6,732.00)	+\$ (143.00)
Morrin's Service Station Inc	3562	1600	\$10,000.00		(\$9,792.00)	+\$ (208.00)
Morton Jaguar Service Inc	2761	2150	\$13,437.50		(\$13,158.00)	+\$ (279.50)
Motor Medics Inc	3570	2150	\$13,437.50		(\$13,158.00)	+\$ (279.50)

Appendix C(2) New Rate

PRP Name	PRP ID	PRP Volume	Total Cash Out PAY THIS AMOUNT	Consists of the EPA Cash-Out Amount	following components (NH Cash-Out Amount)
Moujaes Inc (DBA: C & J Mobil)	0956	4300	\$26,875.00	(\$26,316.00)	+\$559.00
Moujaes Inc (DBA: C & J Mobil)	3495	3400	\$21,250.00	(\$20,808.00)	+\$442.00
Mount Auburn Hospital	3578	2139	\$13,368.75	(\$13,090.68)	+\$278.07
Muldoon Bros Inc	3594	1570	\$9,812.50	(\$9,608.40)	+\$204.10
Multi-State Roofing Inc	3597	1475	\$9,218.75	(\$9,027.00)	+\$191.75
N N 6 Inc (DBA: SpeedDee Oil Change & Tune-Up)	4721	1500	\$9,375.00	(\$9,180.00)	+\$195.00
Nahra Bus Company, Inc.	GRP294	1990	\$12,437.50	(\$12,178.80)	+\$258.70
Nai Enterprises Inc (DBA: Toyota of Wellesley)	5056	1084	\$6,775.00	(\$6,634.08)	+\$140.92
Narragansett Improvement Co	0382	2000	\$12,500.00	(\$12,240.00)	+\$260.00
Nashua Corporation	3620	1250	\$7,812.50	(\$7,650.00)	+\$162.50
New England Tank Company	3675	1520	\$9,500.00	(\$9,302.40)	+\$197.60
New England Transmission Co Inc	3679	2725	\$17,031.25	(\$16,677.00)	+\$354.25
New Hampshire Adjutant General	GRP108	2400	\$15,000.00	(\$14,688.00)	+\$312.00
New Hampshire Department of Environmental Services	GRP265	1400	\$8,750.00	(\$8,568.00)	+\$182.00
New Penn Motor Express Inc	3688	3700	\$23,125.00	(\$22,644.00)	+\$481.00
New Tern Harbor Marina Inc	3689	1250	\$7,812.50	(\$7,650.00)	+\$162.50
Newman Ford Sales Inc	3694	1200	\$7,500.00	(\$7,344.00)	+\$156.00
North River Auto Service	3775	1626	\$10,162.50	(\$9,951.12)	+\$211.38
North River Motors Inc	5330	1100	\$6,875.00	(\$6,732.00)	+\$143.00
North Shore Regional Vocational School District	GRP270	1700	\$10,625.00	(\$10,404.00)	+\$221.00
North Willmington Shell	0610	1580	\$9,875.00	(\$9,669.60)	+\$205.40
Northeast Refrigeration and Heating Co., Inc (DBA: Northeast Equipment Distributors)	3753	1300	\$8,125.00	(\$7,956.00)	+\$169.00
O'Brien's Car Care & Towing Inc	3800	1026	\$6,412.50	(\$6,279.12)	+\$133.38
O F Welker Inc (DBA: Welker's 16 Acres Mobil)	1984	3200	\$20,000.00	(\$19,564.00)	+\$436.00
Olin Hunt Specialty Products Inc	3820	3160	\$19,750.00	(\$19,339.20)	+\$410.80
P A Landers Inc	2377	4075	\$25,468.75	(\$24,939.00)	+\$529.75
P & M Service Center Inc	3846	1500	\$9,375.00	(\$9,180.00)	+\$195.00

Appendix C(2) New Rate

PRP Name	PRP ID	PRP Volume	Total Cash Out PAY THIS AMOUNT	Consists of the (EPA Cash-Out Amount) +	following components (NH Cash-Out Amount)
Paragios Enterprise Inc	3873	1050	\$6,562.50	(\$6,426.00) +	(\$136.50)
Park Avenue Citgo	3881	1500	\$9,375.00	(\$9,180.00) +	(\$195.00)
Pass & Weisz Inc	3905	2550	\$15,937.50	(\$15,606.00) +	(\$331.50)
Patalano Chrysler Plymouth Inc	3906	1465	\$9,156.25	(\$8,965.80) +	(\$190.45)
Paul's Auto	3917	1350	\$8,437.50	(\$8,262.00) +	(\$175.50)
Paul's Transmission Repair	3926	1240	\$7,750.00	(\$7,588.80) +	(\$161.20)
PCI Group Inc	3931	1315	\$8,218.75	(\$8,047.80) +	(\$170.95)
Pelham Street Getty Inc	3947	1400	\$8,750.00	(\$8,568.00) +	(\$182.00)
Pelham Street Shell	1370	4350	\$27,187.50	(\$26,622.00) +	(\$565.50)
Pelletier Bros Garage	3946	3400	\$21,250.00	(\$20,808.00) +	(\$442.00)
Perry Motors	3985	2700	\$16,875.00	(\$16,524.00) +	(\$351.00)
Peter's Auto Sales Inc	3991	2500	\$15,625.00	(\$15,300.00) +	(\$325.00)
Peter A Macheras (DBA: Macheras Service Station)	3198	3250	\$20,312.50	(\$19,890.00) +	(\$422.50)
Peterborough Oil Company	3989	1900	\$11,875.00	(\$11,628.00) +	(\$247.00)
Phil Jr's Mobil Station	4009	1350	\$8,437.50	(\$8,262.00) +	(\$175.50)
Phillips Exeter Academy	4004	3550	\$22,187.50	(\$21,726.00) +	(\$461.50)
Plastow Precast Corporation (DBA: New England Precast Corp)	3672	2000	\$12,500.00	(\$12,240.00) +	(\$260.00)
Plant Action Inc	4043	1200	\$7,500.00	(\$7,344.00) +	(\$156.00)
Plummers Oil Service Inc	4053	1300	\$8,125.00	(\$7,956.00) +	(\$169.00)
Plymouth Rock Transportation Corporation	4058	1450	\$9,062.50	(\$8,874.00) +	(\$188.50)
Polyclad Laminates Inc	4068	3450	\$21,562.50	(\$21,114.00) +	(\$448.50)
Port City Nissan Inc	1441	1800	\$11,250.00	(\$11,016.00) +	(\$234.00)
Port Shell Service	4076	1600	\$10,000.00	(\$9,792.00) +	(\$208.00)
Porter Chevrolet Inc	4075	4975	\$31,093.75	(\$30,447.00) +	(\$646.75)
Portsmouth Motor Mart	4081	1600	\$10,000.00	(\$9,792.00) +	(\$208.00)
Poulin Corp (DBA: Dick Poulin Chrysler-Plymouth-Jeep-Eagle)	4084	4850	\$30,312.50	(\$29,682.00) +	(\$630.50)
Power's Service Station Inc	4093	1550	\$9,687.50	(\$9,486.00) +	(\$201.50)

Appendix C(2) New Rate

PRP Name	PRP ID	PRP Volume	Total Cash Out	PAY THIS AMOUNT	Consists of the (EPA Cash-Out Amount)	following components (NH Cash-Out Amount)
Pratt & Whitney	4094	1375	\$8,593.75		(\$8,415.00)	+\$ (178.75)
Praxair Inc	3118	1500	\$9,375.00		(\$9,180.00)	+\$ (195.00)
Prompt Construction Company Inc	4125	2000	\$12,500.00		(\$12,240.00)	+\$ (260.00)
PSC Inc (DBA: Ronnie's Oil)	4376	3200	\$20,000.00		(\$19,584.00)	+\$ (416.00)
Quality Controls Inc	4153	3000	\$18,750.00		(\$18,360.00)	+\$ (390.00)
Quinn Bros Corp	4161	3110	\$19,437.50		(\$19,033.20)	+\$ (404.30)
R L Buzzell Inc	0933	1540	\$9,625.00		(\$9,424.80)	+\$ (200.20)
R Zambino & Sons Inc	5489	1250	\$7,812.50		(\$7,650.00)	+\$ (162.50)
R & J Getty Inc	4335	3850	\$24,062.50		(\$23,562.00)	+\$ (500.50)
Ralph J Scovotti (DBA: Bradford Towing Co)	0791	4850	\$30,312.50		(\$29,682.00)	+\$ (630.50)
Ramey Contractors Engineers Inc	4201	2650	\$16,562.50		(\$16,218.00)	+\$ (344.50)
Ray's Auto Service Inc	4224	2425	\$15,156.25		(\$14,841.00)	+\$ (315.25)
Ray Merchand Oil Co Inc	3196	1350	\$8,437.50		(\$8,262.00)	+\$ (175.50)
Raymond's Hilltop Inc	4220	1050	\$6,562.50		(\$6,426.00)	+\$ (136.50)
Raytheon Company	4232	2350	\$14,687.50		(\$14,382.00)	+\$ (305.50)
Reading Car Care Center Inc	4236	1250	\$7,812.50		(\$7,650.00)	+\$ (162.50)
Reading Shell and Tire Center	4115	1700	\$10,625.00		(\$10,404.00)	+\$ (221.00)
Rent-A-Tool Inc	4263	1450	\$9,062.50		(\$8,874.00)	+\$ (188.50)
Revere Auto Parts Inc	4270	1200	\$7,500.00		(\$7,344.00)	+\$ (156.00)
RGA Tire & Auto Repair Inc	4278	2085	\$13,031.25		(\$12,760.20)	+\$ (271.05)
Rhode Island Convention Center Authority	2055	4675	\$29,218.75		(\$28,611.00)	+\$ (607.75)
Richard Tanning Co Inc	4921	1500	\$9,375.00		(\$9,180.00)	+\$ (195.00)
Richie's Mobil Inc	4291	2100	\$13,125.00		(\$12,852.00)	+\$ (273.00)
Riverfront Marine Sports Inc	4325	2350	\$14,687.50		(\$14,382.00)	+\$ (305.50)
Riverside Foreign Auto Inc	4328	1450	\$9,062.50		(\$8,874.00)	+\$ (188.50)
Riverside Transmission Co	4330	1400	\$8,750.00		(\$8,568.00)	+\$ (182.00)
RJ Brunault Inc (DBA: Dick's Citgo)	1166	5000	\$31,250.00		(\$30,600.00)	+\$ (650.00)

Appendix C(2) New Rate

PRP Name	PRP ID	PRP Volume	PAY THIS AMOUNT	Total Cash Out	Consists of the following components
			(EPA Cash-Out Amount) +	(NH Cash-Out Amount)	
Robbins Garage Inc	4337	1200	\$7,500.00	(\$7,344.00) + (\$156.00)	
Robert A Chiacchio (DBA: Newton Street Service)	3703	1450	\$9,062.50	(\$8,874.00) + (\$188.50)	
Robert Abate & Peter Abate (DBA: Ryal Side Auto Center)	4438	1500	\$9,375.00	(\$9,180.00) + (\$195.00)	
Robert Fawcett & Son Co Inc	1542	1400	\$8,750.00	(\$8,568.00) + (\$182.00)	
Robert K Sweet Jr (DBA: Buddy's Garage)	0883	1250	\$7,812.50	(\$7,650.00) + (\$162.50)	
Robert Marsland	3593	4275	\$26,718.75	(\$26,163.00) + (\$555.75)	
Roberts Motor Sales Inc	4344	2250	\$14,062.50	(\$13,770.00) + (\$292.50)	
Rochester Agricultural & Mechanical Association	1182	2000	\$12,500.00	(\$12,240.00) + (\$260.00)	
Rochester Ford Sales Inc	4351	2425	\$15,156.25	(\$14,841.00) + (\$315.25)	
Rochester Lincoln-Mercury	4352	1075	\$6,718.75	(\$6,579.00) + (\$139.75)	
Rockland Motors Inc	4355	1850	\$11,562.50	(\$11,322.00) + (\$240.50)	
Rod's Auto Care	4360	3175	\$19,843.75	(\$19,431.00) + (\$412.75)	
Roger Thibault Inc (DBA: Main Shell Service)	3222	1750	\$10,937.50	(\$10,710.00) + (\$227.50)	
Ron's Mobil Inc	4382	3200	\$20,000.00	(\$19,584.00) + (\$416.00)	
Rose's Oil Service Inc	4390	3250	\$20,312.50	(\$19,890.00) + (\$422.50)	
Roy's Place	4404	1200	\$7,500.00	(\$7,344.00) + (\$156.00)	
Roy Rioux Volkswagen Inc	4316	3050	\$19,062.50	(\$18,666.00) + (\$396.50)	
RPP Corporation	4412	4295	\$26,843.75	(\$26,285.40) + (\$558.35)	
RS Audley Inc	0376	1700	\$10,625.00	(\$10,404.00) + (\$221.00)	
S J McNeilly Oldsmobile Inc	3352	4050	\$25,312.50	(\$24,786.00) + (\$526.50)	
S S Pierce	4019	3050	\$19,062.50	(\$18,666.00) + (\$396.50)	
S & E Auto Service & Sales Inc	4445	1530	\$9,562.50	(\$9,363.60) + (\$198.90)	
S & L Automotive Repair Inc	1259	2750	\$17,187.50	(\$16,830.00) + (\$357.50)	
Saef Lincoln-Mercury Inc (DBA: Goss Lincoln-Mercury)	2340	2100	\$13,125.00	(\$12,852.00) + (\$273.00)	
Saint-Gobain Corporation	0655	3200	\$20,000.00	(\$19,584.00) + (\$416.00)	
Salem State College	GRP-191	2100	\$13,125.00	(\$12,852.00) + (\$273.00)	
Salisbury Auto Salvage	4475	3180	\$19,875.00	(\$19,461.60) + (\$413.40)	

Appendix C(2) New Rate

PRP Name	PRP ID	PRP Volume	Total Cash Out PAY THIS AMOUNT	Consists of the (EPA Cash-Out Amount)	following components (NH Cash-Out Amount)
Sam Joseph Catiso (DBA: Little Car Care)	3124	2250	\$14,062.50	(\$13,770.00)	+\$ (292.50)
San-Vel Concrete Corporation	4513	1200	\$7,500.00	(\$7,344.00)	+\$ (\$156.00)
Sawtelle Brothers Inc	4521	1100	\$6,875.00	(\$6,732.00)	+\$ (\$143.00)
Saybolt Inc	4524	1150	\$7,187.50	(\$7,038.00)	+\$ (\$149.50)
SBE Inc (DBA: Dawes Engine Generator)	1068	1200	\$7,500.00	(\$7,344.00)	+\$ (\$156.00)
Schlott Company Inc	4531	1900	\$11,875.00	(\$11,628.00)	+\$ (\$247.00)
School Administrative Unit Fifty Six	GRP282	2200	\$13,750.00	(\$13,464.00)	+\$ (\$286.00)
School Street Sunoco Inc	4534	1380	\$8,625.00	(\$8,445.60)	+\$ (\$179.40)
Scooby's Truck Sales	4533	1400	\$8,750.00	(\$8,568.00)	+\$ (\$182.00)
Scott-Williams Inc	5405	1205	\$7,531.25	(\$7,374.60)	+\$ (\$156.65)
Scott Construction Co Inc	4537	1075	\$6,718.75	(\$6,579.00)	+\$ (\$139.75)
Scotty's Service Inc	4541	4900	\$30,625.00	(\$29,988.00)	+\$ (\$637.00)
Seacoast Auto Parts Inc	4547	1200	\$7,500.00	(\$7,344.00)	+\$ (\$156.00)
Seacoast Volkswagen Inc (DBA: Seacoast VW Mazda)	4551	1075	\$6,718.75	(\$6,579.00)	+\$ (\$139.75)
SGS Control Services Inc	4577	1300	\$8,125.00	(\$7,956.00)	+\$ (\$169.00)
Shaughnessy Crane Service Inc (DBA: Shaughnessy and Ahern Co)	4585	1550	\$9,687.50	(\$9,486.00)	+\$ (\$201.50)
Sierra Contracting Co Inc	4608	1050	\$6,562.50	(\$6,426.00)	+\$ (\$136.50)
Silva Tire Depot Inc	4617	2650	\$16,562.50	(\$16,218.00)	+\$ (\$344.50)
Simmie's Garage Inc	4619	3835	\$23,968.75	(\$23,470.20)	+\$ (\$498.55)
Skelley Motor Co	4599	4760	\$29,750.00	(\$29,131.20)	+\$ (\$618.80)
Skilling & Sons Inc	4630	1025	\$6,406.25	(\$6,273.00)	+\$ (\$133.25)
Sloban Auto Body Inc	4638	3810	\$23,812.50	(\$23,317.20)	+\$ (\$495.30)
Smyly Autos Inc	4662	1864	\$11,650.00	(\$11,407.68)	+\$ (\$242.32)
Sons of Mary Health of the Slick Inc	4671	1830	\$11,437.50	(\$11,199.60)	+\$ (\$237.90)
Southcoast Hospitals Group Inc (DBA: Saint Luke's Hospital)	4465	2700	\$16,875.00	(\$16,524.00)	+\$ (\$351.00)
Spalding Construction Inc	4714	1825	\$11,406.25	(\$11,169.00)	+\$ (\$237.25)
St Margaret Parish	4767	1400	\$8,750.00	(\$8,568.00)	+\$ (\$182.00)

Appendix C(2) New Rate

PRP Name	PRP ID	PRP Volume	Total Cash Out PAY THIS AMOUNT	Consists of the (EPA Cash-Out Amount)	following components (NH Cash-Out Amount)
St Mary's Rectory	6065	3700	\$23,125.00	(\$22,644.00)	+\$481.00)
St Peters Realty Trust	4768	3200	\$20,000.00	(\$19,584.00)	+\$416.00)
Stacy's Automotive Service	4772	4185	\$26,156.25	(\$25,612.20)	+\$544.05)
Standard-Thomson Corporation	4775	3020	\$18,875.00	(\$18,482.40)	+\$392.60)
Stephen Antinirelli Inc (DBA: Plains Automotive)	0279	1214	\$7,587.50	(\$7,429.68)	+\$157.82)
Stephen H Craig (DBA: Plympton Service Center)	4061	1210	\$7,562.50	(\$7,405.20)	+\$157.30)
Stephen J Pettepit (DBA: Beacon Street Sunoco)	0558	1550	\$9,687.50	(\$9,486.00)	+\$201.50)
Stewart's Service Station	4823	1550	\$9,687.50	(\$9,486.00)	+\$201.50)
Stoney Hill Arco	4832	2600	\$16,250.00	(\$15,912.00)	+\$338.00)
Stroock & Stroock & Lavan LLP	2183	1715	\$10,718.75	(\$10,495.80)	+\$222.95)
Subaru of Wakefield Inc	5239	2300	\$14,375.00	(\$14,076.00)	+\$299.00)
Suburu of Milford Inc	4856	1800	\$11,250.00	(\$11,016.00)	+\$234.00)
Suffolk Services Inc	8029	1840	\$11,500.00	(\$11,260.80)	+\$239.20)
Sullivan Brothers Nissan Lincoln-Mercury Inc	3798	1725	\$10,781.25	(\$10,557.00)	+\$224.25)
Sullivan Tire	4870	1175	\$7,343.75	(\$7,191.00)	+\$152.75)
Sun Auto Rental	4874	1100	\$6,875.00	(\$6,732.00)	+\$143.00)
Suns Total Systems Inc	1294	1640	\$10,250.00	(\$10,036.80)	+\$213.20)
T & L Auto Service	4916	1350	\$8,437.50	(\$8,262.00)	+\$175.50)
Tatnuck Mobil	4927	1240	\$7,750.00	(\$7,588.80)	+\$161.20)
Teknor Apex Company	4948	1716.58	\$10,728.63	(\$10,505.47)	+\$223.16)
Tewksbury Center Service	6072	2000	\$12,500.00	(\$12,240.00)	+\$260.00)
Tewksbury Mobil	4956	1300	\$8,125.00	(\$7,956.00)	+\$169.00)
The Caldor Corporation	0882	1935	\$12,093.75	(\$11,842.20)	+\$251.55)
The Charles Stark Draper Laboratory Inc	1281	1595	\$9,968.75	(\$9,761.40)	+\$207.35)
The Dodge Company Incorporated	1213	3800	\$23,750.00	(\$23,256.00)	+\$494.00)
The Druker Company Ltd	1292	3850	\$24,062.50	(\$23,562.00)	+\$500.50)
The Hertz Corporation	2577	3450	\$21,562.50	(\$21,114.00)	+\$448.50)

Appendix C(2) New Rate

PRP Name	PRP ID	PRP Volume	Total Cash Out PAY THIS AMOUNT	Consists of the (EPA Cash-Out Amount)	following components (NH Cash-Out Amount)
The Stop & Shop Supermarket Company	4147	1350	\$8,437.50	(\$8,262.00) +	(\$175.50)
The Wakefield Corporation	5236	2050	\$12,812.50	(\$12,546.00) +	(\$266.50)
The William Carter Company	1802	1200	\$7,500.00	(\$7,344.00) +	(\$156.00)
Three-C Electrical Company Inc	4977	2940	\$18,375.00	(\$17,992.80) +	(\$382.20)
Tichon Lincoln Mercury Corp	3650	1175	\$7,343.75	(\$7,191.00) +	(\$152.75)
Tolman Automotive	4999	2592.5	\$16,203.13	(\$15,866.10) +	(\$337.03)
Tom Porter's Auto Service Inc	4074	1025	\$6,406.25	(\$6,273.00) +	(\$133.25)
Tommy's Auto Service	4750	2125	\$13,281.25	(\$13,005.00) +	(\$276.25)
Tony Ruffo's Inc (DBA: Tony's Auto Repair)	5021	1200	\$7,500.00	(\$7,344.00) +	(\$156.00)
Tosti's Service Station Inc	5028	2247	\$14,043.75	(\$13,751.64) +	(\$292.11)
Tower Automotive	5032	1800	\$11,250.00	(\$11,016.00) +	(\$234.00)
Towers of Chestnut Hill	6075	4900	\$30,625.00	(\$29,988.00) +	(\$637.00)
Town of Billerica	GRP309	2650	\$16,562.50	(\$16,218.00) +	(\$344.50)
Town of Boxford	GRP311	1700	\$10,625.00	(\$10,404.00) +	(\$221.00)
Town of Brookline	GRP316	3400	\$21,250.00	(\$20,808.00) +	(\$442.00)
Town of Burlington	GRP317	1264	\$7,900.00	(\$7,735.68) +	(\$164.32)
Town of Carver	GRP320	1460	\$9,125.00	(\$8,935.20) +	(\$189.80)
Town of Chatham	GRP321	4535	\$28,343.75	(\$27,754.20) +	(\$589.55)
Town of Chester	GRP324	1275	\$7,968.75	(\$7,803.00) +	(\$165.75)
Town of Duxbury	GRP329	1535	\$9,593.75	(\$9,394.20) +	(\$199.55)
Town of Eastham	GRP332	3950	\$24,687.50	(\$24,174.00) +	(\$513.50)
Town of Epping	GRP334	1100	\$6,875.00	(\$6,732.00) +	(\$143.00)
Town of Hanover	GRP344	1050	\$6,562.50	(\$6,426.00) +	(\$136.50)
Town of Hanson	GRP345	1775	\$11,093.75	(\$10,863.00) +	(\$230.75)
Town of Harwich	GRP347	3895	\$24,343.75	(\$23,837.40) +	(\$506.35)
Town of Marshfield	GRP367	3712.56	\$23,203.50	(\$22,720.87) +	(\$482.63)
Town of Milford	GRP376	1441	\$9,006.25	(\$8,818.92) +	(\$187.33)

Appendix C(2) New Rate

PRP Name	PRP ID	PRP Volume	Total Cash Out PAY THIS AMOUNT	Consists of the EPA Cash-Out Amount	following components + (NH Cash-Out Amount)
Town of Natick	GRP380	3440	\$21,500.00	(\$21,052.80)	+\$447.20
Town of Norfolk	GRP386	2000	\$12,500.00	(\$12,240.00)	+\$260.00
Town of Norwood	GRP389	3750	\$23,437.50	(\$22,950.00)	+\$487.50
Town of Orleans	GRP392	3400	\$21,250.00	(\$20,808.00)	+\$442.00
Town of Plaistow	GRP398	4200	\$26,250.00	(\$25,704.00)	+\$546.00
Town of Plymouth	GRP399	3100	\$19,375.00	(\$18,972.00)	+\$403.00
Town of Provincetown	GRP403	3800	\$23,750.00	(\$23,256.00)	+\$494.00
Town of Reading	GRP406	1200	\$7,500.00	(\$7,344.00)	+\$156.00
Town of Wakefield	GRP421	1455	\$9,093.75	(\$8,904.60)	+\$189.15
Town of Wayland	GRP426	1299	\$8,118.75	(\$7,949.88)	+\$168.87
Town of Wellfleet	GRP428	1475	\$9,218.75	(\$9,027.00)	+\$191.75
Town of West Bridgewater	GRP430	1400	\$8,750.00	(\$8,568.00)	+\$182.00
Town of Westford	GRP431	1875	\$11,718.75	(\$11,475.00)	+\$243.75
Town of Winchester	GRP433	1550	\$9,687.50	(\$9,486.00)	+\$201.50
Town & Country Serv	5040	2300	\$14,375.00	(\$14,076.00)	+\$299.00
Townsend Sales & Service Inc	5050	1500	\$9,375.00	(\$9,180.00)	+\$195.00
Tresca Brothers Sand & Gravel Inc	5072	1650	\$10,312.50	(\$10,098.00)	+\$214.50
Tri-City Auto Sales	5073	2500	\$15,625.00	(\$15,300.00)	+\$325.00
Trombly Motor Coach Service Inc	5085	1300	\$8,125.00	(\$7,956.00)	+\$169.00
Tucker's Essex Street Mobil	1464	1750	\$10,937.50	(\$10,710.00)	+\$227.50
Two Twenty Two Berkeley Venture	5116	2150	\$13,437.50	(\$13,158.00)	+\$279.50
U-Haul Co of Boston	5125	1350	\$8,437.50	(\$8,262.00)	+\$175.50
U-Haul International	5124	1200	\$7,500.00	(\$7,344.00)	+\$156.00
U S Food Service	3541	1300	\$8,125.00	(\$7,956.00)	+\$169.00
Unifirst Corporation	5133	1450	\$9,062.50	(\$8,874.00)	+\$188.50
United Cape Cod Cranberry Co	5147	3260	\$20,375.00	(\$19,951.20)	+\$423.80
United Compressor & Pump Technology Inc	5145	3275	\$20,468.75	(\$20,043.00)	+\$425.75

Appendix C(2) New Rate

PRP Name	PRP ID	PRP Volume	Total Cash Out	PAY THIS AMOUNT	Consists of the	following components
					(EPA Cash-Out Amount)	(NH Cash-Out Amount)
United Machine and Tool Design Co	5149	2000	\$12,500.00		(\$12,240.00)	+\$260.00
US Army Corp of Engineers	GRP277	2900	\$18,125.00		(\$17,748.00)	+\$377.00
US Army Reserve	GRP172	1290	\$8,062.50		(\$7,894.80)	+\$167.70
Vachon Mazda-Mitsubishi	5177	4700	\$29,375.00		(\$28,764.00)	+\$611.00
Varney Bros Sand & Gravel Inc	5191	1800	\$11,250.00		(\$11,016.00)	+\$234.00
Verizon New England	3676	2726	\$17,037.50		(\$16,683.12)	+\$354.38
Vin's Auto Service Inc	5219	2450	\$15,312.50		(\$14,994.00)	+\$318.50
Volkswagen of America Inc	5223	2958	\$18,487.50		(\$18,102.96)	+\$384.54
Volvo Village	5228	3100	\$19,375.00		(\$18,972.00)	+\$403.00
W A Kraft Corp	2970	1650	\$10,312.50		(\$10,098.00)	+\$214.50
Wagner & Wagner Auto Sales Inc (DBA: Wagner Motor Sales)	5234	2990	\$18,687.50		(\$18,298.80)	+\$388.70
Wakefield Materials Corporation	3365	3550	\$22,187.50		(\$21,726.00)	+\$461.50
Walkup's Garage	5245	2300	\$14,375.00		(\$14,076.00)	+\$299.00
Walton's Auto Lab	5259	2750	\$17,187.50		(\$16,830.00)	+\$357.50
Water Street Auto Body Inc	5275	1500	\$9,375.00		(\$9,180.00)	+\$195.00
WEACO Realty Inc	0344	3600	\$22,500.00		(\$22,032.00)	+\$468.00
Webber Auto and Truck Parts Inc	5294	2300	\$14,375.00		(\$14,076.00)	+\$299.00
Weber Dodge Inc	5296	1100	\$6,875.00		(\$6,732.00)	+\$143.00
Wesson's Mobil	5333	1600	\$10,000.00		(\$9,792.00)	+\$208.00
Weymouth Motor Sales Inc	5364	1050	\$6,562.50		(\$6,426.00)	+\$136.50
WH Bagshaw Co Inc	0485	2200	\$13,750.00		(\$13,464.00)	+\$286.00
Whispering Pines Service Center Inc	5373	3275	\$20,468.75		(\$20,043.00)	+\$425.75
White Equipment Leasing Corporation	5377	3634	\$22,712.50		(\$22,240.08)	+\$472.42
Whitehead Motors	5380	1750	\$10,937.50		(\$10,710.00)	+\$227.50
Whitney's Service	5393	3300	\$20,625.00		(\$20,196.00)	+\$429.00
William A Miller (DBA: Shawshen Service)	4590	1850	\$11,562.50		(\$11,322.00)	+\$240.50
William Phillips Automotive	4003	2750	\$17,187.50		(\$16,830.00)	+\$357.50

Appendix C(2) New Rate

PRP Name	PRP ID	PRP Volume	Total Cash Out PAY THIS AMOUNT	Consists of the (EPA Cash-Out Amount)	following components + (NH Cash-Out Amount)
William T O'Rourke Jr (DBA: Wilmington Exxon)	5412	1300	\$8,125.00	(\$7,956.00)	+\$169.00
Woods Hole Oceanographic Institution	5447	2200	\$13,750.00	(\$13,464.00)	+\$286.00

Appendix C(3) Non Participation Rate

PRP Name	PRP ID	PRP Volume	PAY THIS AMOUNT	Total Cash Out	Consists of the (EPA Cash-Out Amount + (NH Cash-Out Amount))	following components (NH Cash-Out Amount)
A P S Truck Service	0287	880	\$5,684.80		(\$5,570.40) + (\$114.40)	
Abdon Service Station Inc	0049	800	\$5,168.00		(\$5,064.00) + (\$104.00)	
Abe's Arco Service Station Inc	0052	400	\$2,584.00		(\$2,532.00) + (\$52.00)	
Ace Muffler Clinic Inc	0069	800	\$5,168.00		(\$5,064.00) + (\$104.00)	
Aiken St Automotive	2796	350	\$2,261.00		(\$2,215.50) + (\$45.50)	
Al's Motor Sales Inc	0171	450	\$2,907.00		(\$2,848.50) + (\$58.50)	
Al Hoyt & Sons Inc	2655	500	\$3,230.00		(\$3,165.00) + (\$65.00)	
Albert Magnone	0170	350	\$2,261.00		(\$2,215.50) + (\$45.50)	
Alfred L Del Colle	1096	600	\$3,876.00		(\$3,798.00) + (\$78.00)	
All-Rite Auto Inc	0149	600	\$3,876.00		(\$3,798.00) + (\$78.00)	
Allied Cold Storage Corp	1233	1000	\$6,460.00		(\$6,330.00) + (\$130.00)	
American Concrete	0190	500	\$3,230.00		(\$3,165.00) + (\$65.00)	
American Medical Response of Massachusetts Inc	3101	850	\$5,491.00		(\$5,380.50) + (\$110.50)	
American Truck & Trailer Co Inc	0211	1000	\$6,460.00		(\$6,330.00) + (\$130.00)	
Angela Veltsos	2593	400	\$2,584.00		(\$2,532.00) + (\$52.00)	
Antoine's Auto Repair Inc	2765	350	\$2,261.00		(\$2,215.50) + (\$45.50)	
Aquacultural Research Corporation	0121	400	\$2,584.00		(\$2,532.00) + (\$52.00)	
Arrington Service Inc	3779	900	\$5,814.00		(\$5,697.00) + (\$117.00)	
Arsenal Auto Service	1179	300	\$1,938.00		(\$1,899.00) + (\$39.00)	
Art's Front End & Brake Service	0323	300	\$1,938.00		(\$1,899.00) + (\$39.00)	
Ashland Motors Inc	0330	550	\$3,553.00		(\$3,481.50) + (\$71.50)	
Atlantic Broom Service Inc	0346	820	\$5,297.20		(\$5,190.60) + (\$106.60)	
Auto Hospital	0390	350	\$2,261.00		(\$2,215.50) + (\$45.50)	
Automotive Repairs Inc	3112	300	\$1,938.00		(\$1,899.00) + (\$39.00)	
Ayotte Plumbing Heating and Air Conditioning	0451	450	\$2,907.00		(\$2,848.50) + (\$58.50)	
A&S Auto Craft	0025	500	\$3,230.00		(\$3,165.00) + (\$65.00)	
A. F. Amorello & Sons, Inc.	0228	450	\$2,907.00		(\$2,848.50) + (\$58.50)	

Appendix C(3) Non Participation Rate

Total Cash Out

Consists of the following components

PRP Name	PRP ID	PRP Volume	PAY THIS AMOUNT	(EPA Cash-Out Amount) + (NH Cash-Out Amount)
B & D Shell Inc	0470	700	\$4,522.00	(\$4,431.00) + (\$91.00)
Bacon Street Auto Service Inc	0482	400	\$2,584.00	(\$2,532.00) + (\$52.00)
Barbas Trucking	0513	450	\$2,907.00	(\$2,848.50) + (\$58.50)
Beacon Hill Sunoco	0554	400	\$2,584.00	(\$2,532.00) + (\$52.00)
Beau's Auto Care	5946	500	\$3,230.00	(\$3,165.00) + (\$65.00)
Benoit Auto Sales Inc	0598	530	\$3,423.80	(\$3,354.90) + (\$68.90)
Big W Trans Inc	0638	605	\$3,908.30	(\$3,829.65) + (\$78.65)
Bill's Gasoline Service Inc	0647	700	\$4,522.00	(\$4,431.00) + (\$91.00)
Black Gold Exchange Inc	0659	800	\$5,168.00	(\$5,064.00) + (\$104.00)
Blais Service Station Inc	0663	650	\$4,199.00	(\$4,114.50) + (\$84.50)
BMC Corporation	0720	450	\$2,907.00	(\$2,848.50) + (\$58.50)
Bob's Auto Service	0696	950	\$6,137.00	(\$6,013.50) + (\$123.50)
Bonollo Rubbish Removal Inc	0740	365	\$2,357.90	(\$2,310.45) + (\$47.45)
Boro Sand & Stone Corp	0745	700	\$4,522.00	(\$4,431.00) + (\$91.00)
Boston Fuel Injection Inc	0756	343	\$2,215.78	(\$2,171.19) + (\$44.59)
Boston Harbor Marina Inc	0758	350	\$2,261.00	(\$2,215.50) + (\$45.50)
Bourne Bridge Auto Sales Inc	2674	750	\$4,845.00	(\$4,747.50) + (\$97.50)
Brian Egan and Gregory Egan	1400	950	\$6,137.00	(\$6,013.50) + (\$123.50)
Broadway Foreign Auto Repairs	0837	300	\$1,938.00	(\$1,899.00) + (\$39.00)
Broadway Mobil	3025	350	\$2,261.00	(\$2,215.50) + (\$45.50)
Broadway Service Station Inc	3981	900	\$5,814.00	(\$5,697.00) + (\$117.00)
Brook Leg Serv	0853	800	\$5,168.00	(\$5,064.00) + (\$104.00)
Brookline Towing Inc	2743	350	\$2,261.00	(\$2,215.50) + (\$45.50)
Bruce's Garage	0874	300	\$1,938.00	(\$1,899.00) + (\$39.00)
Bud Little's Auto	0277	420	\$2,713.20	(\$2,658.60) + (\$54.60)
Burke & Sons	0899	600	\$3,876.00	(\$3,798.00) + (\$78.00)
C & A Peides Inc	5361	300	\$1,938.00	(\$1,899.00) + (\$39.00)

Appendix C(3) Non Participation Rate

PRP Name	PRP ID	PRP Volume	Total Cash Out PAY THIS AMOUNT	Consists of the (EPA Cash-Out Amount)	following components (NH Cash-Out Amount)
C & J Equipment Inc	0953	500	\$3,230.00	(\$3,165.00)	+(65.00)
Casoli Sand & Gravel Inc	1814	400	\$2,584.00	(\$2,532.00)	+(52.00)
Cedarview Filling Station Inc	1829	583	\$3,766.18	(\$3,690.39)	+(75.79)
Century Trailer Sales Inc	1857	450	\$2,907.00	(\$2,848.50)	+(58.50)
Charlie's Auto Service	1877	850	\$5,491.00	(\$5,380.50)	+(110.50)
Charlie's Garage	1880	475	\$3,068.50	(\$3,006.75)	+(61.75)
Cherbinis Bus Line	1908	510	\$3,294.60	(\$3,228.30)	+(66.30)
Chicos Sunoco	1919	300	\$1,938.00	(\$1,899.00)	+(39.00)
Chubby's Auto Service Inc	2946	350	\$2,261.00	(\$2,215.50)	+(45.50)
Chuckran Auto Parts Inc	1928	880	\$5,684.80	(\$5,570.40)	+(114.40)
Chute Fuel	1931	750	\$4,845.00	(\$4,747.50)	+(97.50)
City of Beverly	GRP308	550	\$3,553.00	(\$3,481.50)	+(71.50)
City of Brockton	GRP313	660	\$4,263.60	(\$4,177.80)	+(85.80)
City of Lynn	GRP361	750	\$4,845.00	(\$4,747.50)	+(97.50)
City Side Auto	1946	800	\$5,168.00	(\$5,064.00)	+(104.00)
CJ 3A Service & Repair, Inc. d/b/a CJ Auto Repair	0971	825	\$5,329.50	(\$5,222.25)	+(107.25)
Cook Oil Compay Inc	2068	300	\$1,938.00	(\$1,899.00)	+(39.00)
Country Motors	2086	300	\$1,938.00	(\$1,899.00)	+(39.00)
Crest Haven Development Corp	2117	850	\$5,491.00	(\$5,380.50)	+(110.50)
Crest Inc	2115	470	\$3,036.20	(\$2,975.10)	+(61.10)
Custom Steel Fabrication Corp	2168	700	\$4,522.00	(\$4,431.00)	+(91.00)
C. H. Cushing, Inc.	2161	430	\$2,777.80	(\$2,721.90)	+(55.90)
D's Service Center	1296	800	\$5,168.00	(\$5,064.00)	+(104.00)
Dampolo Automotive Inc	4487	800	\$5,168.00	(\$5,064.00)	+(104.00)
Dan's Auto Service Inc	1015	600	\$3,876.00	(\$3,798.00)	+(78.00)
Dartmouth Street Shell	1037	1000	\$6,460.00	(\$6,330.00)	+(130.00)
Dave Gove Auto Repair Incorporated	2343	500	\$3,230.00	(\$3,165.00)	+(65.00)

Appendix C(3) Non Participation Rate

PRP Name	PRP ID	PRP Volume	PAY THIS AMOUNT	Total Cash Out	Consists of the following components
			(EPA Cash-Out Amount)		+(NH Cash-Out Amount)
David Anthony Manchester Sr	3252	643	\$4,153.78	(\$4,070.19)	+(83.59)
Diamond M Contractors	1159	420	\$2,713.20	(\$2,658.60)	+(54.60)
Dick Industrial Inc	1162	485	\$3,133.10	(\$3,070.05)	+(63.05)
Div of Terence Burgess Corp	2310	400	\$2,584.00	(\$2,532.00)	+(52.00)
Dooley's Garage	1250	900	\$5,814.00	(\$5,697.00)	+(117.00)
Duck Mill Auto Body & Sales Inc	1302	350	\$2,261.00	(\$2,215.50)	+(45.50)
Dwight Sharp Construction	4584	770	\$4,974.20	(\$4,874.10)	+(100.10)
D.N Inc	1196	870	\$5,620.20	(\$5,507.10)	+(113.10)
E & S Mobile Service Inc	1335	300	\$1,938.00	(\$1,899.00)	+(39.00)
Eastern Precast Concrete, Inc.	1965	400	\$2,584.00	(\$2,532.00)	+(52.00)
EMR Enterprises	2944	285	\$1,841.10	(\$1,804.05)	+(37.05)
Enzo's Nahant Garage	1451	950	\$6,137.00	(\$6,013.50)	+(123.50)
Erickson Auto Repair Service Inc	1453	350	\$2,261.00	(\$2,215.50)	+(45.50)
Evans Auto Service	1472	550	\$3,553.00	(\$3,481.50)	+(71.50)
F & F Custom Auto Inc	1504	417	\$2,693.82	(\$2,639.61)	+(54.21)
Fairhaven Auto Service	1171	700	\$4,522.00	(\$4,431.00)	+(91.00)
Fairhaven Getty	1516	500	\$3,230.00	(\$3,165.00)	+(65.00)
Fazio Specialty Auto Parts & Service	4525	500	\$3,230.00	(\$3,165.00)	+(65.00)
Fernandes & Sons Construction Co Inc	1559	600	\$3,876.00	(\$3,798.00)	+(78.00)
Ferrous Technology Inc	1564	500	\$3,230.00	(\$3,165.00)	+(65.00)
First Realty Trust	4210	546	\$3,527.16	(\$3,456.18)	+(70.98)
Forbes Service Station Inc	1620	850	\$5,491.00	(\$5,380.50)	+(110.50)
Frank's Enterprises Inc	1672	950	\$6,137.00	(\$6,013.50)	+(123.50)
Fred's Auto Repair	1686	850	\$5,491.00	(\$5,380.50)	+(110.50)
Fred W Smith Inc	4718	450	\$2,907.00	(\$2,848.50)	+(58.50)
Frenchies	1698	350	\$2,261.00	(\$2,215.50)	+(45.50)
Gallo Construction Company Inc	2202	500	\$3,230.00	(\$3,165.00)	+(65.00)

Appendix C(3) Non Participation Rate

Total Cash Out

Consists of the following components

PRP Name	PRP ID	PRP Volume	PAY THIS AMOUNT	(EPA Cash-Out Amount) + (NH Cash-Out Amount)
Gansett Atlantic Service Station Inc	2207	500	\$3,230.00	(\$3,165.00) + (\$65.00)
Georgetown Sand & Gravel Co Inc	2269	1000	\$6,460.00	(\$6,330.00) + (\$130.00)
Gerardi's Amoco	2271	500	\$3,230.00	(\$3,165.00) + (\$65.00)
Gino's Foreign Car Inc	2300	450	\$2,907.00	(\$2,848.50) + (\$58.50)
Globe Super Shell	2312	800	\$5,168.00	(\$5,064.00) + (\$104.00)
Gloucester Marina Inc	2314	750	\$4,845.00	(\$4,747.50) + (\$97.50)
Godin Bros Inc	2320	880	\$5,684.80	(\$5,570.40) + (\$114.40)
Granite Gulf Service, Inc.	2359	425	\$2,745.50	(\$2,690.25) + (\$55.25)
Gray's Garage	2379	700	\$4,522.00	(\$4,431.00) + (\$91.00)
Great Bay Motor Company Inc	4359	650	\$4,199.00	(\$4,114.50) + (\$84.50)
Greater Fall River Regional School District	GRP037	850	\$5,491.00	(\$5,380.50) + (\$110.50)
Hamze Brothers Auto Care Inc	2469	600	\$3,876.00	(\$3,798.00) + (\$78.00)
Hanover Shell and Tire Co Inc	2480	600	\$3,876.00	(\$3,798.00) + (\$78.00)
Harrington Paving	2507	600	\$3,876.00	(\$3,798.00) + (\$78.00)
Harry's Auto Repair	2511	500	\$3,230.00	(\$3,165.00) + (\$65.00)
Harvard Street Garage, Inc.	2517	400	\$2,584.00	(\$2,532.00) + (\$52.00)
Harvey's	2519	300	\$1,938.00	(\$1,899.00) + (\$39.00)
Hemphill Drilling & Blasting Company Inc	2547	450	\$2,907.00	(\$2,848.50) + (\$58.50)
Henley Ed & Sons Automotive, Inc.	6000	400	\$2,584.00	(\$2,532.00) + (\$52.00)
Henley Enterprises Inc	1621	850	\$5,491.00	(\$5,380.50) + (\$110.50)
High St Associates	2563	916	\$5,917.36	(\$5,798.28) + (\$119.08)
Honda Store	2634	1000	\$6,460.00	(\$6,330.00) + (\$130.00)
Hondar House Inc	2632	500	\$3,230.00	(\$3,165.00) + (\$65.00)
Hughes Motor Company	6007	550	\$3,553.00	(\$3,481.50) + (\$71.50)
Ideal Service, Inc.	1528	675	\$4,360.50	(\$4,272.75) + (\$87.75)
Jacques Kanaan	0336	350	\$2,261.00	(\$2,215.50) + (\$45.50)
James Redmond Excavating Co Inc	4247	300	\$1,938.00	(\$1,899.00) + (\$39.00)

Appendix C(3) Non Participation Rate

PRP Name	PRP ID	PRP Volume	PAY THIS AMOUNT	Total Cash Out	Consists of the (EPA Cash-Out Amount)	following components (NH Cash-Out Amount)
JDS Corporation	0040	875	\$5,652.50		(\$5,538.75)	+\$ (113.75)
Jerry's Auto Service Inc	2788	365	\$2,357.90		(\$2,310.45)	+\$ (47.45)
Joe's Auto Service	2825	350	\$2,261.00		(\$2,215.50)	+\$ (45.50)
John's Auto Sales & Service LC	0255	290	\$1,873.40		(\$1,835.70)	+\$ (37.70)
John's Exxon	2854	600	\$3,876.00		(\$3,798.00)	+\$ (78.00)
John Cyr	2180	700	\$4,522.00		(\$4,431.00)	+\$ (91.00)
John F. Boddy Equipment Rentals	0716	620	\$4,005.20		(\$3,924.60)	+\$ (80.60)
Joseph's Garage	2883	580	\$3,746.80		(\$3,671.40)	+\$ (75.40)
Joseph F. Sorenti, Jr. dba Little Red Tow Truck	0275	385	\$2,487.10		(\$2,437.05)	+\$ (50.05)
Karnil & Son, Inc.	2776	300	\$1,938.00		(\$1,899.00)	+\$ (39.00)
Kelley's Transmission Center	2839	800	\$5,168.00		(\$5,064.00)	+\$ (104.00)
Kelly's House of Harley-Davidson	2502	300	\$1,938.00		(\$1,899.00)	+\$ (39.00)
Ken Durling Automotive	1325	950	\$6,137.00		(\$6,013.50)	+\$ (123.50)
Kevin Crawford	2111	1000	\$6,460.00		(\$6,330.00)	+\$ (130.00)
Lasko Enterprises Inc	3938	600	\$3,876.00		(\$3,798.00)	+\$ (78.00)
Lawrence Lynch Corp	3041	350	\$2,261.00		(\$2,215.50)	+\$ (45.50)
LBJ Inc	3043	900	\$5,814.00		(\$5,697.00)	+\$ (117.00)
Louis Pasqualucci & Son Inc	3904	400	\$2,584.00		(\$2,532.00)	+\$ (52.00)
LV Mawn Corporation	2564	750	\$4,845.00		(\$4,747.50)	+\$ (97.50)
Lynn Screw Corp	3184	500	\$3,230.00		(\$3,165.00)	+\$ (65.00)
Lynn Sign Inc	3185	500	\$3,230.00		(\$3,165.00)	+\$ (65.00)
Lynnfield Centre Realty Trust	3186	470	\$3,036.20		(\$2,975.10)	+\$ (61.10)
M H R Auto Body Inc	4323	500	\$3,230.00		(\$3,165.00)	+\$ (65.00)
M K & Sons Express Inc	3516	700	\$4,522.00		(\$4,431.00)	+\$ (91.00)
Mabardy's Gulf Service	3191	870	\$5,620.20		(\$5,507.10)	+\$ (113.10)
Maffee's Garage Inc	3214	1000	\$6,460.00		(\$6,330.00)	+\$ (130.00)
Maheer Bros Auto Sales & Service Inc	2492	500	\$3,230.00		(\$3,165.00)	+\$ (65.00)

Appendix C(3) Non Participation Rate

PRP Name	PRP ID	PRP Volume	Total Cash Out PAY THIS AMOUNT	Consists of the (EPA Cash-Out Amount) +	following components (NH Cash-Out Amount)
Malden Catholic High School	3239	500	\$3,230.00	(\$3,165.00) +	(\$65.00)
Malden Motel	3241	1000	\$6,460.00	(\$6,330.00) +	(\$130.00)
Maloney Auto Parts Inc	3499	440	\$2,842.40	(\$2,785.20) +	(\$57.20)
Mar-Lee Mold Company Inc.	3270	660	\$4,263.60	(\$4,177.80) +	(\$85.80)
Mark A Hebb	4604	285	\$1,841.10	(\$1,804.05) +	(\$37.05)
Markings Inc	3292	800	\$5,168.00	(\$5,064.00) +	(\$104.00)
Marois Brothers Inc	3288	400	\$2,584.00	(\$2,532.00) +	(\$52.00)
Marshall E Merrill Jr	3398	330	\$2,131.80	(\$2,088.90) +	(\$42.90)
Marrell Motor Express Inc	3311	500	\$3,230.00	(\$3,165.00) +	(\$65.00)
Mel's Towing & Auto Service Inc	3378	400	\$2,584.00	(\$2,532.00) +	(\$52.00)
Merrimac Marine	2748	740	\$4,780.40	(\$4,684.20) +	(\$96.20)
Metro-West Dodge Inc	1212	450	\$2,907.00	(\$2,848.50) +	(\$58.50)
Michael's Automotive Sales Inc	3424	560	\$3,617.60	(\$3,544.80) +	(\$72.80)
Michaud & Sons Garage Inc	4769	750	\$4,845.00	(\$4,747.50) +	(\$97.50)
Midas Muffler	3448	425	\$2,745.50	(\$2,690.25) +	(\$55.25)
Moniz Auto Service	3542	810	\$5,232.60	(\$5,127.30) +	(\$105.30)
Montvale Garage Inc	3546	1000	\$6,460.00	(\$6,330.00) +	(\$130.00)
Murphy's Auto Repair	3603	530	\$3,423.80	(\$3,354.90) +	(\$68.90)
M. Wool Recycling, Inc.	5452	300	\$1,938.00	(\$1,899.00) +	(\$39.00)
N & R Repair	2721	590	\$3,811.40	(\$3,734.70) +	(\$76.70)
Narragansett Screw Company	0884	660	\$4,263.60	(\$4,177.80) +	(\$85.80)
Nauset Marine Inc	3633	650	\$4,199.00	(\$4,114.50) +	(\$84.50)
Ned's H/D Towing & Service	3640	650	\$4,199.00	(\$4,114.50) +	(\$84.50)
North Main Service Inc	3769	450	\$2,907.00	(\$2,848.50) +	(\$58.50)
North Shore Auto Clinic Inc	3777	1000	\$6,460.00	(\$6,330.00) +	(\$130.00)
Northeast Builders Transport Inc.	3750	300	\$1,938.00	(\$1,899.00) +	(\$39.00)
Norwest Inc	5502	750	\$4,845.00	(\$4,747.50) +	(\$97.50)

Appendix C(3) Non Participation Rate

PRP Name	PRP ID	PRP Volume	PAY THIS AMOUNT	Total Cash Out	Consists of the	following components
					(EPA Cash-Out Amount) +	(NH Cash-Out Amount)
Nuri Asmar	1197	300	\$1,938.00		(\$1,899.00) +	(\$39.00)
O'Connor Goodyear	3583	950	\$6,137.00		(\$6,013.50) +	(\$123.50)
Olympic House of Pizza	3818	400	\$2,584.00		(\$2,532.00) +	(\$52.00)
P Dietz Foreign & American Car Service Inc	1173	890	\$5,749.40		(\$5,633.70) +	(\$115.70)
P & P Auto Service Inc	3847	750	\$4,845.00		(\$4,747.50) +	(\$97.50)
Palmer Automotive	3859	370	\$2,390.20		(\$2,342.10) +	(\$48.10)
Parkway Texaco	3899	650	\$4,199.00		(\$4,114.50) +	(\$84.50)
Paul's Auto Service Inc	3919	450	\$2,907.00		(\$2,848.50) +	(\$58.50)
Paul's Repair, Inc.	2429	390	\$2,519.40		(\$2,468.70) +	(\$50.70)
Penta Auto Body Co Inc	3965	550	\$3,553.00		(\$3,481.50) +	(\$71.50)
Pep's Auto Repair	3969	520	\$3,359.20		(\$3,291.60) +	(\$67.60)
Perkit Folding Box Corp	3980	300	\$1,938.00		(\$1,899.00) +	(\$39.00)
Perros Incorporated	3984	550	\$3,553.00		(\$3,481.50) +	(\$71.50)
Peter's Battery Inc	3992	450	\$2,907.00		(\$2,848.50) +	(\$58.50)
Peter McGee	3340	400	\$2,584.00		(\$2,532.00) +	(\$52.00)
Pleasure Island Sunoco	4049	1000	\$6,460.00		(\$6,330.00) +	(\$130.00)
Portside Marine Service Inc	4078	400	\$2,584.00		(\$2,532.00) +	(\$52.00)
Post Office Square Mobil Inc	4083	400	\$2,584.00		(\$2,532.00) +	(\$52.00)
Professional Auto Sales, Inc.	4119	390	\$2,519.40		(\$2,468.70) +	(\$50.70)
Progressive Equipment Company Inc	4123	400	\$2,584.00		(\$2,532.00) +	(\$52.00)
Protech Service Center	4113	300	\$1,938.00		(\$1,899.00) +	(\$39.00)
Provincetown Mechanics Inc.	4133	350	\$2,261.00		(\$2,215.50) +	(\$45.50)
R D Automotive Inc	4169	650	\$4,199.00		(\$4,114.50) +	(\$84.50)
R J Cincotta Co Inc	1937	700	\$4,522.00		(\$4,431.00) +	(\$91.00)
R & F Transportation Co Inc	4171	495	\$3,197.70		(\$3,133.35) +	(\$64.35)
Ralph's Service Station	4403	500	\$3,230.00		(\$3,165.00) +	(\$65.00)
Ray's Auto	4223	730	\$4,715.80		(\$4,620.90) +	(\$94.90)

Appendix C(3) Non Participation Rate

PRP Name	PRP ID	PRP Volume	PAY THIS AMOUNT	Consists of the (EPA Cash-Out Amount) +	following components (NH Cash-Out Amount)
Raymer's Express Inc	4217	750	\$4,845.00	(\$4,747.50) +	(\$97.50)
Reimel's Automotive Specialist	4259	945	\$6,104.70	(\$5,981.85) +	(\$122.85)
Rep/Weld Corporation	4266	400	\$2,584.00	(\$2,532.00) +	(\$52.00)
Reynold's Auto Repair	4274	950	\$6,137.00	(\$6,013.50) +	(\$123.50)
RFB Corp	0710	750	\$4,845.00	(\$4,747.50) +	(\$97.50)
Robert B Reader	2888	400	\$2,584.00	(\$2,532.00) +	(\$52.00)
Robert O Wheatley	2744	400	\$2,584.00	(\$2,532.00) +	(\$52.00)
Rod's Automotive	4363	700	\$4,522.00	(\$4,431.00) +	(\$91.00)
Ronald A Vitale	4379	550	\$3,553.00	(\$3,481.50) +	(\$71.50)
Ronald G Normandin	0437	500	\$3,230.00	(\$3,165.00) +	(\$65.00)
Ross Niciewsky	3996	950	\$6,137.00	(\$6,013.50) +	(\$123.50)
Route 114 Mobil Inc	1097	400	\$2,584.00	(\$2,532.00) +	(\$52.00)
Route 133 Getty Inc	1354	700	\$4,522.00	(\$4,431.00) +	(\$91.00)
Russell Hanscomb	2482	500	\$3,230.00	(\$3,165.00) +	(\$65.00)
Salem Street Auto Clinic, Inc.	4471	900	\$5,814.00	(\$5,697.00) +	(\$117.00)
Salsbury Auto Exchange	4474	650	\$4,199.00	(\$4,114.50) +	(\$84.50)
Sandy Bay Service Center Inc	4509	300	\$1,938.00	(\$1,899.00) +	(\$39.00)
Saxonville Realty Trust	4523	400	\$2,584.00	(\$2,532.00) +	(\$52.00)
Seabrook Tire & Auto Inc	4546	550	\$3,553.00	(\$3,481.50) +	(\$71.50)
Serg's Auto Service Inc	4568	800	\$5,168.00	(\$5,064.00) +	(\$104.00)
Shepherd's Auto Inc	4600	330	\$2,131.80	(\$2,088.90) +	(\$42.90)
Showcase Isuzu Inc	4606	400	\$2,584.00	(\$2,532.00) +	(\$52.00)
Silver Lake Dodge, Inc.	4615	600	\$3,876.00	(\$3,798.00) +	(\$78.00)
Sims Tire Co.	4826	465	\$3,003.90	(\$2,943.45) +	(\$60.45)
Skilings Auto Sales Inc	4629	700	\$4,522.00	(\$4,431.00) +	(\$91.00)
So Willow Sunoco	4664	400	\$2,584.00	(\$2,532.00) +	(\$52.00)
South End Service	4689	750	\$4,845.00	(\$4,747.50) +	(\$97.50)

Appendix C(3) Non Participation Rate

PRP Name	PRP ID	PRP Volume	PAY THIS AMOUNT	Consists of the (EPA Cash-Out Amount)	following components (NH Cash-Out Amount)
South Street Garage	4702	330	\$2,131.80	(\$2,088.90)	+\$ (42.90)
Souza's	4709	430	\$2,777.80	(\$2,721.90)	+\$ (55.90)
Spillane's Auto Service	4747	535	\$3,456.10	(\$3,386.55)	+\$ (69.55)
Sprague Awning	4757	300	\$1,938.00	(\$1,899.00)	+\$ (39.00)
Stephen E Shamban	4581	550	\$3,553.00	(\$3,481.50)	+\$ (71.50)
Steve's Service Center	4814	800	\$5,168.00	(\$5,064.00)	+\$ (104.00)
Steve Acierno and Son	0302	800	\$5,168.00	(\$5,064.00)	+\$ (104.00)
Streeter Plumbing & Heating Inc	4847	400	\$2,584.00	(\$2,532.00)	+\$ (52.00)
Stryk's Automotive Repair	4851	750	\$4,845.00	(\$4,747.50)	+\$ (97.50)
Sturbridge Auto Body	4853	1000	\$6,460.00	(\$6,330.00)	+\$ (130.00)
Suburban Auto Technicians	4857	820	\$5,297.20	(\$5,190.60)	+\$ (106.60)
The Car Care Center	1771	790	\$5,103.40	(\$5,000.70)	+\$ (102.70)
Thompson Oil Company, Inc.	4972	600	\$3,876.00	(\$3,798.00)	+\$ (78.00)
Thrifty Texaco	4979	750	\$4,845.00	(\$4,747.50)	+\$ (97.50)
Tony's Service	5020	450	\$2,907.00	(\$2,848.50)	+\$ (58.50)
Topsfield Fire Department	5859	400	\$2,584.00	(\$2,532.00)	+\$ (52.00)
Town of East Bridgewater	GRP330	350	\$2,261.00	(\$2,215.50)	+\$ (45.50)
Town of Mashpee	GRP368	350	\$2,261.00	(\$2,215.50)	+\$ (45.50)
Town of New Durham	GRP383	300	\$1,938.00	(\$1,899.00)	+\$ (39.00)
Town of Wareham	GRP423	440	\$2,842.40	(\$2,785.20)	+\$ (57.20)
Tri-Fon Enterprises Inc	3770	300	\$1,938.00	(\$1,899.00)	+\$ (39.00)
Triple B Auto Service Inc	5079	400	\$2,584.00	(\$2,532.00)	+\$ (52.00)
Tudor Cab Inc	5101	294	\$1,899.24	(\$1,861.02)	+\$ (38.22)
Universal Construction Inc	5160	300	\$1,938.00	(\$1,899.00)	+\$ (39.00)
Unlimited Auto Service Inc	5163	550	\$3,553.00	(\$3,481.50)	+\$ (71.50)
Valley Design Corp	5183	450	\$2,907.00	(\$2,848.50)	+\$ (58.50)
Valley Manufactured Products Co Inc	6077	880	\$5,684.80	(\$5,570.40)	+\$ (114.40)

Appendix C(3) Non Participation Rate

PRP Name	PRP ID	PRP Volume	PAY THIS AMOUNT	Total Cash Out	Consists of the (EPA Cash-Out Amount)	following components (NH Cash-Out Amount)
Valley Towing Inc	5186	700	\$4,522.00	\$4,522.00	(\$4,431.00)	+\$ (91.00)
Vinny's Auto Service Inc	5215	946	\$6,111.16	\$6,111.16	(\$5,988.18)	+\$ (122.98)
Wakefield Tune-Up Inc	5240	300	\$1,938.00	\$1,938.00	(\$1,899.00)	+\$ (39.00)
Walt Curran Automotive	2154	1000	\$6,460.00	\$6,460.00	(\$6,330.00)	+\$ (130.00)
Warrendale Shell Inc	5263	700	\$4,522.00	\$4,522.00	(\$4,431.00)	+\$ (91.00)
Wayne Alden Leighton	1438	930	\$6,007.80	\$6,007.80	(\$5,886.90)	+\$ (120.90)
Wayside Auto Services Inc	5290	500	\$3,230.00	\$3,230.00	(\$3,165.00)	+\$ (65.00)
Wayside Service Center	5291	350	\$2,261.00	\$2,261.00	(\$2,215.50)	+\$ (45.50)
Weaver's Auto	5293	450	\$2,907.00	\$2,907.00	(\$2,848.50)	+\$ (58.50)
Webster Dudley Lincoln Mercury Inc	5300	280	\$1,808.80	\$1,808.80	(\$1,772.40)	+\$ (36.40)
Welding & Excavating Co	5314	900	\$5,814.00	\$5,814.00	(\$5,697.00)	+\$ (117.00)
Wellesley Exxon	5315	550	\$3,553.00	\$3,553.00	(\$3,481.50)	+\$ (71.50)
Westcott Construction Corporation	5346	650	\$4,199.00	\$4,199.00	(\$4,114.50)	+\$ (84.50)
Westgate Sunoco	6082	1000	\$6,460.00	\$6,460.00	(\$6,330.00)	+\$ (130.00)
Weston Automotive Inc	5355	650	\$4,199.00	\$4,199.00	(\$4,114.50)	+\$ (84.50)
Weymouth Service Center, Inc.	5365	700	\$4,522.00	\$4,522.00	(\$4,431.00)	+\$ (91.00)
White's Garage Inc	5386	900	\$5,814.00	\$5,814.00	(\$5,697.00)	+\$ (117.00)
Whitman Economic Development & Industrial Corporation	GRP169	700	\$4,522.00	\$4,522.00	(\$4,431.00)	+\$ (91.00)
Wilkins Service Station	5402	650	\$4,199.00	\$4,199.00	(\$4,114.50)	+\$ (84.50)
Wolfs Express Co Inc	5434	500	\$3,230.00	\$3,230.00	(\$3,165.00)	+\$ (65.00)

**ADMINISTRATIVE ORDER ON CONSENT
SECTION 122(g)(4) DE MINIMIS CONTRIBUTORS**

APPENDIX D

**DECLARATION OF TRUST
Beede Second De Minimis Settlement**

Appendix D - Beede Waste Oil Superfund Site
Second De Minimis Settlement Trust

DECLARATION OF TRUST
BEEDA WASTE OIL SECOND DE MINIMIS SETTLEMENT TRUST

On this 13th day of July, 2002, State Street Bank and Trust Company, a Massachusetts bank and trust company ("Trustee") hereby declares as follows:

WHEREAS, the Beede Waste Oil Superfund Site (the "Site") is a former waste oil facility located in Plaistow, New Hampshire, which is a federal Superfund Site;

WHEREAS, there have been releases and threats of releases of hazardous substances at the Site, and, as a result, EPA designated the Site as a Superfund Site ("Site") by placing it, pursuant to Section 105 of CERCLA, 42 U.S.C. § 9605, on the National Priorities List, set forth at 40 C.F.R. Part 300;

WHEREAS, the U.S. Environmental Protection Agency ("EPA") and the State of New Hampshire (the "State") have incurred response actions in connection with the Site, and contends that certain potentially responsible parties are liable for such response cost pursuant to Section 107(a) of CERCLA, 42 U.S.C. § 9607(a) and New Hampshire Revised Statutes Annotated 147-B:10;

WHEREAS, the United States, and approximately 1000 parties at the Site now seek to enter into a settlement pursuant to Section 122(g) of CERCLA, 42 U.S.C. § 9622(g), ("Administrative Order on Consent" or "Consent Order"), which will resolve these parties' alleged responsibility for past response costs at the Site;

WHEREAS, the proposed Consent Order requires the Respondents to send their settlement payments to a trust fund, and redistribution of the Respondents' payments to the EPA and the State of New Hampshire.

NOW, THEREFORE, the Trustee declares as follows:

1. Establishment of Trust. The Trustee promptly shall establish a segregated trust account in its corporate trust department which shall be known as the "Beede Waste Oil Second De Minimis Settlement Trust" ("Trust").

2. Declaration of Purpose. The Trust is established and shall be administered by the Trustee for the purpose of holding, investing and disbursing funds collected from the Respondents entering into the settlement agreement between the EPA, the State of New Hampshire and the Respondents regarding the Site (the "Consent Order"). The EPA and the State are the beneficiaries of the Trust.

**Appendix D - Beede Waste Oil Superfund Site
Second De Minimis Settlement Trust**

3. Payments

a. The Trustee shall have no authority or responsibility hereunder to collect any contributions to the Trust from any party and shall have no responsibility hereunder or otherwise with respect to the Respondents' compliance with the terms of the Consent Order.

b. The Trustee shall promptly deposit into the Trust all payments received from Respondents. The Trustee shall maintain a record, in alphabetical order, of the name and address of each Respondent making a payment together with the amount and date of the payment.

4. Principal, Interest and Expenses of Trust

a. All monies deposited in the Trust or earned by the investment or reinvestment of such monies ("Trust Funds") shall remain in the Trust and may not be withdrawn by any person, except to make the refunds required by Paragraph 6, payments required by Paragraph 7, or to pay taxes and expenses associated with tax return preparation and filings as provided in Paragraph 12.

b. The Trust Funds shall be used by the Trustee to pay taxes incurred by the Trust as well as any tax return preparation expenses, and tax filing fees. The remaining Trust Funds will remain in the Trust and may not be withdrawn by any person, except to make the refunds provided under Paragraph 6 or the payments provided under Paragraph 7.

c. The Trustee may deduct from the Trust Fund such fees as described in the Fee Schedule attached as Appendix A hereto.

5. Investment of Trust Funds. The Trustee shall deposit and hold all Trust Funds in an account and shall invest such funds in State Street's Insured Money Market Account. All earnings received from the investment of the Trust Funds shall be credited to, and shall become a part of, the Trust, (and any losses on such investments shall be debited to the Trust). The Trustee shall have no liability for any investment losses, including without limitation any market loss on any investment liquidated prior to maturity in order to make a payment required hereunder.

6. Refunds

a. **Refunds from the Trust.** Promptly upon receipt by the Trustee of a certificate from the Director, Office of Site Remediation & Restoration ("OSRR"), U.S. Environmental Protection Agency - New England Office ("Director, OSRR") stating that the EPA decided not to enter into the Consent Order, the Trustee shall refund promptly all contributions previously made to the Trust by the Respondents. Any such refund shall include the original principal amount of the payment and any earnings from the investment of such amounts, less accrued taxes and a pro-rata share of any Trustee fees.

b. **Refunds to Individual Respondents.** If at any time prior to approval of the Consent Order, (i) new information shows that a Respondent sent hazardous waste to the Site for treatment or disposal in excess of 5000 gallons; or (ii) EPA determines based on new information that a Respondent's hazardous waste disproportionately contributed to the cumulative toxic or

**Appendix D - Beede Waste Oil Superfund Site
Second De Minimis Settlement Trust**

other hazardous effects of the waste at the Site, such Respondent shall be disqualified from participation in this Consent Order, and the Trustee shall, within thirty (30) days of receipt of written notification by EPA of such disqualification, refund such Respondent's trust payment and any earnings from the investment of such amounts, less accrued taxes and a pro-rata share of any Trustee fees.

7 Disbursements from the Trust.

a. Except as provided in Paragraphs 4.b, 4.c, 6, 12, or 14, the Trustee shall not make any disbursements from the Trust until it has received written notice from the EPA that the Consent Order has been approved and requesting disbursement of the Trust Funds.

b. Within 30 days of receipt of written notice of approval of the Consent Order, the Trustee shall disburse the Trust Funds, as instructed by EPA, less amounts to be refunded pursuant to Paragraph 6 or paid pursuant to Paragraphs 4.b, 4.c, 6, 12, or 14. More specifically, under agreement with the State, and consistent with Appendix C of the Administrative Order on Consent, EPA will instruct the Trustee to disburse a sum certain of the Trust Funds to the EPA and a sum certain of the Trust funds to the State of New Hampshire, in the manner specified below in paragraph 7.c and 7.d.

c. All payments to EPA under Paragraph 7.a and 7.b shall be made by check to the Beede Waste Oil Special Account of the EPA Hazardous Substances Superfund, shall be accompanied by a transmittal letter and shall be delivered to the payee as follows:

EPA Superfund
Superfund Accounting, Region I
P.O. Box 360197M
Pittsburgh, PA 15251

d. All payments to the State of New Hampshire, as directed by EPA, under Paragraph 7.a and 7.b shall be made by check to Treasurer, State of New Hampshire, shall be accompanied by a transmittal letter and shall be delivered to the payee as follows:

Jennifer J. Patterson
Senior Assistant Attorney General
Environmental Protection Bureau
New Hampshire Attorney General's Office
33 Capitol Street
Concord, New Hampshire 03301

The Trustee shall send a copy of each check and transmittal letter to the EPA as provided in Paragraph 8.

8. **Notices.** All notices, demands, and requests given or required to be given hereunder shall be deemed given if delivered by hand pursuant to signed receipt or mailed by

**Appendix D - Beede Waste Oil Superfund Site
Second De Minimis Settlement Trust**

registered or certified United States mail, postage prepaid, return receipt requested, and shall be addressed as follows:

As to EPA:

Superfund Legal Office
Attn: Beede Waste Oil Site Documents
U.S. EPA, Region I
One Congress Street, Suite 1100 (SES)
Boston, MA 02114-2023

Trustee:

by first class mail to:

State Street Bank and Trust Company
Global Investors Services Group
Corporate Trust
P.O. Box 778
Boston, Massachusetts 02102-0778
Attention: Beede Waste Oil Superfund Site Settlement
Trust

if by fax, addressed as above and sent to the following telecopy number:

617-662-1463

if by hand, certified or registered mail or overnight courier or delivery, to:

State Street Bank and Trust Company
Global Investors Services Group
Corporate Trust, 6th Floor
2 Avenue De Lafayette
Boston, Massachusetts 02111-1724
Attention: Beede Waste Oil Superfund Site Settlement
Trust

9. **Concerning the Trust.** The Trustee acts as a trustee only and not personally; and in respect of any contract, obligation or liability made or incurred by the Trustee in good faith, all persons shall look solely to the Trust and not to the Trustee personally. The Trustee shall not incur personal liability of any nature in connection with any act or omission, made in good faith, in the administration of this Trust, including in following instructions provided pursuant to the provisions of this Declaration with respect to the payment of monies hereunder. The Trust shall indemnify and hold harmless the Trustee from and against any personal liability by reason of any action or failure to act or conduct in his/her official capacity, made in good faith. The Trustee (i) shall not be responsible for the Consent Order, or for determining or compelling compliance therewith, and shall not otherwise be bound thereby; (ii) shall be obligated only for the performance of such duties as are expressly and specifically set forth in this Agreement on its part to be performed, and no implied duties or obligations of any kind shall be read into this

**Appendix D - Beede Waste Oil Superfund Site
Second De Minimis Settlement Trust**

Agreement against or on the part of the Trustee: (iii) may consult counsel satisfactory to it, including in-house counsel, and the opinion or advice of such counsel in any instance shall be full and complete authorization and protection in respect of any action taken, suffered or omitted by it hereunder in good faith and in accordance with the opinion or advice of such counsel. In no event shall the Trustee be liable for indirect, punitive, special or consequential damage or loss (including but not limited to lost profits) whatsoever, even if the Trustee has been informed of the likelihood of such loss or damage and regardless of the form of action.

10. Disputes. In the event a dispute of any kind arises in connection with this Agreement (including any dispute concerning indemnification of the Trustee), the Trustee may, in his/her sole discretion, elect to commence an interpleader action and pay all or any portion of the Trust Funds to the United States District Court for the District of New Hampshire and to provide a complete accounting of all monies paid into the Trust or paid out of the Trust by the Trustee. In the event of such payment, it is understood that Trustee will have no further obligation to the Respondents, and/or the EPA with respect to the amount so paid.

11. Inalienability of Interests of Beneficiaries. The interest of each beneficiary in the income or principal of the Trust hereunder shall be free from the control or interference of any creditor and shall not be subject to assignment, attachment, anticipation or alienation.

12. Interest, Expenses and Taxes of the Trust. The interest or other income earned on the principal in the Trust will be used to pay the expenses of the Trust, including, without limitation, the initial acceptance fee, administration fees, causing tax returns to be prepared, legal expenses directly related to, and reasonably necessary for, the management of the Trust, transaction fees, taxes, if any, incurred by the Trust, tax filing fees, and other miscellaneous expenses of the Trust. The remaining interest or income earned on the principal in the Trust will remain in such Trust to be used for funding of future response actions at the Site.

13. Accounting. By December 30, 2002, the Trustee shall prepare an annual statement setting forth each payment received by the Trustee, the identity of the Respondent making such payment, the date such payment was received, the total amount of Trust Funds in the Trust, the amount of any interest and/or income earned on the Trust Funds, and the amount of any taxes paid by the Trustee. The Trustee shall send monthly statements to the EPA until the Trust is terminated. Said statements shall be sent to the EPA as provided in Paragraph 8.

14. Tax Treatment and Tax Return Preparation. It is intended that this Trust be a Qualified Settlement Fund under Internal Revenue Code Section 468B and Reg. 1.468(B) and taxable as a so-called complex trust to which Internal Revenue Code Sections 661, 662 and 663 apply and not as a partnership, corporation or grantor trust, that is, a trust whose property is deemed to be owned by one or more grantors or other persons pursuant to one or more of the Internal Revenue Code Sections 671 through 678. The Trustee (or a tax administrator engaged by the Trustee at the expense of the Trust) shall file tax returns for the Trust on the assumption that it is a complex trust, unless and until it is determined or the Trustee otherwise has reason to believe the Trust is other than a complex trust. In the event this Trust is determined, or is in the sole judgment of the Trustee at risk of being determined, to be other than a trust which is taxable

**Appendix D - Beede Waste Oil Superfund Site
Second De Minimis Settlement Trust**

as such a complex trust and it is prudent to reorganize the Trust so that it shall be such a complex trust, then the Trustee is authorized to execute such amendment to this Trust Agreement, restatements of this Trust Agreement, new trust agreement, instruments of assignment, plans of reorganization and other documents as are appropriate to enable the Trust or a successor to the assets of the Trust to be a trust which is taxable as such a complex trust; provided always, in no event shall the effect of any such reorganization be to change the purposes hereof, divert the assets of this Trust otherwise than for its original purposes set forth herein or enlarge the powers or responsibilities of the Trustee.

15. Trustee Compensation. The Trustee shall receive compensation for its services as a Trustee under this Trust Agreement pursuant to the Fee Schedule attached hereto as Appendix A. The Fee Schedule shall be binding upon the Trustee, and any change to the Fee Schedule shall become effective only upon the written approval of the EPA.

16. Appointment of Successor Trustee.

a. The Trustee may resign at any time by delivering his/her resignation, in writing, to the EPA, such resignation to take effect upon the appointment of a successor Trustee.

b. The EPA may remove the Trustee at any time, by delivering notice of such removal in writing to the Trustee, such removal to take effect ten days thereafter, or on such later date that may be specified in the notice.

c. Any vacancy in the office of the Trustee created by bankruptcy, insolvency, death, disability, resignation, removal or succession, as provided herein, shall be filled by an appointment in writing of a successor Trustee.

d. Any successor Trustee shall be appointed by the Director, OSRR.

e. Acceptance of appointment as a successor Trustee shall be in writing and shall be mailed to the EPA as provided in Paragraph 8.

f. A successor trustee shall have all of the rights, powers, duties, authority and privileges as if initially named as a Trustee hereunder.

g. A copy of each instrument of resignation, removal, appointment and acceptance of appointment shall be attached to an executed counterpart of this Trust Agreement in the custody of the Trustee and a copy shall be furnished to the EPA.

17. Choice of Law. This Trust Agreement shall be administered, construed, and enforced according to the laws of the State of New Hampshire except to the extent that federal law shall apply to questions arising under CERCLA or the National Contingency Plan, including any amendment thereto.

18. Consent to Jurisdiction and Services. The Trustee absolutely and irrevocably consents and submits to the jurisdiction of the courts of the State of New Hampshire and of any Federal court located in said State in connection with any actions, proceedings or disputes arising out of or relating to this Agreement. In any such action, proceeding or dispute, the Trustee

**Appendix D - Beede Waste Oil Superfund Site
Second De Minimis Settlement Trust**

hereby absolutely and irrevocably waives personal service of any summons, complaint, declaration or other process provided that the service thereof is made by certified or registered mail directed to the Trustee at his/her address in accordance with Paragraph 8.

19. Termination. This Agreement will terminate upon the disbursement of all of the Trust Funds in accordance with the provisions of Paragraph 7.

20. Modifications. This Agreement may not be altered or modified without the express written consent of the Director, OSRR.

21. Reproduction of Documents. This Agreement and all documents relating hereto, including, without limitation, (a) consents, waivers and modifications which may hereafter be executed, and (b) certificates and other information previously or hereafter furnished, may be reproduced by any means. Any such reproduction shall be admissible in evidence as the original itself in any judicial or administrative proceeding, whether or not the original is in existence and whether or not such reproduction was made by the Trustee in the regular course of business, and any enlargement, facsimile or further reproduction of such reproduction shall likewise be admissible in evidence.

22. Counterparts. This Agreement may be executed in separate counterparts, each of which shall be deemed an original, but all of which together shall constitute one and the same instrument.

**Appendix D - Beede Waste Oil Superfund Site
Second De Minimis Settlement Trust**

IN WITNESS WHEREOF, the Trustee hereunder has caused this Declaration to be executed as of the day and year first written above

11/12/11
Date

Trustee:

State Street Bank and Trust Company, a
Massachusetts bank and trust company, acting in its
capacity as Trustee as aforesaid and not its
individual corporate capacity

by [Signature]

title Vice President

hereunto duly authorized.

**Appendix D - Beede Waste Oil Superfund Site
Second De Minimis Settlement Trust**

APPENDIX A

FEE SCHEDULE

The Trustee shall be paid the fees set forth in this Appendix. Such fees shall be the only compensation paid to the Trustee for performing her/his responsibilities pursuant to this Agreement and shall include all expenses of the Trustee in managing the Trust, including, without limitation: fees of administration; fees for providing accountings of such monies in the Trust Fund as are requested by the Director, OSRR; transaction fees; fees for investment of the monies that are in the Trust; and such other miscellaneous expenses as are incurred by the Trustee in carrying out his/her responsibilities under this Agreement. In addition, the Trustee shall be reimbursed (i) for any legal expenses relating to and reasonably necessary for the management of the Trust; and (ii) for other out of pocket expenses.

Administration Fee	\$3,500.00
Plus:	\$35.00 per Respondent
Investment Fees	
SsgA or selected other Money	40 basis points per annum
Market Fund	of the average daily net assets
State Street's Insured Money	No charge
Money Account	
Wire Fees	\$25.00 per wire
Counsel Fees	Billed as Incurred (Estimate \$1,000.00)
Out of Pocket Expenses	Billed as Incurred

**ADMINISTRATIVE ORDER ON CONSENT
SECTION 122(g)(4) DE MINIMIS CONTRIBUTORS**

APPENDIX E

**PAYMENT INVOICE
Beede Second De Minimis Settlement**

Beede Waste Oil Superfund Site (011T)
EPA Docket Number CERCLA-01-2002-0025

Payment Invoice

Name of PRP: _____
Party Identification Number: _____

Amount of Payment: \$ _____

Check Number: _____

Name & Address of the party making payment: _____

Name of Respondent (as it appears on the Signature Page):

The **total** payment and this form shall be sent to:

Deborah Woods
Corporate Trust
State Street Bank & Trust
2 Avenue de Lafayette, 6th floor
Boston MA 02111-1724

A *copy* of the payment and a *copy* of this form shall be sent to:

U.S. Environmental Protection Agency - New England Region
Office of Site Remediation and Restoration
P.O. Box 8908
Boston, MA 02114
Attn: Beede Case Team

Your check must be made payable to the Beede Waste Oil Second De Minimis Settlement Trust.

Other Materials included in this Settlement Package



SIGNATURE INSTRUCTIONS FOR PARTIES ELECTING TO SETTLE AS A DE MINIMIS PARTY PURSUANT TO THE ADMINISTRATIVE ORDER ON CONSENT – BEEDE WASTE OIL SUPERFUND SITE

Eligible parties wishing to accept this settlement offer must sign the Signature Page included in this package and return it, along with proof of payment, as explained in the Settlement Instructions, no later than the deadline for payment specified in the Administrative Order on Consent (“AOC”) and Settlement Instructions. Please read the following instructions carefully. **Your Signature Page and payment will be returned to you if these instructions are not followed.**

NAME OF PARTY

You should make sure when you sign the AOC that you sign **only** for the entity whose name is pre-printed on the Signature Page enclosed with the AOC and that the name of the entity that you are signing for is clearly written or typed on the Signature Page. If the name that is pre-printed on the Signature Page is not your correct legal name, you should submit your Signature Page with the correct name included on it and include an explanation of why your signature differs from the entity pre-printed on the Signature Page.* If you have any questions regarding signature pages, you should call the Beede Enforcement Hotline at 617-737-1512 or 1-888-294-6980 as soon as possible so you can resolve any issues in a timely fashion. Finally, EPA will not accept signature pages in which a Respondent places conditions on the settlement.

PREDECESSOR OR SUCCESSOR COMPANIES

If a predecessor or successor party signs the AOC in addition to the entity whose name is pre-printed on the Signature Page, each such entity should be explicitly referenced on the Signature Page as being bound by the settlement.

SIGNATURE

Whoever signs the AOC must specify, for each entity bound by that signature, his or her business title with respect to each entity.

* You do not need to include an explanation if the correct legal name differs only slightly from the name listed on the signature page as the potentially liable party (“PRP”) (for example, Q Auto Service and Q Auto Service, Inc., or Q & B and Q & B Company).



SETTLEMENT INSTRUCTIONS

BEEDE WASTE OIL SUPERFUND SITE

INSTRUCTIONS FOR SECOND *DE MINIMIS* SETTLEMENT

If your company or organization chooses to settle, payment must be postmarked by August 2, 2002, at 5:00 p.m. EST. To join the settlement, please follow these steps:

Step 1. Remit payment of the total amount by cashier's check or certified check or money order in accordance with the payment instructions in Paragraph 15 of the Administrative Order by Consent (AOC). Your company or organization's payment amount is set forth in Appendix C to the AOC. Include the enclosed Check Payment Invoice with your payment. Checks should be made payable to the **Beede Waste Oil Second De Minimis Settlement Trust**.

Step 2. Send the check and completed Check Payment Invoice, and the original, signed Signature Page for the AOC to:

Deborah Woods
Corporate Trust
State Street Bank & Trust
2 Avenue de Lafayette
6th Floor
Boston, MA 02111-1724

Step 3. Submit a copy of your company or organization's completed Check Payment Invoice, and a copy of the signed Signature Page, to EPA at the following address:

U.S. EPA - New England Region
Office of Site Remediation & Restoration
P.O. Box 8908
Boston, MA 02114
Attention: Beede Case Team

Please remember to mail to the Trustee at the above address the following:

- Full total payment
- Original Signature Page and
- Completed Check Payment Invoice

****Please note that original documentation must be submitted to the Trustee. Please do not send documentation via facsimile.**

Please remember to mail to the EPA at the above address the following:

- Copy of payment
- Copy of Signature Page
- Copy of Check Payment Invoice

**PREMIUM EXPLANATION DOCUMENT
SECOND *DE MINIMIS* SETTLEMENT
BEEDE WASTE OIL SUPERFUND SITE**

After receiving a *de minimis* settlement offer from the U.S. Environmental Protection Agency ("EPA"), potential *de minimis* settlors often have several questions. This document answers commonly-asked questions about the *de minimis* premium and explains EPA's application of such a premium to this Second *De Minimis* settlement.

What is a Premium?

Typically, a *de minimis* settlement offer comprises both a "base payment" and a "premium." The premium is essentially a risk transfer mechanism, similar to an insurance premium. When a *de minimis* party obtains a final resolution of liability, it shifts its liability-related risks to the government and, in many cases, to other potentially responsible parties ("PRPs"). In exchange for a release from liability, EPA normally requires *de minimis* settlors to pay a premium in addition to their base payment amount. The premium is typically a percentage of the future cost component of the settlor's base payment, and is determined as a matter of EPA's enforcement discretion.

The type and magnitude of risks that are shifted by a *de minimis* settlement vary. However, in each case, the primary reason for increased risk to EPA and the remaining PRPs is the finality of the *de minimis* settlement. This finality results both from the breadth of EPA's agreement not to sue a *de minimis* party (known as a "covenant not to sue") and from the fact that, in *de minimis* settlements, EPA also agrees not to go after a *de minimis* party for additional work at the site (typically referred to as a "reopener").

In addition, the extent of the uncertainties at a site at the time of settlement contributes to the degree of risk shifted by the *de minimis* settlement. These uncertainties include, among others: (1) the cost and extent of future response actions, (2) the potential magnitude of the site's orphan share, and (3) accuracy of EPA's determination of each *de minimis* party's share.

By paying a premium as part of a settlement, the *de minimis* party compensates for the finality it obtains and for the risks others assume. Thus, the amount of the premium depends on the degree of finality afforded to the *de minimis* settlor and the extent of risk assumed by the Agency and the site's remaining PRPs.

What is EPA's policy on *de minimis* premiums?

EPA seeks to offer *de minimis* settlements to eligible PRPs as early in the site cleanup process as possible. Moreover, EPA makes every effort to craft *de minimis* settlement offers on terms that will be acceptable to all parties at the site, including non-*de minimis* parties. In light of the risks that are transferred to both EPA and to other PRPs by a *de minimis* settlement, EPA issued a policy in July, 1995 that set forth premium figures which are based on EPA's substantial experience in executing *de minimis* settlements (these are called "presumptive premiums") and are meant to place a value on future risk.

This policy states that if the settlement does not contain a remedy cost reopener (and thereby grants

the settlors maximum finality), the premium should usually be 100 percent. If the settlement does contain such a reopener, the premium should usually be 50 percent. These presumptive figures are based on the premiums assessed in more than 150 settlements that were developed under the Agency's enforcement discretion, subjected to public notice and comment, and approved by a court.

Although EPA's policy recommends the use of these figures, the premium determination remains a matter of EPA's enforcement discretion. The policy recommends an evaluation of the following circumstances, or adjustment factors, which may justify a Regional Office's deviation from these presumptive premiums:

- Remedy costs. Uncertainty regarding remedy cost may be due to the possibility of cost fluctuations, remedy contingencies, or the possibility of remedy "failure."
- Magnitude of the orphan share. Uncertainty regarding the number of insolvent or defunct parties at the site. In October 1995, EPA changed the Superfund program to provide compensation for insolvent or defunct parties in settlements with PRPs who agree to perform cleanup activities at a Superfund site. The share of cleanup costs attributable to insolvent or defunct parties is called the "orphan share." Relative uncertainty regarding the orphan share may be reflected in the premium if the orphan share has not simply been reallocated among all PRPs at the site.
- Waste allocation. Relative uncertainty in the waste allocation as a result of the quantity of waste contributed (e.g., where the contribution may be greater or less than estimated, but still within the *de minimis* cutoff); or the nature or toxicity of the waste contributed.

How was the premium for this settlement determined?

The premium used in this settlement is **50 percent**, which has been reduced from the 100 percent presumptive premium amount contained in EPA's national policy for settlements which do not contain a remedy reopener. This is the same premium which was applied to the Early *De Minimis* settlement EPA offered last June, 2001. EPA carefully evaluated the following site-specific adjustment factors in determining that a 50 percent premium remains appropriate for this Second *De Minimis* settlement.

Application of Adjustment Factors

1. Remedy Costs

Future remedial costs associated with selection of the final cleanup at the Beede Site provides the greatest uncertainty. In selecting the appropriate cleanup, or remediation, at the Site, EPA conducts a feasibility study to evaluate different remedial alternatives. EPA then recommends a preferred remedial alternative to the public for review and comment in a proposed plan.

EPA has worked closely with the New Hampshire Department of Environmental Services and its contractors on this State-lead remedial investigation and feasibility study (released in January, 2002), and has a high level of confidence in the content and accuracy of the remedial alternatives under consideration. A preferred remedial alternative has been identified from the various alternatives presented in the feasibility study and received initial approval from EPA's National Remedy Review Board on November 15, 2000. The alternative includes active source control and management of migration components. If successful, the preferred alternative should result in permanent remediation of the Site. Currently, the proposed plan for the Site, which will announce the preferred alternative, is undergoing final EPA and NH DES review, and will be presented to the public for review and comment before a final alternative is selected.

Reduction in the presumptive 100 percent premium is appropriate given the relatively high certainty in selection of the preferred alternative. A 50 percent premium should provide adequate protection with respect to final remedy selection and implementation, and has been applied to all future costs.

2. Magnitude of The Orphan Share

At the Beede Site, an orphan share analysis has not yet been performed. However, results of PRP search efforts to date indicate that numerous bankrupt, or otherwise insolvent or defunct owners, operators, transporters and, particularly, generators will meet the orphan share criteria. These parties, who would otherwise be named as PRPs, will be considered in an orphan share analysis in subsequent settlements. Although cash-out amounts associated with this Second *De Minimis* settlement have not been reduced through direct application of an orphan share, the volumetric contribution of waste by potential orphan share parties is included in EPA's calculation of total waste at the Site. This results in an indirect benefit to the Second *De Minimis* parties because the per gallon cash-out rate is lower since it is determined based on a larger volume contribution which includes orphan shares. Because some orphan share benefit has been indirectly realized, application of the full presumptive premium is not necessary. A reduced 50 percent premium should adequately address the uncertainty associated with the final amount of compensation from EPA as a result of the orphan share.

3. Waste Allocation

Unlike many previous Superfund sites, allocation of waste to PRPs associated with the Beede Site is based primarily on credible documents such as hazardous waste manifests and driver's logs. However, the Beede Waste Oil/Cash Energy Site operated for more than fifty years and recovered documentation exists only back to the 1970's. Through the remedial investigation, it is known that significant wastes were disposed of in a lagoon which was located near the center of the former operations area. The lagoon was filled in the late 1960's, but remains a significant source area today. The potential exists for pre-1970's or even more recent evidence to be brought forward for consideration. However, this potential is believed to be very limited due to EPA's extensive and detailed PRP search efforts over the past several years. Accordingly, application of a 50 percent premium should provide adequate protection against such uncertainty.

Conclusion

EPA has carefully evaluated the existing circumstances associated with this Second *De Minimis* settlement consistent with EPA's guidance, "Standardizing the *De minimis* Premium," July 7, 1995. This and other relevant EPA policy and guidance documents are available through the EPA Headquarters Website at "www.epa.gov/oeca/osre/osredoc.html." Uncertainties exist with regard to future remedial costs, the amount of compensation from EPA as a result of the orphan share, and waste allocation. The 50 percent premium should provide reasonable and sufficient insurance for uncertainties associated with this Second *De Minimis* settlement.

Instructions for Applying for Financial Review Beede Waste Oil Superfund Site - Second *De Minimis* Settlement

To process a claim of financial hardship, EPA requires you to substantiate that claim by submitting extensive and detailed financial documentation. If as a potentially responsible party ("PRP") you feel that you would face a severe financial hardship by remitting the full payment amount, you may request that EPA review your financial ability to pay by following the instructions outlined below. Please note that EPA will not be able to review and analyze such claims before the deadline for the Second *De Minimis* Settlement. Your ability to pay claim cannot be considered unless all requested information has been submitted to EPA, or a justifiable explanation as to why it cannot be provided is specifically stated. Your claim will be considered in a future settlement. If financial information was submitted in response to an EPA information request letter for the Beede Site, that information should be updated and/or supplemented.

BUSINESSES, please provide:

1. Copies of the most recent 5 years of tax returns as filed with the IRS complete with all schedules and attachments.
2. Copies of the most recent 5 years of audited financial statements complete with all notes and supplementary schedules. If no audit is performed, unaudited is acceptable.
3. Provide an all inclusive depreciation schedule detailing the assets of the company.
4. For any loans obtained in the past 3 years provide a copy of your loan application and any supporting documents.
5. Provide an organization chart detailing all related entities.
6. Provide a written position statement detailing your financial condition and ability to pay. Provide any documents which support your position or which you want us to consider.
7. If applicable, provide a copy of the partnership agreement and any amendments.
8. Name and telephone number of the person(s) most familiar with the submitted documents to answer questions.

INDIVIDUALS, please provide:

1. Copies of the most recent 5 years of tax returns as filed with the IRS complete with all schedules and attachments.
2. For any loans obtained in the past 3 years provide a copy of your loan application and any supporting documents.
3. A written position statement detailing your financial condition and ability to pay. Provide any documents which support your position or which you want us to consider.
4. Name and telephone number of the person(s) most familiar with the submitted documents to answer questions.
5. Complete the Financial Data Request Form which may be obtained by contacting the Beede Enforcement Hotline at 617-737-1512 or toll free at 1-888-294-6980 or visiting the Beede Web Site at www.epa.gov/region01/superfund/sites/beede

Please submit your request for financial review and all required supporting documentation ***no later than the deadline for Financial Reviews set forth in the Second De Minimis Settlement offer letter.*** Please include your party identification number on any documents submitted to the Agency. Requests for review should be sent to:

**United States Environmental Protection Agency
Office of Site Remediation and Restoration
P.O. Box 805
Boston, MA 02103
Attention: Beede Case Team/Financial Review Office**