

000021

Nutmeg
20
#18831



Preliminary Assessment

SITE NAME DOVER MFG. CORP. TOSUN RD (WRONG LOCATION)
TOWN WOLCOTT NUMBER 166-
CONNECTICUT

#18831

Preliminary Assessment
 Dover Mfg. Co.
 Tosun Rd., Wolcott, Ct.

February 24, 1986

The Dover Mfg. Co. was shown on the Preliminary Assessment list as being on Tosun Road, Wolcott. There was a fire on the site, and a new metal building erected in 1980, now occupied by "Phaneuf Co." In November 1985, I visited "Phanaeuf", see map #1,#2, and spoke to James Homewood, president of this company which is involved in Sales and Service of Bank and Office Systems. They sell paper shredders, filing supplies, shelving and graphic art supplies; and produce no industrial wastes. They have been on site for two years and rent from Marjorie Drubner, whose company, "Craftsman Litho", was on the site from 1980 until 1983.

Mr. Homewood said their water had been tested and approved by the Chesprocott Health District. In doing a perimeter inspection, I saw no evidence of waste materials or stained soils, see Photos #5, but did realize the map I had taken from the 1970 inspection which mentioned dumping of oils was of a different location, See map #3. After some map research and another visit to Wolcott, I found that location and discovered that there also had been a Dover Mfg. Co. at the map #3 location, 30 Town Line Rd. This site is assessed in a separate folder. The Tosun Rd. site, now occupied by "Phaneuf" seems to need no further investigation.

Reference Documents

Reference Documents

1. Road map
2. Sketch map
3. 1970 Water Compliance Inspection report
4. 1980 Water Compliance summary of data
5. 1986 photos

<u>Name</u>	<u>Address</u>	<u>Phone</u>
Wolcott Town Clerk		203-879-4666
"Phaneuf",	Box 6172, Tosun Rd., Wolcott	203-879-9151
Marjorie Drubner,	135 Crest Rd, Middlebury	203-758-1320
"Craftsman Litho",	300 Railroad Hill, Waterbury	203-575-1111
Chesprocott Health District,	91 No.Brooksdale Rd,Cheshire	203-272-2761

 POTENTIAL HAZARDOUS WASTE SITE PRELIMINARY ASSESSMENT PART 1 - SITE INFORMATION AND ASSESSMENT		I IDENTIFICATION	
		01 STATE	02 SITE NUMBER
		CT.	166-
II. SITE NAME AND LOCATION			
01 SITE NAME (Legal, common, or descriptive name of site)		02 STREET, ROUTE NO., OR SPECIFIC LOCATION IDENTIFIER	
THE DOVER MFG. CORP. O.O.B.		TOSUN RD.	
03 CITY	"PHANEUF", J. HOMEWOOD PRES. NOW ON SITE	04 STATE	05 ZIP CODE
WOLCOTT		CT.	
06 COUNTY		07 COUNTY CODE	08 CONG DIST
NEW HAVEN		009	05
09 COORDINATES		LONGITUDE	
LATITUDE		LONGITUDE	
41° 34' 31" -		- 72° 59' 50.3"	
10 DIRECTIONS TO SITE (Starting from nearest public road)			
ROUTE 84 EXIT 23, NORTH ON ROUTE 69 ≈ 3 MILES, RIGHT ON TOSUN RD.			
III. RESPONSIBLE PARTIES			
01 OWNER (if known)		02 STREET (Business mailing addresses)	
MARJORIE DRUBNER		135 CREST RD. Box 6172	
03 CITY	04 STATE	05 ZIP CODE	06 TELEPHONE NUMBER
MIDDLEBURY	CT.		(203)-879-9151
07 OPERATOR (if known and different from owner)		08 STREET (Business mailing addresses)	
09 CITY	10 STATE	11 ZIP CODE	12 TELEPHONE NUMBER
			()
13 TYPE OF OWNERSHIP (Check one)			
<input checked="" type="checkbox"/> A. PRIVATE <input type="checkbox"/> B. FEDERAL _____ (Agency name) <input type="checkbox"/> C. STATE <input type="checkbox"/> D. COUNTY <input type="checkbox"/> E. MUNICIPAL <input type="checkbox"/> F. OTHER _____ (Specify) <input type="checkbox"/> G. UNKNOWN			
14 OWNER/OPERATOR NOTIFICATION ON FILE (Check all that apply)			
<input type="checkbox"/> A. RCRA 3001 - DATE RECEIVED _____ MONTH DAY YEAR <input type="checkbox"/> B. UNCONTROLLED WASTE SITE (RCRA 103(c)) DATE RECEIVED _____ MONTH DAY YEAR <input checked="" type="checkbox"/> C. NONE			
IV. CHARACTERIZATION OF POTENTIAL HAZARD			
01 ON SITE INSPECTION		BY (Check all that apply)	
<input type="checkbox"/> YES DATE <u>11/22/85</u> MONTH DAY YEAR <input type="checkbox"/> NO		<input type="checkbox"/> A. EPA <input type="checkbox"/> B. EPA CONTRACTOR <input checked="" type="checkbox"/> C. STATE <input type="checkbox"/> D. OTHER CONTRACTOR <input type="checkbox"/> E. LOCAL HEALTH OFFICIAL <input type="checkbox"/> F. OTHER _____ (Specify)	
CONTRACTOR NAME(S): _____			
02 SITE STATUS (Check one)		03 YEARS OF OPERATION	
<input checked="" type="checkbox"/> A. ACTIVE <input type="checkbox"/> B. INACTIVE <input type="checkbox"/> C. UNKNOWN		<u>CLOSED</u> BEFORE <u>6/10/80</u> <u>1959</u> BEGINNING YEAR ENDING YEAR <input type="checkbox"/> B. UNKNOWN	
04 DESCRIPTION OF SUBSTANCES POSSIBLY PRESENT, KNOWN, OR ALLEGED			
WASTE OIL; CUTTING OILS, MINERAL SPIRITS			
05 DESCRIPTION OF POTENTIAL HAZARD TO ENVIRONMENT AND/OR POPULATION			
DISCHARGE OF UNKNOWN QUANTITY OF WASTE OIL BEHIND BUILDING ≈ 1959 - 1961 COULD CONTAMINATE GROUNDWATER SEE #4			
V. PRIORITY ASSESSMENT			
01 PRIORITY FOR INSPECTION (Check one. If high or medium is checked, complete Part 2 - Waste Information and Part 3 - Description of Hazardous Conditions and Incidents)			
<input type="checkbox"/> A. HIGH (Inspection required promptly) <input type="checkbox"/> B. MEDIUM (Inspection required) <input type="checkbox"/> C. LOW (Inspect on time available basis) <input type="checkbox"/> D. NONE (No further action needed, complete current disposition form)			
VI. INFORMATION AVAILABLE FROM			
01 CONTACT		02 OF (Agency/Organization)	
03 TELEPHONE NUMBER			
()			
04 PERSON RESPONSIBLE FOR ASSESSMENT		05 AGENCY	06 ORGANIZATION
ANN BURCROFF		D.I.E.P.	HAZ. WASTE UNIT
		07 TELEPHONE NUMBER	08 DATE
		6031566-8844	11/22/85 MONTH DAY YEAR



**POTENTIAL HAZARDOUS WASTE SITE
PRELIMINARY ASSESSMENT**
PART 3 - DESCRIPTION OF HAZARDOUS CONDITIONS AND INCIDENTS

I IDENTIFICATION

01 STATE	02 SITE NUMBER
CT	166-

I. HAZARDOUS CONDITIONS AND INCIDENTS

01 <input type="checkbox"/> A. GROUNDWATER CONTAMINATION 03 POPULATION POTENTIALLY AFFECTED _____	02 <input type="checkbox"/> OBSERVED (DATE _____) 04 NARRATIVE DESCRIPTION	<input type="checkbox"/> POTENTIAL	<input type="checkbox"/> ALLEGED
NA			
01 <input type="checkbox"/> B. SURFACE WATER CONTAMINATION 03 POPULATION POTENTIALLY AFFECTED _____	02 <input type="checkbox"/> OBSERVED (DATE _____) 04 NARRATIVE DESCRIPTION	<input type="checkbox"/> POTENTIAL	<input type="checkbox"/> ALLEGED
NA			
01 <input type="checkbox"/> C. CONTAMINATION OF AIR 03 POPULATION POTENTIALLY AFFECTED _____	02 <input type="checkbox"/> OBSERVED (DATE _____) 04 NARRATIVE DESCRIPTION	<input type="checkbox"/> POTENTIAL	<input type="checkbox"/> ALLEGED
NA			
01 <input type="checkbox"/> D. FIRE EXPLOSIVE CONDITIONS 03 POPULATION POTENTIALLY AFFECTED _____	02 <input type="checkbox"/> OBSERVED (DATE _____) 04 NARRATIVE DESCRIPTION	<input type="checkbox"/> POTENTIAL	<input type="checkbox"/> ALLEGED
NA			
01 <input type="checkbox"/> E. DIRECT CONTACT 03 POPULATION POTENTIALLY AFFECTED _____	02 <input type="checkbox"/> OBSERVED (DATE _____) 04 NARRATIVE DESCRIPTION	<input type="checkbox"/> POTENTIAL	<input type="checkbox"/> ALLEGED
NA			
01 <input type="checkbox"/> F. CONTAMINATION OF SOIL 03 AREA POTENTIALLY AFFECTED _____ <small>(Acres)</small>	02 <input type="checkbox"/> OBSERVED (DATE _____) 04 NARRATIVE DESCRIPTION	<input type="checkbox"/> POTENTIAL	<input type="checkbox"/> ALLEGED
NA			
01 <input type="checkbox"/> G. DRINKING WATER CONTAMINATION 03 POPULATION POTENTIALLY AFFECTED _____	02 <input type="checkbox"/> OBSERVED (DATE _____) 04 NARRATIVE DESCRIPTION	<input type="checkbox"/> POTENTIAL	<input type="checkbox"/> ALLEGED
NA			
01 <input type="checkbox"/> H. WORKER EXPOSURE/INJURY 03 WORKERS POTENTIALLY AFFECTED: _____	02 <input type="checkbox"/> OBSERVED (DATE _____) 04 NARRATIVE DESCRIPTION	<input type="checkbox"/> POTENTIAL	<input type="checkbox"/> ALLEGED
NA			
01 <input type="checkbox"/> I. POPULATION EXPOSURE/INJURY 03 POPULATION POTENTIALLY AFFECTED: _____	02 <input type="checkbox"/> OBSERVED (DATE _____) 04 NARRATIVE DESCRIPTION	<input type="checkbox"/> POTENTIAL	<input type="checkbox"/> ALLEGED
NA			



**POTENTIAL HAZARDOUS WASTE SITE
PRELIMINARY ASSESSMENT**
PART 3 - DESCRIPTION OF HAZARDOUS CONDITIONS AND INCIDENTS

I. IDENTIFICATION	
01 STATE CT	02 SITE NUMBER 166-

II. HAZARDOUS CONDITIONS AND INCIDENTS *(Continued)*

01 J. DAMAGE TO FLORA
04 NARRATIVE DESCRIPTION

02 OBSERVED (DATE: _____) POTENTIAL ALLEGED

NA

01 K. DAMAGE TO FAUNA
04 NARRATIVE DESCRIPTION *(include name(s) of species)*

02 OBSERVED (DATE: _____) POTENTIAL ALLEGED

NA

01 L. CONTAMINATION OF FOOD CHAIN
04 NARRATIVE DESCRIPTION

02 OBSERVED (DATE: _____) POTENTIAL ALLEGED

NA

01 M. UNSTABLE CONTAINMENT OF WASTES
(Spills run-off standing liquids leaking drums)
03 POPULATION POTENTIALLY AFFECTED: _____

02 OBSERVED (DATE: _____) POTENTIAL ALLEGED

04 NARRATIVE DESCRIPTION

NA

01 N. DAMAGE TO OFF-SITE PROPERTY
04 NARRATIVE DESCRIPTION

02 OBSERVED (DATE: _____) POTENTIAL ALLEGED

NA

01 O. CONTAMINATION OF SEWERS, STORM DRAINS, WWTPs
04 NARRATIVE DESCRIPTION

02 OBSERVED (DATE: _____) POTENTIAL ALLEGED

NA

01 P. ILLEGAL/UNAUTHORIZED DUMPING
04 NARRATIVE DESCRIPTION

02 OBSERVED (DATE: _____) POTENTIAL ALLEGED

NA

05 DESCRIPTION OF ANY OTHER KNOWN, POTENTIAL, OR ALLEGED HAZARDS

NA

III. TOTAL POPULATION POTENTIALLY AFFECTED: _____

IV. COMMENTS

--- NOT THE SITE MENTIONED IN FILE AS HAVING
DUMPING

V. SOURCES OF INFORMATION *(Cite specific references, e.g., state files, sample analysis reports)*

JAMES HOMEWOOD, PRES. "PHANAEUP," NOW ON SITE
WATER COMPLIANCE FILES, D.E.P.

203-879-9151
203-566-2518

DOVER MFG., TOSUN RD.
WOLCOTT, CT

LITCHFIELD

000027



Peterson Park

Wolcott

Wolcott H.S.

Welton Pond

Chestnut Hill Res

Lake Wequapauset

Evers Pond

Scovill Res

06716

Woodtick

Great Brook Res

69

Bald Hill

Woodtick Cem

06704

Della Bella Lake

Hitchcock

06702

06706

06705

Larsen Pond

69

64

25

Jack
est
06714

Tenants - ① Jovan Machine Co. - 3 emp. - some machinery operation
② John D. Lucas Co. - 4 emp. - wire forming & stamping

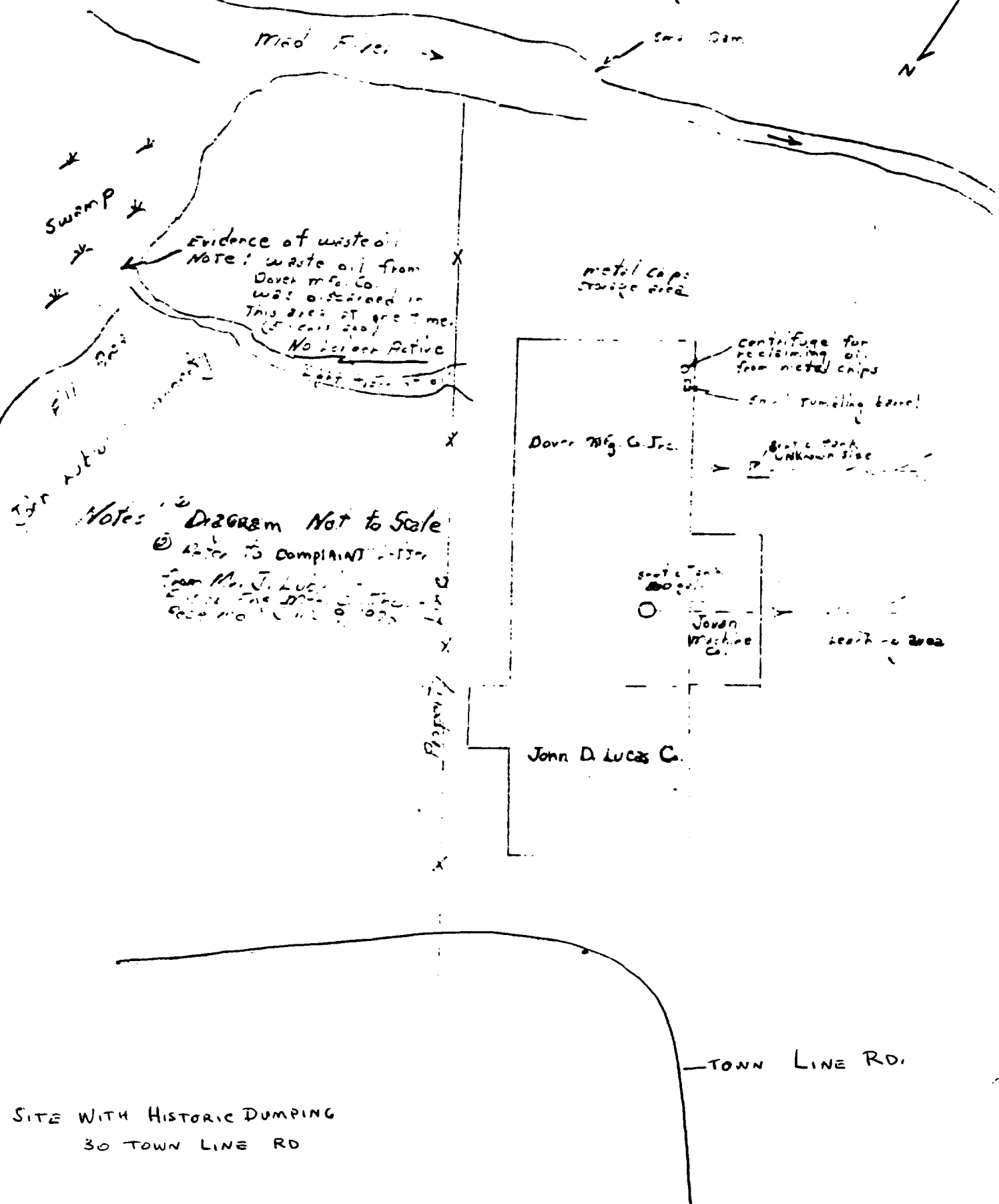

Evidence of waste oil
Note: waste oil from
Dover Mfg. Co.
was observed in
this area at one time.
(see call log)
No release Active

metal chips
storage area

centrifuge for
reclaiming oil
from metal chips

small tunneling barrel

septic tank
unknown size

Dover Mfg. Co. Inc.

septic tank
200 gal.

Jovan
Machine
Co.

search area

John D. Lucas Co.

TOWN LINE RD.

SITE WITH HISTORIC DUMPING
30 TOWN LINE RD

STATE OF CONNECTICUT
WATER RESOURCES COMMISSION

0000029

Form P-5

Name of company		Town <i>Walcott</i>		Location on Map <i>021</i>	
<i>Dover Mfg. Co., Inc.</i>		Village		Watershed <i>Naugatuck R.</i>	
Mailing Address		Rec. Stream		Contact <i>Mr. E. Mearing (President)</i>	
<i>PO Box 613 (Town Line Rd.)</i>		Contact <i>Mr. R. Mearing</i>		Type of Problem	
<i>Walcott</i>		Type of Problem		<input checked="" type="checkbox"/> Serious <input type="checkbox"/> Routine <input type="checkbox"/> Minor <input type="checkbox"/> None	
Date Established <i>1960</i>		No. of Emp.		<input type="checkbox"/> 1-10hr <input type="checkbox"/> 11-20hr <input type="checkbox"/> 21-30hr <input type="checkbox"/> 31-40hr <input type="checkbox"/> 41-50hr <input type="checkbox"/> 51-60hr <input type="checkbox"/> 61-70hr <input type="checkbox"/> 71-80hr <input type="checkbox"/> 81-90hr <input type="checkbox"/> 91-100hr	
Date of Last Ex. <i>—</i>		Report by <i>Robert W. Senack</i>		Date <i>6-17-70</i>	
Products <i>Screw Machine Products</i>					
Processes					
A <i>Turning</i>					
B <i>Milling</i>					
C <i>Screw Machines</i>					
D <i>Tumbling</i>					
Origin of Wastes					
Wastes Contain					
A <i>Metal chips & Cutting oils</i>					
B <i>" " " "</i>					
C <i>" " " "</i>					
D <i>Mineral spirits & abrasive stone</i>					
Comments Not Covered by Above Data					
<i>Metal chips are stored in 55 gal. drums and collected by scrap metal dealers</i>					
<i>① Scherer Bros. Waterbury ② S. Salmer Co. Waterbury</i>					
<i>There are two other tenants in the building (see reverse side)</i>					
Water Used For		San. Wastes		Industrial Wastes	
Discharged To		<i>Ground (T)</i>			
Water Usage		Gals-per-day		How Computed	
Sanitary Sewage		<i>180</i>		<i>12 emp. x 15 gpd. = 180 gpd.</i>	
Industrial Wastes					
Clean Discharge					
Boiler Water					
In Product					
Unaccounted					
Total Used		<i>180</i>		<i>Total of Knowns</i>	
SANITARY TREATMENT - <i>Septic Tank & Leaching Fields</i>					
INDUSTRIAL TREATMENT - <i>None</i>					
File Data Available:					
NOTES: <i>Water Supply - Private Well</i>					
<i>Property owner - Emma Cocchiola 207 South Mayd Rd., Waterbury</i>					

(over)