



**Tar Creek Superfund Site – Operable Unit 4
Ottawa County, Oklahoma
EPA Announces Truck Haul Routes for Work at
New Locations East of Quapaw
June 2013**



The U.S. Environmental Protection Agency (EPA) and its contractors are continuing the cleanup of mining wastes—commonly known as chat. Cleanup involves excavating chat and hauling it in large trucks to a repository on South 40 Road. Work will begin soon on three parcels of land located east of Quapaw. Two parcels, called “Distal 7 South”, are located on East 620 Road between South 620 Road and South 630 Road. The third parcel, called “Distal 7 North,” is located on South 630 Road between South 40 Road and South 50 Road. The map on the inside pages of this flyer show the location of these chat removal areas and the truck hauling routes.

Safety is our top priority. This is the latest in a series of flyers we are producing to enhance public safety by alerting the community in advance to the routes these large trucks will use. Beginning in late-June 2013, loaded trucks will use the following routes to deliver waste to the repository and return to the chat removal areas:

Distal 7 Haul Route

To Repository (located on East 40 Road):

- South on 630 or 620 Road to West on 50 Road
- West on 50 Road to Scale
- West on East 50 Road to Hwy 69A
- West on 69A/50 Road to North on 560 Road
- North on 560 Road to North on 565 Road
- North on 565 Road to East on 40 Road
- East on East 40 Road to Repository



Return Trip to Sites:

- Repository to East 40 Road
- East on East 40 Road to Hwy 69
- North on Hwy 69 to East 20 Road
- East on East 20 Road to 610 Road
- South on 610 Road to East 40 Road
- East on East 40 Road to 620 Road (or 630 Road for Distal 7 North)
- South on 620 Road (or 630 Road for Distal 7 North)

Please be aware of the potential to encounter large trucks on roadways and drive cautiously. Trucks may be traveling on Ottawa County roads Monday through Friday from 7 a.m. until 5:30 p.m. and possibly on some weekend days. All haul trucks working on our projects will have speed restrictions for dump trucks lower than posted speed limits, roadside warning signs, and lighted/flashing signs at critical intersections. ***Please comply with the warning signs, for your safety and the safety of others.***

If you witness unsafe driving by any project trucks on these routes, please call 918.674.1164 with the time, location, and the name of the company that is located on the door of the trucks. Your feedback is appreciated.

For more information about construction activities and traffic safety, contact the Tar Creek Project Office at 918.674.1164. Additional information about cleanup efforts at the Tar Creek Superfund Site can be found online at http://www.epa.gov/region6/6sf/oklahoma/tar_creek/index.htm

***We thank you, the school superintendent, the school bus drivers, and the community
for your continued support throughout the year as we work together to clean up
Tar Creek site wastes and improve the community.***

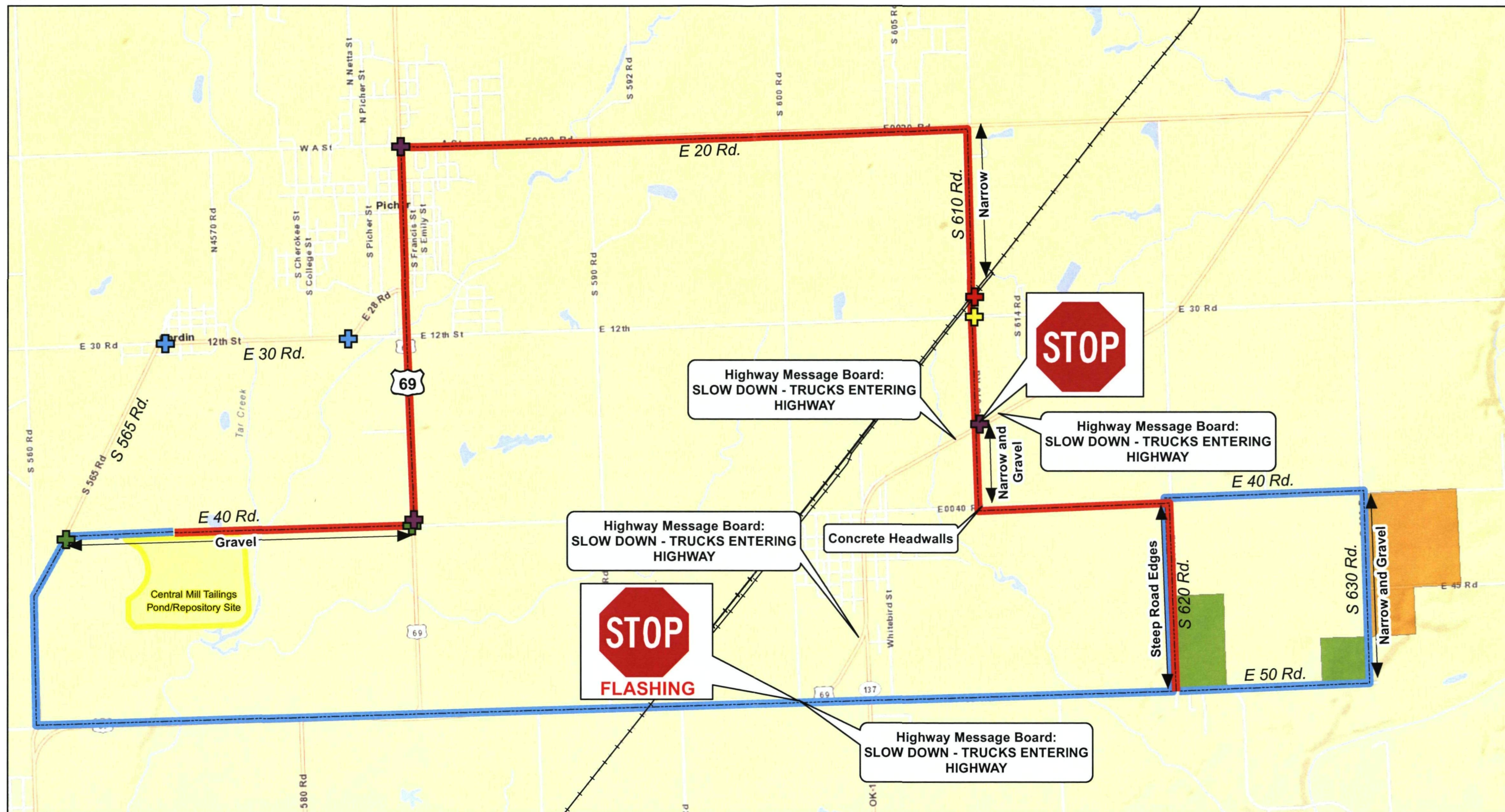

Legend

- Approved Haul Route from Distal 7 N&S Site to the Repository
- Approved Return route from the Repository to Distal 7 N&S
- Railroad
- Road
- Creek
- Distal 7 North
- Distal 7 South

- Haul Route Intersects RR
- Stop Sign Installed
- Trees Obstruct View
- Truck Crossing
- Trucks Entering



0 1,250 2,500 5,000 Feet



Haul Route for Current Removal Area (Distal 7 North & South)

Tar Creek Superfund Site
Operable Unit No. 4
Ottawa County, Oklahoma

CH2MHILL



**EPA Continues Commitment to Safety First
Announces Truck Haul Routes for Chat Removal from
new location at the Tar Creek Superfund Site**



 **EPA**
United States
Environmental Protection
Agency

Region 6
1445 Ross Ave. (6SF-VO)
Dallas, TX 75202