



February 13, 2024

988887

Matthew Ziegler  
AT&T  
4533 W. Roscoe St.  
Chicago, Illinois 60641

RE: Thorium Monitoring – AT&T 195 N. Harbor Dr.  
CDOT Permit: 1895559

Dear Mr. Ziegler:

Stan A. Huber Consultants, Inc (SAHCI) was hired by your firm to provide radiation monitoring during excavation for repair of an AT&T conduit at 195 N. Harbor Drive in Chicago, Illinois. The monitoring was performed by Glenn Huber, SAHCI Health Physicist, on February 10, 2024.

#### Instrumentation

Surface gamma scans were performed using a Ludlum Model 2221 Scaler / Ratemeter (serial no. 134542) with attached Ludlum Model 44-10 2"x2" NaI Detector (w/ 6" collimated lead shield). The instrument was calibrated on May 9, 2023. The US Environmental Protection Agency (USEPA) action level of 7.1 picocuries per gram (pCi/g) total thorium for this instrument is 6,552 counts per minute (cpm).

The average background count rate for this location was measured at 1,556 cpm.

#### Soil Gamma Scans

Gamma surface scans were performed using the Ludlum Model 2221 Scaler / Ratemeter described above. Survey data was collected by entering the excavation (Area 1) and recording the highest count rate on the floors and walls to a depth of 48 inches below ground surface. Material excavated below 36 inches to a maximum depth of 48 inches was surveyed as it was stockpiled at the surface. A second location (Area 2) had the surface concrete removed but no additional excavation took place. Surveys at this location took place at the surface and 6 inches below ground surface.

The maximum gamma count rate for each lift was recorded on the attached Radiation Survey Form. The count rates in the excavations ranged from 1,500 cpm to 2,400 cpm. No count rates were found at any time that exceeded the threshold limit of 6,552 cpm.

## Additional Monitoring

Since no count rates were identified above the 7.1 pCi/gram threshold limit, no additional soil sampling, air monitoring, or personnel monitoring were performed.

I will be providing a copy of this report to both the City of Chicago Department of Public Health and US Environmental Protection Agency, as required.

Thank you for your assistance with this project. If you have any questions or need additional information, please call me at (815) 485-6161.

Sincerely,  
Stan A. Huber Consultants, Inc.



Glenn Huber, CHP  
President



## Radiation Survey Form

**Location/ Project ID:** 195 N. Harbor Dr. AT&T CDOT #1895559

**Date:** 2/10/24

**Technician:** Glenn Huber

**Inst Model:** Ludlum 2221

**Serial No. :** 134542

**Probe Type:** 1"x1" NaI / 2"x2" NaI  
Shielded / Not Shielded

**Lift Elevation:** Surface to -48"

**Background** 1,556 cpm

**Action Level:** 6,552 cpm

Write grid designations in circles. Record highest counts for grid in cpm. Record 30 second counts at grid intersections (if required). Shade areas of elevated counts and record max cpm.

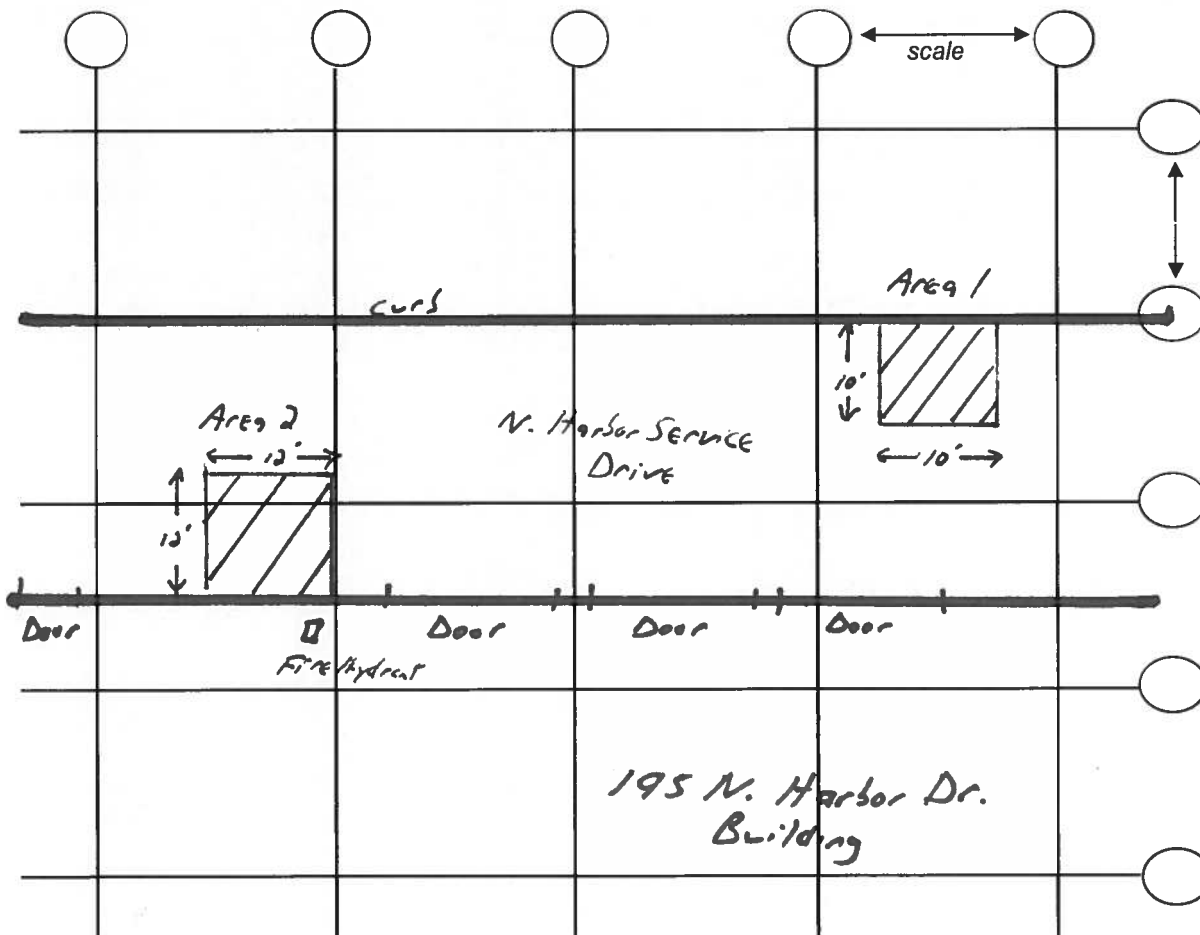

Area 1	
Depth	Cpm
Surface	1500
-1.5"	1800
-3"	2400
-4"	2300

Area 2	
Depth	Cpm
Surface	1800
-6"	2000