



AECOM  
303 E. Wacker Drive, Suite 1400  
Chicago, Illinois 60606

312-939-1000 tel  
312-939-4198 fax

978612

November 7, 2022

Mr. Kyle Carlson  
Peoples Gas Light & Coke Co.  
Environmental Services Department  
200 E. Randolph Street, 24<sup>th</sup> Floor  
Chicago, IL 60601

RE: Streeterville Thorium Monitoring Results – Service Renewal  
Permit No.: CDOT1739900  
Permit Addresses: 150 E Ontario St.

Dear Mr. Carlson:

Pursuant to conditions specified in the Right-of-Way (ROW) forms (attached) issued by the City of Chicago Department of Public Health (CDPH), radiation monitoring was required to be performed at the above referenced site. AECOM Technical Services, Inc. (AECOM) provided the required radiation surveillance on November 1, 2022, for an excavation to install a new gas service line at the above project address (refer to map included with CDPH form).

The monitoring did not indicate that the fill soils were above the removal action level established by the U.S. Environmental Protection Agency (USEPA) for the Streeterville area of Chicago. The USEPA removal action level for Chicago's Streeterville area is 7.1 picocuries per gram (pCi/g) total radium (Ra-226 + Ra-228). Gamma radiation count measurements for the project were recorded using a Ludlum Model 2221 survey meter and a shielded 2 x 2 inch NaI probe (Model 44-10). For the instruments used (Ludlum, NaI probe), the gamma count threshold indicative of the 7.1 pCi/g removal action level was approximately 6,726 (S/N: 176944) counts per minute (cpm) shielded.

The excavation was located approximately 75-feet east of N. Michigan Ave. and began just south of the north curb of E. Ontario St. extending approximately 30-feet north onto the sidewalk. The excavation was 24-inches wide to depth of 30 to 40-inches below ground surface (bgs). The excavation was divided into three 10-foot sections for gamma monitoring with the first section in the street. Field gamma measurements within this opening did not exceed the instrument threshold previously stated and ranged from 1,440 to a maximum reading of 3,003 cpm. The background gamma count of nearby soils was measured at 3,013 cpm shielded. Based on field observations, there was no indication of the presence of radiologically-contaminated fill and/or an exceedance of the USEPA removal action level of 7.1 pCi/g total radium.

A PDF copy of this letter will be forwarded via email to the CDPH and Verneta Simon (USEPA) to fulfill the requirements of the CDPH. Copies of the CDPH form, photographs, and the tabulated gamma results are included as attachments to this report.

Please contact us with any questions you have regarding this letter or the reported results.

Regards,



Eric Sulita, P.E.  
Environmental Engineer III



Steven C. Kornder, Ph.D.  
Senior Project Geochemist

cc: Ahmad Nur, Chicago Department of Public Health  
Verneta Simon, USEPA

Attachments: CDPH Permit Form and Map  
Tabulated Gamma Results and Photograph

## CDPH PERMIT FORMS



DEPARTMENT OF PUBLIC HEALTH  
CITY OF CHICAGO

FORM NO. CDPH.ROW.03 (STREETERVILLE Right-of-Way)

Notice is hereby given that the site you have requested a permit for is recorded with the City of Chicago Department of Public Health (CDPH) as potentially having environmental contamination on the site and adjacent right-of way. This environmental contamination could present a threat to human health and safety in connection with work performed at the site, or in the adjacent right-of-way, if proper safeguards are not employed.

A file containing detailed information regarding the aforementioned environmental contamination is available for review at CDPH at 333 S. State St., Room 200, Chicago, Illinois 60604 during normal business hours (8:30AM-4:30PM, Monday through Friday). Contact (312) 745-3152 for an appointment. This file must be reviewed and the remainder of this form completed before the permit can be issued if the ground is exposed or excavated. **Please note that for some locations, additional health and safety procedures may be required by law.**

Please complete the following:

I have reviewed and understand the documents, maintained by CDPH, regarding environmental contamination of the site and adjacent right-of-way. Further, I will ensure that all work at the subject site and adjacent right-of-way, and any monitoring required including but not limited to radiation monitoring, will be performed in a manner that is protective of human health and the environment and in compliance with all applicable local, state, and federal laws, rules, and regulations, especially those pertaining to worker safety and waste management. I will ensure that the results of any radiation monitoring and/or surveying conducted shall be provided to the CDPH and the United States Environmental Protection Agency **within two (2) weeks of their completion**. If any elevated levels of radioactive material are detected, I will immediately contact the United States Environmental Protection Agency at (800) 424-8802.

Applicant Name (print): Maria G. Oliver

Signature: Maria G Oliver

Site Address and Work Location (Describe exact site location and attach map):

150-159 E Ontario St

Nature of Work: Service Renewal

Company Name, Address, Phone No.: Peoples Gas, 200 E Randolph St, (312) 240-4692

General / Prime Contractor Name, Address, Phone No.: William Krueger, (773) 475-3734

*Include subcontractor information if applicable*

Safety Officer / Phone No. Joseph McHugh (312) 285-7315

Radiation Contractor / Phone No. (if applicable) Steve Kornder, AECOM, INC (262)515-7700

Check if City Department Work ☐ Department Name: \_\_\_\_\_

CDOT Permit No.: DOT1739900

Today's Date: 10/6/2022

Expected Start Date: 10/26/2022

CDPH Approval / Date ahmad nur 10/06/2022

Please return this completed form to the Chicago Department of Transportation, Division of Infrastructure Management, Public Way Permit Office, City Hall – Room 905, 121 N. LaSalle St., Chicago, Illinois 60602 during normal business hours (8:30 AM - 4:30 PM, Monday through Friday)

For CDPH Use Only

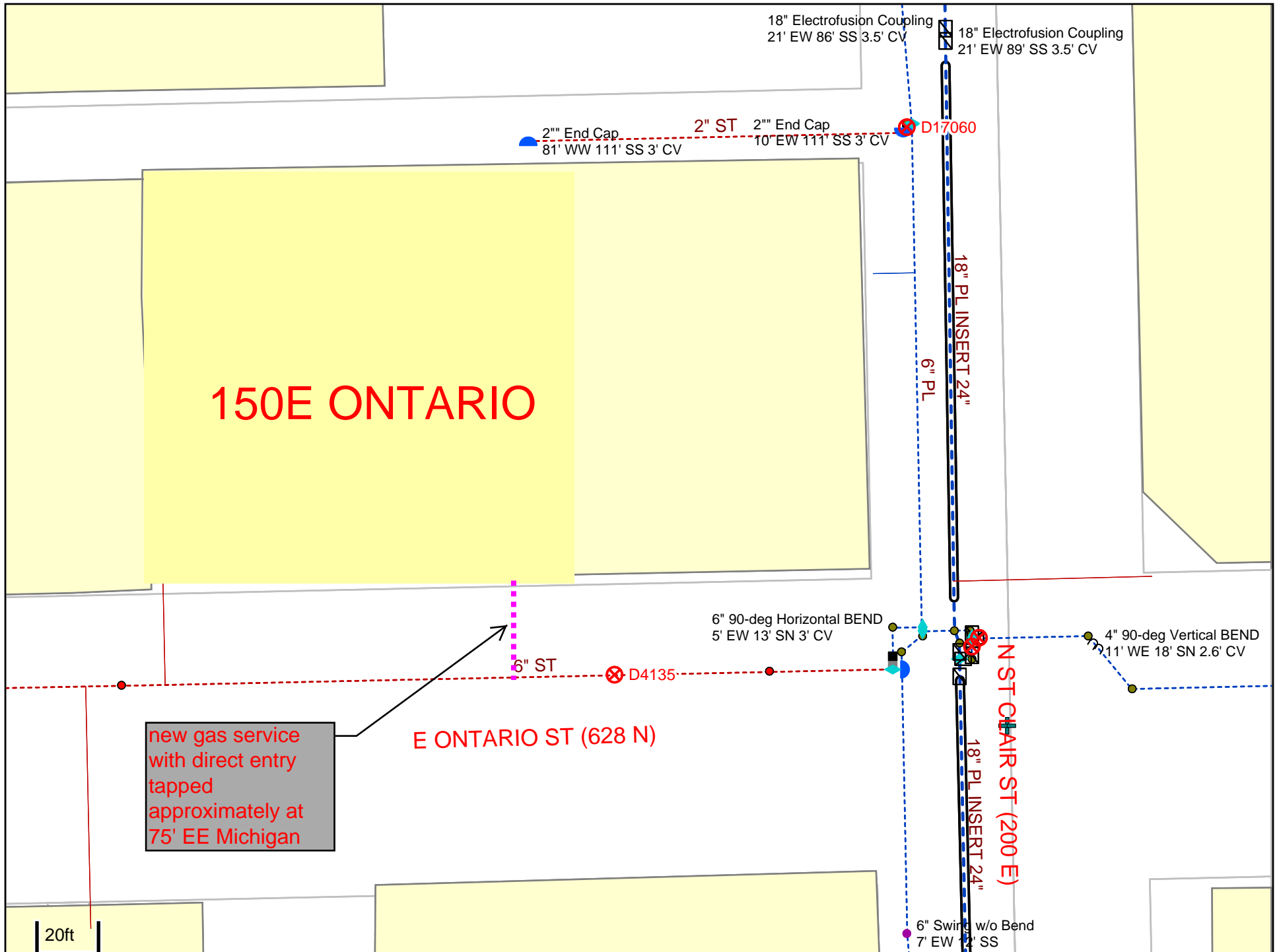

## PHOTOGRAPHS AND TABULATED GAMMA RESULTS

## Gamma Survey Results People's Gas

### Survey Equipment:

CDOT No:	1739900
Ludlum 2221 S/N:	176944
Ludlum Probe S/N	RN21187
Cutoff (cpm)	6,726
Background (cpm)	3,013
Personnel:	E. Sulita and E. Renn
Date of Screening:	11/01/2022

### Survey Results:

Location	Depth (inches)	Maximum Readings (cpm)
1	0-12	sidewalk/concrete
	12	1,440
	30	1,880
2	0	2,517
	18	2,754
	30-36	2,960
3	0	2,352
	18	2,977
	30	1,982
	40	3,003



**PICTURE 1: VIEW OF THE COMPLETED EXCAVATION AT 150-159 E ONTARIO ST.**

