



AECOM
100 S. Wacker Drive, Suite 500
Chicago, Illinois 60606

312-939-1000 tel
312-939-4198 fax

960631

May 26, 2017

Mr. Willie Thomas
Commonwealth Edison Co.
2 Lincoln Centre
Oakbrook Terrace, IL 60181

RE: Replacement of Vault Roof in Sidewalk – 230-253 E. Illinois St.
Permit No.: DOT784671
Permit Address: 230-253 E. Illinois St., Chicago, Illinois
AECOM Project No. 60493426

Dear Mr. Thomas:

Pursuant to conditions specified in a permit (see attached) issued by the City of Chicago, radiation monitoring was required to be performed at the above referenced site. AECOM Technical Services, Inc. (AECOM) provided the required radiation surveillance on May 18, 2017 for excavations to remove the sidewalk around an existing vault.

Surveying was performed on the fill exposed beneath concrete at 230-253 E. Illinois St. (see sketch) required to address the replacement of vault roof. The work consisted of removing the sidewalk around the vault to allow the vault roof to be replaced. The pavement removals were completed to depths between 6 and 10 inches below the original paved surface. No excavation of the fill was required and surveying was completed for the exposed fill beneath the concrete paving. Refer to the sketch for exact dimensions.

The monitoring did not indicate that the fill soils were above the removal action level established by the U.S. Environmental Protection Agency (USEPA) for the Streeterville area of Chicago. The USEPA removal action level for Chicago's Streeterville area is 7.1 picocuries per gram (pCi/g) total radium (Ra-226 + Ra-228). Gamma radiation count measurements for the project were recorded using Ludlum Models 2221 survey meter and an unshielded 2 x 2 inch NaI probe (Model 44-10). For the instrument used, the gamma count threshold indicative of the 7.1 pCi/g removal action level is 17,193 (S/N: 326720) counts per minute (cpm) unshielded.

The field gamma measurements within the excavation during the excavation process did not exceed the instrument threshold previously stated and ranged from a minimum of 3,700 cpm to a maximum of 5,800 cpm unshielded. The general subsurface stratigraphy was composed of gravel road base and urban fill beneath the concrete. Based on field observations there was no indication of the presence of radiologically-contaminated fill and/or an exceedance of the USEPA removal action level of 7.1 pCi/g total radium. A copy of the permit and a field sketch documenting the area where work was performed, have been included as attachments.

As part of the permit conditions, this letter has been forwarded to:

Chicago Department of Public Health
Attention: Mr. Terry Sheahan
333 South State Street, Room 200
Chicago, Illinois 60604

Permit No.: DOT784671
Permit Address: 230-253 East Illinois Street
Page 2

Please contact us with any questions you have regarding this letter or the reported results.

Regards,

Regards,



Andrew Kozak
Geologist



Steven C. Kornder, Ph.D.
Senior Project Geochemist

cc: Terry Sheahan, Chicago Department of Public Health
Verneta Simon, USEPA
William Nolan, ComEd

Attachments: Permit
Sketch

PERMIT



DEPARTMENT OF PUBLIC HEALTH
CITY OF CHICAGO

FORM NO. CDPH.ROW.03 (STREETERVILLE Right-of-Way)

Notice is hereby given that the site you have requested a permit for is recorded with the City of Chicago Department of Public Health (CDPH) as potentially having environmental contamination on the site and adjacent right-of way. This environmental contamination could present a threat to human health and safety in connection with work performed at the site, or in the adjacent right-of-way, if proper safeguards are not employed.

A file containing detailed information regarding the aforementioned environmental contamination is available for review at CDPH at 333 S. State St., Room 200, Chicago, Illinois 60604 during normal business hours (8:30AM-4:30PM, Monday through Friday). Contact (312) 745-3152 for an appointment. This file must be reviewed and the remainder of this form completed before the permit can be issued if the ground is exposed or excavated. **Please note that for some locations, additional health and safety procedures may be required by law.**

Please complete the following:

I have reviewed and understand the documents, maintained by CDPH, regarding environmental contamination of the site and adjacent right-of-way. Further, I will ensure that all work at the subject site and adjacent right-of-way, and any monitoring required including but not limited to radiation monitoring, will be performed in a manner that is protective of human health and the environment and in compliance with all applicable local, state, and federal laws, rules, and regulations, especially those pertaining to worker safety and waste management. I will ensure that the results of any radiation monitoring and/or surveying conducted shall be provided to the CDPH and the United States Environmental Protection Agency **within two (2) weeks of their completion**. If any elevated levels of radioactive material are detected, I will immediately contact the United States Environmental Protection Agency at (800) 424-8802.

Applicant Name (print): Willie Thomas

Signature: Willie Thomas

Site Address and Work Location (Describe exact site location and attach map): 230-253 E. Illinois Street

Nature of Work: Replacement of vault roof in sidewalk, only minor disturbance of fill necessary to complete project.

Company Name, Address, Phone No.: Commonwealth Edison Co. 2 Lincoln Centre Oakbrook Terrace, IL 60181Ed

General / Prime Contractor Name, Address, Phone No.: Meade Electric Co., 9550 W 55th St., Ste A, Countryside IL, 60525

Include subcontractor information if applicable
Safety Officer / Phone No. Meade - Miks O'Connor 708-588-6068; Safety/ComEd - Dion Creggett 630-726-2168

Radiation Contractor / Phone No. (if applicable) AECOM (Steve Kornder 262-515-7700 - steve.kornder@aecom.com)

Check if City Department Work Department Name: _____

CDOT Permit No.: DOT784671

Today's Date: 4/14/17 Expected Start Date: 4/17/17 CDPH Approval / Date J Sheahan 4-17/17

Please return this completed form to the Chicago Department of Transportation, Division of Infrastructure Management, Public Way Permit Office, City Hall - Room 905, 121 N. LaSalle St., Chicago, Illinois 60602 during normal business hours (8:30 AM - 4:30 PM, Monday through Friday)

For CDPH Use Only

N.C.-367-BE-COVER 7

6

5

4

3

2

1

LEGEND

- EXISTING ABOVENET MANHOLE
- EXISTING SEWER MANHOLE
- EXISTING SEWER CATCH BASIN
- EXISTING ATT MANHOLE
- EXISTING MISC MANHOLE
- EXISTING GAS VALVE
- EXISTING ELECTRIC MANHOLE
- EXISTING WATER MANHOLE
- EXISTING IRON MANHOLE
- EXISTING CABLETV MANHOLE
- EXISTING STREET LIGHT
- EXISTING PARKING PAY BOX
- EXISTING POST
- EXISTING STREET SIGN
- EXISTING COMED MANHOLE
- EXISTING COLUMN
- EXISTING PARKING METER
- EXISTING BIKE RACK
- PROPERTY LINE
- EXISTING COMCAST
- EXISTING COMED
- EXISTING CITY ELECTRIC
- EXISTING SAN SEWER
- EXISTING WATER MAIN
- EXISTING GAS MAIN
- EXISTING MCI-MFS
- EXISTING ATT
- EXISTING RCN
- EXISTING ABOVENET



An Exelon Company

COMED NETWORK VAULT ROOF REPLACEMENT

N.C.-367-425
230 E. ILLINOIS ST.
CHICAGO, ILLINOIS



INDEX TO SHEETS

DRAWING NO.	SHEET	DESCRIPTION	ISSUE PURPOSE	REVISION
N.C.-367-BE-COVER	1	TITLE, LEGEND, LOCATION MAP	FOR CONSTRUCTION	A3
N.C.-367-BE-A	2	ROOF REPLACEMENT PLAN AND SECTIONS	FOR CONSTRUCTION	A3
N.C.-367-BE-B	3	ROOF REPLACEMENT DETAILS	FOR CONSTRUCTION	A3
N.C.-367-BE-C	4	ELEVATIONS AND GRADING PLAN	FOR CONSTRUCTION	A3
N.C.-367-BE-D	5	LOCATION PLAN WITH UTILITIES	FOR CONSTRUCTION	A3
N.C.-367-BE-TWSP	6	TEMPORARY WALL SHORING PLAN	FOR CONSTRUCTION	A2
N.C.-367-BE-DEMO	7	DEMOLITION PLAN	FOR CONSTRUCTION	A2
N.C.-367-BE-LOG	8	LOGISTICS PLAN	FOR CONSTRUCTION	A2
N.C.-367-BE-1		EXISTING GENERAL PLAN	FOR INFORMATION	

DUTY TO INDEMNIFY

THE CONTRACTOR SHALL DEFEND, INDEMNIFY, KEEP AND SAVE HARMLESS THE MUNICIPALITY, OWNER AND ENGINEER, AND THEIR RESPECTIVE BOARD MEMBERS, REPRESENTATIVES, AGENTS, AND EMPLOYEES, IN BOTH INDIVIDUAL AND OFFICIAL CAPACITIES, AGAINST ALL SUITS, CLAIMS, DAMAGES, LOSSES AND EXPENSES, INCLUDING ATTORNEY'S FEES, CAUSED BY, GROWING OUT OF, OR INCIDENTAL TO THE PERFORMANCE OF THE WORK UNDER THE CONTACT BY THE CONTRACTOR OR ITS SUBCONTRACTORS TO THE FULL EXTENT WHICH WOULD RENDER THESE PROVISIONS VOID OR UNENFORCEABLE. THIS OBLIGATION INCLUDES BUT IS NOT LIMITED TO: THE ILLINOIS LAWS REGARDING STRUCTURAL WORK (II REV. STAT. CH. 48, PAR. 60 AT SEQ.) AND REGARDING THE PROTECTION OF ADJACENT LANDOWNERS (I. REV. STAT. CH. 17 1/2 PAR. 51 ET. SEQ.) IN THE EVENT OF ANY SUCH INJURY (INCLUDING DEATH) OR LOSS OR DAMAGE, OR CLAIMS THEREFORE, THE CONTRACTOR SHALL GIVE PROMPT NOTICE TO THE OWNER.



LOCATION PLAN

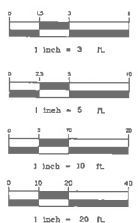

121 NORTH LASALLE STREET, ROOM 905
CHICAGO, IL 60602

REV.	DESCRIPTION	P.E.	P.C.	DATE
A3.11-13-18	FOR CONSTRUCTION	ASB	CHG	AJS
A3.10-21-18	FOR REVISION	ASB	CHG	AJS
A3.09-13-18	FOR CAD REVIEW	ASB	CHG	AJS
A3.08-07-18	FOR DATE REVIEW	ASB	CHG	AJS



HBK ENGINEERING, L.L.C.
180 WEST FULLER STREET, SUITE 100
CHICAGO, IL 60601
PHONE: 773-329-7400 FAX: 773-329-7401
WWW.HBK-ENGINEERING.COM

ANY MODIFICATION OR ADDITION TO THIS DRAWING BY ANY ORGANIZATION OTHER THAN HBK IS NOT THE RESPONSIBILITY OF HBK.

PROJ. No. 15-0186

PROJECT ENGINEER: PHONE NO.: PROJECT DESIGNER: PHONE NO.:
DATE: SCALE: P.L. NO.: REPORT NO.:
ComEd
N.C.-367-BE-COVER
Issue: 11-15-2016
DRAWING NO.

7

6

5

4

3

2

1



SKETCH

JOB TITLE 230 E. Illinois St.
 JOB NO. 60493426 CALCULATION NO. _____
 ORIGINATOR K. Korczak DATE 5/19/17
 REVIEWER S. Kornder DATE 5/25/17
 SCALE not to scale SHEET NO. 1 OF 1

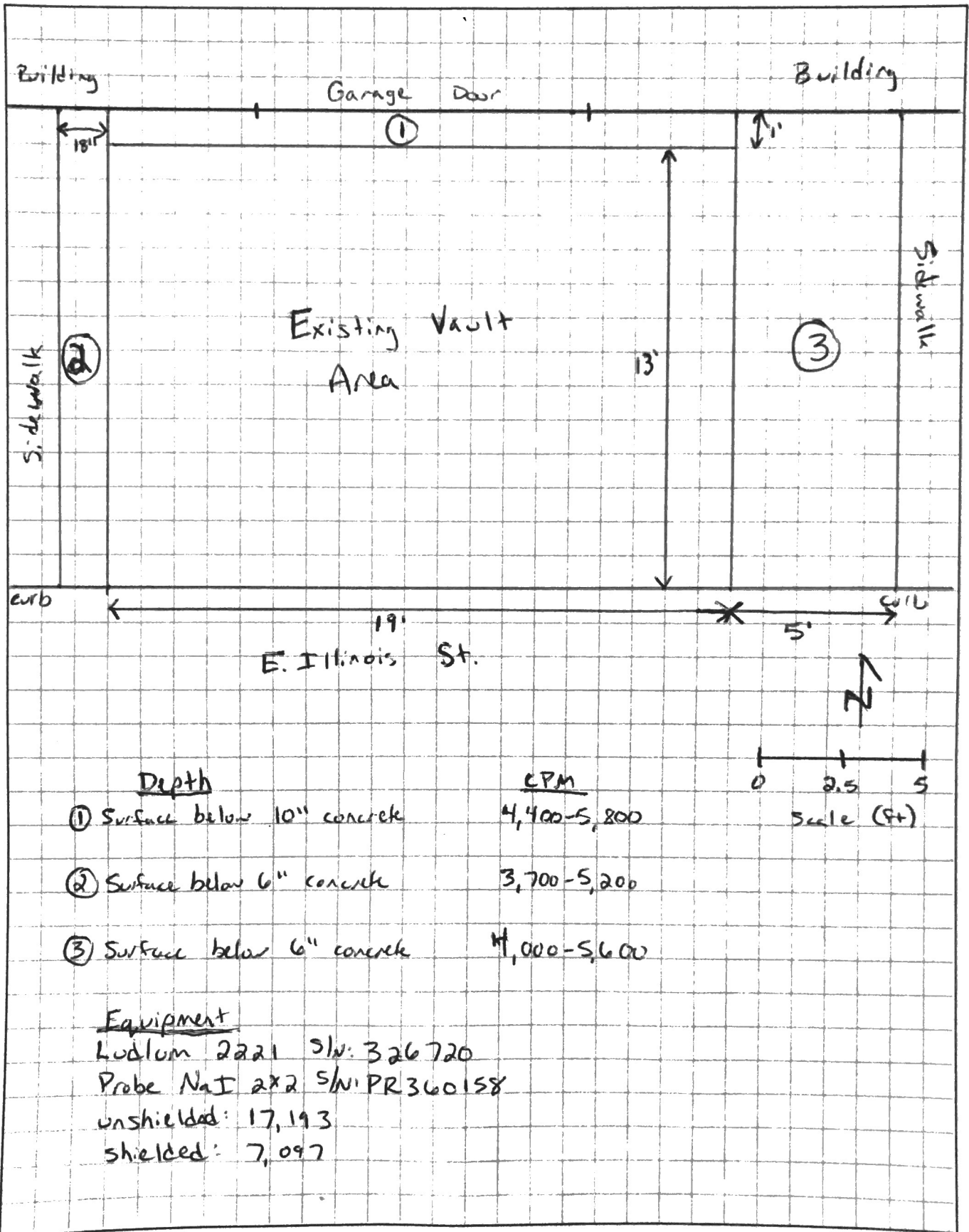

Depth	CPM
① Surface below 10" concrete	4,400-5,800
② Surface below 6" concrete	3,700-5,200
③ Surface below 6" concrete	4,000-5,600

Equipment
 Ludlum 2221 SN: 326720
 Probe Nat 2x2 SN: PR360158
 unshielded: 17,193
 shielded: 7,097