



AECOM
303 E. Wacker Drive, Suite 1400
Chicago, Illinois 60606

312-939-1000 tel
312-939-4198 fax

May 11, 2022

Mr. Kyle Carlson
Peoples Gas Light & Coke Co.
Environmental Services Department
200 E. Randolph Street, 24th Floor
Chicago, IL 60601

RE: Streeterville Thorium Monitoring Results – Corrosion Protection
Permit No.: 1658393
Permit Addresses: 100-163 E Ontario St.

Dear Mr. Carlson:

Pursuant to conditions specified in the Right-of-Way (ROW) forms (attached) issued by the City of Chicago Department of Public Health (CDPH), radiation monitoring was required to be performed at the above referenced site. AECOM Technical Services, Inc. (AECOM) provided the required radiation surveillance on April 25, 2022, for an excavation to install corrosion protection anodes at the project address (refer to maps included with CDPH forms). The excavation was 46-inches by 62-inches to a depth of 3-feet below ground surface (bgs).

The monitoring did not indicate that the fill soils were above the removal action level established by the U.S. Environmental Protection Agency (USEPA) for the Streeterville area of Chicago. The USEPA removal action level for Chicago's Streeterville area is 7.1 picocuries per gram (pCi/g) total radium (Ra-226 + Ra-228). Gamma radiation count measurements for the project were recorded using a Ludlum Model 2221 survey meter and a shielded 2 x 2 inch NaI probe (Model 44-10). For the instruments used (Ludlum, NaI probe, and long cord), the gamma count threshold indicative of the 7.1 pCi/g removal action level was approximately 5,300 (S/N: 326720) counts per minute (cpm) shielded.

The excavation was located approximately 130-feet east of N. Michigan Ave. and 4-feet south of the north sidewalk of E. Ontario St. Field gamma measurements within this opening did not exceed the instrument threshold previously stated and ranged from 1,480 to a maximum reading of 1,618 cpm. The background gamma count of nearby soils was measured at 1,436 cpm shielded. Based on field observations, there was no indication of the presence of radiologically-contaminated fill and/or an exceedance of the USEPA removal action level of 7.1 pCi/g total radium.

A PDF copy of this letter will be forwarded via email to the CDPH and Verneta Simon (USEPA) to fulfill the requirements of the CDPH. Copies of the CDPH form, photographs, and the tabulated gamma results are included as attachments to this report.

Please contact us with any questions you have regarding this letter or the reported results.

Regards,



Eric Sulita, P.E.
Environmental Engineer III



Steven C. Kornder, Ph.D.
Senior Project Geochemist

cc: Ahmad Nur, Chicago Department of Public Health
Verneta Simon, USEPA

Attachments: CDPH Permit Form and Map
Tabulated Gamma Results and Photograph

CDPH PERMIT FORM



DEPARTMENT OF PUBLIC HEALTH
CITY OF CHICAGO

FORM NO. CDPH.ROW.03 (STREETERVILLE Right-of-Way)

Notice is hereby given that the site you have requested a permit for is recorded with the City of Chicago Department of Public Health (CDPH) as potentially having environmental contamination on the site and adjacent right-of way. This environmental contamination could present a threat to human health and safety in connection with work performed at the site, or in the adjacent right-of-way, if proper safeguards are not employed.

A file containing detailed information regarding the aforementioned environmental contamination is available for review at CDPH at 333 S. State St., Room 200, Chicago, Illinois 60604 during normal business hours (8:30AM-4:30PM, Monday through Friday). Contact (312) 745-3152 for an appointment. This file must be reviewed and the remainder of this form completed before the permit can be issued if the ground is exposed or excavated. Please note that for some locations, additional health and safety procedures may be required by law.

Please complete the following:

I have reviewed and understand the documents, maintained by CDPH, regarding environmental contamination of the site and adjacent right-of-way. Further, I will ensure that all work at the subject site and adjacent right-of-way, and any monitoring required including but not limited to radiation monitoring, will be performed in a manner that is protective of human health and the environment and in compliance with all applicable local, state, and federal laws, rules, and regulations, especially those pertaining to worker safety and waste management. I will ensure that the results of any radiation monitoring and/or surveying conducted shall be provided to the CDPH and the United States Environmental Protection Agency within two (2) weeks of their completion. If any elevated levels of radioactive material are detected, I will immediately contact the United States Environmental Protection Agency at (800) 424-8802.

Applicant Name (print): Maria G Oliver Signature: Maria G Oliver

Site Address and Work Location (Describe exact site location and attach map): 100-163 E Ontario St

Nature of Work: Corrosion Repair

Company Name, Address, Phone No.: Peoples Gas, 200 E Randolph St (312) 240-4692

General / Prime Contractor Name, Address, Phone No.: Jose Gomez (312) 978-3335 Include subcontractor information if applicable

Safety Officer / Phone No. Joseph McHugh (312) 285-7315

Radiation Contractor / Phone No. (if applicable) Steve Kornder, AECOM INC. (262) 515-7700

Check if City Department Work [] Department Name:

CDOT Permit No.: DOT1658393

Today's Date: 4/14/2022 Expected Start Date: 4/19/2022 CDPH Approval / Date ahmad nur 04/14/2022

Please return this completed form to the Chicago Department of Transportation, Division of Infrastructure Management, Public Way Permit Office, City Hall - Room 905, 121 N. LaSalle St., Chicago, Illinois 60602 during normal business hours (8:30 AM - 4:30 PM, Monday through Friday)

For CDPH Use Only

DOT1658393 Opening for Corrosion Repair:

Curb Lane, Parkway, Sidewalk, and Traffic Lane 5x60x5

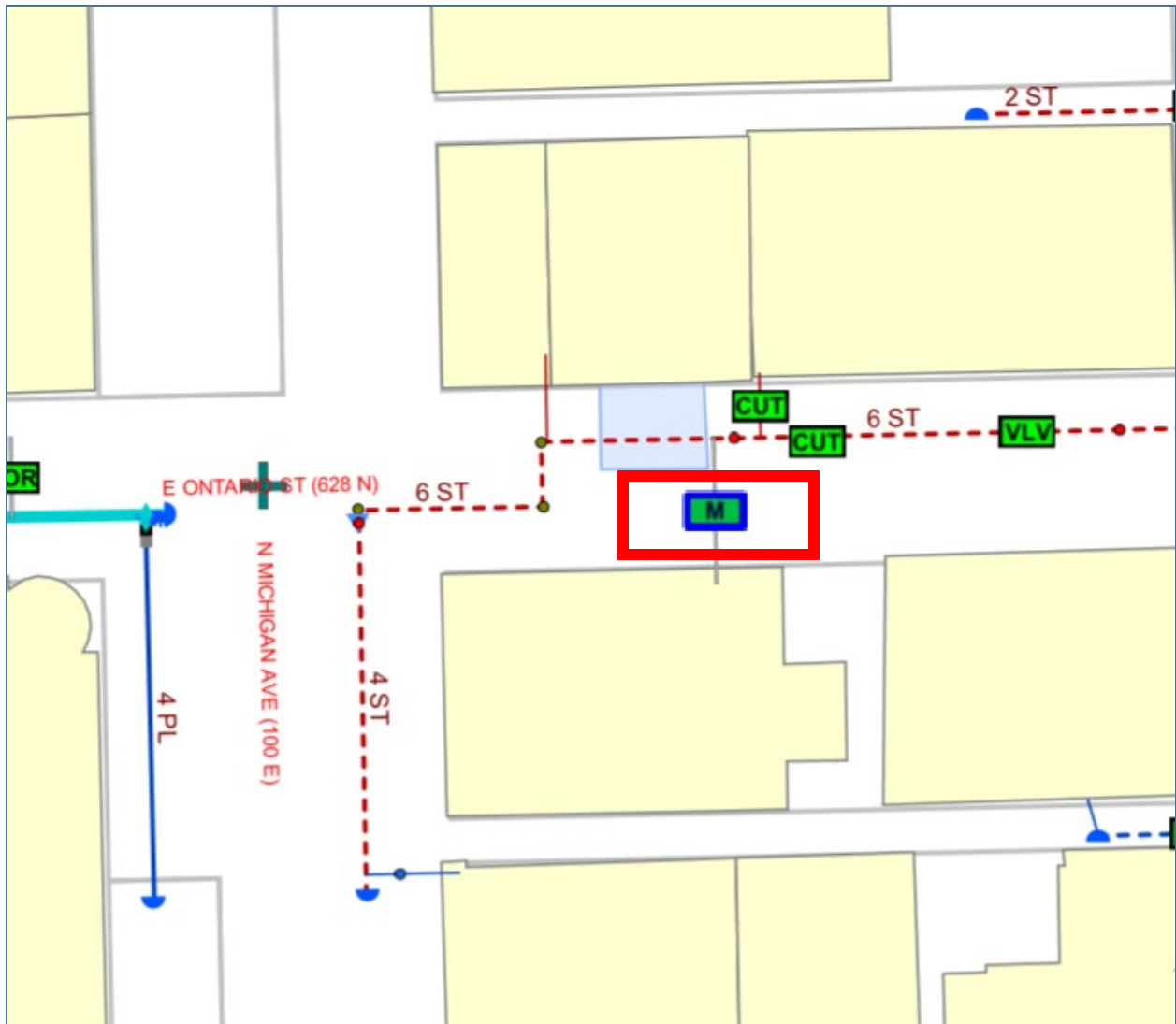

PHOTOGRAPHS AND TABULATED GAMMA RESULTS

**Gamma Survey Results
People's Gas**

Survey Equipment

CDOT No:	1658393
Ludlum 2221 S/N:	326720
Ludlum Probe S/N	PR360158
Cutoff (using long-cord) (cpm)	5300
Background (cpm)	1436
Personnel:	E. Sulita and C. Redding
Date of Screening:	4/25/2022

Survey Results

Location	Depth (inches)	Maximum Readings (cpm)
100-163 E Ontario	0-18	concrete
	18	1480
	27	1618
	30	1573

PICTURE 1: VIEW OF THE COMPLETED CORROSION PROTECTION EXCAVATION AT 100-163 E ONTARIO ST.

