

April 4, 2019

Mr. Phil Livingston  
IHC Construction Companies LLC  
1500 Executive Drive  
Elgin, IL 60123

RE: Utility Excavation for Duct Repair  
Permit No.: DOT1072735  
Permit Address: 100 E Ohio Street, Chicago, IL  
AECOM Project No. 60565145

Dear Mr. Livingston:

Pursuant to conditions specified in a permit (see attached) issued by the City of Chicago, radiation monitoring was required to be performed at the above referenced site. AECOM Technical Services, Inc. (AECOM) provided the required radiation surveillance during excavation work to repair a blocked duct bank on April 3, 2019. The duct package had been abandoned for some time and was being evaluated and prepared for future reuse.

Surveying was performed on the fill exposed at the permit address listed above (refer to the attached sketch). The work consisted of the excavation of a rectangular 4 by 6-foot excavation in the center lane of E. Ohio Street on the western side of the intersection of E. Ohio and N. Rush Streets. The excavation was excavated to a maximum depth of 36-inches below ground surface (bgs). The excavation revealed that a plastic gas main had been installed directly through the abandoned duct package.

The monitoring did not indicate that the fill soils were above the removal action level established by the U.S. Environmental Protection Agency (USEPA) for the Streeterville area of Chicago. The USEPA removal action level for Chicago's Streeterville area is 7.1 picocuries per gram (pCi/g) total radium (Ra-226 + Ra-228). Gamma radiation count measurements for the project were recorded using Ludlum Models 2221 survey meter and a shielded 2 x 2 inch NaI probe (Model 44-10). For the instrument used, the gamma count threshold indicative of the 7.1 pCi/g removal action level is 6,669 (S/N: 172039) counts per minute (cpm) shielded. The field instrument background count for soil within a nearby planter on the southwest corner of the intersection was 2,002 cpm shielded.

The field gamma measurements within the excavation during the excavation process did not exceed the instrument threshold previously stated and ranged from a minimum of 1,645 cpm to a maximum of 2,100 cpm shielded. The general subsurface stratigraphy beneath the pavement was composed of urban fill. In the vicinity of the gas service main, and duct package breach, the fill was predominantly a tan backfill sand typical of that utilized around gas service mains. Based on field observations there was no indication of the presence of radiologically-contaminated fill and/or an exceedance of the USEPA removal action level of 7.1 pCi/g total radium. A copy of the CDPH ROW form and a field sketch documenting the area where work was performed have been included as attachments.

As part of the permit conditions, a PDF copy of this letter has been forwarded to Terry Sheahan at the CDPH and Verneta Simon (USEPA).

Permit No.: DOT1072735

Permit Address: 100 E Ohio Street, Chicago, IL

Page 2

Please contact us with any questions you have regarding this letter.

Regards,



Andrew Kozak  
Geologist



Steven C. Kornder, Ph.D.  
Senior Project Geochemist

cc: Terry Sheahan, Chicago Department of Public Health  
Verneta Simon, USEPA

**PERMIT**



DEPARTMENT OF PUBLIC HEALTH
CITY OF CHICAGO

(STREETERVILLE Right-of-Way)

Notice is hereby given that the site you have requested a permit for is recorded with the City of Chicago Department of Public Health (CDPH) as potentially having environmental contamination on the site and adjacent right-of way. This environmental contamination could present a threat to human health and safety in connection with work performed at the site, or in the adjacent right-of-way, if proper safeguards are not employed.

A file containing detailed information regarding the aforementioned environmental contamination is available for review at CDPH at 333 S. State St., Room 200, Chicago, Illinois 60604 during normal business hours (8:30AM-4:30PM, Monday through Friday). Contact (312) 745-3152 for an appointment. This file must be reviewed and the remainder of this form completed before the permit can be issued if the ground is exposed or excavated. Please note that for some locations, additional health and safety procedures may be required by law.

Please complete the following:

I have reviewed and understand the documents, maintained by CDPH, regarding environmental contamination of the site and adjacent right-of-way. Further, I will ensure that all work at the subject site and adjacent right-of-way, and any monitoring required including but not limited to radiation monitoring, will be performed in a manner that is protective of human health and the environment and in compliance with all applicable local, state, and federal laws, rules, and regulations, especially those pertaining to worker safety and waste management. I will ensure that the results of any radiation monitoring and/or surveying conducted shall be provided to the CDPH and the United States Environmental Protection Agency within two (2) weeks of their completion. If any elevated levels of radioactive material are detected, I will immediately contact the United States Environmental Protection Agency at (800) 424-8802.

Applicant Name (print): Brian McDonagh Signature: Brian McDonagh Digitally signed by Brian McDonagh Date: 2019.03.21 16:05:05 -05'00'

Site Address and Work Location (Describe exact site location and attach map): Corner of Ohio and State
1 - 100 E. Ohio St., 1 - 50 W. Ohio St.

Nature of Work: 5x5x5 Dig up to repair/remove debris from conduit

Company Name, Address, Phone No.: MCI Metro 2400 N Glenville, Richardson TX (708)458-6410

General / Prime Contractor Name, Address, Phone No.: IHC Construction, Phil Livingston 847-420-0552
Include subcontractor information if applicable)

Safety Officer / Phone No.
Radiation Contractor / Phone No. and email address (if applicable) AECOM (Steve Kornder 262-515-7700)

Check if City Department Work [ ] Department Name:

CDOT Permit No.: DOT1072735

Today's Date: 3/25/2018 Expected Start Date: 3/26/2018 CDPH Approval / Date [Signature] 3/26/19

Please return this completed form to the Chicago Department of Transportation, Division of Infrastructure Management, Public Way Permit Office, City Hall - Room 905, 121 N. LaSalle St., Chicago, Illinois 60602 during normal business hours (8:30 AM - 4:30 PM, Monday through Friday)

For CDPH Use Only

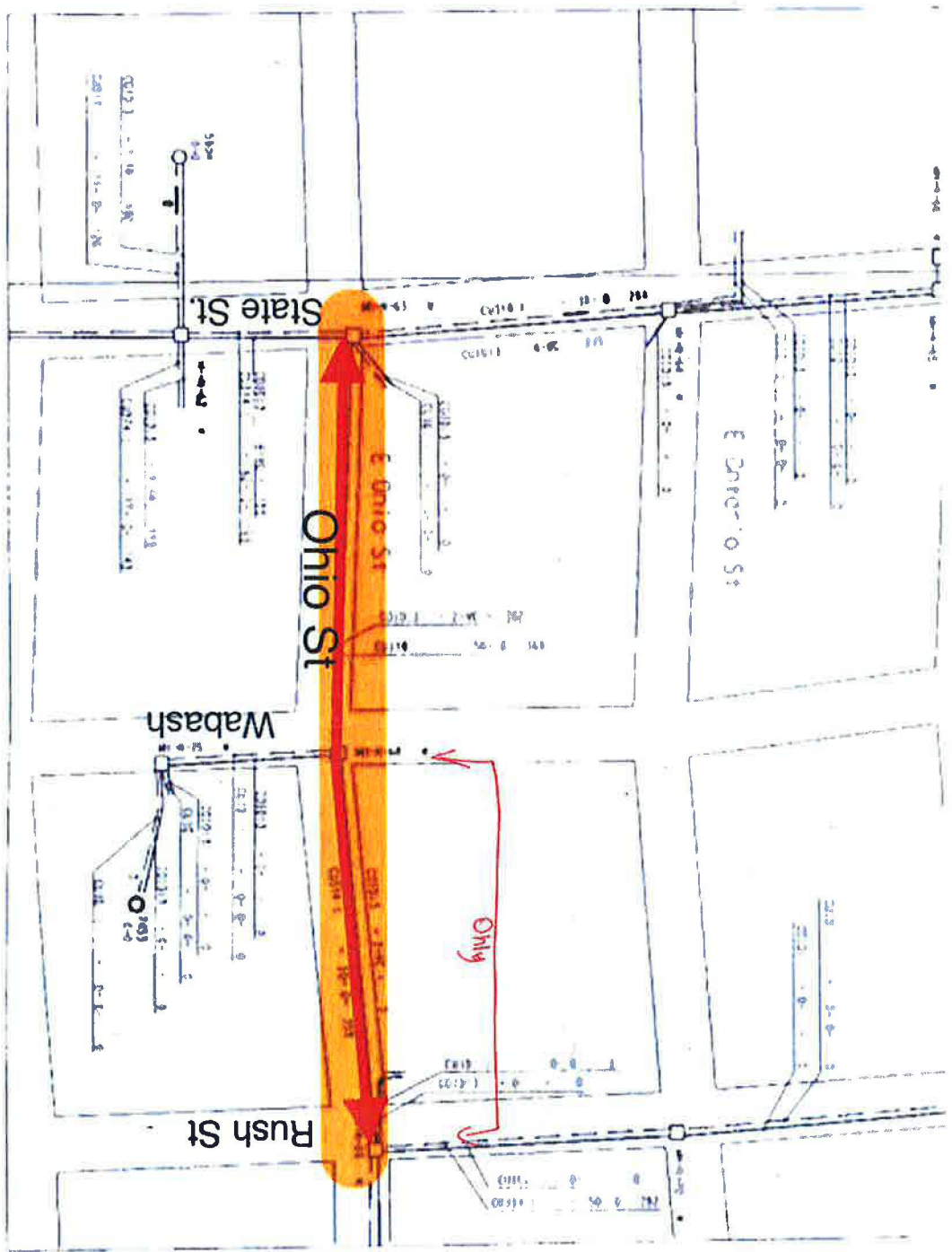

**SKETCH**



JOB TITLE IHL - 60565145 N. Rush St. West,  
JOB NO. 60565145 CALCULATION NO. \_\_\_\_\_  
ORIGINATOR SCR DATE 4/3/19  
REVIEWER DK DATE 4/3/19  
SCALE none SHEET NO. 1 OF 1

Ludlum: Ser #  
Permit: DOT 1072735  
Background: 2002 cpm shielded  
Shield-d Count: 6,669 cpm  
Screeners: SKemder

