



AECOM  
303 E. Wacker Drive, Suite 1400  
Chicago, Illinois 60606

312-373-7700 tel  
312-373-6800 fax

September 28, 2018

Mr. Robert Wilson  
Mobilitie, LLC  
120 S. Riverside Plaza, Suite 1800  
Chicago, IL 60606

RE: Installation of Wireless Cellular Service Equipment  
Permit No.: DOT949398  
Permit Address: 588 E. Illinois St., Chicago, Illinois  
AECOM Project No. 60579801

Dear Mr. Wilson:

Pursuant to conditions specified in a permit (see attached) issued by the City of Chicago, radiation monitoring was required to be performed at the above referenced site. AECOM Technical Services, Inc. (AECOM) provided the required radiation surveillance on September 18, 2018 for an excavation related to an installation of small wireless cellular service equipment.

Surveying was performed on the fill removed at 588 E. Illinois St. (see sketch), required to address a replacement of an existing light-base and an excavation of a related trench. The trench excavation was approximately 15-feet long, 1.5 to 3-feet wide, and to a depth of 3-feet below ground surface (bgs). The light-base excavation utilized a hydro-vacuum truck to excavate a 2-foot diameter hole to 9.5-feet bgs. See attached sketch for the location of excavation.

The monitoring did not indicate that the fill soils were above the removal action level established by the U.S. Environmental Protection Agency (USEPA) for the Streeterville area of Chicago. The USEPA removal action level for Chicago's Streeterville area is 7.1 picocuries per gram (pCi/g) total radium (Ra-226 + Ra-228). Gamma radiation count measurements for the project were recorded using Ludlum Models 2221 survey meter and a shielded 2 x 2 inch NaI probe (Model 44-10). For the instrument used (S/N: 172309), the gamma count threshold indicative of the 7.1 pCi/g removal action level is 6,669 counts per minute (cpm) shielded short cord configuration and 6,456 cpm for the shielded long cord configuration.

The field gamma measurements within the excavation during the excavation process did not exceed the instrument threshold previously stated, and ranged from a minimum of 1,800 cpm to a maximum of 4,000 cpm shielded. The general subsurface stratigraphy was composed of urban fill and gravel. Based on field observations there was no indication of the presence of radiologically-contaminated fill and/or an exceedance of the USEPA removal action level of 7.1 pCi/g total radium. A copy of the permit and a field sketch documenting the area where work was performed, have been included as attachments.

As part of the permit conditions, this letter has been forwarded to:

Chicago Department of Public Health  
Attention: Mr. Terry Sheahan  
333 South State Street, Room 200  
Chicago, Illinois 60604

Permit No.: DOT949398  
Permit Address: 588 E. Illinois St.  
Page 2

Please contact us with any questions you have regarding this letter or the reported results.

Regards,



Andrew Kozak  
Geologist



Steven C. Kornder, Ph.D.  
Senior Project Geochemist

cc: Terry Sheahan, Chicago Department of Public Health  
Verneta Simon, USEPA  
Jose J Galvez, Lyons-Pinner

Attachments: Permit  
Annotated Drawing and Results

**PERMIT**



DEPARTMENT OF PUBLIC HEALTH
CITY OF CHICAGO

(STREETERVILLE Right-of-Way)

Notice is hereby given that the site you have requested a permit for is recorded with the City of Chicago Department of Public Health (CDPH) as potentially having environmental contamination on the site and adjacent right-of way. This environmental contamination could present a threat to human health and safety in connection with work performed at the site, or in the adjacent right-of-way, if proper safeguards are not employed.

A file containing detailed information regarding the aforementioned environmental contamination is available for review at CDPH at 333 S. State St., Room 200, Chicago, Illinois 60604 during normal business hours (8:30AM-4:30PM, Monday through Friday). Contact (312) 745-3152 for an appointment. This file must be reviewed and the remainder of this form completed before the permit can be issued if the ground is exposed or excavated. Please note that for some locations, additional health and safety procedures may be required by law.

Please complete the following:

I have reviewed and understand the documents, maintained by CDPH, regarding environmental contamination of the site and adjacent right-of-way. Further, I will ensure that all work at the subject site and adjacent right-of-way, and any monitoring required including but not limited to radiation monitoring, will be performed in a manner that is protective of human health and the environment and in compliance with all applicable local, state, and federal laws, rules, and regulations, especially those pertaining to worker safety and waste management. I will ensure that the results of any radiation monitoring and/or surveying conducted shall be provided to the CDPH and the United States Environmental Protection Agency within two (2) weeks of their completion. If any elevated levels of radioactive material are detected, I will immediately contact the United States Environmental Protection Agency at (800) 424-8802.

Applicant Name (print): Robert Wilson Signature: [Handwritten Signature]

Site Address and Work Location (Describe exact site location and attach map):

588 E Illinois (see attached construction drawings)

Nature of Work: Attach small cell wireless equipment to replacement light pole.

Company Name, Address, Phone No.: Mobilitie, LLC, 120 S. Riverside Plaza, Suite 1800, Chicago, IL, 60606, (312) 343-4882

General / Prime Contractor Name, Address, Phone No.: Lyons-Pinner, Jose Galvez, 650 E Elm Ave, La Grange, IL 60525
Include subcontractor information if applicable 708-588-6813

Safety Officer / Phone No.

Radiation Contractor / Phone No. and email address (if applicable) AECOM, Steve Kornder, 262 515-7700

Check if City Department Work [ ] Department Name:

CDOT Permit No.: DOT949398

Today's Date: 5/9/2018 Expected Start Date: 5/14/2018 CDPH Approval / Date [Handwritten Signature] 5-15-18

Please return this completed form to the Chicago Department of Transportation, Division of Infrastructure Management, Public Way Permit Office, City Hall - Room 905, 121 N. LaSalle St., Chicago, Illinois 60602 during normal business hours (8:30 AM - 4:30 PM, Monday through Friday)

For CDPH Use Only

SHEET NO.	TITLE
1.0	SHEET TITLE
2.0	GENERAL NOTES
3.0	ELECTRICAL NOTES
4.0	RESTORATION PLAN
5.0	COOT STANDARDS
6.0	COOT STANDARDS
7.0	COOT STANDARDS
8.0	COOT STANDARDS
9.0	COOT STANDARDS
10.0	TRAFFIC CONTROL NOTES
11.0	SUGGESTED MAINTENANCE OF TRAFFIC PLAN
12.0	TRAFFIC CONTROL DETAILS 7 ADA RAMP
13.0	TRAFFIC CONTROL DETAILS
14.0	SIDE POLE ELEVATIONS
15.0	FRONT POLE ELEVATIONS
16.0	CABLING DIAGRAM
17.0	GROUNDING RISER DIAGRAM
18.0	EQUIPMENT DETAILS AND POLE LOADING REPORT

**PROJECT INFORMATION**  
 ADDRESS/CROSS ST: 588 E. ILLINOIS ST., CHICAGO, IL 60611  
 WARD: 42  
 COUNTY: COOK COUNTY  
 UTILITIES: POWER, "COMED", TELEPHONE, "ATA", CABLE, "COMCAST", GAS, "PEOPLES"  
 PROPERTY OWNER: PUBLIC RIGHT-OF-WAY MOBILITY LLC  
 APPLICANT: MOBILITY LLC  
 JURISDICTION: CDOT

**PROJECT SUMMARY**  
 INSTALL 20' ELECTRICAL PVC CONNECT TO COM-ED SECONDARY FEED

**STANDARDS**  
 • CDOT RULES & REGULATIONS FOR CONSTRUCTION IN THE PUBLIC WAY MARCH 2016  
 • IDOT HIGHWAY STANDARDS

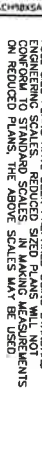

FULL SIZE PLANS HAVE BEEN PREPARED USING STANDARD CONVENTION TO STANDARD SCALES. SIZED DRAWING MEASUREMENTS ON REDUCED PLANS, THE ABOVE SCALES MAY BE USED.

DIGGER: 312-744-7000  
 CONTRACTOR SHALL CALL DIGGER TWO (2) WORKING DAYS (48 HOURS) BEFORE DIGGING.

**PROJECT CONTACTS**  
 MOBILITY PROJECT MANAGER CONTACT: ROBERT WILSON, 1520 RIVERVIEW PLAZA, CHICAGO, IL 60606, PHONE: 312-638-5363  
 DB STERLIN CONSULTANTS, INC. ENGINEER CONTACT: 123 N. WACKER DR., SUITE 2000, CHICAGO, IL 60606, PHONE: 312-857-1006

**VICINITY MAP**  
 LATITUDE: 41.891145 N  
 LONGITUDE: 87.615185 W

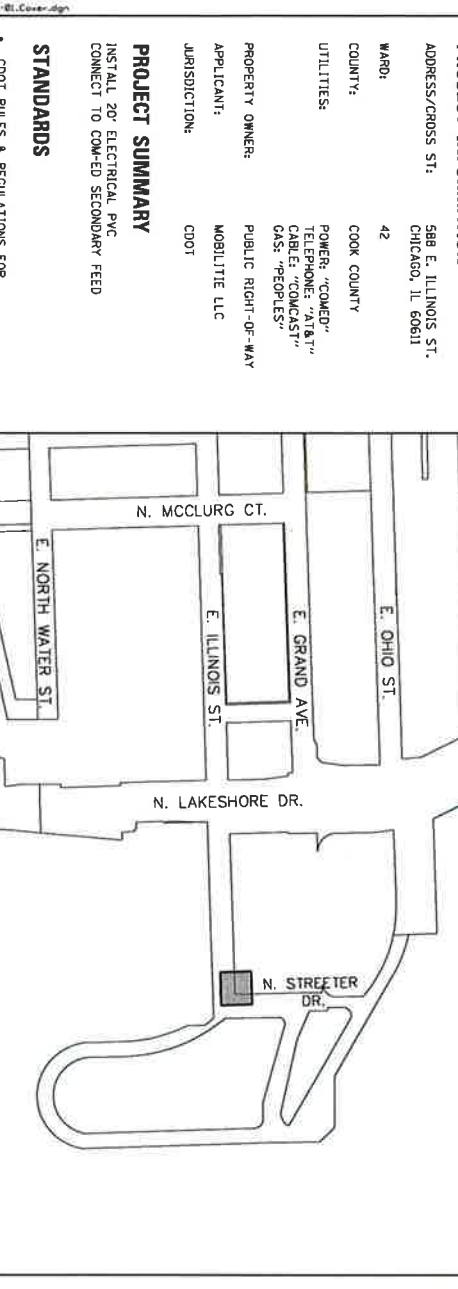

**POLE LOCATION**  
 588 E. ILLINOIS ST.  
 LATITUDE: 41.891145 N  
 LONGITUDE: 87.615185 W

**EXISTING POLE TO BE REMOVED AND REPLACED TO MOUNT PROPOSED LESSER ANTENNA, RRU AND EQUIPMENT.**

**EXISTING UTILITIES**

UTILITY	STATUS
LOW PRESSURE GAS MAIN	---
MEDIUM PRESSURE GAS MAIN	---
HIGH PRESSURE GAS MAIN	---
AIR & COMMUNICATIONS	---
COMED	---
DEO	---
SEWER	---
WATER MAIN	---

**SYMBOLS**

SYMBOL	DESCRIPTION
☀	FIRE HYDRANT
☀	TREE < 6"
☀	TREE > 6"
☀	UTILITY MH
☀	STORM MH
☀	STORM CATCH BASIN
☀	UTILITY POLE
☀	SIGN
☀	POLE
☀	MEDALLION
☀	GREEN CUT TRENCH, SEE 4 LOCATION TO BE DETERMINED BY FIELD ENGINEER
☀	NEW ADA SIDEWALK RAMP
☀	NEW ADA SIDEWALK RAMP
☀	OLD ADA SIDEWALK RAMP
☀	BUS PAD
☀	BUS PAD
☀	RAILROAD TRACKS
☀	APPROX. LOCATION OF POTENTIAL BURIED CTA TRACKS

**ISSUED FOR OLC REVIEW - 3/28/2018**

**TITLE SHEET**

FORM BY: CBF  
 CHECKED BY: HJM  
 DATE: 3/28/2018  
 PROJECT: DASC CH90XSAT7F (00C-2018-01318)  
 TITLE: 588 E ILLINOIS ST.  
 SCALE: AS SHOWN  
 PAGE: 1.0 OF 18.0

**DEO WORK ORDER #: 11717026**



**mobilitie**  
 intelligent infrastructure

**PROFESSIONAL LICENSURE**

DBS  
 DB STERLIN CONSULTANTS, INC.  
 1520 RIVERVIEW PLAZA, SUITE 2000  
 CHICAGO, ILLINOIS 60606  
 TEL: 312-638-5363 FAX: 312-638-5364

**HANNAH J. MARTENS**  
 REGISTERED PROFESSIONAL ENGINEER  
 STATE OF ILLINOIS  
 082-058491  
 3/28/2018

**REVISIONS**  
 3/28/2018

## ANNOTATED DRAWING AND RESULTS



UTILITY NOTES:

1. THIS SITE PLAN WAS GENERATED WITHOUT THE USE OF A SURVEY. PROPERTY LINES, CURBS, MANHOLES, AND UTILITY LINES SHOWN ON THESE PLANS ARE ESTIMATED.
2. THE EXISTENCE AND LOCATION OF UNDERGROUND UTILITIES SHALL BE OBTAINED FROM ALL UTILITY COMPANIES, INVESTIGATED AND VERIFIED IN THE FIELD BY THE CONTRACTOR BEFORE STARTING WORK. EXCAVATION IN THE VICINITY OF EXISTING STRUCTURES SHALL BE PERFORMED BY HAND. THE CONTRACTOR SHALL BE HELD RESPONSIBLE FOR ANY AND ALL DAMAGES TO EXISTING FACILITIES, MAINTENANCE AND PROTECTION OF EXISTING UTILITIES AND STRUCTURES.
3. HAND EXCAVATION IS REQUIRED TO FIELD VERIFY THE HORIZONTAL AND VERTICAL LOCATION OF THE 12-INCH WATER MAIN PRIOR TO CROSSING. A MINIMUM OF 4 FEET OF UNDISTURBED SOIL IS TO REMAIN ON EITHER SIDE OF THIS EXISTING MAIN. EXTREME CAUTION MUST BE TAKEN TO AVOID DAMAGE TO THESE WATER FACILITIES. IF ANY DAMAGE OCCURS TO THIS DEPARTMENT'S FACILITIES THE CONTRACTOR AND/OR OWNER WILL BE RESPONSIBLE FOR THE COST OF REPAIRING OR REPLACING THE DAMAGED FACILITIES.
4. UPON PROJECT COMPLETION, RESIDENT ENGINEERS MUST CONTACT THE DWM SEWER EVALUATION SECTION AT 312-747-4680 TO SCHEDULE A FIELD MEETING FOR PROJECT ACCEPTANCE. PRIVATE SEWER DRAINS (W/BASEMENTS) TYPICALLY HAVE APPROXIMATELY 5 FEET OF COVER. DUE TO POTENTIAL VERTICAL CONFLICTS IN THE PARKWAY, THE CONTRACTOR MUST TELEVISION ALL PRIVATE DRAINS AFTER CONSTRUCTION. A COPY OF THE DVD MUST BE PRESENTED TO THE DWM SEWER INSPECTOR FOR PROJECT ACCEPTANCE.
5. USE #6 AWG STRANDED CABLE UNLESS OTHERWISE NOTED.

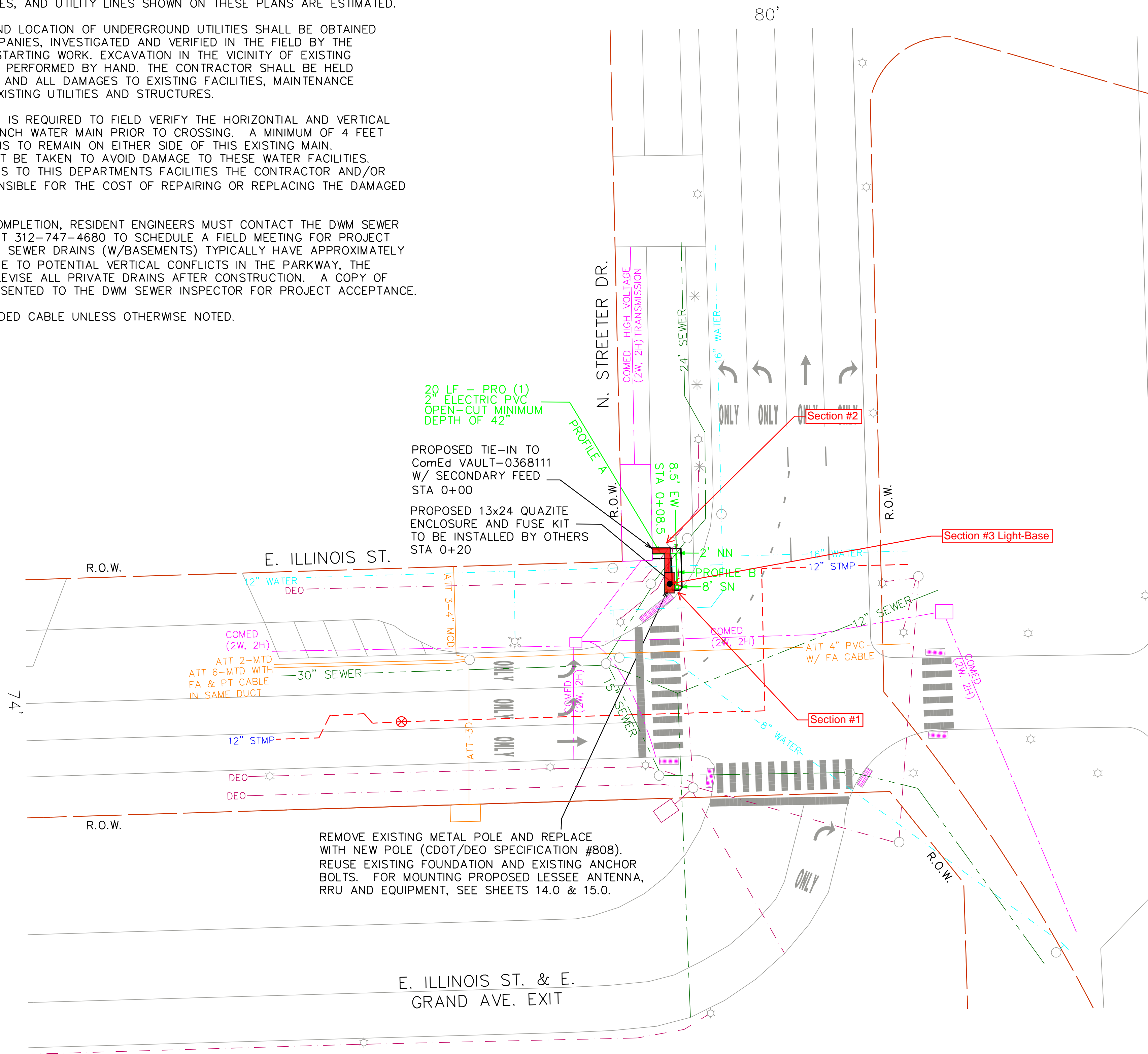

PROFILE A  
E. ILLINOIS ST.  
FROM: STA. 0+00 TO STA. 0+8.5

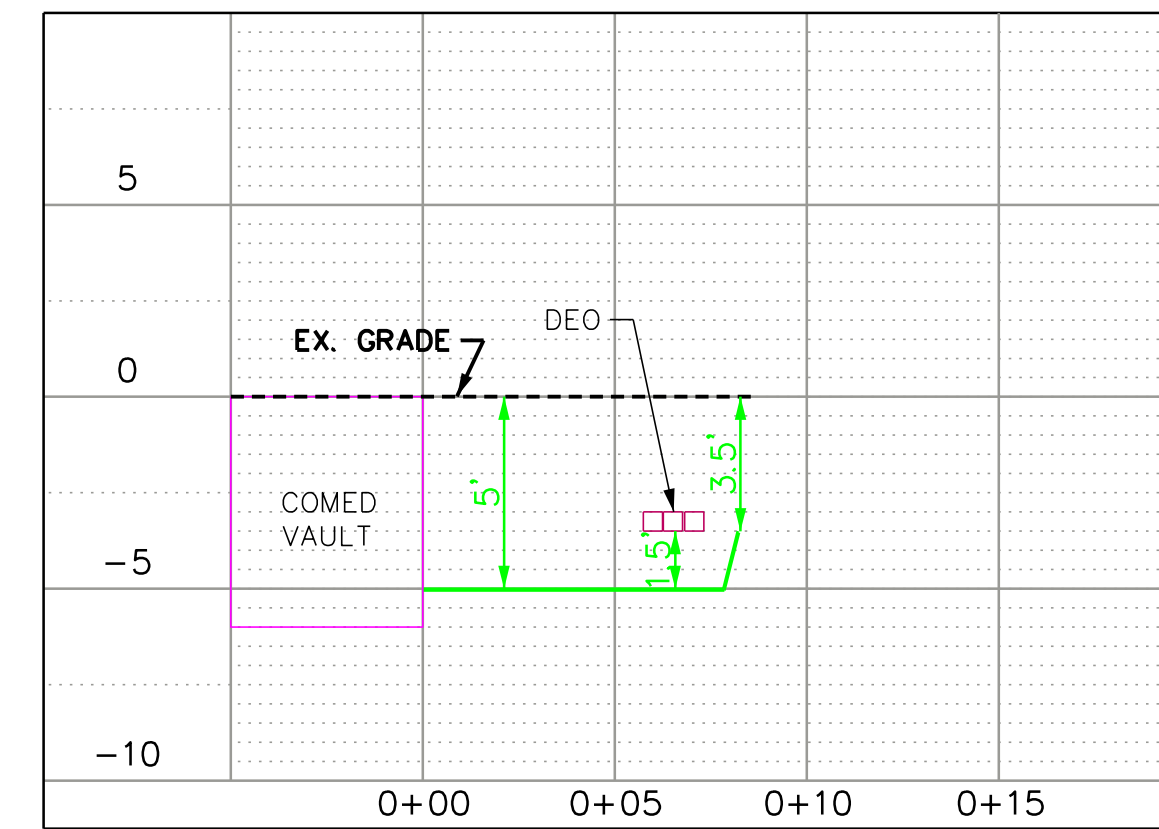

PROFILE B  
E. ILLINOIS ST.  
FROM: STA. 0+8.5 TO STA. 0+20

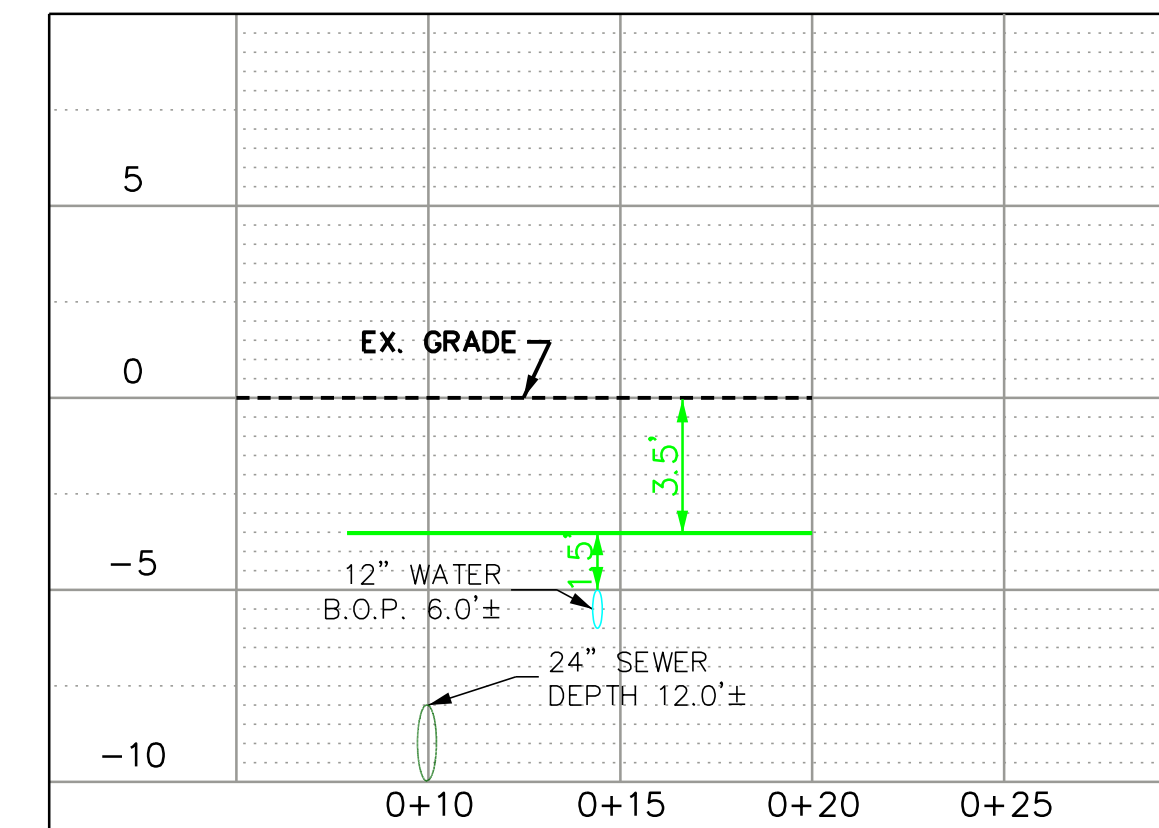

CONTRACTOR TO COORDINATE WITH BUILDING OWNER REGARDING CONSTRUCTION SCHEDULE AND TO VERIFY NO VAULTED SIDEWALK IS PRESENT AT PROPOSED POLE LOCATION.

NOTE:  
CONTRACTOR TO USE EXTREME CAUTION WHEN CROSSING OVER THE 12" WATER MAIN IN N. ILLINOIS ST. SEE WATER DEPT GENERAL NOTE ON SHEET 2

NOTE:  
MOBILITIE EQUIPMENT TO BE PAINTED BLACK.

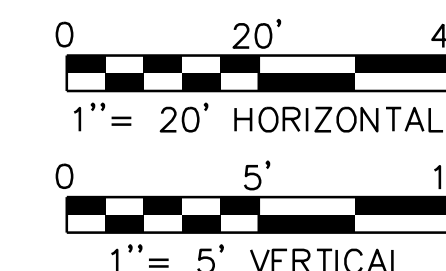

**PROFESSIONAL LICENSURE**



3/28/2018

**REVISIONS**

ISSUED FOR OUC REVIEW - 3/28/2018

SHEET TITLE:  
**SITE PLAN**

DRAWN BY: CBF

CHECKED BY: HJM

DATE: 3/28/2018

PROJECT: DASC CH90XSA77F (OUC# 2018-81318)

TITLE: 588 E ILLINOIS ST

SCALE: AS SHOWN PAGE: **4.0** OF: **18.0**

## Gamma Survey Results

588 E. Illinois St.

Lyons-Pinner

DOT949398

### Survey Equipment

Ludlum 2221 S/N:	172039
Probe 2x2 NaI S/N:	PR179406
shielded cutoff (long cable):	6,669 cpm (6,456 cpm)
background:	-
Personnel:	D. Domino
Date of Screening:	8.18.18
Permit #:	DOT949398

### Survey Results

Location	Depth (inches)	Readings (CPM)
1	0	concrete
	6	1800 - 2500
2	0	concrete
	6	1800 - 2500
	24	1800 - 2000
3	0	concrete
	6	1800 - 2500*
	24	2000 - 2500*
	60	2200 - 3300*
	78	2200 - 4000*
	114	3400 - 3500*

Note: \* - long cable