



AECOM  
100 S. Wacker Drive, Suite 500  
Chicago, Illinois 60606

312-939-1000 tel  
312-939-4198 fax

July 2, 2018

Mr. Mike Jouras  
Peoples Gas Light & Coke Co.  
Environmental Services Department  
200 E. Randolph Street, 24<sup>th</sup> Floor  
Chicago, IL 60601

RE: New Gas Service Installation – 335-360 E. Sub-Wacker Dr.  
Permit No.: DOT951995  
Permit Address: 335-60 E. Sub-Wacker Dr., Chicago, Illinois  
AECOM Project No. 60157647

Dear Mr. Jouras:

Pursuant to conditions specified in a permit (see attached) issued by the City of Chicago, radiation monitoring was required to be performed at the above referenced site. AECOM Technical Services, Inc. (AECOM) provided the required radiation surveillance on June 7, 2018 during a trench excavation for the installation of new gas service.

Surveying was performed on the fill removed at 335-60 E. Sub-Wacker Drive required to address a new gas service line installation. The work consisted of a single trench excavation approximately 40-feet long by 3-feet wide, and excavated to a depth of approximately 36-inches below ground surface (bgs). See attached sketch for the location of the excavations.

The monitoring did not indicate that the fill soils were above the removal action level established by the U.S. Environmental Protection Agency (USEPA) for the Streeterville area of Chicago. The USEPA removal action level for Chicago's Streeterville area is 7.1 picocuries per gram (pCi/g) total radium (Ra-226 + Ra-228). Gamma radiation count measurements for the project were recorded using Ludlum Models 2221 survey meter and an unshielded 2 x 2 inch NaI probe (Model 44-10). For the instrument used, the gamma count threshold indicative of the 7.1 pCi/g removal action level is 6,367 (S/N: 176944) counts per minute (cpm) shielded. Background measured in the vicinity of the excavations was 1,200 cpm shielded.

The field gamma measurements within the excavations during the excavation process did not exceed the instrument threshold previously stated, and ranged from a minimum of 1,200 cpm to a maximum of 3,500 cpm shielded. The general subsurface stratigraphy during the excavation was composed of tan fill sand and urban fill. Based on field observations there was no indication of the presence of radiologically-contaminated fill and/or an exceedance of the USEPA removal action level of 7.1 pCi/g total radium. A copy of the permit and a field sketch documenting the area where work was performed, have been included as attachments.

As part of the permit conditions, this letter has been forwarded to:

Chicago Department of Public Health  
Attention: Mr. Terry Sheahan  
333 South State Street, Room 200  
Chicago, Illinois 60604

Permit No.: DOT951995  
Permit Address: 335-60 E. Sub-Wacker Dr.  
Page 2

Please contact us with any questions you have regarding this letter or the reported results.

Regards,



Andrew Kozak  
Geologist



Steven C. Kornder, Ph.D.  
Senior Project Geochemist

cc: Terry Sheahan, Chicago Department of Public Health  
Verneta Simon, USEPA

Attachments: Permit  
Sketch and Results

**PERMIT**



DEPARTMENT OF PUBLIC HEALTH  
CITY OF CHICAGO

**FORM NO. CDPH.ROW.03 (STREETERVILLE Right-of-Way)**

Notice is hereby given that the site you have requested a permit for is recorded with the City of Chicago Department of Public Health (CDPH) as potentially having environmental contamination on the site and adjacent right-of way. This environmental contamination could present a threat to human health and safety in connection with work performed at the site, or in the adjacent right-of-way, if proper safeguards are not employed.

A file containing detailed information regarding the aforementioned environmental contamination is available for review at CDPH at 333 S. State St., Room 200, Chicago, Illinois 60604 during normal business hours (8:30AM-4:30PM, Monday through Friday). Contact (312) 745-3152 for an appointment. This file must be reviewed and the remainder of this form completed before the permit can be issued if the ground is exposed or excavated. **Please note that for some locations, additional health and safety procedures may be required by law.**

Please complete the following:

I have reviewed and understand the documents, maintained by CDPH, regarding environmental contamination of the site and adjacent right-of-way. Further, I will ensure that all work at the subject site and adjacent right-of-way, and any monitoring required including but not limited to radiation monitoring, will be performed in a manner that is protective of human health and the environment and in compliance with all applicable local, state, and federal laws, rules, and regulations, especially those pertaining to worker safety and waste management. I will ensure that the results of any radiation monitoring and/or surveying conducted shall be provided to the CDPH and the United States Environmental Protection Agency **within two (2) weeks of their completion**. If any elevated levels of radioactive material are detected, I will immediately contact the United States Environmental Protection Agency at (800) 424-8802.

Applicant Name (print): Maria G. Oliver Signature: Maria G. Oliver

Site Address and Work Location (Describe exact site location and attach map): 335-360 E Wacker Sub Drive

Nature of Work: New Service Installation

Company Name, Address, Phone No.: Peoples Gas, 200 E Randolph (312) 240-4692

General / Prime Contractor Name, Address, Phone No.: Bob Anderson (773) 475-3654

Include subcontractor information if applicable  
Safety Officer / Phone No. Liveida Monsalve (773) 794-6869

Radiation Contractor / Phone No. (if applicable) Steve Koruder AECOM, Inc (262) 515-7700

Check if City Department Work  Department Name: \_\_\_\_\_

CDOT Permit No.: DDT951995

Today's Date: 5/17/18 Expected Start Date: 5/29/18 CDPH Approval / Date: J Sheehan 5-18-18

Please return this completed form to the Chicago Department of Transportation, Division of Infrastructure Management, Public Way Permit Office, City Hall - Room 905, 121 N. LaSalle St., Chicago, Illinois 60602 during normal business hours (8:30 AM - 4:30 PM, Monday through Friday)

**For CDPH Use Only**

355 E. Wacker. New  
Service installation from 8"  
Gas main in E. Wacker sub  
Drive. 50'x4'x4' trench at  
500' EE lower Columbus Dr.

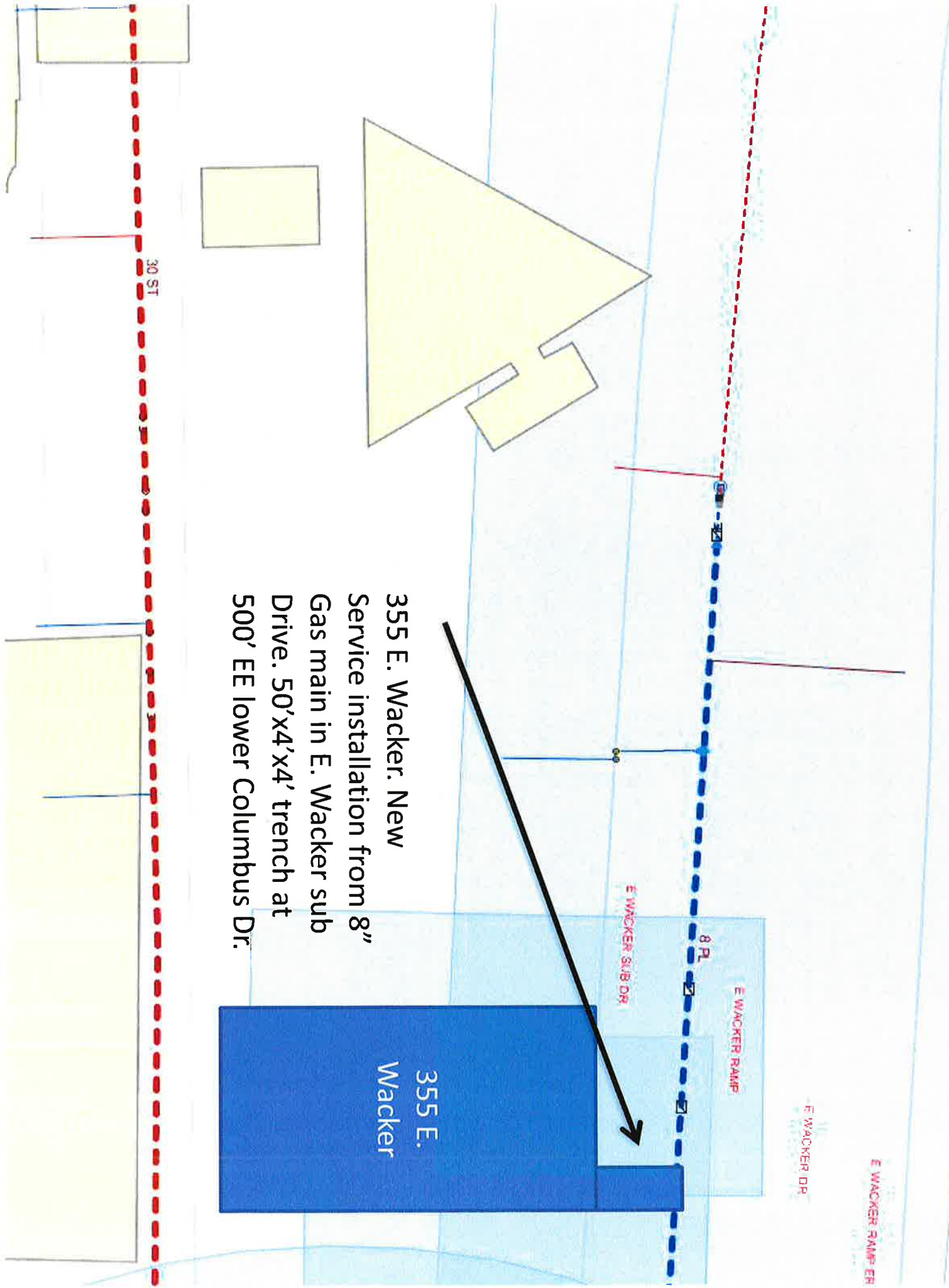

## SKETCH AND RESULTS

JOB TITLE People's Gas - 335-360 E. Sub-Wacker Dr.  
JOB NO. 60157647.99 CALCULATION NO. \_\_\_\_\_  
ORIGINATOR A. Kozak DATE 6/7/18  
REVIEWER S. Kotuder DATE 6/18/18  
SCALE \_\_\_\_\_ SHEET NO. 1 OF 1

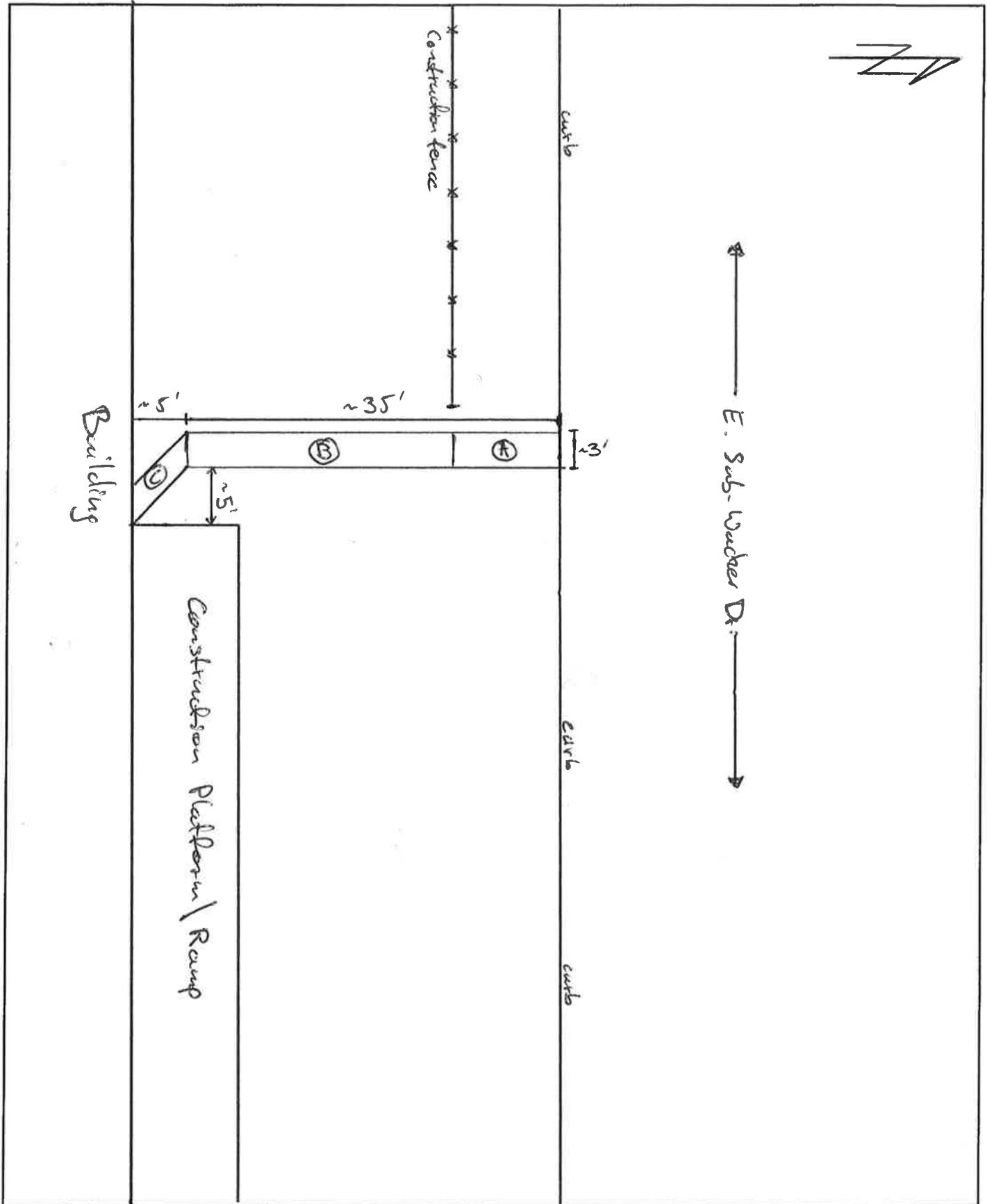

**Survey Results**  
**335-60 E Sub Wacker Dr.**  
**Peoples Gas**

**Survey Equipment**

Ludlum 2221 S/N:	176944
Probe 2x2 NaI S/N:	RN21187
shielded:	6,367 cpm
background:	1,200 cpm
Personnel:	D. Domino
Date of Screening:	6.7.18

**Survey Results**

Section	Depth (inches)	Readings (CPM)
A	0	Pavement
	18	1,200
	36	3,500
B	0	Pavement
	18	1,400
	36	2,400
C	0	Pavement
	18	1,300
	36	1,200