



AECOM
100 S. Wacker Drive, Suite 500
Chicago, Illinois 60606

312-939-1000 tel
312-939-4198 fax

December 11, 2017

Ms. Sandra Rubio
AT&T
2427 Union Street,
Blue Island, IL 60406

RE: New Service Installation – 301-15 E. Illinois St.
Permit No.: DOT881483
Permit Address: 301-15 East Illinois Street, Chicago, Illinois
AECOM Project No. 60163572

Dear Ms. Rubio:

Pursuant to conditions specified in a permit (see attached) issued by the City of Chicago, radiation monitoring was required to be performed at the above referenced site. AECOM Technical Services, Inc. (AECOM) provided the required radiation surveillance on November 9 and 10, 2017 for a trench excavation for the installation of new service.

Surveying was performed on the soil removed at 301-15 E. Illinois Street (see sketch) required to address the new service. The work consisted of two trench excavations. The first excavation was excavated to approximately 36 inches below ground surface (bgs) at the east end, sloping to 54 inches bgs to the west. The second excavation was sloping from 24 inches bgs at the north, to 48 inches bgs to the south. See attached sketch for the location of each excavation.

The monitoring did not indicate that the fill soils were above the removal action level established by the U.S. Environmental Protection Agency (USEPA) for the Streeterville area of Chicago. The USEPA removal action level for Chicago's Streeterville area is 7.1 picocuries per gram (pCi/g) total radium (Ra-226 + Ra-228). Gamma radiation count measurements for the project were recorded using Ludlum Models 2221 survey meter and an shielded 2 x 2 inch NaI probe (Model 44-10). For the instrument used, the gamma count threshold indicative of the 7.1 pCi/g removal action level is 7,374 (S/N: 172039) counts per minute (cpm) shielded.

The field gamma measurements within the excavation during the excavation process did not exceed the instrument threshold previously stated, and ranged from a minimum of 800 cpm to a maximum of 2,800 cpm shielded. The general subsurface stratigraphy was composed of urban fill and gravel. Based on field observations there was no indication of the presence of radiologically-contaminated fill and/or an exceedance of the USEPA removal action level of 7.1 pCi/g total radium. A copy of the permit and a field sketch documenting the area where work was performed, have been included as attachments.

As part of the permit conditions, this letter has been forwarded to:

Chicago Department of Public Health
Attention: Mr. Terry Sheahan
333 South State Street, Room 200
Chicago, Illinois 60604

Permit No.: DOT881443
Permit Address: 301-15 East Illinois Street
Page 2

Please contact us with any questions you have regarding this letter or the reported results.

Regards,



Kyle Korczak
Geologist



Steven C. Kornder, Ph.D.
Senior Project Geochemist

cc: Terry Sheahan, Chicago Department of Public Health
Verneta Simon, USEPA

Attachments: Permit
Sketch

PERMIT



DEPARTMENT OF PUBLIC HEALTH
CITY OF CHICAGO

(STREETERVILLE Right-of-Way)

Notice is hereby given that the site you have requested a permit for is recorded with the City of Chicago Department of Public Health (CDPH) as potentially having environmental contamination on the site and adjacent right-of-way. This environmental contamination could present a threat to human health and safety in connection with work performed at the site, or in the adjacent right-of-way, if proper safeguards are not employed.

A file containing detailed information regarding the aforementioned environmental contamination is available for review at CDPH at 333 S. State St., Room 200, Chicago, Illinois 60604 during normal business hours (8:30AM-4:30PM, Monday through Friday). Contact (312) 745-3152 for an appointment. This file must be reviewed and the remainder of this form completed before the permit can be issued if the ground is exposed or excavated. **Please note that for some locations, additional health and safety procedures may be required by law.**

Please complete the following:

I have reviewed and understand the documents, maintained by CDPH, regarding environmental contamination of the site and adjacent right-of-way. Further, I will ensure that all work at the subject site and adjacent right-of-way, and any monitoring required including but not limited to radiation monitoring, will be performed in a manner that is protective of human health and the environment and in compliance with all applicable local, state, and federal laws, rules, and regulations, especially those pertaining to worker safety and waste management. I will ensure that the results of any radiation monitoring and/or surveying conducted shall be provided to the CDPH and the United States Environmental Protection Agency within two (2) weeks of their completion. If any elevated levels of radioactive material are detected, I will immediately contact the United States Environmental Protection Agency at (800) 424-8802.

Applicant Name (print): Stephen Thomas Signature: [Signature]

Site Address and Work Location (Describe exact site location and attach map): 305-307 E. Illinois St
474-479 N. Park Dr

Nature of Work: Install new conduit to connect to customer. Conduit

Company Name, Address, Phone No.: AT+T 211 W. Randolph Chicago, IL (312) 977-7139

General / Prime Contractor Name, Address, Phone No.: ARCHON Construction Co. Inc 563 S. Route 53
Include subcontractor information if applicable Addison, IL 60101 (630) 495-0015

Safety Officer / Phone No. _____

Radiation Contractor / Phone No. and email address (if applicable) AECOM (312) 373-7700 | Steve.Kornder@aecom.com

Check if City Department Work Department Name: _____

CDOT Permit No.: DOT 881483

Today's Date: 11/1/2017 Expected Start Date: 11-7-17 CDPH Approval / Date: [Signature] 11-1-17

Please return this completed form to the Chicago Department of Transportation, Division of Infrastructure Management, Public Way Permit Office, City Hall - Room 905, 121 N. LaSalle St., Chicago, Illinois 60602 during normal business hours (8:30 AM - 4:30 PM, Monday through Friday)

For CDPH Use Only

PLAN/PROFILE

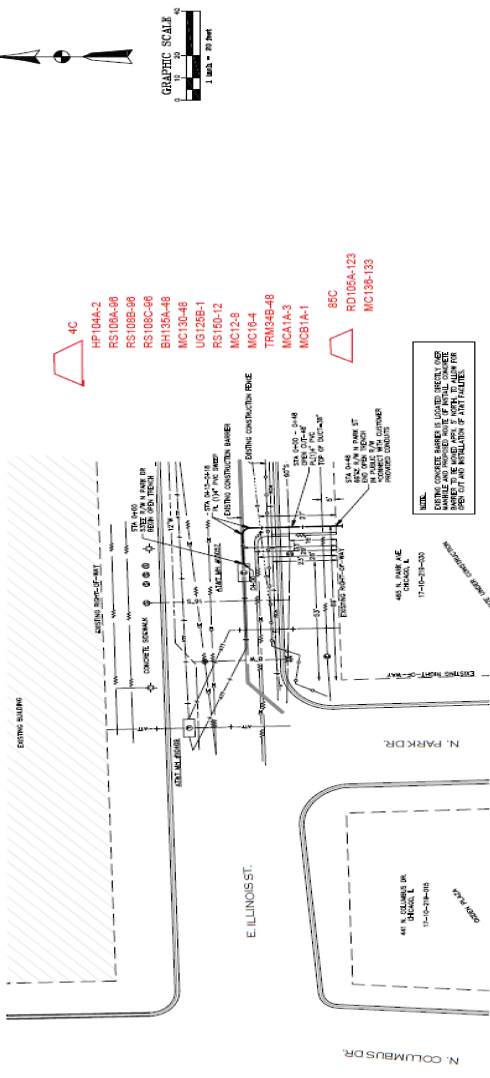

- 4C
- HP1044-2
- RS1084-98
- RS1085-98
- RS1086-98
- BH1354-48
- MC1304-48
- UG125B-1
- RS105-12
- MC12-8
- TRM348-48
- MCA1A-3
- MCB1A-1
- 88C
- RD105A-123
- MC136-133

NOTE: ALL DIMENSIONS ARE IN FEET UNLESS OTHERWISE NOTED. ALL DIMENSIONS ARE TO FACE UNLESS OTHERWISE NOTED. ALL DIMENSIONS ARE TO FACE UNLESS OTHERWISE NOTED. ALL DIMENSIONS ARE TO FACE UNLESS OTHERWISE NOTED.

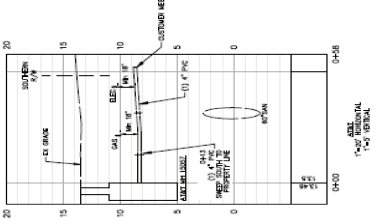

JOB SUMMARY

- MANHOLE ACCESS REQUIRED ON E. ILLINOIS AND N. PARK DR (MH 15057)
- CORE DRILL ON THE EAST SIDE CONCRETE WALL OF MH 15057
- DIG PIT AT NORTH WALL OF BUILDING FOUNDATION
- DIG PIT ON THE EAST SIDE OF MH 15057
- RESTORE CONCRETE TO GRADE, DEVELOPER RESPONSIBLE FOR RESTORING STREET
- ROD AND ROPE 123' FROM MH TO TRASH ROOM

		PROJECT: 465 N PARK ST DRAWING: 1000 CONDUIT DRIVE CONTRACT NO.: DAMBOUR, ILLINOIS 60523
DATE: 07/29/2017 CHECKED: [Signature] DESIGNED: [Signature]	DATE: 07/29/2017 CHECKED: [Signature] DESIGNED: [Signature]	DATE: 07/29/2017 CHECKED: [Signature] DESIGNED: [Signature]

E. ILLINOIS	N. PARK DR
N. COLUMBUS DR	E. NORTH WATER ST

- 88C
- 123 BLOW OR HAND ROD IN VACAN
- 133 1 1/4" InnerRadius
- 4C
- 2 HAND DIG PIT - EXISTING C
- 96 SAW CUT, REMOVE & RESTORE
- 96 SAW CUT, REMOVE & RESTORE
- 48 TRENCH & PLACE ONE ITEM -
- 1 CORE DRILLING TO ACCEPT U
- 12 HAUL & DISPOSE OF SPOIL D
- 8 Premium Gravel
- 48 PLACE CONCRETE ENCASING -
- 3 Finishing Atrows
- 1 Barricade Type II w/ flas

A

T-BUG TESTING REQD FOR ALL DIGITAL SERVICES

PROJECT #	DATE SVC REQD		
A00ZCOF	11/15/2017		
PROJECT TITLE: FFTP- PSA 2028PH -465 PARK DR			
DA	GEO LOC	NPANX	WC
2028PH	Q12970	312222	id
CITY: CHICAGO			
PRIMARY ENGR. ID: LW621F TELEPHONE # 3129777139			
PRIMARY ENGR. NAME: WILLIS, LEANDRE L			
CONTRACTOR NAME:			
REVISION NOTES:			

REV. DATE:	PERMIT REQ'D.	Y
PRINT	1	OF 1

AT&T Proprietary (Internal Use Only.) Not for use or disclosure outside of AT&T companies except under written agreement.

SKETCH

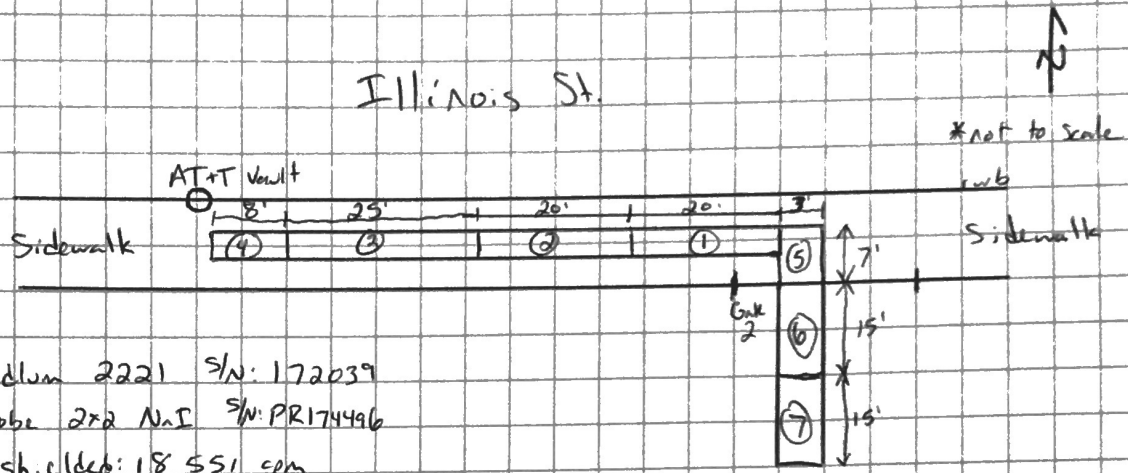

Ludlum 2221 S/N: 172039
 Probe 272 N.I S/N: PR17446
 unshielded: 18,551 cpm
 shielded: 7,374 cpm
 background: 1,400 cpm

Depth	CPM
① 0-12"	concrete
12-36" (spoil)	1,100-1,900
② 0-12"	concrete
12-36" (spoil)	1,200-2,000
③ 0-12"	concrete
12-36" (spoil)	1,200-2,800
④ 0-12"	concrete
12-54" (spoil)	1,100-2,000
⑤ 0-12"	concrete
12-24" (spoil)	1,000-1,600
⑥ 0-12"	concrete
12-36" (spoil)	800-1,700
⑦ 0-12"	concrete
12-48" (spoil)	1,000-2,000