



AECOM
100 S. Wacker Drive, Suite 500
Chicago, Illinois 60606

312-939-1000 tel
312-939-4198 fax

October 13, 2016

Mike Jouras
Peoples Gas Light & Coke Co.
Environmental Services Department
200 E. Randolph Street, 24th Floor
Chicago, IL 60601

RE: Radiological Survey of a Utility Service Relocation
Permit No.: DOT698102
Permit Address: 301-40 N. Field Blvd., Chicago, Illinois
AECOM Project No. 60157647.76

Dear Mr. Jouras:

Pursuant to conditions specified in a permit (see attached) issued by the City of Chicago, radiation monitoring was required to be performed at the above referenced site. AECOM Technical Services, Inc. (AECOM) provided the required radiation surveillance between September 15 and October 12, 2016 for excavation related to relocation a utility service line.

Surveying was performed within the excavations and on the spoil removed at 301-40 N. Field Blvd. (refer to sketch). The excavation was composed of three trenches; two of the trenches within N. Field Blvd and one trench near the intersection of Sub-Lower Wacker Drive and N. Field Blvd. The two separate trenches within N. Field Blvd. were approximately 140-feet and 60-feet in length with varying depths of 36 to 114-inches below ground surface (bgs). The trench near the intersection of N. Field Blvd. and Lower-Lower Wacker Dr. was approximately 6-feet wide by 12-feet long, to a depth of 3-feet bgs.

The monitoring did not indicate that the fill soils were above the removal action level established by the U.S. Environmental Protection Agency (USEPA) for the Streeterville area of Chicago. The USEPA removal action level for Chicago's Streeterville area is 7.1 picocuries per gram (pCi/g) total radium (Ra-226 + Ra-228). Gamma radiation count measurements for the project were recorded using Ludlum Models 2221 survey meter and an unshielded 2 x 2 inch NaI probe (Model 44-10). For the instrument used, the gamma count threshold indicative of the 7.1 pCi/g removal action level is 17,253 (S/N: 172039) counts per minute (cpm) unshielded.

The field gamma measurements within the excavations and of the spoil during the excavation process did not exceed the instrument threshold previously stated and predominantly ranged from a minimum of 3,000 cpm to a maximum of 10,000 cpm unshielded. A few anomalous readings were recorded within the western trench of N. Field Blvd., with trench readings up to 14,300. Based on field observations there was no indication of the presence of radiologically-contaminated fill and/or an exceedance of the USEPA removal action level of 7.1 pCi/g total radium. A copy of the permit and a field sketch documenting the area where work was performed, have been included as attachments.

As part of the permit conditions, this letter has been forwarded to:

Chicago Department of Public Health
Attention: Ms. Rahmat Begum
333 South State Street, Room 200
Chicago, Illinois 60604

Permit No.: DOT698102
Permit Address: 301-40 N. Field Blvd.
Page 2

Please contact us with any questions you have regarding this letter or the reported results.

Regards,



Andrew Kozak
Geologist



Steven C. Kornder, Ph.D.
Senior Project Geochemist

cc: Rahmat Begum, Chicago Department of Public Health
Verneta Simon, USEPA

Attachments: Permit
Sketch

PERMIT



DEPARTMENT OF PUBLIC HEALTH
CITY OF CHICAGO

FORM NO. CDPH.ROW.03 (STREETERVILLE Right-of-Way)

Notice is hereby given that the site you have requested a permit for is recorded with the City of Chicago Department of Public Health (CDPH) as potentially having environmental contamination on the site and adjacent right-of-way. This environmental contamination could present a threat to human health and safety in connection with work performed at the site, or in the adjacent right-of-way, if proper safeguards are not employed.

A file containing detailed information regarding the aforementioned environmental contamination is available for review at CDPH at 333 S. State St., Room 200, Chicago, Illinois 60604 during normal business hours (8:30AM-4:30PM, Monday through Friday). Contact (312) 745-3152 for an appointment. This file must be reviewed and the remainder of this form completed before the permit can be issued if the ground is exposed or excavated. Please note that for some locations, additional health and safety procedures may be required by law.

Please complete the following:

I have reviewed and understand the documents, maintained by CDPH, regarding environmental contamination of the site and adjacent right-of-way. Further, I will ensure that all work at the subject site and adjacent right-of-way, and any monitoring required including but not limited to radiation monitoring, will be performed in a manner that is protective of human health and the environment and in compliance with all applicable local, state, and federal laws, rules, and regulations, especially those pertaining to worker safety and waste management. I will ensure that the results of any radiation monitoring and/or surveying conducted shall be provided to the CDPH and the United States Environmental Protection Agency within two (2) weeks of their completion. If any elevated levels of radioactive material are detected, I will immediately contact the United States Environmental Protection Agency at (800) 424-8802.

Applicant Name (print): Maria G. Oliver Signature: Maria G. Oliver

Site Address and Work Location (Describe exact site location and attach map): _____

301-40 N. Field Blvd.

Nature of Work: Gas Main Installation

Company Name, Address, Phone No.: Peoples Gas, 200 E. Randolph (312) 240-4692

General / Prime Contractor Name, Address, Phone No.: Mike Crosby (708) 243-7802

Include subcontractor information if applicable
Safety Officer / Phone No. Gerry Gross (773) 542-7927

Radiation Contractor / Phone No. (if applicable) Steve Konder, AECOM, Inc. (262) 515-7700

Check if City Department Work Department Name: _____

CDOT Permit No.: DOT698102

Today's Date: 9/6/16 Expected Start Date: 9/12/16 CDPH Approval / Date: J Sheahan 9/7/16

Please return this completed form to the Chicago Department of Transportation, Division of Infrastructure Management, Public Way Permit Office, City Hall - Room 905, 121 N. LaSalle St., Chicago, Illinois 60602 during normal business hours (8:30 AM - 4:30 PM, Monday through Friday)

For CDPH Use Only

INDEX OF SHEETS

DRAWING NO.	SHEET NO.	SHEET TITLE
C1	1	TITLE SHEET
C2	2	SIGNATURES AND SEALS
C3	3	GENERAL NOTES
C4	4	SYMBOLS AND SPECIFICATIONS
C5-C5A	5-6	INSTALLATION PLAN & PROFILES
RET1	7	RETIREMENT PLAN
R1	8	RESTORATION PLAN
R2	9	RESTORATION DETAILS
T1-T4	10-13	TRAFFIC CONTROL PLAN
T5-T6	14-15	TRAFFIC CONTROL STANDARDS

CENTRAL SHOP C-WANDA-01-PI-CN03189 PROPOSED 16" GAS MAIN INSTALLATION & RETIREMENT

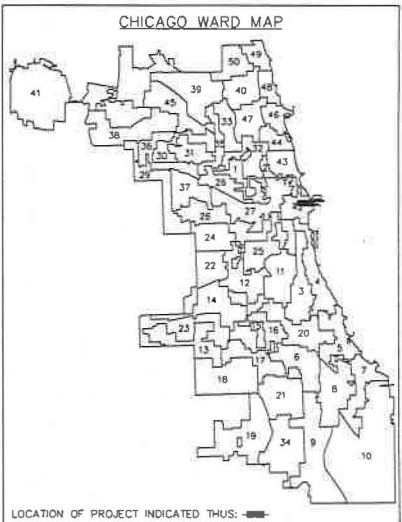

PROJECT DESCRIPTION AND SCOPE OF WORK:

INSTALL: 16" STMP GAS MAIN
RETIRE: 12" PLMP & 16" STMP GAS MAIN
LOCATION: N. FIELD BLVD. (E. SOUTH WATER ST. TO E. LOWER WACKER DR.)

STANDARDS

- DDOT RULES & REGULATIONS FOR CONSTRUCTION IN THE PUBLIC WAY
- CHAPTER 4.1.12 - EROSION & SITE CLEANLINESS
- APPENDIX B - ADA STANDARDS
- DDOT HIGHWAY STANDARDS #
- 701501-06
- 701701-10
- 701801-06
- 701901-05

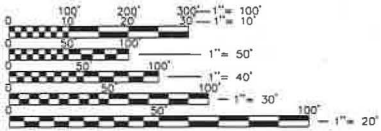
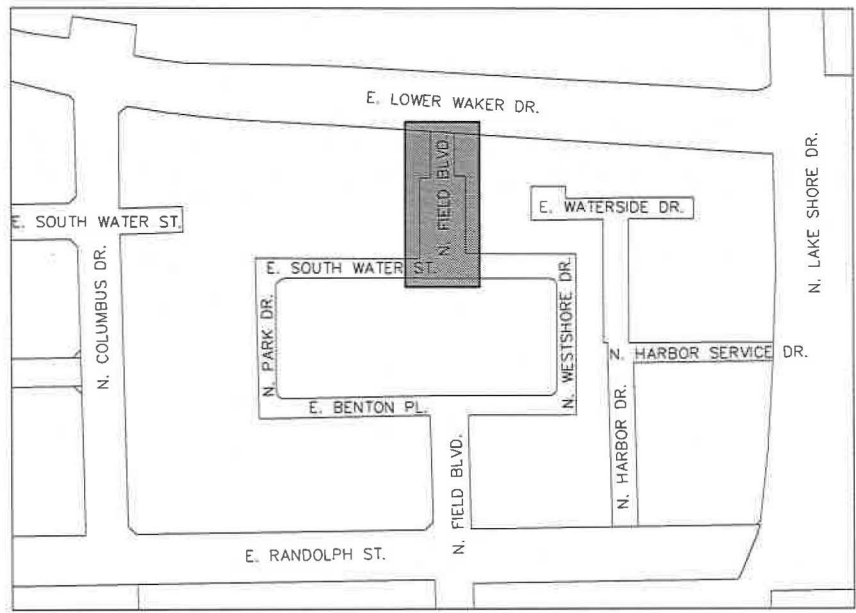

FULL SIZE PLANS HAVE BEEN PREPARED USING STANDARD ENGINEERING SCALES. REDUCED SIZED PLANS WILL NOT CONFORM TO STANDARD SCALES. IN MAKING MEASUREMENTS ON REDUCED PLANS, THE ABOVE SCALES MAY BE USED.

LOCATION MAP (N.T.S.)

16" STMP GAS MAIN
12" PLMP GAS MAIN
16" STMP GAS MAIN
REQUIRE APPROX 27 FT. OF 12" PLMP GAS MAIN
REQUIRE APPROX 230 FT. OF 16" STMP GAS MAIN
NUMBER OF ADA RAMP REPLACEMENTS = 0

DIGGER: 312-744-7000
CONTRACTOR SHALL CALL DIGGER TWO (2) WORKING DAYS (48 HOURS) BEFORE DIGGING.

GAS MAIN RETIREMENT & INSTALLATION

REQUIRE APPROX 27 FT. OF 12" PLMP GAS MAIN
REQUIRE APPROX 230 FT. OF 16" STMP GAS MAIN
NUMBER OF ADA RAMP REPLACEMENTS = 0

REVISION NO.	BY NO.	DATE	SHEET NO.	STATUS

ENGINEERING CONSULTANT: 28100 TORCH PARKWAY WESTBROOK, IL 60090 TEL: 815-383-7999 FAX: 815-383-7999 WWW.ENGINEERING.COM	DESIGNED BY: LD	DATE: 07-14-2016	REV: 07-14-2016	BY: ENE	BY: 5.6	ADDED ATT SAC NOTE.
	DRAWN BY: JR					
	CHECKED BY: LD					
	DATE: 07-14-2016	REV: 07-14-2016	BY: ENE	BY: 5.6		
SCALE: N.T.S.						

PEOPLES GAS
NATURAL GAS DELIVERY

CENTRAL SHOP
C-WANDA-01-PI-CN03189
PROPOSED 16" GAS MAIN
INSTALLATION & RETIREMENT
TITLE SHEET

DP PROJECT NUMBER	NON-DP PROJECT NUMBER	0017016063
DP BCA NUMBER	NON-DP BCA NUMBER	3199
DP WR NUMBER	NON-DP WR NUMBER	2199521
	DRAWING NO.	
	SHEET NO.	
DUC NUMBER	2016-21792	
		1 OF 15

CHICAGO, IL

SKETCH

Equipment

Ludlum 2221 S/N: 172039
 Probe 2x2 NaI S/N: 174496
 unshielded: 17,253 cpm
 shielded: 7,018 cpm
 background: 8,400 cpm
 personnel: A. Kozak

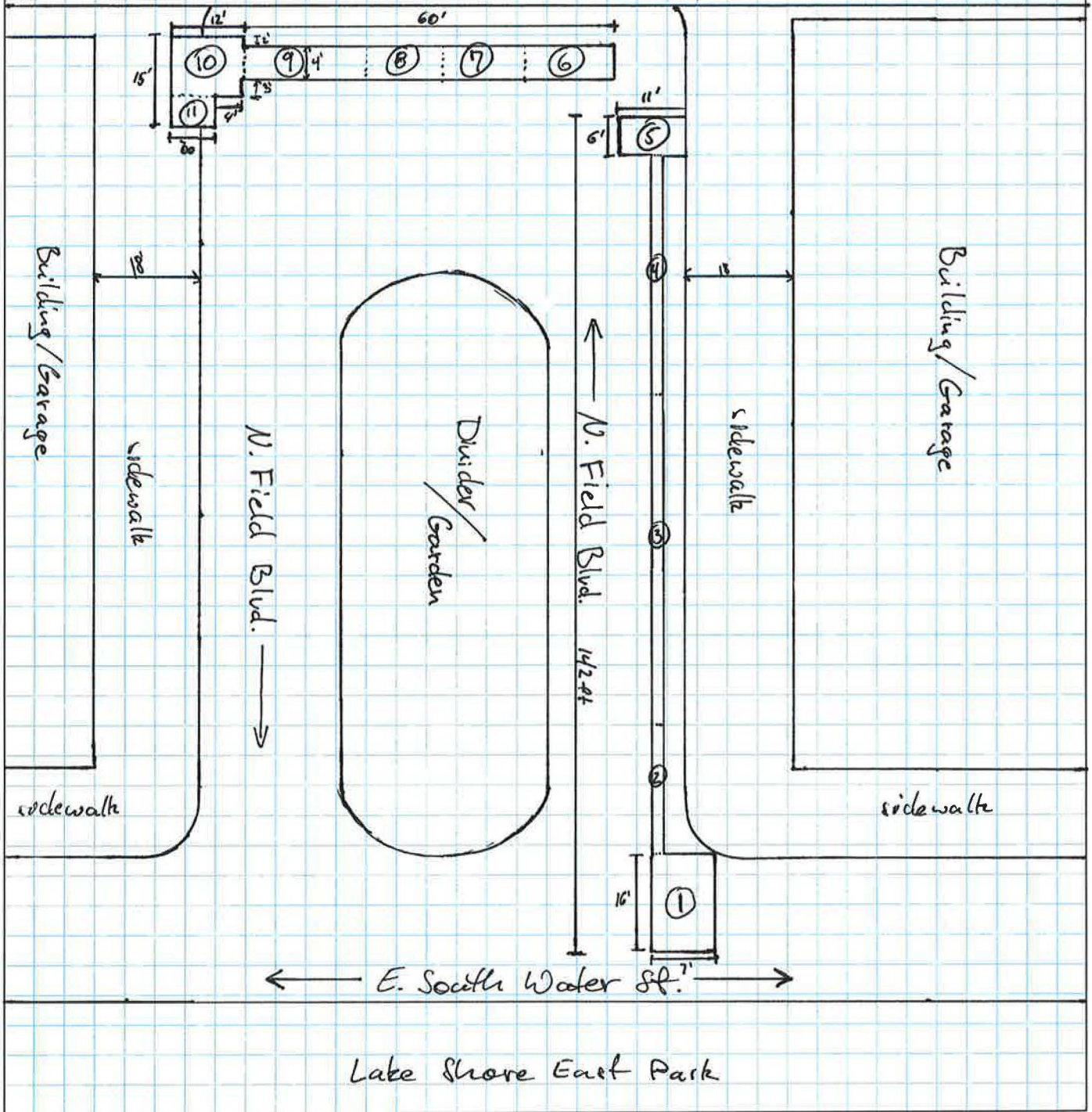

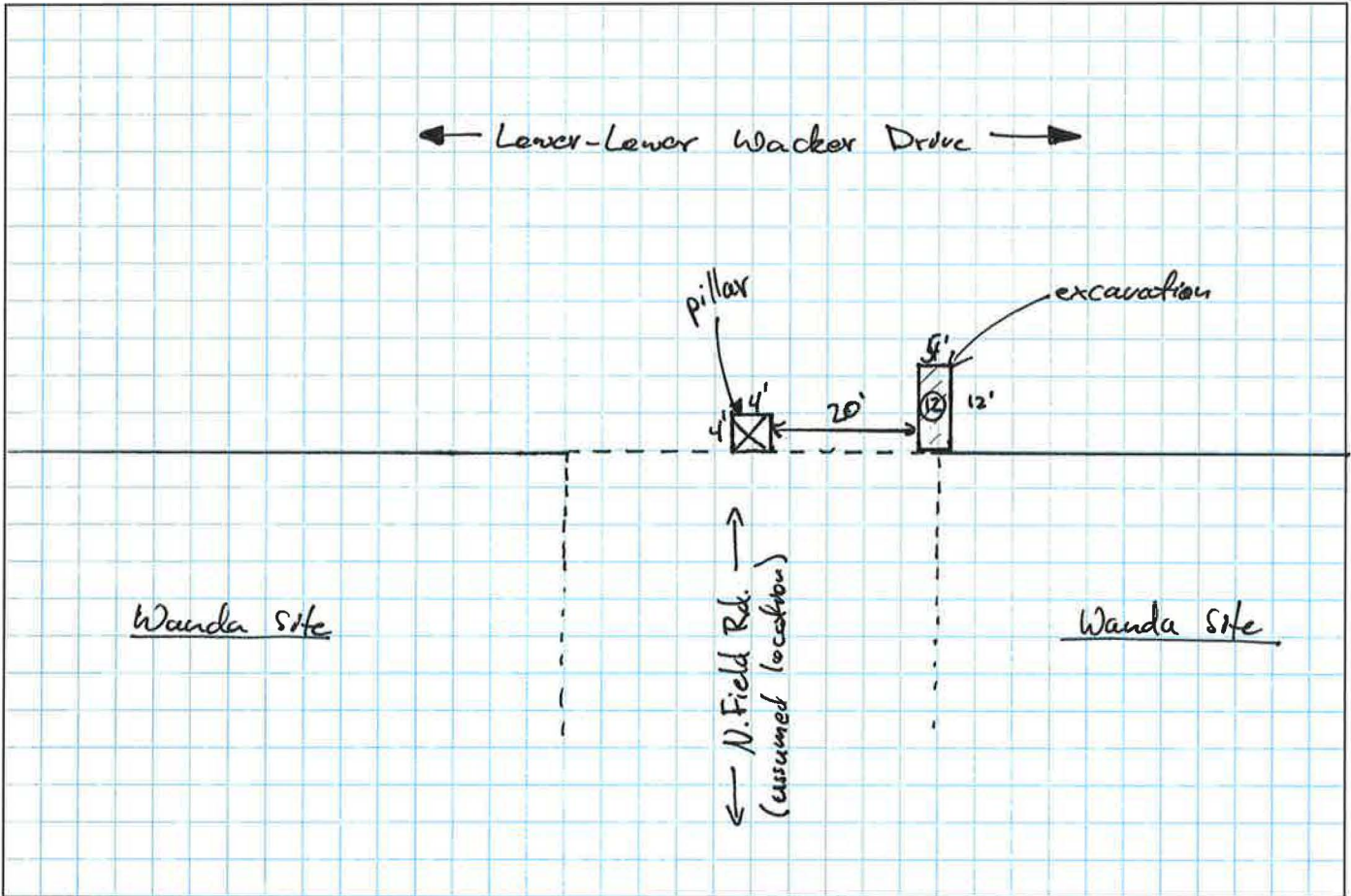

Readings (surface reading not recorded as it was asphalt)

Depth	CPM
① surface	—
16" (beneath concrete)	6,400 - 7,200
30"	5,500 - 8,600
45"	6,500 - 9,200
45"-69" (spoil)	3,400 - 5,000
② 16"	5,600 - 6,400
16"-45" (spoil)	7,200 - 8,700
③ 16"	5,000 - 5,600
36" (stone)	4,400 - 6,400
④ 16"	4,400 - 6,000
16"-36"	8,100 - 10,700
⑤ 16"	5,400 - 6,400
16"-60" (spoil)	4,700 - 6,000
⑥ 16"	3,200 - 4,400
16"-48"	4,000 - 5,100
48"-102"	6,000 - 7,700
102"	8,800 - 10,900

Depth	CPM
⑦ 16"	4,000 - 5,100
16"-48" (spoil)	3,600 - 4,800
48"-102"	8,500 - 9,200
102" (floor)	8,700 - 9,700
⑧ 16"	3,600 - 5,000
16"-48"	4,700 - 6,000
48"-102"	4,100 - 7,000
102" (floor)	7,400 - 8,700
⑨ 16"	3,000 - 4,800
16"-48"	6,200 - 7,100
68"	8,600 - 9,700
84"	10,200 - 10,600
102"	11,100 - 11,700
⑩ 16"-60" (sand)	4,300 - 5,300
78"	11,200 - 13,400
96"	10,700 - 12,400
114"	12,000 - 14,300

- ⑪ 16"-102" (spoil/sand) 4,400 - 7,600
- ⑫ 16"-54" (spoil/sand) 3,600 - 5,800