



AECOM
303 E. Wacker Drive, Suite 900
Chicago, Illinois 60601

312-938-0300 tel
312-938-1109 fax

January 14, 2013

Ms. Michele Pisterzi
AT&T Illinois
2427 Union Street
Blue Island, Illinois 60406

RE: Radiological Survey of Right-of-Way Utility Excavation
Permit No.: 281095832
Permit Address: 300-326 N. Columbus St.
AECOM Project No. 60163572

Dear Ms. Pisterzi:

Pursuant to conditions specified in a permit (see attached) issued by the City of Chicago, radiation monitoring was required to be performed at the above referenced site. AECOM Technical Services, Inc. (AECOM) provided the required radiation monitoring on December 21, 2012 for a trench excavation to remove and replace a communications utility pole and corresponding service line.

Surveying was conducted in 18-inch lifts for soils removed from an approximately 3-foot wide by 210-foot long trench excavation to a depth of 36-inches in the Right of Way (see sketch) required for the removal and replacement of a communications utility pole and corresponding service line. The monitoring revealed no indication of soils above the specified clean-up threshold established by the U.S. Environmental Protection Agency (USEPA) for the Streeterville area of Chicago. The USEPA threshold for Chicago's Streeterville area is 7.1 picocuries per gram (pCi/g total radium (Ra-226 + Ra-228)).

Gamma radiation count measurements for the project were made using a Ludlum Model 2221 survey meter and an unshielded 2 x 2 NaI probe (Model 44-10). For the instrument used, the gamma count indicative of the 7.1 pCi/g threshold was 17,920 counts per minute (cpm) unshielded (6,425 cpm shielded). The field gamma background for the area was measured at approximately 9,200 cpm unshielded. The field gamma measurements within the excavation and the spoil materials generated during the excavation process did not exceed the respective threshold values previously stated and ranged from a minimum of 10,900 cpm to a maximum of 12,300 cpm unshielded. Thus, there was no indication of the presence of radiologically-contaminated material and/or an exceedance of the USEPA cleanup threshold of 7.1 pCi/g total radium.

As part of the permit conditions this letter has been forwarded to:

Chicago Department of Public Health
Attn: Ms. Rahmat Begum
333 South State Street, Rm. 200
Chicago, Illinois 60604

Please contact us with any questions you have regarding this letter or the reported results.

Regards,

Joshua J. Rowe
Project Scientist II

Steven C. Kornder, Ph.D.
Senior Project Geoscientist

cc: Rahmat Begum, Chicago Department of Public Health
Verneta Simon, USEPA

Attachments: Permit
Sketch

281095832



DEPARTMENT OF PUBLIC HEALTH
CITY OF CHICAGO

FORM NO. CDPH.R0W.01

Notice is hereby given that the site you have requested a permit for is recorded with the City of Chicago Department of Public Health (CDPH) as potentially having environmental contamination on the site and adjacent right-of-way. This environmental contamination could present a threat to human health and safety in connection with work performed at the site, or in the adjacent right-of-way, if proper safeguards are not employed.

A file containing detailed information regarding the aforementioned environmental contamination is available for review at CDPH at 333 S. State St., Room 200, Chicago, Illinois 60604 during normal business hours (8:30AM-4:30PM, Monday through Friday). Contact (312) 745-3152 for an appointment. This file must be reviewed and the remainder of this form completed before the permit can be issued if the ground is exposed or excavated. Please note that for some locations, additional health and safety procedures may be required by law.

Please complete the following:

I have reviewed and understand the documents, maintained by CDPH, regarding environmental contamination of the site and adjacent right-of-way. Further, I will ensure that all work at the subject site and adjacent right-of-way, and any monitoring required including but not limited to petroleum contamination, will be performed in a manner that is protective of human health and the environment and in compliance with all applicable local, state, and federal laws, rules, and regulations, especially those pertaining to worker safety and waste management. I will ensure that the results of any radiation monitoring and/or surveying conducted shall be provided to CDPH within two (2) weeks of their completion.

Applicant Name (print): Michele Pistone Signature: Michele Pistone

Site Address and Work Location (Describe exact site location and attach map): 323 N Columbus Lower Dr

Nature of Work: Trench 45x2x4 in curb Traffic Lane

Company Name, Address, Phone No.: AT&T 2427 Union Blue Island IL 60404

General / Prime Contractor Name, Address, Phone No.: John Burns Const / Archon / Qualco

Include subcontractor information if applicable)

Safety Officer / Phone No.: Steve Kornder @ AECOM 847-279-2448

Check if City Department Work Department Name: _____

CDOT Permit No.: 281095832

Today's Date: 11/7/2012 Expected Start Date: ASAP

CDPH Approval / Date: Kahnatunisa Begum
11/7/2012

Please return this completed form to the Chicago Department of Transportation, Division of Infrastructure Management, Public Way Permit Office, City Hall - Room 905, 121 N. LaSalle St., Chicago, Illinois 60602 during normal business hours (8:30 AM - 4:30 PM, Monday through Friday)

For CDPH Use Only

Fax # 708-824-2808

300-326 N Columbus Lower Dr - AT&T
 project # 60163572
 originator: Joshua Rowe 11/01/13
 reviewer: Steve Kovader 11/01/13
 not to scale

meter S/N 176944
 cut off 17,920 cpm unshielded

TYPE OF STRUCTURE: STEEL COLUMN
 IS THE POLE DECORATIVE? YES OR NO
 OTHER EQUIPMENT ALREADY INSTALLED ON POLE? YES OR NO
 BASE OF POLE - BALLAST HOUSING: YES OR NO
 SIDE WALK VAULTED? YES OR NO
 NEAREST BLDG ADDRESS: 300 N LOWER COLUMBUS DR, CHICAGO, IL 60601
 COLOR OF POLE: SILVER

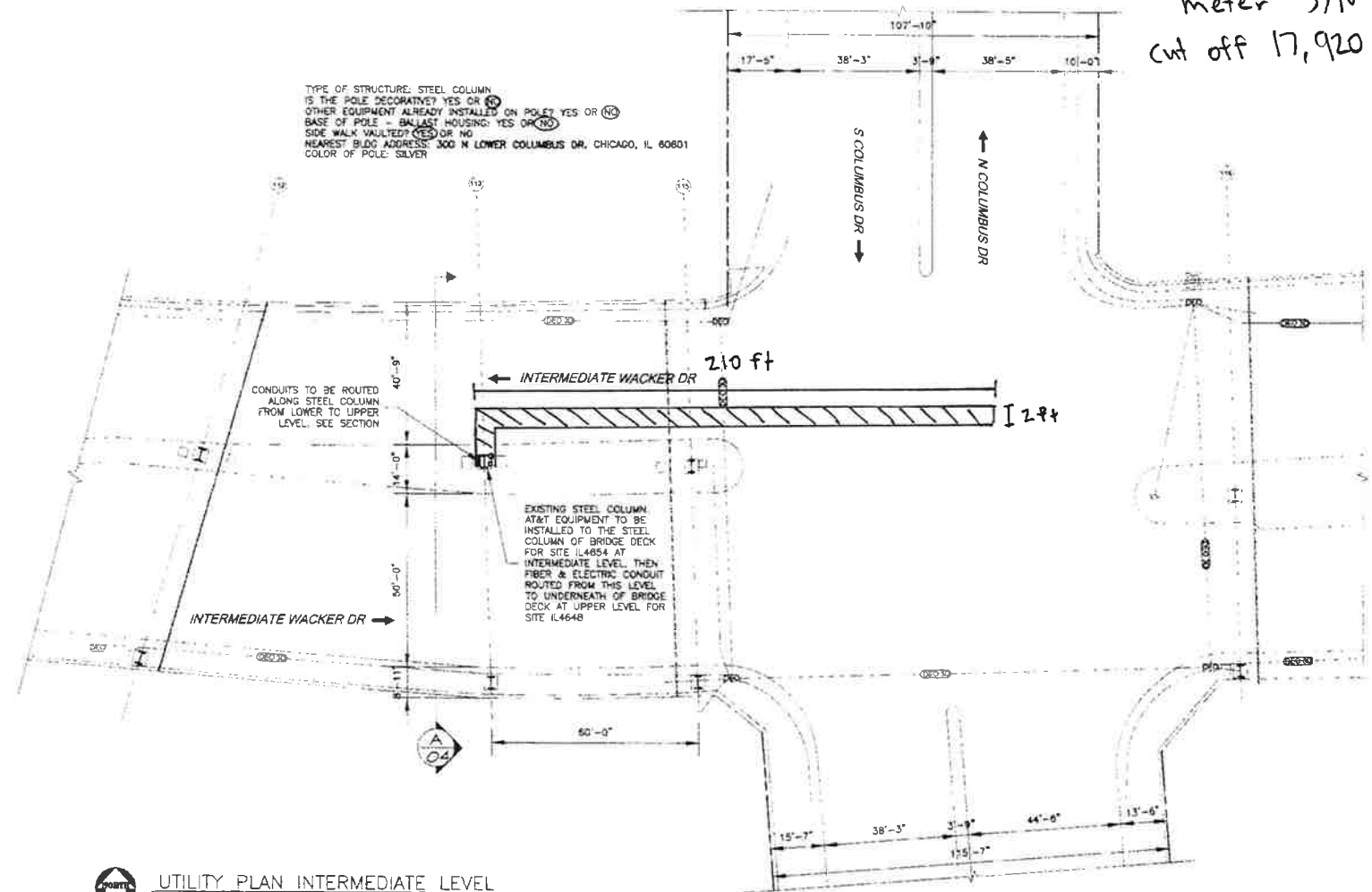

UTILITY PLAN INTERMEDIATE LEVEL
 SCALE: 1"=30'-0"

Copyright © Bechtel Corporation, 2011. Contains confidential information proprietary to Bechtel that is not to be used, shared, or reproduced in any format or medium without Bechtel's prior written permission. Notwithstanding the above, AT&T Mobility has the right to use the information contained in this document pursuant to Confidentiality Agreement dated 11/01/13 between Bechtel Corporation and AT&T Mobility, AT&T Mobility references.

BECHTEL
BECHTEL COMMUNICATIONS, Inc.
 1501 E WOODFIELD ROAD
 SCHALMBURG, IL 60173

Apex Engineers, Inc.
 Structural & Civil Engineers
 500 E. 22nd STREET
 LOMBARD, Illinois 60148
 Ph. (630) 627-1800
 Fax. (630) 627-1165
 APEX JOB No.AT11-0096-26

SITE NAME: LOWER COLUMBUS AVE & LOWER WACKER DRIVE
DAS #: IL4654
 300 N LOWER COLUMBUS DR.
 CHICAGO, IL 60601

at&t
 Mobility
 930 NATIONAL PARKWAY
 SCHALMBURG, IL 60173

3	06/06/13	ISSUED FOR CONSTRUCTION	RD	RS	RC
2	08/08/13	REVISED PER BECHTEL COMMENTS	RD	RS	RC
1	07/23/13	REVISED PER COMMENTS	RD	RS	RC
0	07/23/13	REVISED PER BECHTEL COMMENTS	RD	RS	RC
A	06/25/13	ISSUED FOR REVIEW	EW	RD	RC
NO.	DATE	REVISIONS	BY	CHK	APPV
SCALE: AS SHOWN		DESIGNED BY: DS	DRAWN BY: DS		

at&t
 UTILITY PLAN INTERMEDIATE LEVEL

JOB NUMBER	SCOPE	DRAWING NUMBER	REV
		IL4654-03	0