



AECOM
303 E. Wacker Drive, Suite 900
Chicago, Illinois 60601

312-938-0300 tel
312-938-1109 fax

March 13, 2012

Ms. Michele Pisterzi
AT&T Illinois
2427 Union Street
Blue Island, Illinois 60406

RE: Radiological Survey of Right-of-Way Utility Excavation
Permit No.: 254796001
Permit Address: 205 E. Grand Ave.
AECOM Project No. 60163572

Dear Ms. Pisterzi:

Pursuant to conditions specified in a permit (see attached) issued by the City of Chicago, radiation monitoring was required to be performed at the above referenced site. AECOM Technical Services, Inc. (AECOM) provided the required radiation monitoring on March 12-13, 2012 for a trench excavation to install a telephone communications service package.

Surveying was conducted in 18-inch lifts for soils removed from an approximately 4-foot wide by 8-foot long trench excavation to a depth of 42-inches in the Right of Way (see sketch), required for the installation of a telephone communications service package. The monitoring revealed no indication of soils above the specified clean-up threshold established by the U.S. Environmental Protection Agency (USEPA) for the Streeterville area of Chicago. The USEPA threshold for Chicago's Streeterville area is 7.1 picocuries per gram (pCi/g total radium (Ra-226 + Ra-228)).

Gamma radiation count measurements for the project were made using a Ludlum Model 2221 survey meter and an unshielded 2 x 2 NaI probe (Model 44-10). For the instrument used, the gamma count indicative of the 7.1 pCi/g threshold was 19,969 counts per minute (cpm) unshielded (7,127 cpm shielded). The field gamma background for the area was measured at approximately 6,700 cpm unshielded. The field gamma measurements within the excavation and of the spoil materials generated during the excavation process did not exceed the respective threshold values previously stated and ranged from a minimum of 7,600 cpm to a maximum of 8,600 cpm unshielded. Thus, there was no indication of the presence of radiologically-contaminated soil and/or an exceedance of the USEPA cleanup threshold of 7.1 pCi/g total radium.

As part of the permit conditions this letter has been forwarded to:

Chicago Department of Environment
Attention: Ms. Rahmat Begum
30 North LaSalle Street, 2nd Floor
Chicago, Illinois 60602

Please contact us with any questions you have regarding this letter or the reported results.

Regards,

Brian R. Schmidt
Project Scientist II

Steven C. Kornder, Ph.D.
Senior Project Geoscientist

cc: Rahmat Begum, Chicago Department of Environment
Verneta Simon, USEPA

Attachments: Permit
Sketch

US EPA RECORDS CENTER REGION 5



428137

Permit # 254796001

Radioactivity

CITY OF CHICAGO DEPARTMENT OF ENVIRONMENT
FORM NO. DOE.ROW.07

Notice is hereby given that the site you have requested information on is recorded with the City of Chicago Department of Environment as potentially having environmental contamination on the site and adjacent right-of-way. This environmental contamination could present a threat to human health and safety in connection with work performed at the site, or in the adjacent right-of-way, if proper safeguards are not employed.

A file containing detailed information regarding the aforementioned environmental Contamination is available for review at the Department of Environment at 30 N. LaSalle St., 2nd Floor, Chicago, Illinois 60602 during normal business hours (8:30 AM - 4:30 PM, Monday through Friday). Contact Rahmat Begum (312) 744 - 3152 for an appointment. This file must be reviewed and the remainder of this form completed before the permit can be issued. Please note that for some locations, additional health and safety procedures may be required by law.

DATE 2-22-12

Please complete the following:

Permit No. 254796001

Date 2-17-2012

Site Address Rear 205 E Grand AV

Work Location (describe exact site location):

Alley @ Rear 205 E Grand AV

Nature of Work Dig (1) 8'x4'x4

Opening And Trench 8'x2'x3' across the alley:

Restore To COOT Standards

I have reviewed and understand the documents maintained by the Department of Environment, regarding environmental contamination of the site and adjacent right-of-way. Further, I will ensure that all work at the subject site and adjacent right-of-way, and any Monitoring required including but not limited to petroleum contamination, will be performed in a manner that is protective of human health and the environment and in compliance with all applicable local, state, and federal laws, rules, and regulations, especially those pertaining to worker safety and waste management. I will ensure that the results of any monitoring and/or surveying conducted shall be provided to the Department of Environment within two (2) weeks of their completion.

Signature Michele Pisterzi

Name (print) Michele Pisterzi

Company A+T

Address 2427 Union Blue Island, IL

Phone No: 708 8242817

Prime Contractor/Cont: Qualeco

Address P.O. Box 1840 Evanston, IL 60204

Phone 773-542-1530

Safety Officer/Phone STEVE KORNDLER A/C Com 847-279-2500

Signed by Department of Environment Rahmatunise Begum

Date 2/23/2012

Please return this completed form to the City of Chicago Department of Transportation at 30 N. LaSalle St., Room 1101, Chicago, Illinois 60602 during normal business hours (8:30 AM - 4:30 PM, Monday through Friday).

Calculation Sheet

Project 205 E. Grand Ave.		Subject ATTT ROW - RAD SURVEY				
Originated By BNS	Date 3/12/2012	Checked By BNS	Date 3/12/2012	Job No. 60163572	Scale 2/A	Sheet No. 1 of 1

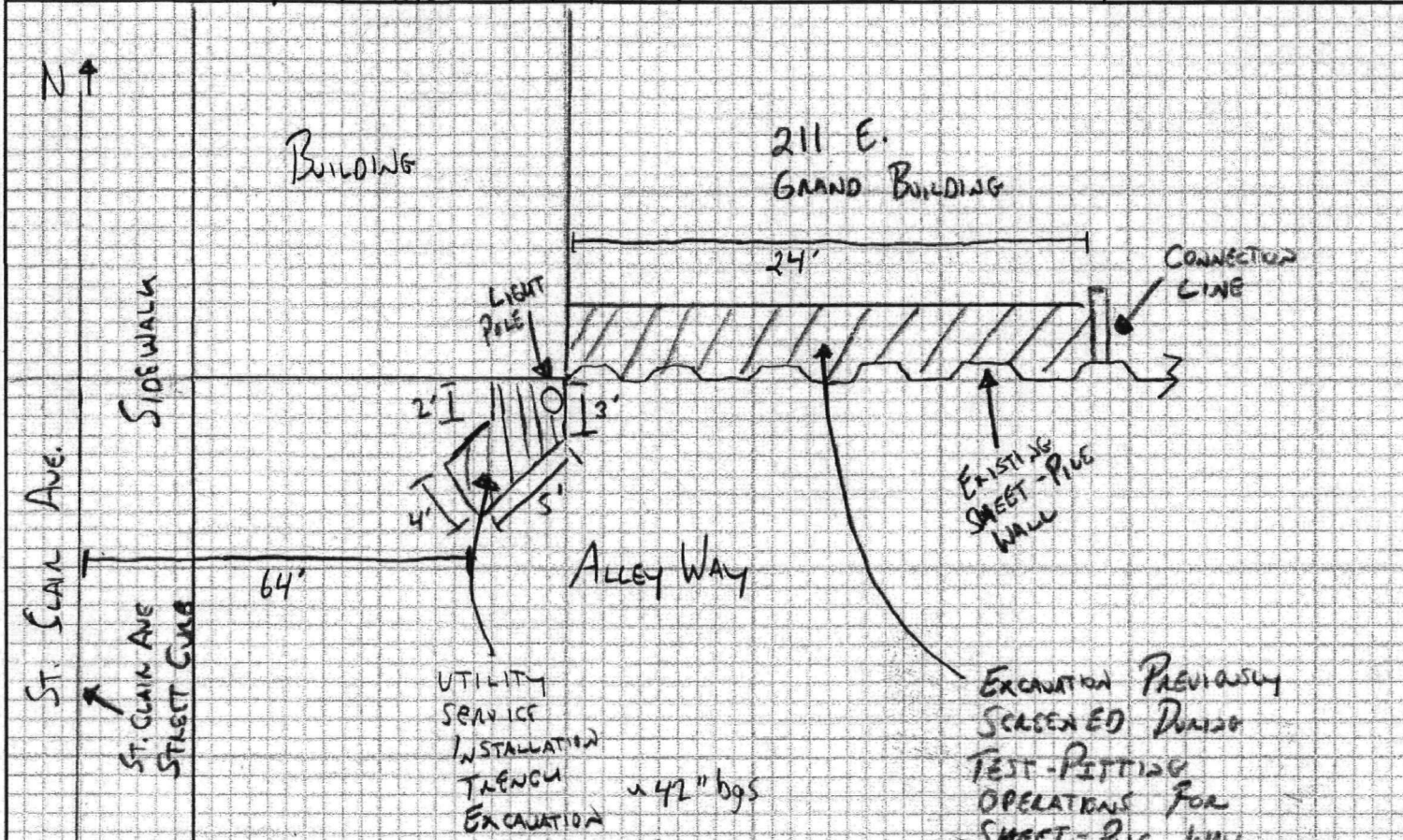

DEPTH	COUNTS PER MINUTE
0-6"	CONCRETE + ASPHALT
6-24"	8,000
24-42"	7,600
42-60"	8,600

EXCAVATION PREVIOUSLY SCREENED DURING TEST-PITTING OPERATIONS FOR SHEET-PILE WALL INSTALLATION
14' bgs

UTILITY SERVICE INSTALLATION TRENCH EXCAVATION
142" bgs