

Fang, Sharon

From: Ordway, Bryan (SSA R4) <Bryan.Ordway@cobham.com>
Sent: Wednesday, April 22, 2015 12:17 PM
To: Fang, Sharon; rapatel@pa.gov
Subject: Project Adams - Construction/Renovation - Submittal
Attachments: Cobham Adams Project Submittal Package.pdf

Dear Ms. Fang and Mr. Patel:

On behalf of Cobham Integrated Electronic Solutions ("Cobham"), attached please find a copy of a Scope Summary of Soil Disruption and Ground Breaking for the Cobham Adams Project at its facility located at 305 Richardson Road in Lansdale, Pennsylvania. In general terms, this Project consists of relatively small scale renovations, expansions and ground leveling activities at the Lansdale facility to accommodate the installation of new equipment (including a liquid nitrogen tank and a test chamber), as well as an outdoor test range. As reflected in the attached Scope Summary, this work will require some excavation and soil disturbance. While Cobham does not believe any of the proposed work will in any way interfere with or impede the implementation of any current or future investigation or remedial activity at the property, we are providing a copy of the attached report to the EPA and the PADEP for their respective review pursuant to Paragraph 1(e) of the Environmental Covenant between Cobham and BAE Systems Information and Electronic Systems Integration, Inc., dated February 22, 2008, out of an abundance of caution.

Please contact me with any questions or concerns either of you have with respect to this proposed work. I also respectfully request that the agencies conduct their review at their earliest convenience, as this Project is important for the growth of our business.

Thank you.

--

Bryan Ordway

Senior Environmental Affairs Specialist
Cobham Integrated Electronic Solutions
T : +1 215-996-2599
F : +1 215-996-2078
C : +1 267-640-4212
bryan.ordway@cobham.com

Cobham Advanced Electronic Solutions Inc., 305 Richardson Road, LANSDALE, Pennsylvania, 19446, USA. +1 (215) 996 2000 www.cobham.com/integrated-electronic-solutions

Please consider the environment before printing this email

This e-mail and any files transmitted with it ("E-mail") is intended solely for the addressee(s) and may contain information that is proprietary, privileged, company confidential and/or exempt from disclosure under applicable law. If you are not the intended addressee(s), any disclosure, reproduction, copying, distribution or other use of the E-mail is strictly prohibited. It may also contain data subject to the International Traffic in Arms Regulations or United States Export Administration Regulations, particularly if this E-mail has been transmitted from a United States location, and cannot be disseminated, distributed or copied to foreign nationals, residing in the United States or abroad, without the prior approval of the U.S. Department of State or appropriate export licensing authority. If you have received this E-mail in error, please delete it and destroy all copies of this E-mail and notify the sender immediately via telephone call or return e-mail.

Neither the company nor any subsidiary or affiliate or associated company nor any individual sending this E-mail accepts any liability in respect of the content (including errors and omissions) nor shall this e-mail be deemed to enter the company or any subsidiary or affiliate or associated company into a contract or to create any legally binding obligations unless expressly agreed to in writing under separate cover and timeliness of the E-mail which arise as a result of transmission. If verification is required, please request a hard copy version from the sender.



**SCOPE SUMMARY OF SOIL DISRUPTION
AND GROUND BREAKING**

FOR

***Cobham Adams Project
Cobham Integrated Electronic Solutions
Lansdale, Pennsylvania, USA***

April 10, 2015

Rev. No.	Issue Date	Pages	Rev Description	Prepared By	Reviewed By
0	4/10/15	7	Issued for review	Robert Shandik - Jacobs	Bob Moser - Cobham

TABLE OF CONTENTS

- 1.0 SCOPE OF WORK
- 2.0 STAKEHOLDERS
- 3.0 SITE PLAN
- 4.0 CHEMICAL STORAGE, COVERED WALKWAY, AND WOODEN DECK
- 5.0 LIQUID NITROGEN (LN2) TANK FOUNDATION
- 6.0 ISOLATION PAD

1.0 SCOPE OF WORK:

- 1.1 **Project Name:** Cobham Integrated Electronic Solutions Adams Project
- 1.2 **Project Location/Address:** 305 Richardson Road, Lansdale, Pennsylvania, USA 19446
- 1.3 **Description of work to be performed:** This project will consist of architectural and civil upgrades to the existing Cobham Lansdale facility. Some items of work, described herein, will required disturbing soil that may or may not have been previously disturbed during past site improvement efforts. Various storm water pollution prevention methods and erosion control practices will be in place to protect spoils generated during the excavation process.

2.0 STAKEHOLDERS:

1.1 Cobham Integrated Electronic Solutions:

COBHAM LANSDALE KEY MANAGEMENT STAFF	NAME	PHONE
Facilities Manager	Bob Moser	215-996-2797
Safety Manager	Paul Carroll	215-996-2290
Senior Environmental Affairs Specialist	Bryan Ordway	215-996-2599

1.2 JACOBS:

JACOBS KEY MANAGEMENT STAFF	NAME	PHONE
Project Manager	David C Beckemeier	407-948-2111
Site Manager	Robert Shandik	407-702-7442

3.0 SITE PLAN

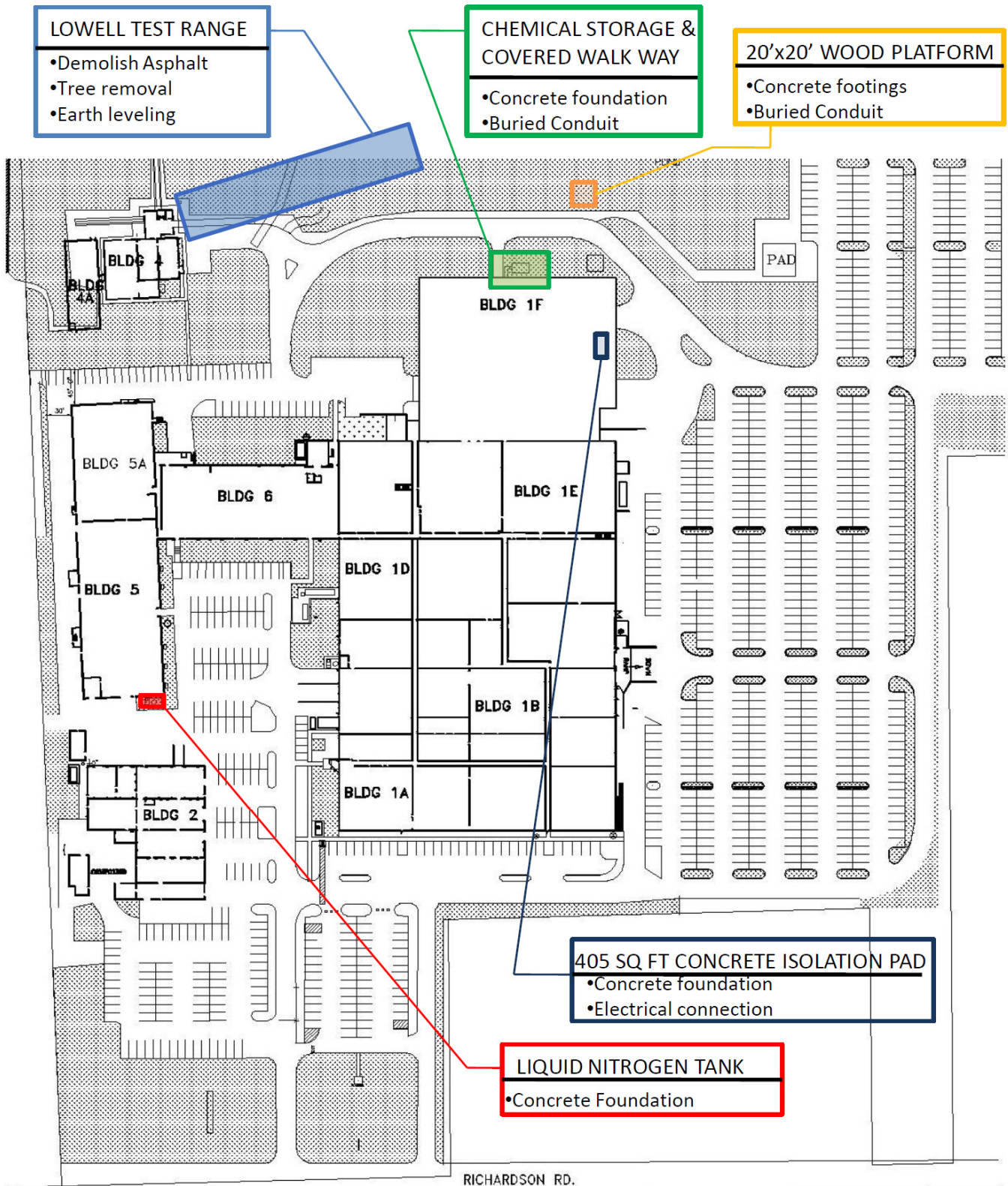

4.0 CHEMICAL STORAGE, COVERED WALKWAY, AND WOODEN DECK

FOUNDATION - CHEMICAL STORAGE UNIT

- Excavate 23'-4"Lx13'-4"Wx1'-0"D for foundation
- Excavate 1'-0"W x 3'-0"D at perimeter mentioned above for footings
- Compact existing sub-grade as required
- Install backfill per manufacturer's recommendations
- Install vapor barrier per manufacturer's recommendations
- Install concrete reinforcement per manufacturer's recommendations
- Pour concrete per manufacturer's recommendations
- Treat Soil as required

2 BURIED CONDUITS

- Saw cut and remove asphalt
- Excavate 1'W x 100'L x 3'-6"D
- Install sub-grade conduits
- Backfill excavation to grade
- Pour new asphalt

1 BURIED CONDUIT

- Excavate 1'-0"W x 20'-0"L 3'-6"D
- Install sub-grade conduits
- Backfill excavation to grade

3'x25' COVERED WALKWAY

- Excavate 6" of top soil
- Level and compact existing sub-grade as required
- Install welded wire fabric as required
- Form and pour 4" thick concrete walkway
- Saw cut concrete joints
- Treat soil as required

20'x20' WOODEN PLATFORM

- Excavate 3'-0" deep for concrete Footings as required.
- Treat Soil as required

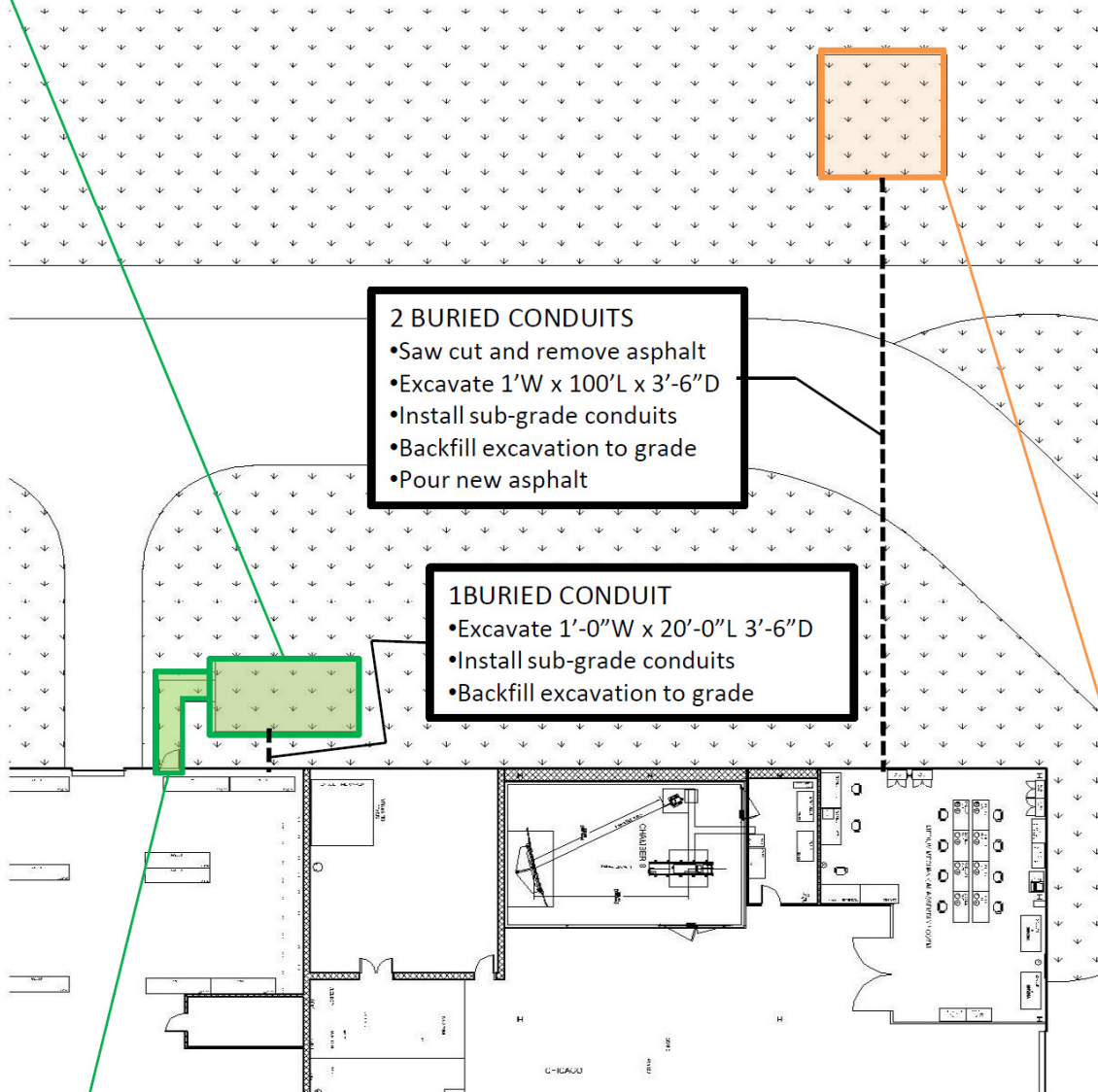

5.0 LIQUID NITROGEN (LN2) TANK FOUNDATION

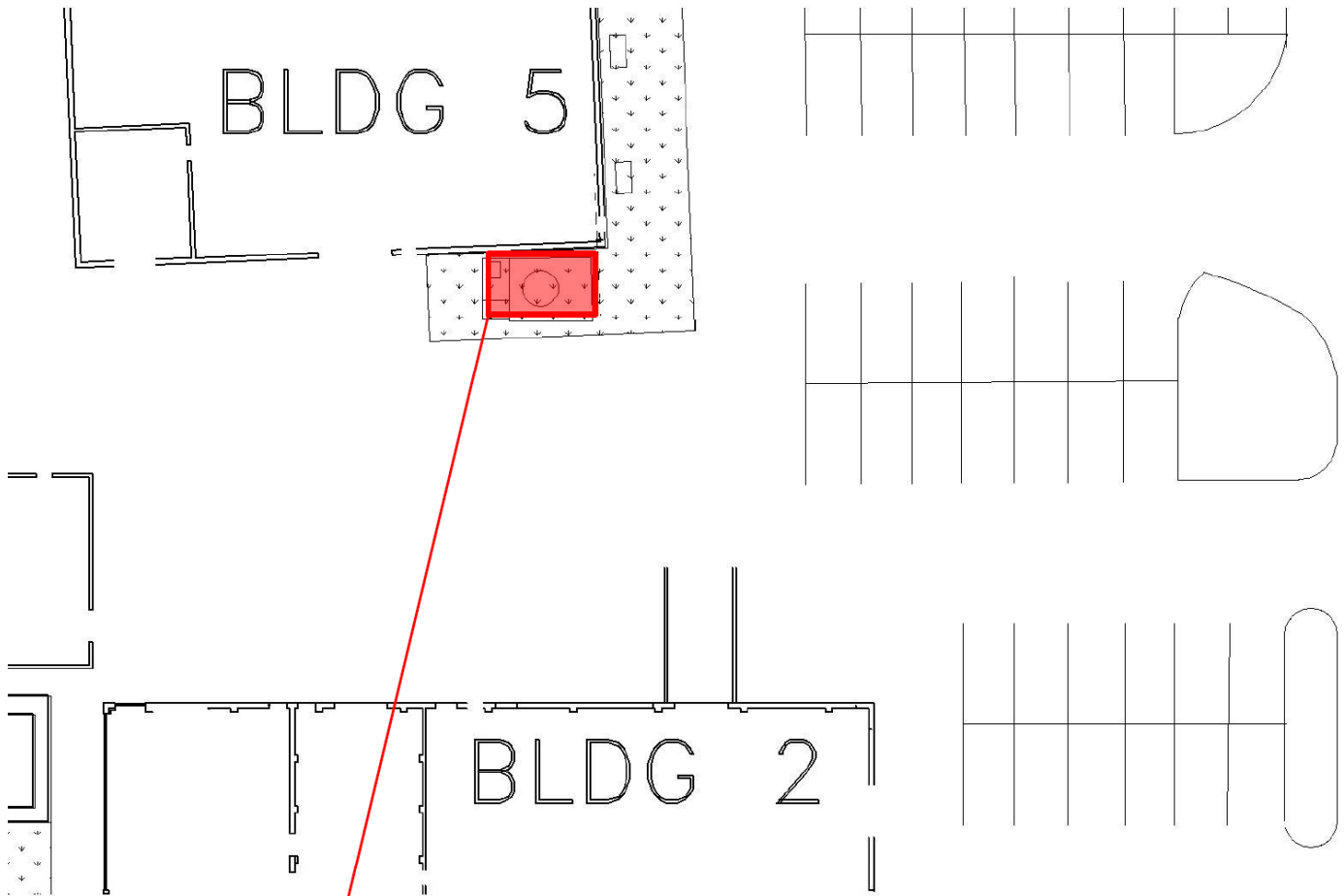

LIQUID NITROGEN TANK FOUNDATION

- Excavate 23'-4" Lx13'-4" Wx1'-0"D
- Excavate 1'-0" W x 3'-0" D at perimeter mentioned above for footings
- Compact existing sub-grade as required
- Install backfill per manufacturer's recommendations
- Install vapor barrier per manufacturer's recommendations
- Install concrete reinforcement per manufacturer's recommendations
- Pour concrete per manufacturer's recommendations

6.0 ISOLATION PAD

14'x28'x4' CONCRETE ISOLATION PAD

- Saw-cut existing concrete slab to dimensions above.
- Excavate concrete and earth 4' below top of existing slab
- Install backfill as required
- Install vapor barrier as required
- Apply waterproof coating as required
- Install concrete reinforcement as required
- Pour concrete to form pit per user requirements
- Install isolation board as required

