

District Director, Newark District

October 8, 1981

Firm: Helen Kramer Landfill
Mantua, NJ

John T. Frederick, Jr.
Investigator, Newark District

Vegetables grown on farms in vicinity of
Helen Kramer Landfill

This investigation was conducted pursuant to CP7304.004, Pesticides and Industrial Chemicals in Domestic Foods Program FY '82 at the request of US EPA, John Frisco, Chief, Hazardous Waste Unit.

On 10/6/81 a survey was made of the area surrounding the Helen Kramer Landfill with consideration given to those areas along Edwards Run, a local creek, downstream from the landfill. For a more thorough understanding of this memo please refer to the attached sketches and copy of the pertinent section of the Gloucester County map.

The Landfill site is situated south of Jessup Mill Road and north of Edwards Run. The landfill appears to be elevated relative to Edwards Run, however, the access road runs adjacent to several domiciles and was posted "No Trespassing" and the landfill property could not be closely scrutinized. The perimeter checked via GCV started on Jessup Mill Road

October 15, 1981

TO: Pesticides and Industrial Chemicals in
Domestic Foods Program Monitor, CRP

This investigation, conducted at the request of US EPA, John Frisco, Chief, Hazardous Waste Unit, revealed a number of operating farms in the area of the Helen Kramer Landfill and Edwards Run, a small stream found contaminated with leachate from the landfill. FDA investigation in the area of the landfill and stream identified a number of vegetable farms. A sample of butternut squash (INV 82-271-183) was collected for HUF-DO analysis for chemicals identified by EPA.

During the 1982 growing season we will collect samples of the crops identified during our investigation. Test results of the sample collected will be forwarded to EPA.

Robert J. Deininger
Supervisory Investigator, CRP, NWK-DO

RJD/dan
O+Attachs:CRP (Pesticides Monitor)
cc+Attachs: US EPA (John Frisco, Chief,
Hazardous Waste Unit
cc:HVV-323, RF, CRP-S.I.

HEL 001 2022

7

Page 2.

traveling north from Route 45 to Cohawkin Road then to County House Road to Mantua - Paulsboro Road and finally to Schaub Road ending again on Jessup Mill Road.

Several farms were observed along the route driven and a roadside market called Frank's Farm Market was observed west of Mantua - Paulsboro Road and south of the turnpike.

A visit was made to this farm; credentials were shown to Frank Cristaudo (Telephone No. (609) 468-3599) and he answered my questions about all the area farms, their usual crops and methods of irrigation. This farm market was one of two observed in operation in the area. The other market, Valley Wood Farm Market, is located on the same road on the opposite side and much closer to Edwards Run. These farms will be marked with circled code numbers on the sketched map.

Mr. Cristaudo said he and his son operated the Family Farm and he owned all the land adjacent to Mantua - Paulsboro Road from his farm house to the town of Mt. Royal. He and his son planted a variety of vegetables both for farm market sale and public sale at the Vineland Auction. They normally irrigate their crops in dry weather using water from several spring-fed ponds on their property, but no irrigation was done this year because his son was hospitalized with an illness and moving the irrigation equipment was too much for one man. Mr. Cristaudo said he was aware of possible environmental problems since the KPA had sent him a communication about 2 months ago warning against using water from Edwards Run for irrigation purposes. Another farm, the Leone Farm, located off Jessup Mill Road, grew mostly asparagus; Mr. Cristaudo was unsure of their irrigation methods. On the opposite side and further along Jessup Mill Road is the DiSimone Farm. Mr. Cristaudo said this farm irrigated their crops using farm ponds that apparently were spring-fed. Their main crops were tomatoes, summer squash and grains. He could not say whether this farm also irrigated using Edwards Run as a source. This farm also farmed a section along Mantua - Paulsboro Road but they irrigated crops using water from Mantua Creek upstream from confluence with Edwards Run. Valley Wood Farm owned by Fred Tomarchio adjoined the landfill on the southwest side but this is on the upstream side of Edwards Run. Mr. Cristaudo said this was the extent of the farms in the proximity of Edwards Run and the Kramer Landfill.

While motoring around the area the following materials or evidence of them were seen in the general area. These will be marked with circled code letters on the sketched map.

- A. Asparagus
- B. Eggplant
- C. Pepper
- D. Tomato
- E. Soybeans
- F. Corn
- G. Wheat

HEL 001 2023

Page 3.

Mr. Cristaudo said the growing season was all but finished. I observed about thirty watermelons and a large amount of butternut squash. Mr. Cristaudo said he had a few peppers and eggplant left but their size was not large.

ATTACHMENTS:

1. Pertinent Area on Gloucester County Map
2. Sketch of Pertinent Area
- 3.) Copy of Assignment

John T. Frederick, Jr.
Investigator, Newark District

JTF/dan

056
EAST
REENWICH

08066

08020

08006

Attached to
How Kramer Landfill
2/4/82
877

08025

MANUA

HEL 001 2025



Attachment # 2
 Helen Kroner Landfill
 10/6/81
 JTA

County House Rd.

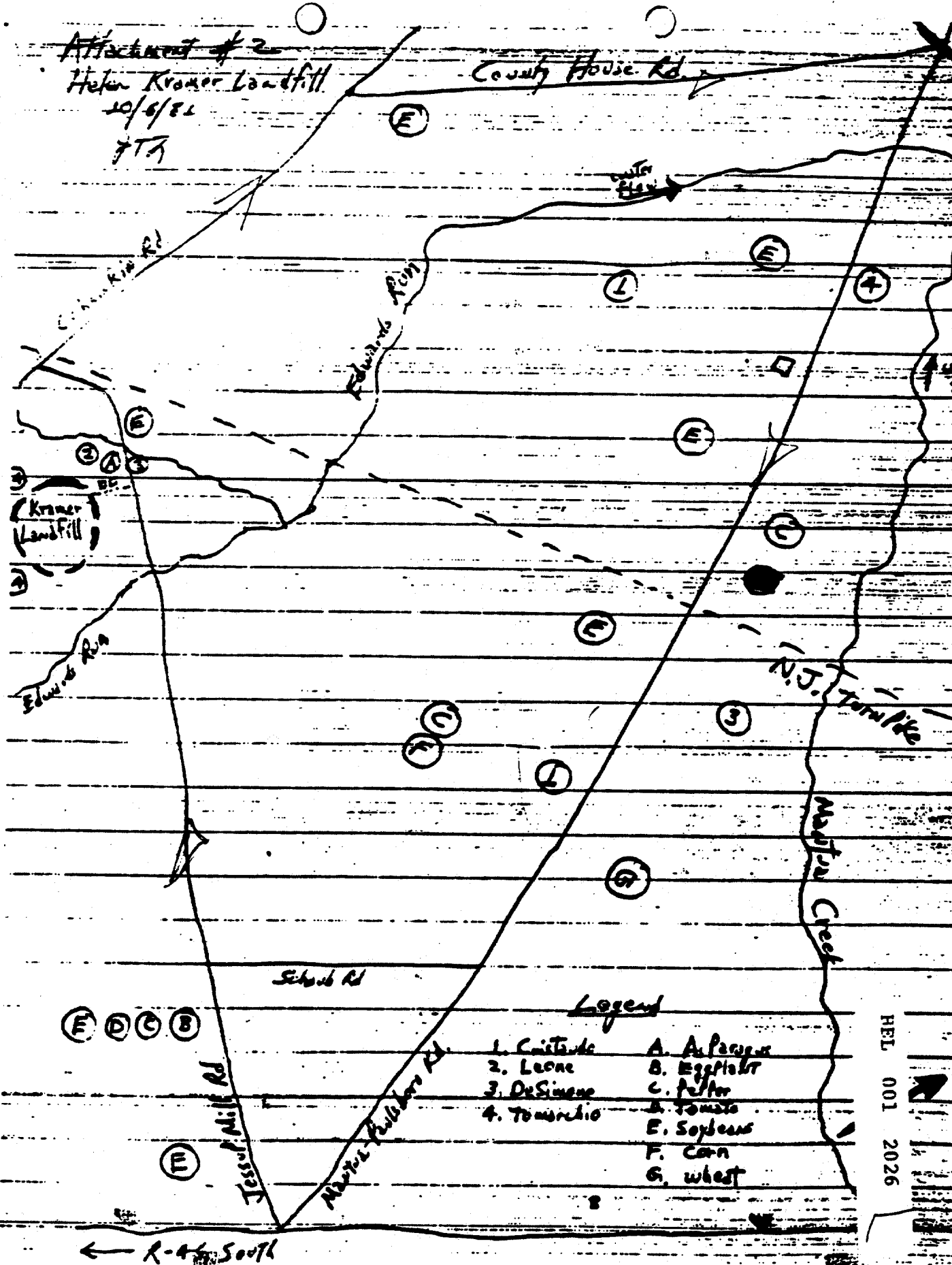

Legend

- | | |
|-------------|-------------|
| 1. Cuitanda | A. Alfalfa |
| 2. Leone | B. Eggplant |
| 3. DeSimone | C. Peper |
| 4. Tomarcho | D. Tomato |
| | E. Soybeans |
| | F. Corn |
| | G. wheat |

HEL 001 2026

← R-44 South